



DEVELOPER  
**MURPHY'S BOWL  
LLC**  
10400 NE 4th St, Suite 3000  
Bellevue, WA 98004

DEVELOPER'S MANAGING AGENT  
**WILSON MEANY**  
6701 Center Drive, Suite 950  
Los Angeles, CA 90045  
310.382.9000 tel  
http://wilsonmeany.com/

ARCHITECT / PLANNING /  
ENGINEERING / TRANSPORTATION  
**AECOM**  
AECOM TECHNICAL SERVICES, INC.  
2390 McGee, Suite 200  
Kansas City, MO 64108  
816.561.4443 tel. 816.561.2863 fax  
www.aecom.com

CIVIL ENGINEER  
**D&D  
ENGINEERING, INC**  
3501 S. La Cienega Blvd., Suite 106  
Inglewood, CA 90501  
424.351.6800 tel

DRY UTILITY SYSTEMS  
**BJ PALMER &  
ASSOCIATES, INC**  
Valencia, CA 91355  
760.842.7510 tel

PARKING  
**WALKER  
CONSULTANTS**  
608 S. Olive St., Suite 1100  
Los Angeles, CA 90014  
213.458.4911 tel

SHORING ENGINEER  
**DRS  
ENGINEERING, INC**  
3564 Sagunto Street, Suite 468  
Santa Ana, CA 92704  
949.402.3962 tel

MATCHLINE SEE BELOW

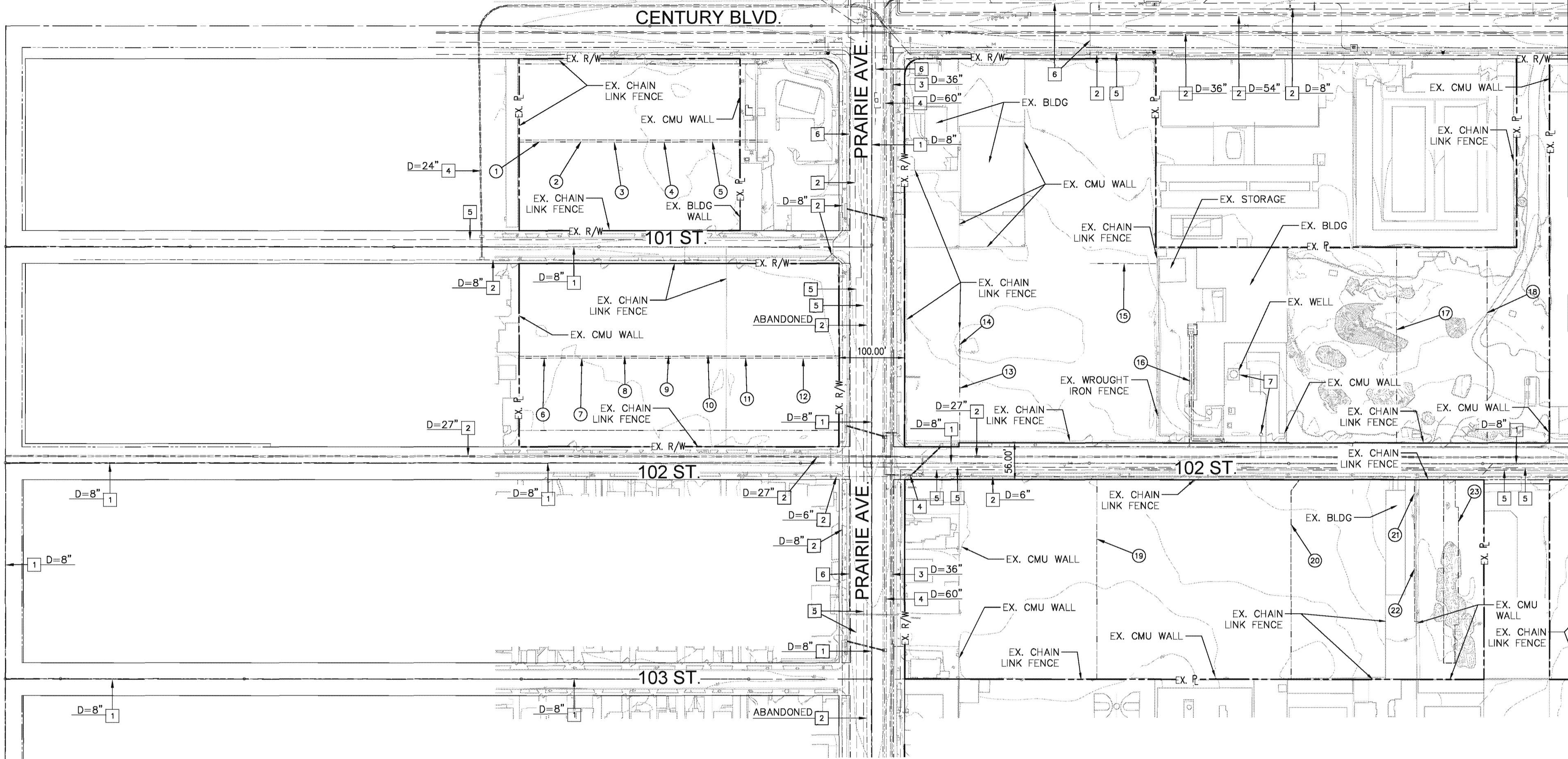

**PLOTTED EASEMENTS**

- ① 3' EASEMENT FOR POLE LINES AND CONDUITS BOOK 3959 PG 126 OF OFFICIAL RECORDS
- ② 3' WIDE EASEMENT FOR POLE LINES AND CONDUITS BOOK 4569 PG 382 OF OFFICIAL RECORDS
- ③ 3' WIDE EASEMENT PUBLIC UTILITIES BOOK 7378 PG 187 OF OFFICIAL RECORDS
- ④ 3' WIDE EASEMENT FOR TELEGRAPHY AND ELECTRIC LIGHT BOOK 2788 PG 85 OF OFFICIAL RECORDS
- ⑤ 3' WIDE EASEMENT FOR PUBLIC UTILITIES RECORDED FEBRUARY 15, 1950, BOOK 2948 PG 16 OF OFFICIAL RECORDS
- ⑥ 3' WIDE EASEMENT FOR PUBLIC POLES, WIRES, LINES, CONDUITS BOOK 9694 PG 40 OF OFFICIAL RECORDS
- ⑦ 3' WIDE EASEMENT FOR PUBLIC POLES, WIRES, LINES, CONDUITS RECORDED APRIL 18, 1923, INST # 610 BOOK 2136 PG 183 OF OFFICIAL RECORDS
- ⑧ 25' WIDE EASEMENT FOR STREET PURPOSES BOOK 7098 PG 81 OF OFFICIAL RECORDS
- ⑨ 3' WIDE EASEMENT FOR PUBLIC UTILITIES BOOK 5892 PG 224 OF OFFICIAL RECORDS
- ⑩ 3' WIDE EASEMENT FOR PUBLIC UTILITIES BOOK 5561 PG 82 OF OFFICIAL RECORDS
- ⑪ 3' WIDE EASEMENT FOR POLE LINES AND CONDUITS BOOK 3406 PG 132 OF OFFICIAL RECORDS
- ⑫ 3' WIDE EASEMENT FOR POLE, WIRES, CABLES, LINES, AND CONDUITS BOOK 7291 PG 258 OF OFFICIAL RECORDS
- ⑬ 12' WIDE EASEMENT FOR DRIVEWAY, RECORDED JULY 21, 1959, BOOK D-542 PG 520 OF OFFICIAL RECORDS
- ⑭ 12' WIDE EASEMENT FOR DRIVEWAY, RECORDED JULY 21, 1959, BOOK D-542 PG 520 OF OFFICIAL RECORDS
- ⑮ 25' WIDE EASEMENT FOR PUBLIC UTILITIES, RECORDED AUGUST 11, 1928, INST # 1282 BOOK 7211 PG 141 OF OFFICIAL RECORDS
- ⑯ EASEMENT FOR PUBLIC STREET UTILITIES, SOUTHERN CALIFORNIA EDISON COMPANY, RECORDED APRIL 09, 1990, INST # 1990-667859 OF OFFICIAL RECORDS
- ⑰ EASEMENT FOR POLE LINES AND CONDUITS, SOUTHERN CALIFORNIA EDISON RECORDED OCTOBER 23, 1983, INST # 5181 BOOK D-2230 PG 723 OF OFFICIAL RECORDS
- ⑱ 3' WIDE EASEMENT FOR PUBLIC UTILITIES, SOUTHERN CALIFORNIA EDISON RECORDED JULY 20, 1987, INST # 87-1146843 OF OFFICIAL RECORDS
- ⑲ EASEMENT FOR SEWER LINE BOOK 22905 PG 199 OF OFFICIAL RECORDS
- ⑳ EASEMENT FOR UTILITIES BOOK 5563B PG 230 OF OFFICIAL RECORDS
- ㉑ EASEMENT FOR PUBLIC UTILITY FACILITIES, RECORDED APRIL 07, 1959, INST # 3073 OF OFFICIAL RECORDS

**EXISTING UTILITIES**

- 1] EXISTING SEWER, DIAMETER PER PLAN
- 2] EXISTING WATER, DIAMETER PER PLAN
- 3] EXISTING RECLAIMED WATER, DIAMETER PER PLAN
- 4] EXISTING STORM DRAIN, SIZE PER PLAN
- 5] EXISTING GAS
- 6] EXISTING SCE/ELECTRICAL CONDUIT
- 7] EXISTING WELL

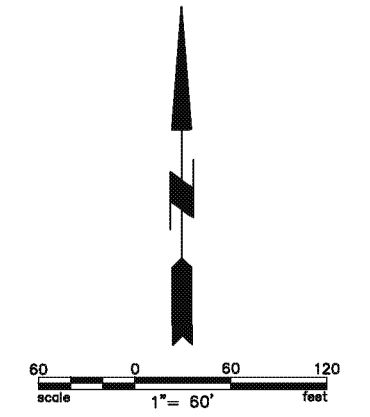

MATCHLINE SEE ABOVE

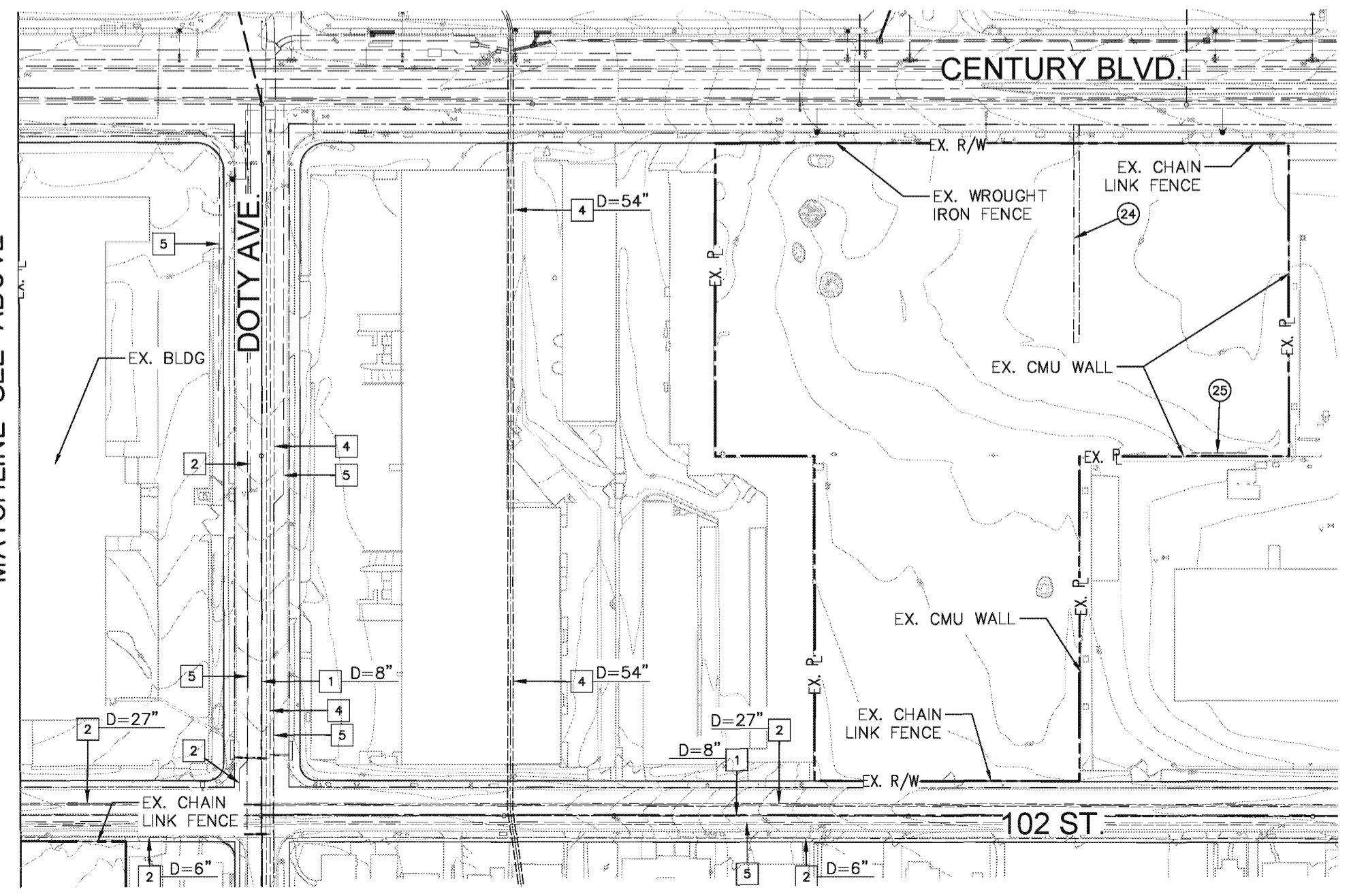

**REGISTRATION**  
This drawing has been prepared for the use of AECOM's client and may not be used, reproduced or relied upon by third parties, except as agreed by AECOM and its client, as required by law or for use by governmental reviewing agencies. AECOM accepts no responsibility, and denies any liability whatsoever, to any party that modifies this drawing without AECOM's express written consent. Do not scale this document. All measurements must be obtained from the stated dimensions.

**NOT FOR CONSTRUCTION**

**ISSUE/REVISION**

I/R	DATE	DESCRIPTION

**KEY PLAN**

**PROJECT NUMBER**  
17001-100

**SHEET TITLE**  
Existing Conditions Plan

**SHEET NUMBER**

**C-101**  
© 2015 AECOM TECHNICAL SERVICES, INC.