

WEST GARAGE - ARRIVAL TO ARENA

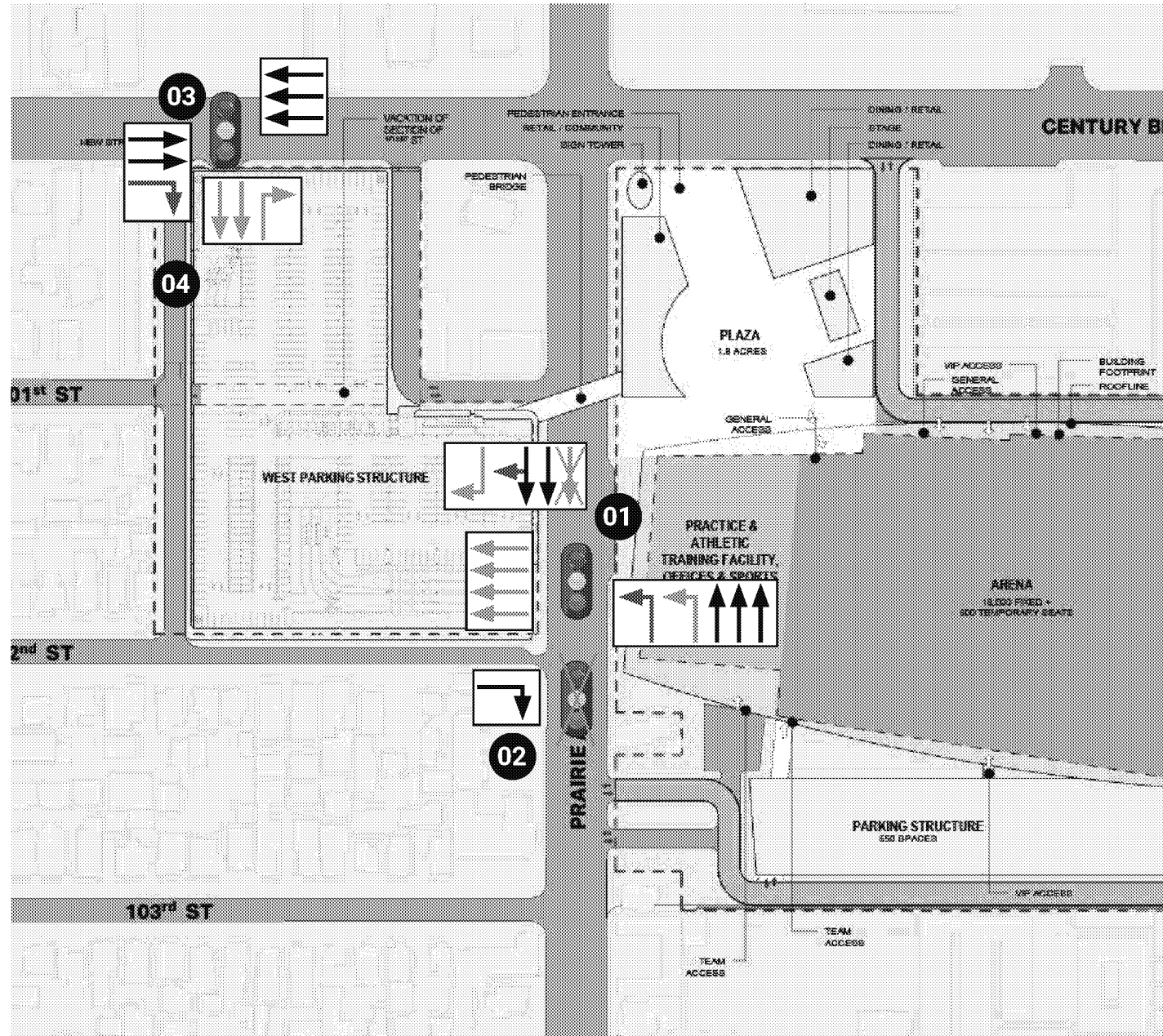

	New Traffic Signal		Project Design Lane Improvement
	Temporary Delineators		Potential Lane Reassignment
	Temporary Lane Closure		Existing Lane Configuration

SCALE: 1" = 200'
0 100 200 400

01. PRAIRIE AVENUE AT WEST PARKING DRIVEWAY INTERSECTION

Fully Operational Traffic Signal;
 1 Southbound Right Turn Lane; Approximately 175' Long (from 101st to parking garage driveway);
 1 Southbound Temporary Shared Right Turn Lane;
 1 Northbound Dedicated Left Turn Lane (converted from existing two-way left turn lane);
 1 Northbound Temporary Left Turn Lane (will require reversing one southbound lane);
 Crosswalk on South Leg of Intersection (operational during non-event days) and Pedestrian Crossing Prevented by Traffic Control Officers on Event Days.

02. PRAIRIE AVENUE AT 102ND STREET

Remove Existing Traffic Signal;
 Restrict Eastbound 102nd Street Traffic to Right Out Only;
 Provide a Corner Extension (aka half closure) to Prevent Right In/Left Out/Left In Movements.

03. CENTURY BLVD / WEST PARKING DRIVEWAY EVENT DAYS

Right In / Right Out Only.

04. CENTURY BLVD / NEW STREET

Fire Lane Only;
 No Spectator Access.

WEST GARAGE - DEPARTURE FROM ARENA

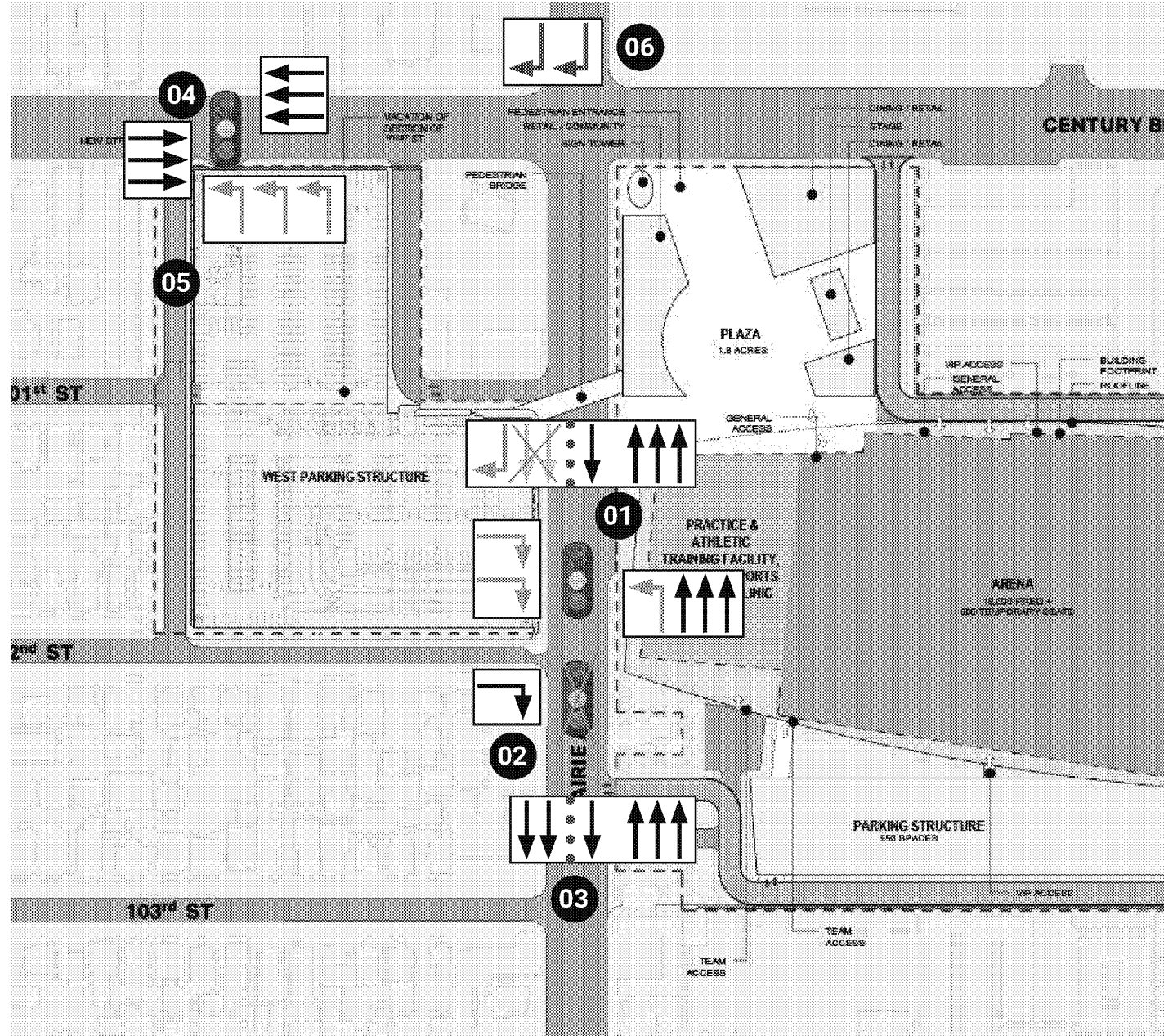

	New Traffic Signal		Project Design Lane Improvement
	Temporary Delineators		Potential Lane Reassignment
	Temporary Lane Closure		Existing Lane Configuration

SCALE: 1" = 200'

1. PRAIRIE AVENUE AT WEST PARKING DRIVEWAY INTERSECTION

Fully Operational Traffic Signal;
 Southbound Outside Two Through Lanes Closed to Provide Receiving Lanes for Right Turns from Driveway;
 Crosswalk on South Leg of Intersection (operational during non-event days) and Pedestrian Crossing Prevented by Traffic Control Officers on Event Days.

2. PRAIRIE AVENUE AT 102ND STREET

Remove Existing Traffic Signal;
 Restrict Eastbound 102nd Street Traffic to Right Out Only;
 Provide a Corner Extension (aka half closure) to Prevent Right In/Left Out/Left In Movements.

3. SB PRAIRIE AVENUE

Provide Dedicated Receiving Lanes for Two Right Turns from West Parking Garage along SB Prairie Avenue.

4. CENTURY BLVD / WEST PARKING DRIVEWAY EVENT DAYS

Traffic Signal Preemption for Departure;
 Left Out Only (right turns out restricted);
 Right Turns In Restricted.

5. CENTURY BLVD / NEW STREET

Fire Lane Only / No Spectator Access.

6. SB PRAIRIE AVE / CENTURY BLVD

Institute Temporary Southbound Dual-Right Turn Lane for Traffic Heading Westbound to Century.

WEST GARAGE - NON-EVENT DAYS

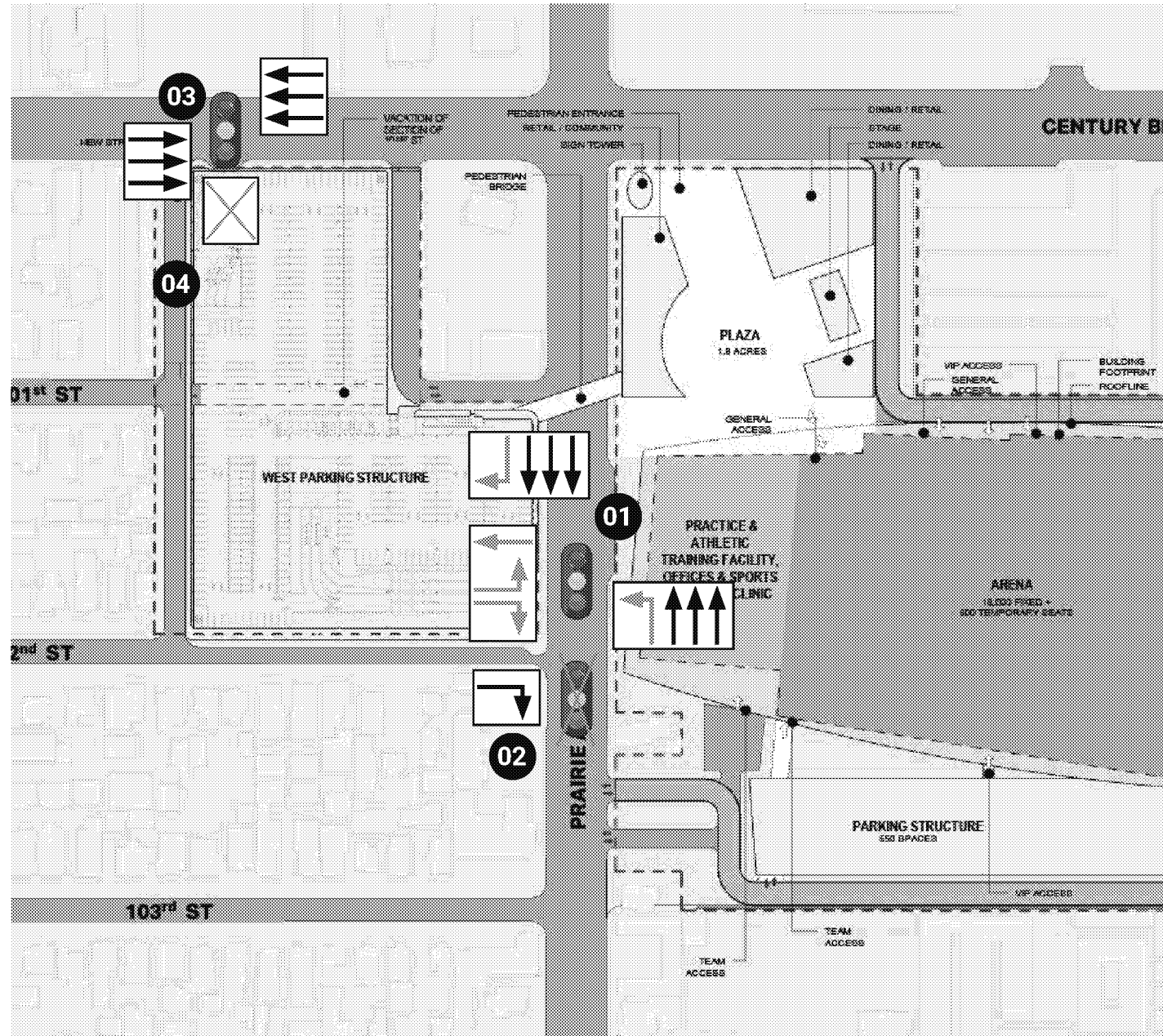

New Traffic Signal

➤ Project Design Lane Improvement

➤ Potential Lane Reassignment

➤ Existing Lane Configuration

SCALE: 1" = 200'



01. PRAIRIE AVENUE AT WEST PARKING DRIVEWAY INTERSECTION

Fully Operational Traffic Signal;

1 Southbound Right Turn Lane; Approximately 175' Long (from 101st to parking garage driveway);

1 Northbound Dedicated Left Turn Lane (converted from existing two-way left turn lane);
Crosswalk on South Leg of Intersection (operational during non-event days).

02. PRAIRIE AVENUE AT 102ND STREET

Remove Existing Traffic Signal;

Restrict Eastbound 102nd Street Traffic to Right Out Only;

Provide a Corner Extension (aka half closure) to Prevent Right In/Left Out/Left In Movements.

03. CENTURY BLVD / WEST PARKING DRIVEWAY EVENT DAYS

Driveway Closed on Non-Event Days;

NOTE: For a 2,000 Person Event Scenario, Right Turn In Allowed. Egress Restricted.

04. CENTURY BLVD / NEW STREET

Right In / Right Out Only.