

ST-4696

ST-4696

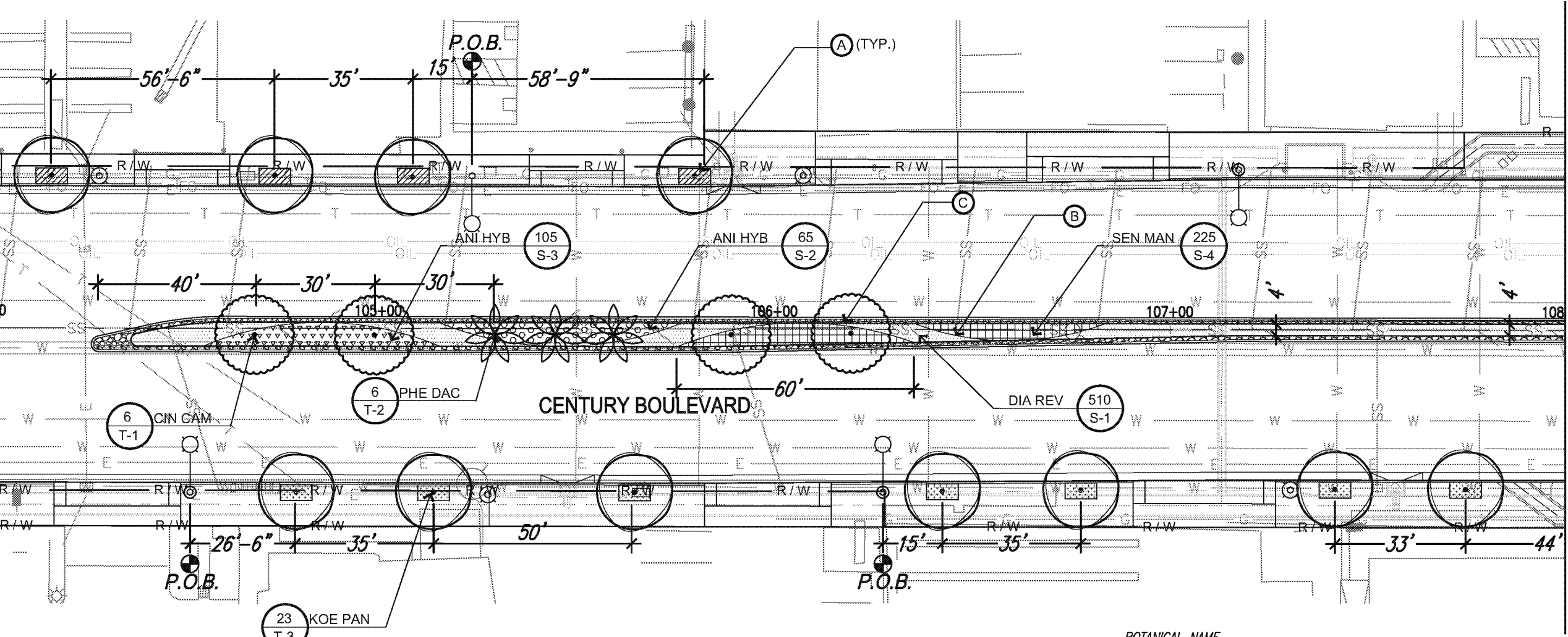
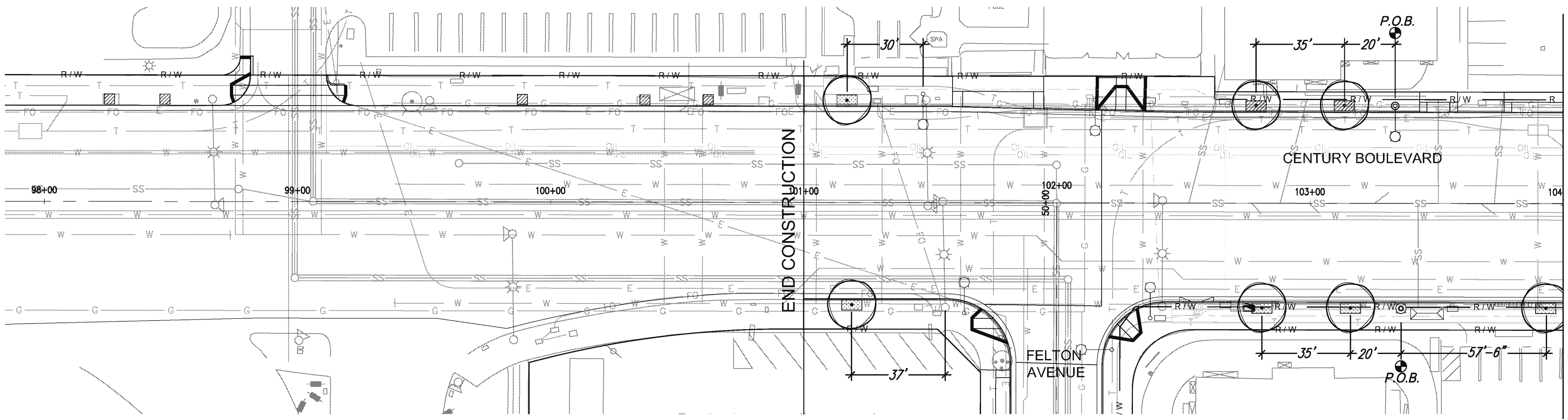

PLANT LEGEND

| SYMBOL | BOTANICAL NAME | COMMON NAME | QTY. | SIZE | DETAIL REFERENCE |
|---------------------|--------------------------------------|----------------------|------------|--------------------|---|
| TREES | | | | | |
| T-1 | CINNAMOMUM CAMPHORA | CAMPHOR TREE | 6 | 24" BOX | STANDARD DOUBLE STAKE TREE DETAIL A, SHEET LP-203 |
| T-2 | PHEONIX DACTYLIFERA | DATE PALM | 6 | 20" B.T | PALM PLANTING DETAIL B, SHEET LP-203 |
| T-3 | KOELREUTERIA PANICULATA | GOLDENRAIN TREE | 23 | 24" BOX | STANDARD DOUBLE STAKE TREE DETAIL A, SHEET LP-203 |
| SHRUBS | | | | | |
| S-1 | DIANELLA REVOLUTA | LITTLE REV FLAX LILY | 510 | 5 GAL @ 2' O.C. | SEE SHRUB PLANTING, DETAIL C, SHEET LP-203 |
| S-2 | ANIGOZANTHOS HYBRID 'RUBY VELVET' | RUBY VELVET | 65 | 5 GAL @ 2' O.C. | SEE SHRUB PLANTING, DETAIL C, SHEET LP-203 |
| S-3 | ANIGOZANTHOS HYBRID 'GOLD VELVET' | GOLD VELVET | 105 | 5 GAL @ 2' O.C. | SEE SHRUB PLANTING, DETAIL C, SHEET LP-203 |
| S-4 | SENECIO MANDRALISCAE | BLUE CHALK STICKS | 225 | 5 GAL @ 2' O.C. | SEE GROUNDCOVER PLANTING, DETAIL D, SHEET LP-203 |
| GROUNDCOVERS | | | | | |
| GC-1 | STABILIZED DECOMPOSED GRANITE | | 480 S.F. | | SEE DECOMPOSED GRANITE, DETAIL E, SHEET LP-203 |
| GC-2 | RIVER ROCK BANDING IN GROUT | | 1,600 S.F. | | SEE RIVER ROCK BANDING, DETAIL H, SHEET LP-203 |
| A | 4'X8' TREE GRATE "ADA" BY IRONSMITH | | 8 | | SEE 48" X 96" TREE GRATE, DETAIL G, SHEET LP-203 |
| B | ALUMINUM EDGING/DIVIDER | | 410 L.F. | | SEE EDGING/DIVIDER DETAIL F, SHEET LP-203, OR APPROVED EQUAL. |
| C | ROOT BARRIER, 24" DEPTH | | 840 L.F. | | SEE DETAIL A, SHEET LP-203, OR APPROVED EQUAL. |

NOTE: PLANT QUANTITIES FOR CONTRACTORS REFERENCE ONLY.

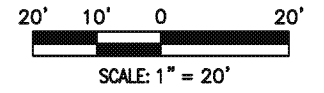

SEE ABOVE RIGHT FOR CONTINUATION
MATCH LINE - STA 104+00

MATCH LINE - STA 108+00
SEE SHEET LP-202 FOR CONTINUATION

MATCH LINE - STA 104+00
SEE BOTTOM LEFT FOR CONTINUATION

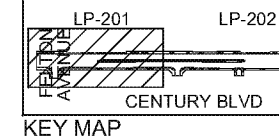

CORNERSTONE STUDIOS, INC.
 106 W. 4th St. 5th Floor 714. 973. 2200 Voice
 Santa Ana, CA 92701 714. 973. 0203 Fax
 LANDSCAPE ARCHITECTURE • URBAN DESIGN • PLANNING • RESOURCE ANALYSIS

AECOM
 AECOM Technical Services, Inc.
 515 S. FLOWER ST., 4th FLOOR
 LOS ANGELES, CA 90071
 T 213.330.7200 F 213.330.7201
 www.aecom.com

LICENSED LANDSCAPE ARCHITECT
 No. 200
 State of California

| REVISIONS | | |
|-----------|------|-------------|
| MARK | DATE | DESCRIPTION |
| | | |

CITY OF INGLEWOOD, CALIFORNIA
PUBLIC WORKS DEPARTMENT

PROJECT TITLE:
**PLANS FOR IMPROVEMENT OF
 CENTURY BOULEVARD
 DOTY AVE TO INGLEWOOD AVE
 PLANTING PLAN - 100+00 TO 108+00**

DESIGNED BY: _____
 DRAWN BY: _____
 CHECKED BY: _____

SUBMITTED BY / APPROVED BY:

 ELOY M. CASTILLO, RCE #100 / PRINCIPAL CIVIL ENGINEER

DATE: **5/18/2015**

PLAN NO.: LP-201
 SHEET NO.: 46 OF 67

Vertical text on the right edge of the sheet.

ST-4696

SEE SHEET LP-201 FOR CONTINUATION
MATCH LINE - STA 108+00

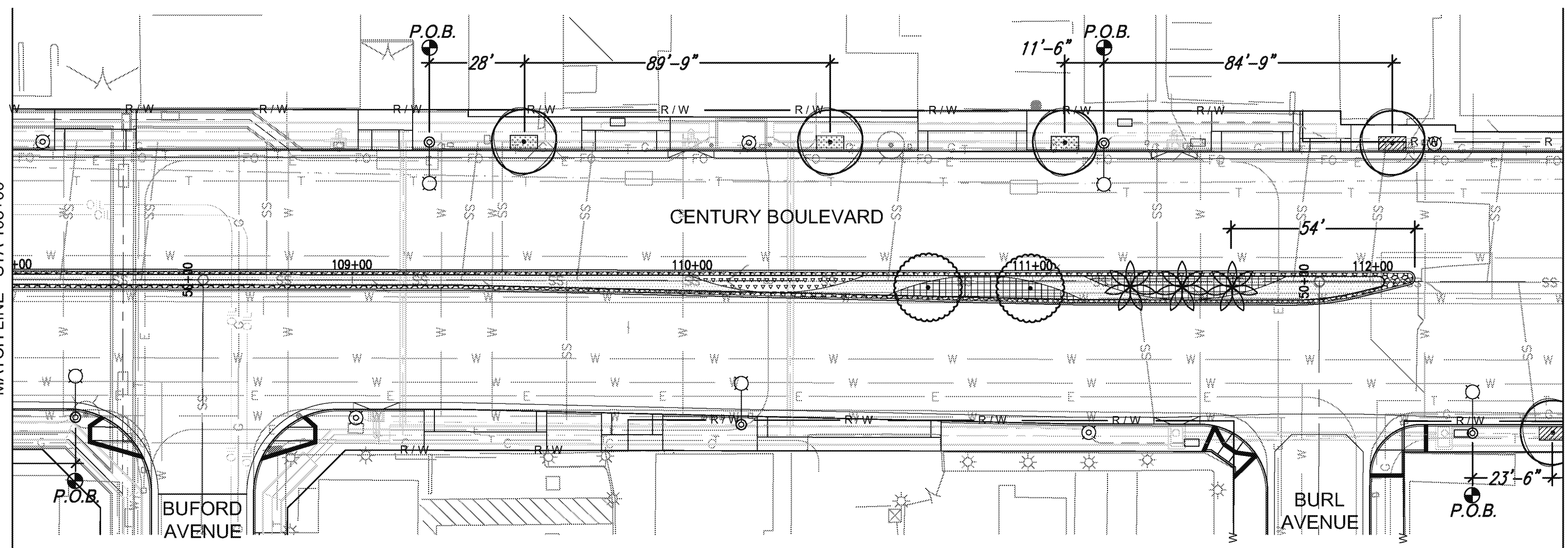

MATCH LINE - STA 112+55
SEE PROJECT 3 PLANTING PLANS, SHEET LP-301 FOR CONTINUATION.

- NOTE:
1. INSTALLATION OF ALL PLANTING MATERIALS IN PROJECT 2 WILL TAKE PLACE UPON ACTIVATION OF THE IRRIGATION SYSTEMS IN PROJECT 2.
 2. INSTALL IRRIGATION SYSTEMS INCLUDING MAINLINE, SLEEVING, CONTROL VALVES, CONTROL & COMMON WIRING, LATERAL PIPING AND HEADS WITH THE UNDERSTANDING THAT NO CONNECTIONS TO WATER OR AUTOMATIC CONTROLLER WILL TAKE PLACE UNTIL PROJECT #3 IS ACTIVATED. CAP AND PROTECT ALL PIPING THAT IS NOT TO BE INSTALLED UNTIL PROJECT #3.

PLANTING NOTES

1. WORK SHALL MEET THE REQUIREMENTS OF ALL LOCAL, STATE, AND FEDERAL GOVERNING CODES, ORDINANCES, LAWS, REGULATIONS, SAFETY ORDERS AND DIRECTIVES.
2. CONTRACTOR SHALL BE RESPONSIBLE FOR MAKING HIMSELF/HERSELF FAMILIAR WITH ALL UNDERGROUND UTILITIES, PIPES AND STRUCTURES. CONTRACTOR SHALL TAKE SOLE RESPONSIBILITY FOR ANY COST INCURRED DUE TO DAMAGE OF SAID UTILITIES.
3. CONTRACTOR MUST CHECK ALL SITE CONDITIONS PRIOR TO COMMENCING WORK. CONTRACTOR SHALL NOT WILLFULLY PROCEED WITH CONSTRUCTION AS DESIGNED WHEN IT IS OBVIOUS THAT UNKNOWN OBSTRUCTIONS AND/OR GRADE DIFFERENCES EXIST THAT MAY NOT HAVE BEEN KNOWN DURING DESIGN. SUCH CONDITIONS SHALL BE IMMEDIATELY BROUGHT TO THE ATTENTION OF THE OWNER'S AUTHORIZED REPRESENTATIVE. THE CONTRACTOR SHALL ASSUME FULL RESPONSIBILITY FOR ALL NECESSARY REVISIONS DUE TO FAILURE TO GIVE SUCH NOTIFICATION.
4. ALL PLANT QUANTITIES ARE IDENTIFIED BY TYPICAL SYMBOLS. REFER TO PLANT LEGEND FOR QUANTITIES. PLANT QUANTITIES ARE APPROXIMATE AND ARE PROVIDED FOR THE CONVENIENCE OF THE CONTRACTOR. IT SHALL BE THE CONTRACTOR'S RESPONSIBILITY TO CONFIRM ALL PLANT QUANTITIES PRIOR TO BIDDING. IN THE EVENT OF DISCREPANCIES IN PLANT COUNT, QUANTITIES INDICATED BY PLANT SYMBOLS SHALL PREVAIL.
5. TREES SHALL BE REVIEWED AND TAGGED BY OWNER'S AUTHORIZED REPRESENTATIVE. PLANT MATERIAL SHALL BE GUARANTEED TO BE AVAILABLE AND MEET OR EXCEED REQUIRED SPECIFICATIONS ON ESTIMATED DATE OF START OF PLANTING. IF REQUESTED BY OWNER'S AUTHORIZED REPRESENTATIVE, CONTRACTOR SHALL SUBMIT FOR APPROVAL PHOTOS OF ALL BOXED TREES. PHOTOS SHOULD INCLUDE PERSON FOR SCALE PURPOSES.
6. CONTRACTOR SHALL NOTIFY OWNER'S AUTHORIZED REPRESENTATIVE IF, PRIOR TO BIDDING, ANY SPECIFIED PLANT MATERIAL IS FOUND TO BE UNAVAILABLE.
7. IT IS THE CONTRACTOR'S RESPONSIBILITY TO FURNISH PLANT MATERIAL FREE OF PESTS OR DISEASE.
8. ALL PLANT MATERIAL DELIVERED TO THE SITE SHALL BE APPROVED BY THE OWNER'S AUTHORIZED REPRESENTATIVE PRIOR TO INSTALLATION.
9. ALL PLANT MATERIAL SHALL BE SET OUT AS SHOWN ON PLAN. FINAL LOCATION OF ALL PLANT MATERIAL SHALL BE SUBJECT TO THE APPROVAL OF THE OWNER'S AUTHORIZED REPRESENTATIVE.
10. ALL EXISTING TREES NOTED TO REMAIN ON PLANTING PLAN OR TREE INVENTORY ARE TO BE PROTECTED IN PLACE DURING CONSTRUCTION.
11. ANY TREE SHOWN ON PLAN TO BE INSTALLED LESS THAN 3' (THREE FEET) CLEAR DISTANCE FROM CENTERLINE OF TRUNK TO ANY CURB, WALKWAY, OR FOUNDATION, SHALL BE INSTALLED IN A ROOT CONTROL BARRIER. INSTALL PER MANUFACTURER'S INSTRUCTIONS.
12. ALL AREAS NOT PLANTED IN TURF AND LESS THAN 4:1 SLOPE SHALL BE COVERED WITH 2" ORGANIC MULCH. SUBMIT 1 CU. FT. SAMPLE PRIOR TO APPLICATION.
13. MINIMUM 3 SOIL SAMPLES SHALL BE TAKEN BY CONTRACTOR AFTER GRADING OPERATIONS ARE COMPLETED FOR SOIL FERTILITY AND AGRICULTURAL SUITABILITY BY AN APPROVED LABORATORY. SEE SPECIFICATIONS FOR SOIL AMENDMENTS SPECIFIED FOR BIDDING PURPOSES ONLY. SUBMIT SOIL REPORT TO OWNER'S AUTHORIZED REPRESENTATIVE. SOIL AMENDMENTS SHALL BE AS PER RECOMMENDATIONS IN SOILS REPORT.
14. CONTRACTOR SHALL NOTIFY OWNER'S AUTHORIZED REPRESENTATIVE 48 HOURS PRIOR TO COMMENCEMENT OF WORK TO COORDINATE OPERATIONS.
15. THE OWNER'S AUTHORIZED REPRESENTATIVE SHALL BE THE SOLE JUDGE AS TO WHEN THE MAINTENANCE PERIOD BEGINS.
16. THAT CONTRACTOR SHALL ENSURE THAT THE PLANT MATERIAL SPECIES NOTED ON THE APPROVED PLANS WILL BE AVAILABLE UPON THE COMMENCEMENT OF CONSTRUCTION.
17. ALL LANDSCAPED AREAS SUBJECT TO A 90-CALENDAR DAY MINIMUM, xxx- CALENDAR DAY MAXIMUM, LANDSCAPE MAINTENANCE PERIOD.
18. ALL LANDSCAPED PLANTING AREAS SHALL BE TREATED WITH AN APPROVED HERBICIDE APPLICATION ACCORDING TO MANUFACTURER'S RECOMMENDATIONS TO ENSURE A WEED FREE CONDITION PRIOR TO CITY ACCEPTANCE OF THE WORK.

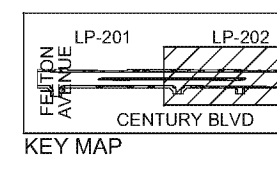
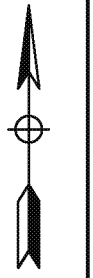
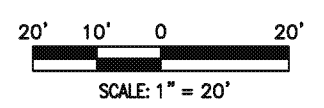

CORNERSTONE STUDIOS, INC.
 106 W. 4th St. 5th Floor 714.973.2200 Voice
 Santa Ana, CA 92701 714.973.0203 Fax
 LANDSCAPE ARCHITECTURE • URBAN DESIGN • PLANNING • RESOURCE ANALYSIS

AECOM
 AECOM Technical Services, Inc.
 515 S. FLOWER ST., 4th FLOOR
 LOS ANGELES, CA 90071
 T 213.330.7200 F 213.330.7201
 www.aecom.com

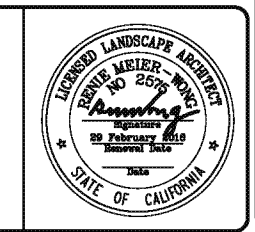

| REVISIONS | | |
|-----------|------|-------------|
| MARK | DATE | DESCRIPTION |
| | | |
| | | |

CITY OF INGLEWOOD, CALIFORNIA
PUBLIC WORKS DEPARTMENT

PROJECT TITLE:
PLANS FOR IMPROVEMENT OF CENTURY BOULEVARD DOTY AVE TO INGLEWOOD AVE PLANTING PLAN - 108+00 TO 112+55

DESIGNED BY: _____
 DRAWN BY: _____
 CHECKED BY: _____

SUBMITTED BY / APPROVED BY:

 ELOY M. CASTILLO, RCE #9100 / PRINCIPAL CIVIL ENGINEER

DATE: **5/18/2015**

PLAN NO.: **LP-202**
 SHEET NO.: **47 OF 67**

ST-4696

ST-4696

ST-4696

Drawing Name: V:\Century Boulevard\0-0655\Drawings\CS\06\Project 4\Project 2\LP-202.dwg
 Last Created: Mar 1, 2015 - 4:29PM by: jll/ken

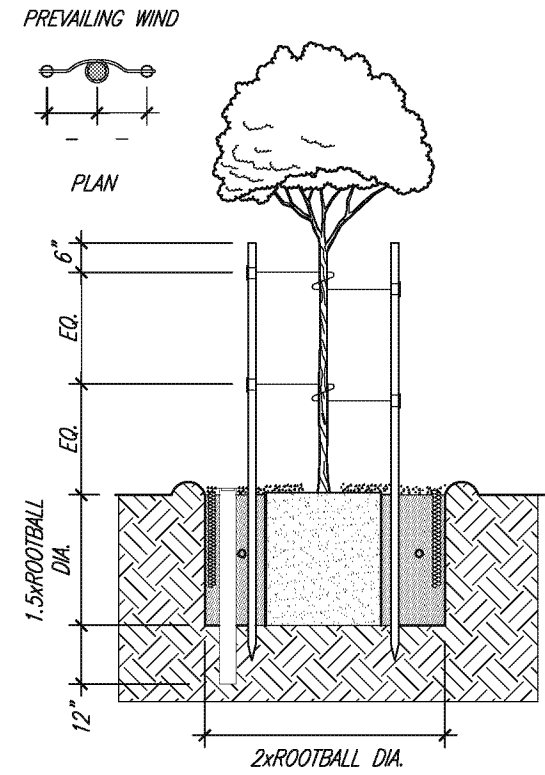

- Detail Legend**
- TREE SUPPORT, MFG. "VIT" TWIST BRACE OR APPROVED EQUAL.
 - PLUMB LODGEPOLE TREE STAKE, 2"x10"-0".
 - KEEP 2" THICK LAYER OF ORGANIC MULCH 6" CLEAR OF TREE TRUNK
 - FLOOD 3" DEEP WATER BASIN TO PLUMB TREE TRUNK & SET GRADE OF ROOTBALL
 - FINISH GRADE
 - ROOTBALL, INSTALL 1" ABOVE GRADE.
 - FERTILIZER TABLET, SEE SPECS.
 - SEE SPECS FOR AMENDED BACKFILL MIX.
 - SCARIFY PLANTING PIT EDGE
 - SITE SOIL, UNDISTURBED
 - FILL 3" PERF PIPE W/ CRUSHED 3/4" ROCK ABOVE FINISH GRADE. INSTALL PER MFG SPECS, SIZE & LAYOUT PER CONSTRUCTION SHEETS, OR APPROVED EQUAL.
 - 12" FOR MDL TB24 FOR 15 GAL TREE OR 18" FOR MDL TB36 FOR 24" TO 36" BOX
- NOTE: MIN. (2) TIES [TOP & BOTTOM] REQUIRED. USE 3RD TIE WHEN NECESSARY TO HOLD TREE IN UPRIGHT POSITION.

A Tree Planting w/Root Barrier N.T.S.

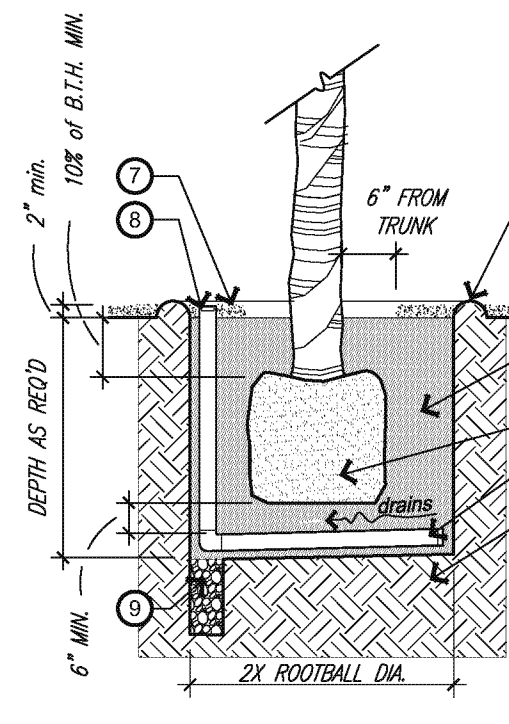

- Detail Legend**
- WATERING BASIN (TO BE REMOVED WHEN GROUND COVER IS PLANTED)
 - FINISH GRADE
 - 100% COARSE SAND BACKFILL, (MECHANICALLY COMPACT AND JET W/ WATER)
 - ROOTBALL
 - 4" DIA. PERF. DRAIN LINE (2000# CRUSH POLYSTYRENE) WRAP W/ FILTER FABRIC SOCK-CENTER UNDER ROOTBALL PROVIDE END CAP & ELL AS INDICATED.
 - UNDISTURBED SITE SOIL
 - INERT MULCH, SEE SPECS
 - 4" DIA. REMOVABLE BLACK RUBBER PLUG DAYLIGHT @ FG.
 - 12" DIA. x 7" DEEP GRAVEL FILLED SUMP SLOPE PIT TO SUMP

B Palm Planting N.T.S.

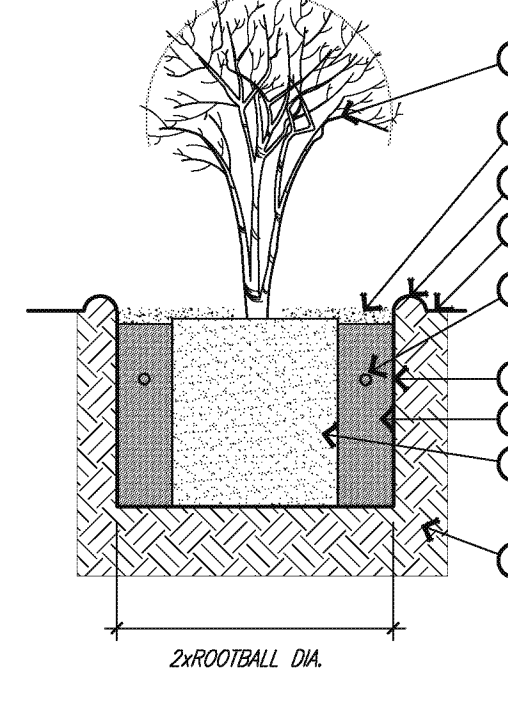

- Detail Legend**
- SHRUB, 1 OR 5 GAL
 - KEEP 2" LAYER OF ORGANIC MULCH 6" CLEAR FROM PLANT CROWN.
 - FLOOD & SETTLE 3" DEEP WATER BASIN TO PLUMB PLANT STEM (TO GRADE) AND SET GRADE OF ROOTBALL
 - FINISH GRADE
 - FERTILIZER TABLET, SEE SPECS.
 - SCARIFY ALL SIDES OF PLANTING PIT
 - SEE PLANTING SPEC. FOR AMENDED BACKFILL MIX
 - PLANT ROOTBALL 1/2" ABOVE FINISH GRADE & LOOSEN ROOTS IF NECESSARY.
 - SITE SOIL, UNDISTURBED

C Shrub Planting N.T.S.

Ground Cover Spacing (Triangular) N.T.S.

| SPACING O.C. "D" | ROW "A" | NO. OF PLANTS / 100 S.F. |
|------------------|---------|--------------------------|
| 6" O.C. | 5" | 462 |
| 8" O.C. | 7" | 260 |
| 9" O.C. | 8" | 215 |
| 10" O.C. | 8-1/2" | 166 |
| 12" O.C. | 10-1/2" | 115 |
| 15" O.C. | 13" | 74 |
| 18" O.C. | 15-1/2" | 51 |
| 24" O.C. | 21" | 29 |
| 30" O.C. | 26" | 19 |
| 36" O.C. | 31" | 12 |
| 48" (4') O.C. | 41-1/2" | 7 |
| 60" (5') O.C. | 52" | 5 |
| 72" (6') O.C. | 62" | 3 |
| 84" (8') O.C. | 73" | 2 |
| 120" (10') O.C. | 104" | 1 |

NOTES:
D = ON CENTER (O.C.)
SPACING BETWEEN PLANTS AS SPECIFIED IN PLANTING LEGEND
A = DISTANCE BETWEEN ROW OF PLANTS

D Ground Cover Spacing (Triangular) N.T.S.

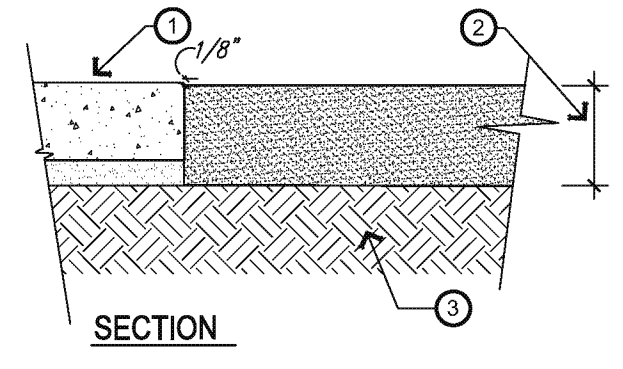

- Detail Legend**
- EXISTING CONCRETE PAVING OR CURB.
 - 1/4" MINUS DECOMPOSED GRANITE-SEE SPECS. KEEP D.G. 1/8" BELOW TOP OF HEADER, WALKWAYS, ETC. SEE CONSTRUCTION PLAN SHEETS L-201-203 FOR LOCATION. DG SHALL BE PLACED TO A MIN. DEPTH OF 4" COMPACTED. BINDER SHALL BE INCORPORATED.
 - UNDISTURBED OR COMPACTED SUBGRADE
- NOTES:
- D.G. IS AVAILABLE THRU DECORATIVE STONE SOLUTIONS TEL: (800) 699 - 1878 OR APPROVED EQUAL.

E D.G. Paving at Concrete Edge N.T.S.

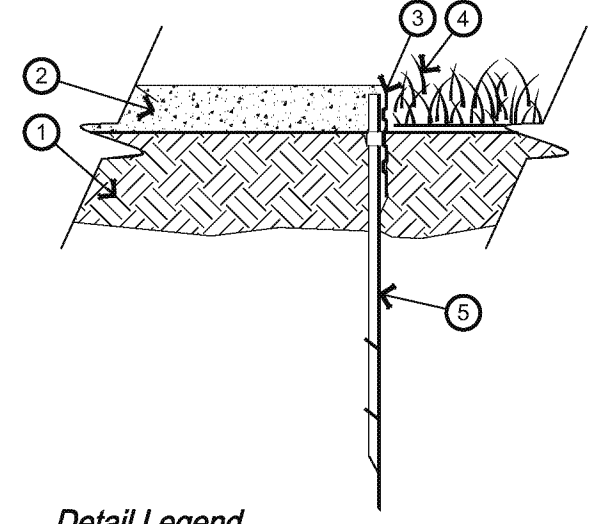

- Detail Legend**
- NATIVE SOIL
 - GROUND COVER, 2" ROCK MULCH SEE CONST. PLAN
 - PERMALOC CLEANLINE ALUMINUM LANDSCAPE BED EDGING
 - GROUND COVER, SEE PLANTING PLAN
 - ALUMINUM STAKES, 12" LOCK INTO PREFORMED LOOPS ON EDGING.
- NOTES:
1. 16-0 (4.9M) SECTIONS TO INCLUDE (5) 12" (30.5) ALUMINUM STAKES.
2. COMPACT GRADES ADJACENT TO EDGING TO AVOID SETTLING. FINISH GRADE TO BE 1/2" (1.3CM) BELOW TOP OF EDGING.
3. CORNERS - CUT BASE OF EDGING UP HALF WAY AND FORM A CONTINUOUS CORNER.
4. PERMALOC CLEANLINE AS MANUFACTURED BY PERMALOC CORPORATION, HOLLAND MI. (800) 356-9660, (616) 399-9600.
5. EDGING SIZE 1/2" X 4" MILL FINISH (NATURAL ALUMINUM).

F Aluminum Landscape Bed Edging N.T.S.

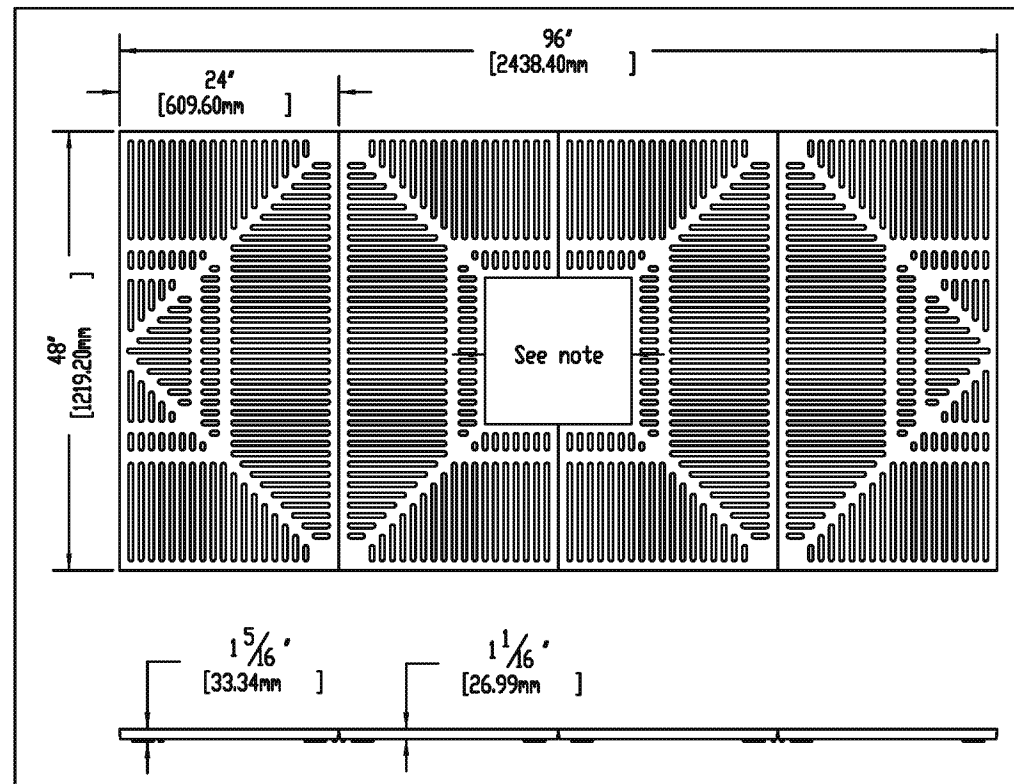

4836x2
ADA Tree Grate
48" x 96"
tree grate in four sections.
1/2" maximum slot opening for ADA compliance and pedestrian safety.
Cast from 100% recycled iron, aluminum, or bronze for pedestrian loads only.
Tree opening: 12", 22"
Grates can be ordered with or later expanded to these openings.
Finish: Unfinished, or Black Dip, or Enamel Paint, or Polyurethane Paint, or Powder Coat.
Zinc undercoat available.
Specify finish and color.
Use Frame Model: 4836x2F
Weight: Iron=440 Lb / 200kg, Aluminum=150 Lb / 68kg

NO NET SCALE DRAWING

IRONSMTIH
41-701 Corporate Way #3
Palm Desert, CA 92260
(800) 338-4766
(760) 776-5080 Fax

G 48" X 96" Tree Grate N.T.S.

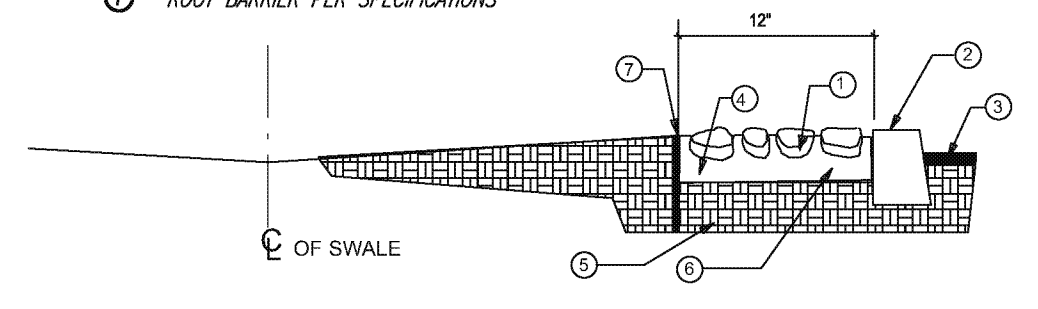

H Grouted Cobblestone Band N.T.S.

CORNERSTONE STUDIOS, INC.
106 W. 4th St. 5th Floor 714. 973. 2200 Voice
Sanita Ariza, CA 92701 714. 973. 0203 Fax
LANDSCAPE ARCHITECTURE • URBAN DESIGN • PLANNING • RESOURCE ANALYSIS

AECOM
AECOM Technical Services, Inc.
515 S. FLOWER ST., 4th FLOOR
LOS ANGELES, CA 90071
T 213.330.7200 F 213.330.7201
www.aecom.com

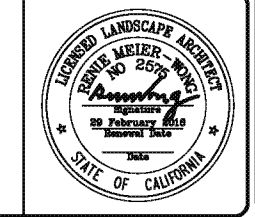

| REVISIONS | | |
|-----------|------|-------------|
| MARK | DATE | DESCRIPTION |
| | | |

CITY OF INGLEWOOD, CALIFORNIA
PUBLIC WORKS DEPARTMENT

PROJECT TITLE:
PLANS FOR IMPROVEMENT OF CENTURY BOULEVARD DOTY AVE TO INGLEWOOD AVE
PLANTING DETAILS 1 OF 2

DESIGNED BY: _____
DRAWN BY: _____
CHECKED BY: _____

SUBMITTED BY / APPROVED BY:

ELOY M. CASTILLO, RCE #9100 / PRINCIPAL CIVIL ENGINEER

DATE: **5/18/2015**

PLAN NO.: **LP-203**
SHEET NO.: **48 OF 67**