

ARCH: 38" x 48"



PROJECT
PROJECT CONDOR,
INGLEWOOD CALIFORNIA



DEVELOPER
**MURPHY'S BOWL
LLC**
10400 NE 4TH ST, SUITE 3000
BELLEVUE, WA 98004
DEVELOPER'S MANAGING AGENT
WILSON MEANY
8701 Center Drive, Suite 950
Los Angeles, CA 90045
310.382.8000
http://wilsonmeany.com/

ARCHITECT / PLANNING /
ENGINEERING / TRANSPORTATION

AECOM
AECOM TECHNICAL SERVICES, INC
2380 McGee, Suite 200
Kansas City, MO 64108
816.861.4443 tel 816.561.2863 fax
www.aecom.com

CIVIL ENGINEER
**D&D
ENGINEERING, INC**
8901 S. La Cienega Blvd. Suite 106
Inglewood, CA 90501
494.393.4122 tel

DRY UTILITY SYSTEMS
**BJ PALMER &
ASSOCIATES, INC**
28245 Crocker Avenue
Valencia, CA 91355
760.842.7510 tel

PARKING
**WALKER
CONSULTANTS**
606 S. Olive St, Suite 1100
Los Angeles, CA 90014
213.488.4911 tel

SHORING ENGINEER
**DRS
ENGINEERING, INC**
3584 Sagunto Street, Suite 468
Santa Ynez, CA 93460
818.402.3962 tel

REGISTRATION
This drawing has been prepared for the use of AECOM's client and may not be used, reproduced or relied upon by third parties, except as agreed by AECOM and its client, as required by law or for use by governmental reviewing agencies. AECOM accepts no responsibility, and denies any liability whatsoever, to any party that modifies this drawing without AECOM's express written consent. Do not scale this document. All measurements must be obtained from the stated dimensions.

**NOT FOR
CONSTRUCTION**

ISSUE/REVISION

NO.	DATE	DESCRIPTION

KEY PLAN



PROJECT NUMBER

SHEET TITLE
SITE PLAN

SHEET NUMBER

P101A
© 2015 AECOM TECHNICAL SERVICES, INC

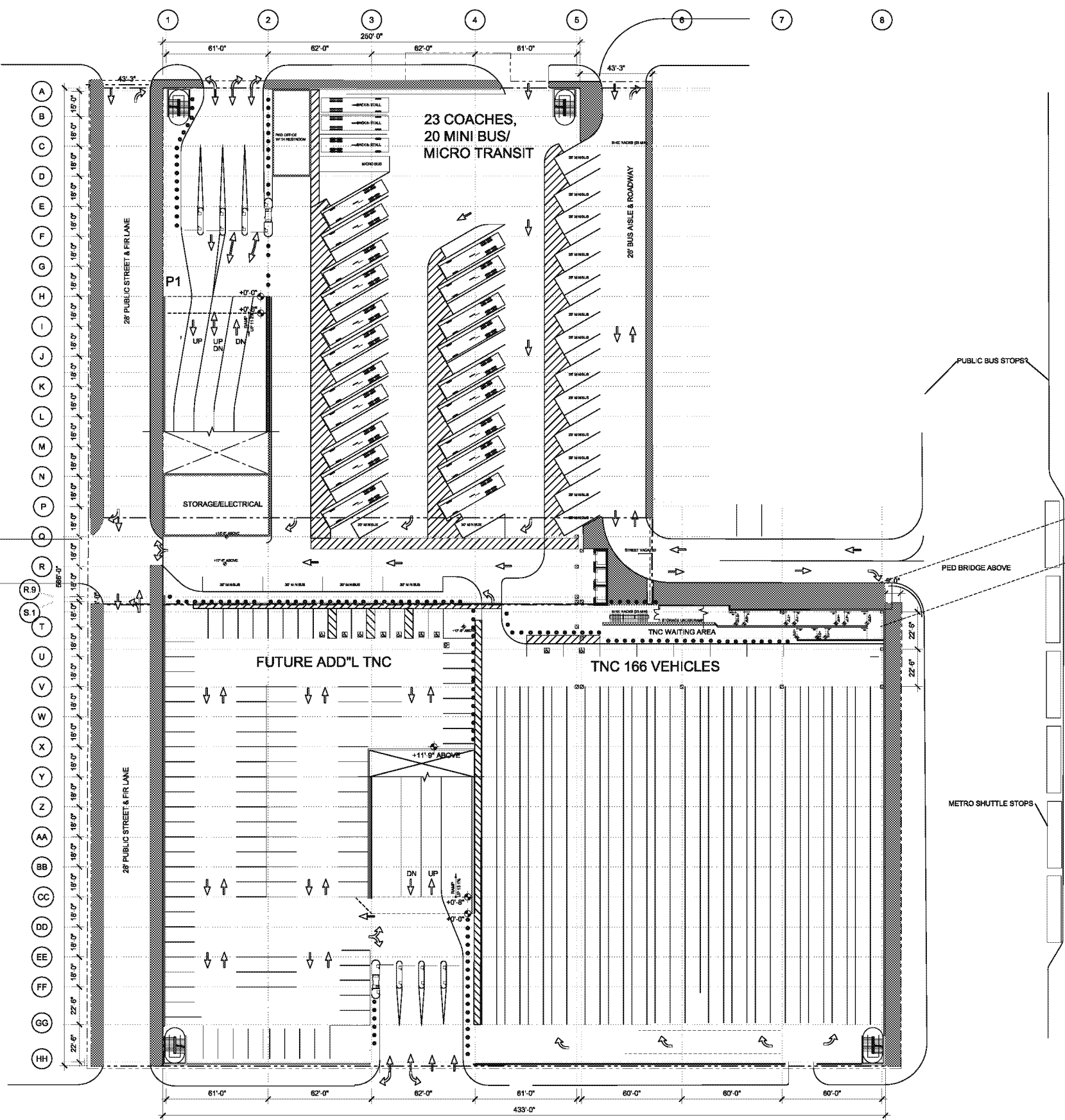

Project Management Initials
Last Printed
Filename

Printed on Post Consumer
Recycled Content Paper



DEVELOPER
MURPHY'S BOWL LLC
10400 NE 4TH ST, SUITE 3000
BELLEVUE, WA 98004

DEVELOPER'S MANAGING AGENT
WILSON MEANY
6701 Center Drive, Suite 050
Los Angeles, CA 90045
310.352.0000 tel
http://wilsonmeany.com/

ARCHITECT / PLANNING /
ENGINEERING / TRANSPORTATION
AECOM

AECOM TECHNICAL SERVICES, INC.
2380 McGee, Suite 200
Kansas City, MO 64108
816.951.4443 tel / 816.561.2863 fax
www.aecom.com

CIVIL ENGINEER
D&D ENGINEERING, INC
8801 S. La Cienega Blvd, Suite 106
Inglewood, CA 90301
424.393.4122 tel

DRY UTILITY SYSTEMS
BJ PALMER & ASSOCIATES, INC
28245 Crocker Avenue
Valencia, CA 91355
760.842.7510 tel

PARKING
WALKER CONSULTANTS
606 S. Olive St, Suite 1100
Los Angeles, CA 90014
213.458.4911 tel

SHORING ENGINEER
DRS ENGINEERING, INC
3584 Sagunto Street, Suite 488
Santa Ynez, CA 93480
818.402.3982 tel

CAR COUNT
9'-0" 90' STANDARD SPACE

TIER	TEAM	STANDARD	CAR ACCESSIBLE	VAN ACCESSIBLE	EVCS EQUIPPED (3%)	EVCS READY (6%)	EV AMB ACCESSIBLE	EV CAR ACCESSIBLE	EV VAN ACCESSIBLE	TOTAL	AREA (SQ FT)	EFFICIENCY (SQ FT/STALL)
P1 (+90'-9")		50	1	2	13	26	2	1	1	98	35800	374
TEAM @ P1	87		3	1		6	1	1	1	100	34870	348
P2 (+102'-3")		223	1	1		0				225	73012	324
P3 (+113'-8")		227	1	1		0				229	70772	309
TOTAL	87	500	6	5	13	32	3	2	2	650	214,554	330

3% EVCS AT OPENING DAY = 19 TOTAL ALLOCATED AS 3 TEAM (ALL ACCESSIBLE) & 16 VIP
+5% (6% TOTAL) EVCS READY = 33 (52 TOTAL) ALLOCATED AS 6 ADD'L TEAM REST VIP
SAME ACCESSIBLE REQUIRED FOR BOTH OPENING DAY AND 6% TOTAL
1 VAN, 3 CAR, 3 AMBULATORY ALLOCATED TO TEAM 1 @ VAN, CAR & AMBULATORY
REST TO VIP, BUT CHANGED 1 CAR TO VAN SO HAVE 1 VAN, 1 CAR AND 2 AMB.
REMAINING SPACES AT OPENING DAY = 650 - 52 = 598 SPACES
91 TEAM REQUIRES 1 VAN AND 3 CAR ACCESSIBLE
507 VIP REQUIRES 2 VAN AND 9 CAR ACCESSIBLE

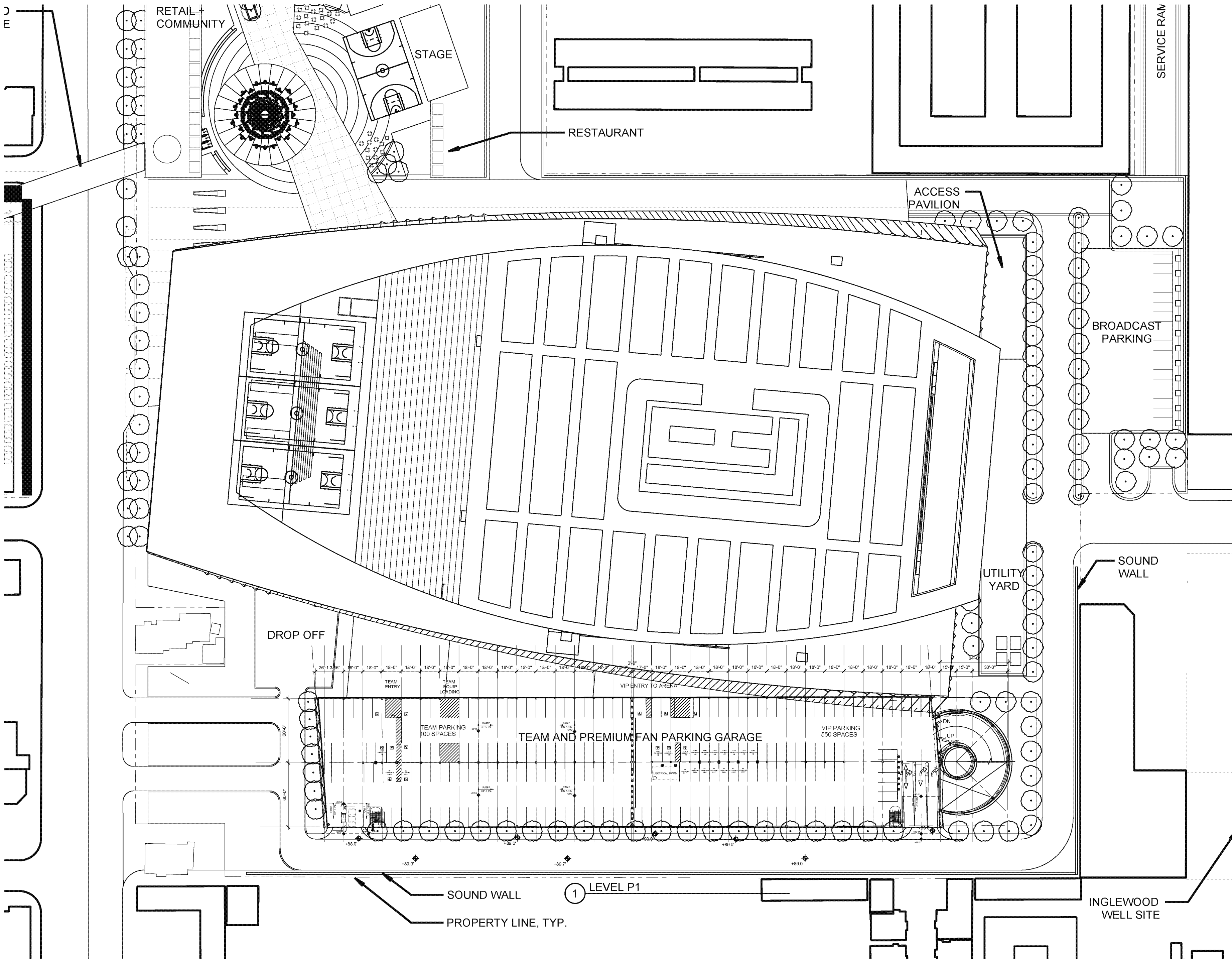

REGISTRATION
This drawing has been prepared for the use of AECOM's client and may not be used, reproduced or relied upon by third parties, except as agreed by AECOM and its client, as required by law or for use by governmental reviewing agencies. AECOM accepts no responsibility, and denies any liability whatsoever, to any party that modifies this drawing without AECOM's express written consent. Do not scale this document. All measurements must be obtained from the stated dimensions.

NOT FOR CONSTRUCTION
ISSUE/REVISION

DATE	DESCRIPTION
SEP 12, 2018	CONCEPT DESIGN

KEY PLAN



PROJECT NUMBER
60545923

SHEET TITLE
SITE PLAN

SHEET NUMBER
P201A

ARCH: 36" x 48"
 Project Management Initials:
 Lead Planner:
 File Name:
 Project: Proj-Condor
 Revised: Corrected Paper



DEVELOPER
MURPHY'S BOWL LLC
 10400 NE 4TH ST, SUITE 3000
 BELLEVUE, WA 98004

DEVELOPER'S MANAGING AGENT
WILSON MEANY
 6701 Center Drive, Suite 950
 Los Angeles, CA 90045
 310.382.8500 tel
 http://wilsonmeany.com/

ARCHITECT / PLANNING / ENGINEERING / TRANSPORTATION

AECOM
 AECOM TECHNICAL SERVICES, INC.
 2380 McCain, Suite 200
 Kansas City, MO 64108
 816.561.4443 tel 816.561.2863 fax
 www.aecom.com

CIVIL ENGINEER
D&D ENGINEERING, INC
 8901 S. La Cienega Blvd. Suite 106
 Inglewood, CA 90501
 494.393.4122 tel

DRY UTILITY SYSTEMS
BJ PALMER & ASSOCIATES, INC
 28245 Crocker Avenue
 Valencia, CA 91355
 760.842.7510 tel

PARKING
WALKER CONSULTANTS
 606 S. Olive St, Suite 1100
 Los Angeles, CA 90014
 213.488.4911 tel

SHORING ENGINEER
DRS ENGINEERING, INC
 3564 Sagunto Street, Suite 488
 Santa Ynez, CA 93460
 818.402.3992 tel

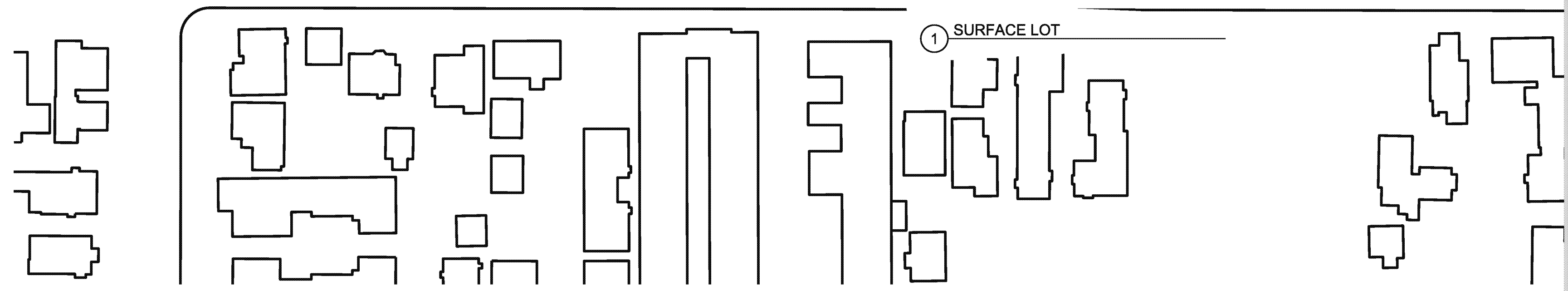
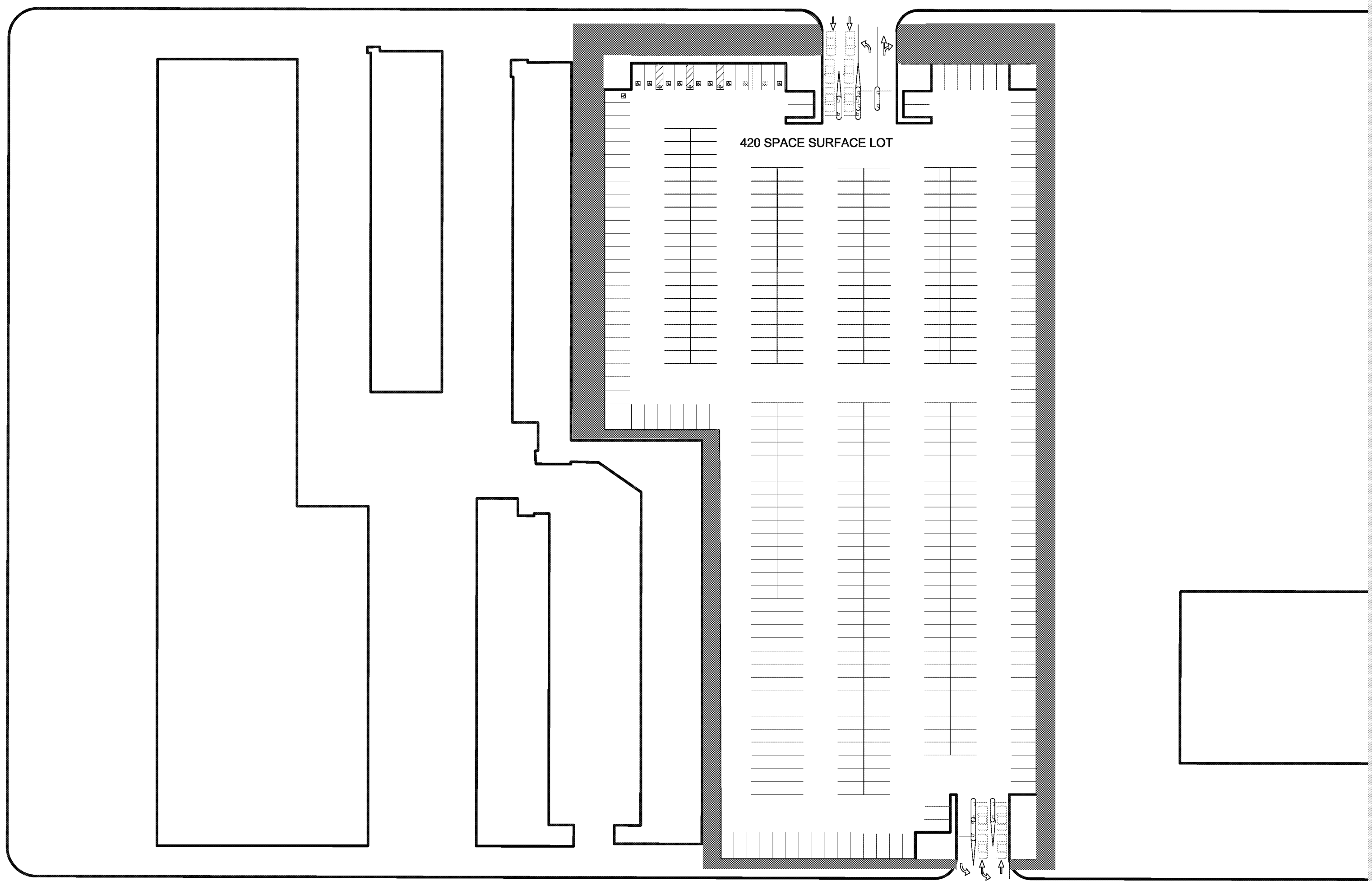

REGISTRATION
 This drawing has been prepared for the use of AECOM's client and may not be used, reproduced or relied upon by third parties, except as agreed by AECOM and its client, as required by law or for use by governmental reviewing agencies. AECOM accepts no responsibility, and denies any liability whatsoever, to any party that modifies this drawing without AECOM's express written consent. Do not scale this document. All measurements must be obtained from the stated dimensions.

NOT FOR CONSTRUCTION

ISSUE/REVISION

ISSUE/REVISION	DATE	DESCRIPTION

KEY PLAN



PROJECT NUMBER
60545923

SHEET TITLE
SITE PLAN

SHEET NUMBER