

CURVE DATA TABLE				
No.	RADIUS	DELTA	LENGTH	TANGENT
1	600.00'	30°18'13" RT	317.34'	162.47'
2	1.75'	164°48'43" LT	5.03'	13.13'
3	609.50'	2°53'19" RT	30.73'	15.37'
4	600.00'	2°53'19" RT	30.25'	15.13'
5	4.75'	180°00'00" LT	14.92'	-
6	25.00'	111°40'27" LT	48.73'	36.84'
7	55.00'	53°09'58" LT	51.03'	27.52'
8	40.00'	70°41'27" LT	49.35'	28.37'
9	35.00'	69°57'07" RT	42.73'	24.49'
10	1500.00'	29°52'29" LT	782.12'	400.16'

- NOTES:**
- SEE TRAFFIC SIGNAL (TS) PLANS FOR TRAFFIC SIGNAL POLE LOCATIONS.
 - SEE SIGNING AND STRIPING (GEO) PLANS FOR CROSSWALK LOCATIONS.
 - SEE A.2-AERIAL GUIDEWAY STRUCTURES - STRUCTURAL (S) PLANS FOR BRIDGE LOCATION AND WORK DETAILS.
 - SB TRACK IS TRACK 3 AND NB TRACK IS TRACK 4.
 - SEE STREET LIGHTING (CL) PLANS FOR IMPROVEMENTS TO STREET LIGHTING.
 - FOR TYPICAL SECTION INFORMATION, SEE DWG CX-B1-107.
 - FOR RAISED MEDIAN ISLAND DETAILS, SEE DETAIL "D" ON CDT-B1-119.
 - FOR DRAINAGE MODIFICATION (CD), SEE DWG CD-B1-105.
 - SEE PLANTING (LP) PLANS FOR PROPOSED LANDSCAPING IMPROVEMENTS AND IMPACTS OF EXISTING LANDSCAPING AREAS
 - FOR ADDITIONAL BACK OF WALK ELEVATIONS, SEE DWG CDT-B1-106.
 - CONTRACTOR TO VERIFY ELEVATIONS OF EXISTING SURFACE PRIOR TO CONSTRUCTION.

CONSTRUCTION NOTES

- REMOVE EXISTING CURB
- REMOVE EXISTING CURB & GUTTER
- REMOVE EXISTING SIDEWALK/ DRIVEWAY APPROACH/ CURB RAMP
- REMOVE EXISTING CONCRETE PAVEMENT
- REMOVE EXISTING ASPHALT CONCRETE PAVEMENT
- REMOVE EXISTING CRUSHED MISCELLANEOUS BASE
- REMOVE EXISTING CURB DRAIN GRATE INLET
- REMOVE EXISTING STREET LIGHT
- REMOVE EXISTING STREET SIGN AND POST
- REMOVE EXISTING MEDIAN CONCRETE PAVERS
- SAWCUT/ JOIN EXISTING PAVEMENT
- ADJUST EXISTING WATER METER TO GRADE
- ADJUST EXISTING STREET LIGHTING PULL BOX TO GRADE
- ADJUST EXISTING TRAFFIC SIGNAL PULL BOX TO GRADE
- ADJUST EXISTING COMMUNICATION PULL BOX TO GRADE

CONSTRUCTION NOTES CONT'D

- ADJUST EXISTING GAS VALVE TO GRADE
- REMOVE EXISTING TRAFFIC SIGNAL POLE
- EXISTING POWER POLE TO BE RELOCATED BY OTHERS
- RELOCATE EXISTING TRAFFIC SIGNAL CABINET
- ADJUST EXISTING SEWER MAINTENANCE HOLE TO GRADE
- CONSTRUCT CURB TYPE A1 PER SPPWC STD PLAN 120-2, "CF" PER PLAN
- CONSTRUCT CURB AND GUTTER TYPE A2 PER SPPWC STD PLAN 120-2, "CF" PER PLAN
- CONSTRUCT 4" THICK PCC SIDEWALK, JOINTS PER SPPWC STD. PLAN 112-2
- INSTALL PCC CONCRETE PAVEMENT, THICKNESS SHOWN ON TYPICAL SECTION
- INSTALL A.C. PAVEMENT SECTION, THICKNESS SHOWN ON TYPICAL SECTION
- INSTALL CRUSHED MISCELLANEOUS BASE (CMB) OVER COMPACTED NATIVE, THICKNESS SHOWN ON TYPICAL SECTION
- CONSTRUCT CURB RAMP PER SPPWC STD. PLAN 111-5, "CASE, TYPE, X & Y" PER PLAN
- CONSTRUCT MEDIAN FLARE PER SPPWC STD. PLAN 141-2
- INSTALL STAMPED CONCRETE WITHIN RAISED MEDIAN PER PLANTING (LP) PLANS FOR HARDSCAPING IMPROVEMENTS
- RELOCATE EXISTING STREET LIGHTING PULL BOX
- RELOCATE EXISTING TRAFFIC SIGNAL PULL BOX
- EXISTING CURB & GUTTER TO REMAIN IN PLACE
- EXISTING CONCRETE SIDEWALK TO REMAIN IN PLACE
- EXISTING ASPHALT CONCRETE PAVEMENT TO REMAIN IN PLACE
- EXISTING SIGN MONUMENT TO REMAIN IN PLACE
- EXISTING FIRE HYDRANT TO REMAIN IN PLACE
- EXISTING STREET SIGN AND POST TO REMAIN IN PLACE
- EXISTING SIGN AND POST TO REMAIN IN PLACE
- EXISTING TREE TO REMAIN IN PLACE
- EXISTING MEDIAN TO REMAIN IN PLACE
- EXISTING MAINTENANCE HOLE TO REMAIN IN PLACE
- EXISTING STREET LIGHTING PULL BOX TO REMAIN IN PLACE
- EXISTING TRAFFIC SIGNAL PULL BOX TO REMAIN IN PLACE
- EXISTING ELECTRICAL VAULT TO REMAIN IN PLACE
- EXISTING IRRIGATION CONTROL VALVE (ICV) TO REMAIN IN PLACE
- EXISTING STREET LIGHTING POLE TO REMAIN IN PLACE
- EXISTING POWER POLE TO REMAIN IN PLACE
- EXISTING CONCRETE BLOCK COLUMN TO REMAIN IN PLACE
- CONSTRUCT TREE WELL PER PLANTING (LP) PLANS, DIMENSIONS PER PLAN
- REMOVE EXISTING CATCH BASIN
- CONSTRUCT CURB OPENING CATCH BASIN PER SPPWC STD. PLAN 300-3; H, V & W PER PLAN
- EXISTING LOCAL DEPRESSION TO REMAIN IN PLACE
- EXISTING CATCH BASIN TO REMAIN IN PLACE
- EXISTING STORM DRAIN MANHOLE TO REMAIN IN PLACE
- EXISTING GRATE INLET TO REMAIN IN PLACE
- CONSTRUCT LOCAL DEPRESSION PER SPPWC STD. PLAN 313-3

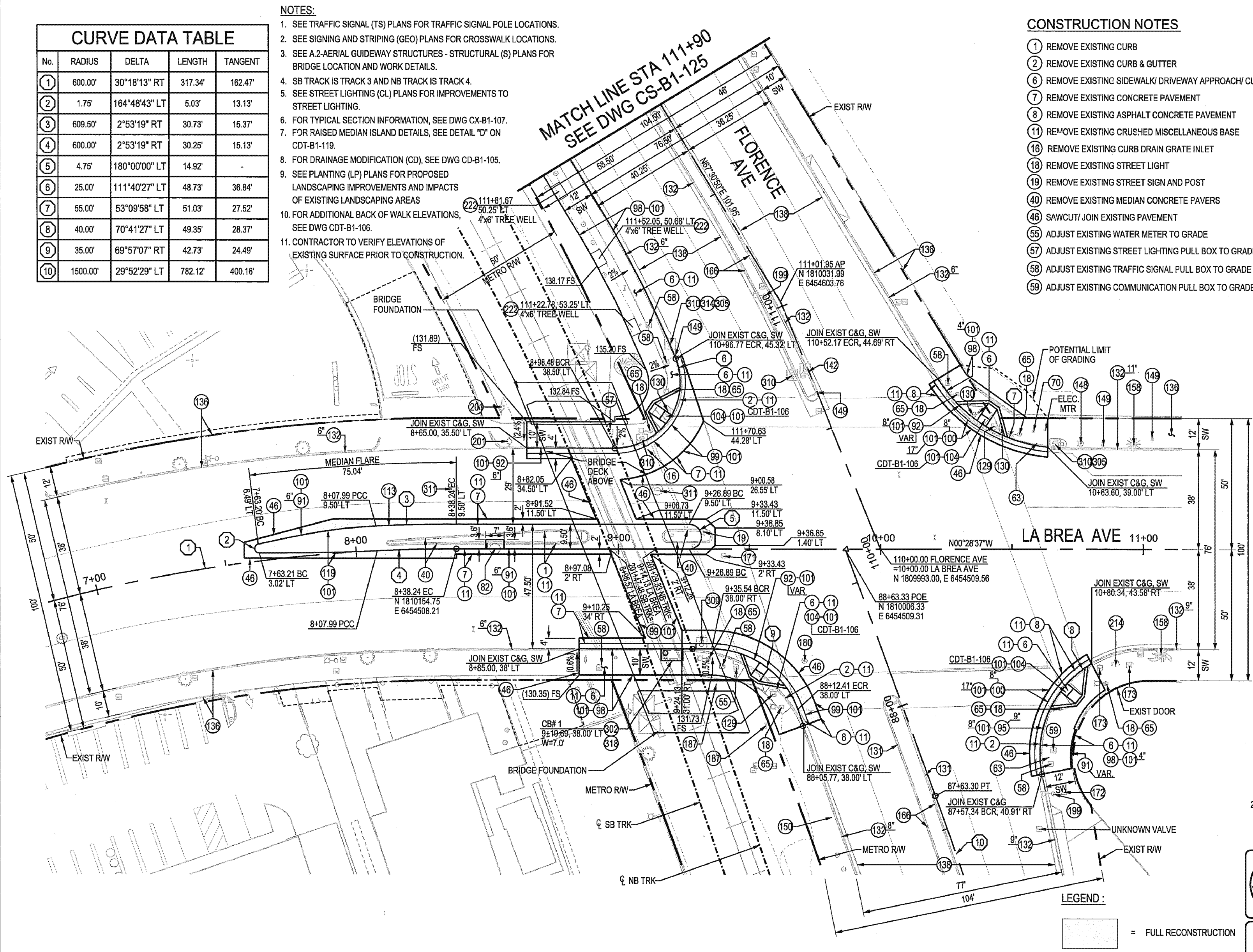
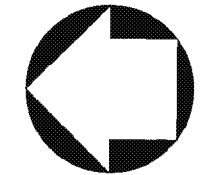

CRENSHAW/LAX TRANSIT CORRIDOR DESIGN/BUILD

APPROVED

APPROVED AS NOTED, NO RESUBMITTAL REQUIRED

REJECTED, REVISE AND RESUBMIT

RECORD ONLY

Director, Construction MGR / Engineer: *Mark Van Sledright* Date: 1/20/16

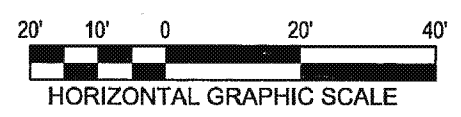

PACKAGE B-1.5
APPROVED FOR CONSTRUCTION SUBMITTAL

CITY OF INGLEWOOD, CALIFORNIA
PUBLIC WORKS DEPARTMENT

SUBMITTED BY/APPROVED BY: *[Signature]* 1-19-16
ELDY CASTILLO, P.E. CS9100, PRINCIPAL CIVIL ENGINEER

CRENSHAW/LAX TRANSIT CORRIDOR PROJECT
SEGMENT B1 - STREET MODIFICATION PLAN
LA BREA AVE AT FLORENCE AVE

CONTRACT NO. **C0988**

DRAWING NO. **CS-B1-123** REV **0**

SCALE **1" = 20'**

SHEET NO.

THE PREPARATION OF THIS DRAWING HAS BEEN FINANCED IN PART THROUGH A GRANT FROM THE U.S. DEPARTMENT OF TRANSPORTATION, FEDERAL TRANSIT ADMINISTRATION (FTA), UNDER THE FEDERAL TRANSIT ACT OF 1964, AS AMENDED, AND IN PART BY THE TAXES OF THE CITIZENS OF LOS ANGELES COUNTY AND OF THE STATE OF CALIFORNIA.

REV	DATE	BY	APP	REG NO	EXPIRES	SEAL HOLDER	DESCRIPTION
0	1/15/16						AFC SUBMITTAL

DESIGNED BY: **MANUEL BARRIOS**
DRAWN BY: **RUBEN VENEGAS**
CHECKED BY: **RAVI PUDIPEDDI**
IN CHARGE: **NOAH BUSCH**
DATE: **1/15/2016**

LOS ANGELES COUNTY METROPOLITAN TRANSPORTATION AUTHORITY
Metro

WALSH-SHEA CORRIDOR CONSTRUCTORS
1777 Oakland Blvd.
Walnut Creek, CA 94596

HNTB

V&A INC.
330 S. HUNTING ST., SUITE 121
LOS ANGELES, CA 90013

THE CITY OF INGLEWOOD OR ITS OFFICERS OR AGENTS SHALL NOT BE RESPONSIBLE FOR THE ACCURACY OR COMPLETENESS OF ELECTRONIC COPIES OF THIS PLAN SHEET.

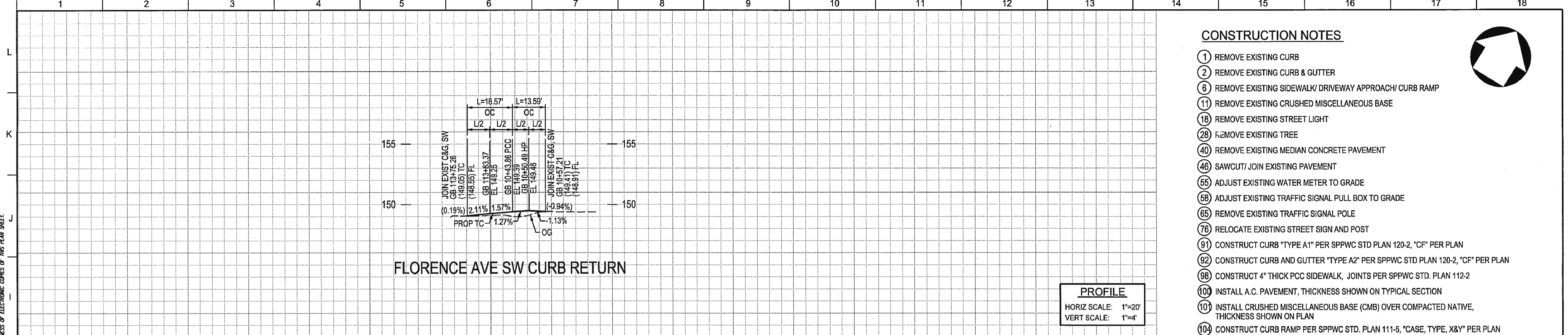

FLORENCE AVE SW CURB RETURN

PROFILE
 HORIZ SCALE: 1"=20'
 VERT SCALE: 1"=4'

CONSTRUCTION NOTES

- 1 REMOVE EXISTING CURB
- 2 REMOVE EXISTING CURB & GUTTER
- 6 REMOVE EXISTING SIDEWALK/ DRIVEWAY APPROACH/ CURB RAMP
- 11 REMOVE EXISTING CRUSHED MISCELLANEOUS BASE
- 18 REMOVE EXISTING STREET LIGHT
- 28 REMOVE EXISTING TREE
- 40 REMOVE EXISTING MEDIAN CONCRETE PAVEMENT
- 46 SAWCUT/ JOIN EXISTING PAVEMENT
- 55 ADJUST EXISTING WATER METER TO GRADE
- 58 ADJUST EXISTING TRAFFIC SIGNAL PULL BOX TO GRADE
- 65 REMOVE EXISTING TRAFFIC SIGNAL POLE
- 76 RELOCATE EXISTING STREET SIGN AND POST
- 91 CONSTRUCT CURB "TYPE A1" PER SPPWC STD PLAN 120-2, "CF" PER PLAN
- 92 CONSTRUCT CURB AND GUTTER "TYPE A2" PER SPPWC STD PLAN 120-2, "CF" PER PLAN
- 98 CONSTRUCT 4" THICK PCC SIDEWALK, JOINTS PER SPPWC STD. PLAN 112-2
- 101 INSTALL A.C. PAVEMENT, THICKNESS SHOWN ON TYPICAL SECTION
- 101 INSTALL CRUSHED MISCELLANEOUS BASE (CMB) OVER COMPACTED NATIVE, THICKNESS SHOWN ON PLAN
- 104 CONSTRUCT CURB RAMP PER SPPWC STD. PLAN 111-5, "CASE, TYPE, X&Y" PER PLAN
- 119 INSTALL STAMPED CONCRETE WITHIN RAISED MEDIAN PER PLANTING (LP) PLANS FOR HARDSCAPING IMPROVEMENTS
- 131 RELOCATE EXISTING TRAFFIC SIGNAL PULL BOX
- 132 EXISTING CURB & GUTTER TO REMAIN IN PLACE
- 136 EXISTING ASPHALT CONCRETE PAVEMENT TO REMAIN IN PLACE
- 139 EXISTING DRIVEWAY APPROACH TO REMAIN IN PLACE
- 165 EXISTING GUY WIRE TO REMAIN IN PLACE
- 166 EXISTING MEDIAN TO REMAIN IN PLACE
- 171 EXISTING TELEPHONE MAINTENANCE HOLE TO REMAIN IN PLACE
- 172 EXISTING STREET LIGHTING PULL BOX TO REMAIN IN PLACE
- 174 EXISTING COMMUNICATIONS PULL BOX TO REMAIN IN PLACE
- 183 EXISTING WATER METER TO REMAIN IN PLACE
- 201 EXISTING TRAFFIC SIGNAL POLE TO REMAIN IN PLACE
- 201 EXISTING POWER POLE TO REMAIN IN PLACE
- 213 EXISTING LANDSCAPE AREA TO REMAIN IN PLACE
- 222 CONSTRUCT TREE WELL PER PLANTING (LP) PLANS, DIMENSIONS PER PLAN
- 305 EXISTING LOCAL DEPRESSION TO REMAIN IN PLACE
- 310 EXISTING CATCH BASIN TO REMAIN IN PLACE
- 311 EXISTING STORM DRAIN MANHOLE TO REMAIN IN PLACE

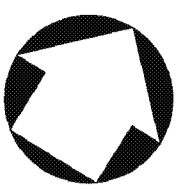

CURVE DATA TABLE				
No.	RADIUS	DELTA	LENGTH	TANGENT
1	23.00'	46°14'25" RT	18.57'	9.82'
2	36.00'	21°37'29" RT	13.59'	6.88'
3	17.00'	73°16'43" RT	21.74'	12.64'

CRENSHAW/LAX TRANSIT CORRIDOR DESIGN/BUILD

APPROVED

APPROVED AS NOTED, NO RESUBMITTAL REQUIRED

REJECTED, REVISE AND RESUBMIT

RECORD ONLY

Director, Construction MGR / Engineer: *Mark Van Sessel* Date: *1/19/16*



- NOTES:**
1. SEE TRAFFIC SIGNAL (TS) PLANS FOR TRAFFIC POLE LOCATIONS.
 2. SEE SIGNING AND SIGNAL (GEO) PLANS FOR CROSSWALK LOCATIONS.
 3. SB TRACK IS TRACK 3 AND NB TRACK IS TRACK 4.
 4. SEE STREET LIGHTING (CL) PLANS FOR IMPROVEMENTS TO STREET LIGHTING.
 5. FOR TYPICAL SECTION INFORMATION, SEE DWG CX-B1-105.
 6. FOR DRAINAGE MODIFICATIONS (CD), SEE DWG CD-B1-106.
 7. SEE PLANTING (LP) PLANS FOR PROPOSED LANDSCAPING IMPROVEMENTS AND IMPACTS TO EXISTING LANDSCAPING AREAS
 8. FOR CURB RAMP & MEDIAN DETAILS, SEE DWG CDT-B1-106A.

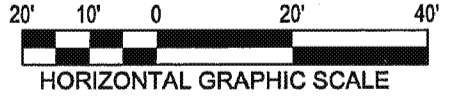

PACKAGE B-1.5
 APPROVED FOR CONSTRUCTION SUBMITTAL

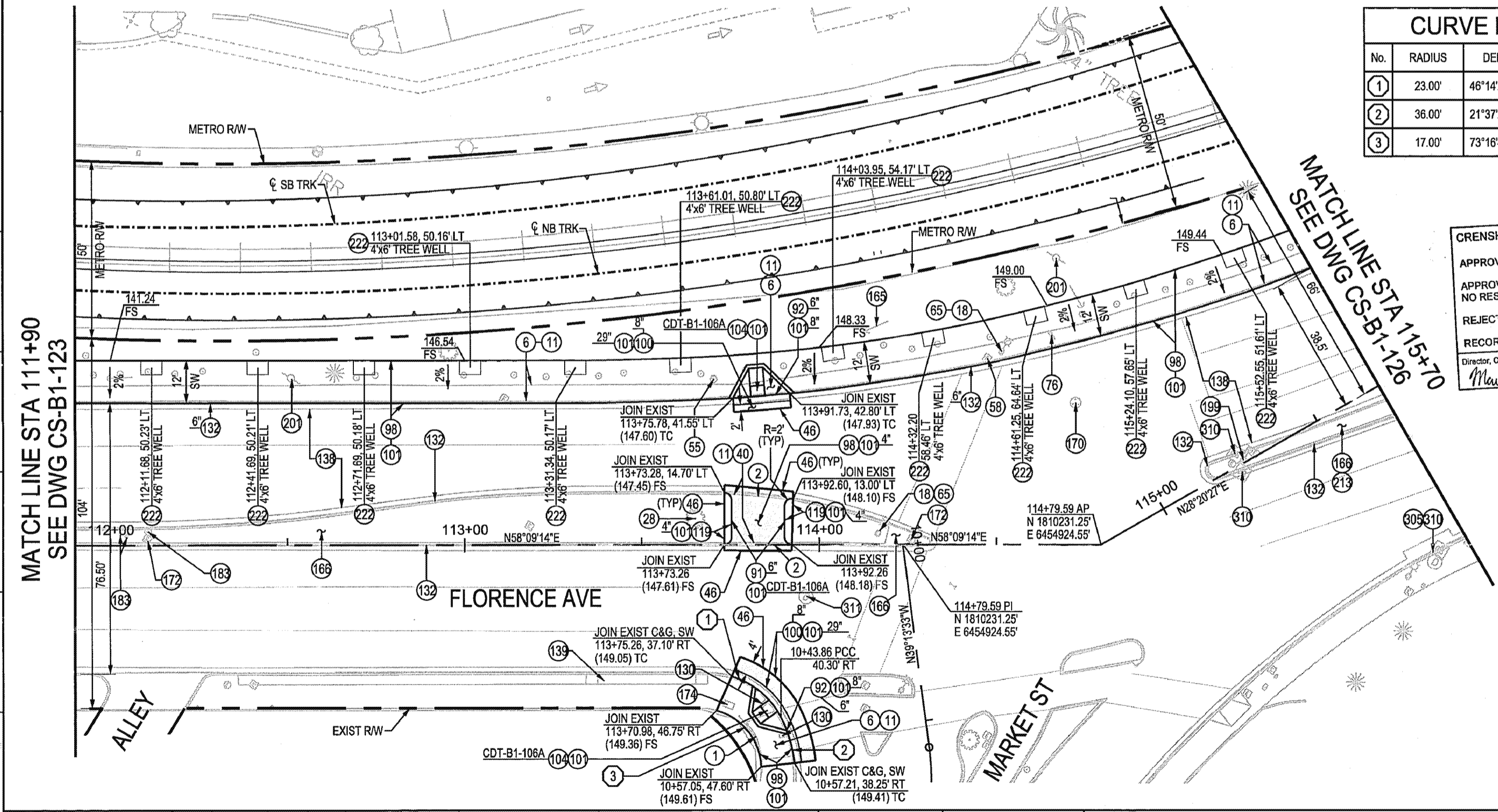

THE PREPARATION OF THIS DRAWING HAS BEEN FINANCED IN PART THROUGH A GRANT FROM THE U.S. DEPARTMENT OF TRANSPORTATION, FEDERAL TRANSIT ADMINISTRATION (FTA), UNDER THE FEDERAL TRANSIT ACT OF 1984, AS AMENDED, AND IN PART BY THE TAXES OF THE CITIZENS OF LOS ANGELES COUNTY AND OF THE STATE OF CALIFORNIA.		DESIGNED BY MANUEL BARRIOS					
		DRAWN BY DAVID PARDEZ					
		CHECKED BY RAVI PUDIPEDDI					
		IN CHARGE NOAH BUSCH					
REV	DATE	BY	APP	REG NO	EXPIRES	SEAL HOLDER	DESCRIPTION
0	1/15/16						AFC SUBMITTAL

LOS ANGELES COUNTY METROPOLITAN TRANSPORTATION AUTHORITY

Metro

WALSH-SHEA CORRIDOR CONSTRUCTORS
 1777 Oakland Blvd.
 Walnut Creek, CA 94596

HNTB

W&A INC.
 330 S. HIGHT ST., SUITE 121
 LOS ANGELES, CA 90013

CITY OF INGLEWOOD, CALIFORNIA PUBLIC WORKS DEPARTMENT

SUBMITTED BY/APPROVED BY: *[Signature]* **1-19-16**

ELIJO CASTILLO, P.E. C8910, PRINCIPAL CIVIL ENGINEER

CRENSHAW/LAX TRANSIT CORRIDOR PROJECT

SEGMENT B1 - STREET IMPROVEMENTS
 FLORENCE AVE AT MARKET ST

CONTRACT NO. **C0988**

DRAWING NO. **CS-B1-125** REV **0**

SCALE: **1" = 20'**

SHEET NO.

THE CITY OF INGLEWOOD OR ITS OFFICERS OR AGENTS SHALL NOT BE RESPONSIBLE FOR THE ACCURACY OR COMPLETENESS OF ELECTRONIC COPIES OF THIS PLAN SHEET.

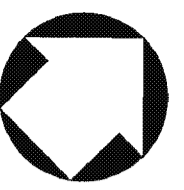

CONSTRUCTION NOTES

- 2 REMOVE EXISTING CURB & GUTTER
- 6 REMOVE EXISTING SIDEWALK/DRIVEWAY APPROACH/CURB RAMP
- 8 REMOVE EXISTING ASPHALT CONCRETE PAVEMENT
- 9 COLD PLANE EXISTING A.C. PAVEMENT, MAXIMUM 2"
- 11 REMOVE EXISTING CRUSHED MISCELLANEOUS BASE
- 14 REMOVE EXISTING WATER METER
- 18 REMOVE EXISTING STREET LIGHT
- 28 REMOVE EXISTING TREE
- 40 REMOVE EXISTING MEDIAN CONCRETE PAVEMENT
- 46 SAWCUT/JOIN EXISTING PAVEMENT
- 57 ADJUST EXISTING STREET LIGHTING PULL BOX TO GRADE
- 76 RELOCATE EXISTING STREET SIGN AND POST
- 80 RELOCATE EXISTING FIRE HYDRANT
- 81 ADJUST EXISTING STORM DRAIN MAINTENANCE HOLE TO GRADE
- 85 ADJUST EXISTING TELEPHONE MAINTENANCE HOLE TO GRADE
- 92 CONSTRUCT CURB AND GUTTER "TYPE A2" PER SPPWC STD. PLAN 120-2, "CF" PER PLAN
- 98 CONSTRUCT 4" THICK PCC SIDEWALK, JOINTS PER SPPWC STD. PLAN 112-2
- 100 INSTALL A.C. PAVEMENT SECTION, THICKNESS SHOWN ON TYPICAL SECTION
- 101 INSTALL CRUSHED MISCELLANEOUS BASE (CMB) OVER COMPACTED NATIVE, THICKNESS SHOWN ON TYPICAL SECTION
- 102 CONSTRUCT VARIABLE THICKNESS A.C. OVERLAY, MINIMUM 2"
- 112 CONSTRUCT MEDIAN TAPER PER SPPWC STD. PLAN 140-3
- 119 INSTALL STAMPED CONCRETE WITHIN RAISED MEDIAN
- 132 EXISTING CURB & GUTTER TO REMAIN IN PLACE
- 136 EXISTING CONCRETE SIDEWALK TO REMAIN IN PLACE
- 138 EXISTING ASPHALT CONCRETE PAVEMENT TO REMAIN IN PLACE
- 139 EXISTING DRIVEWAY APPROACH TO REMAIN IN PLACE
- 149 EXISTING STREET SIGN AND POST TO REMAIN IN PLACE
- 158 EXISTING TREE TO REMAIN IN PLACE
- 166 EXISTING MEDIAN TO REMAIN IN PLACE
- 174 EXISTING COMMUNICATIONS PULL BOX TO REMAIN IN PLACE
- 183 EXISTING WATER METER TO REMAIN IN PLACE
- 199 EXISTING STREET LIGHTING POLE TO REMAIN IN PLACE
- 222 CONSTRUCT TREE WELL PER PLANTING (LP) PLANS, DIMENSIONS PER PLAN
- 213 EXISTING LANDSCAPE AREA TO REMAIN IN PLACE
- 300 REMOVE EXISTING CATCH BASIN
- 318 CONSTRUCT LOCAL DEPRESSION PER SPPWC STD. PLAN 313-3
- 320 CONSTRUCT CURB SIDE GRATING CATCH BASIN PER SPPWC STD. PLAN 303-3; H, V & W PER PLAN

MATCH LINE STA 120+25
SEE DWG CS-B1-128

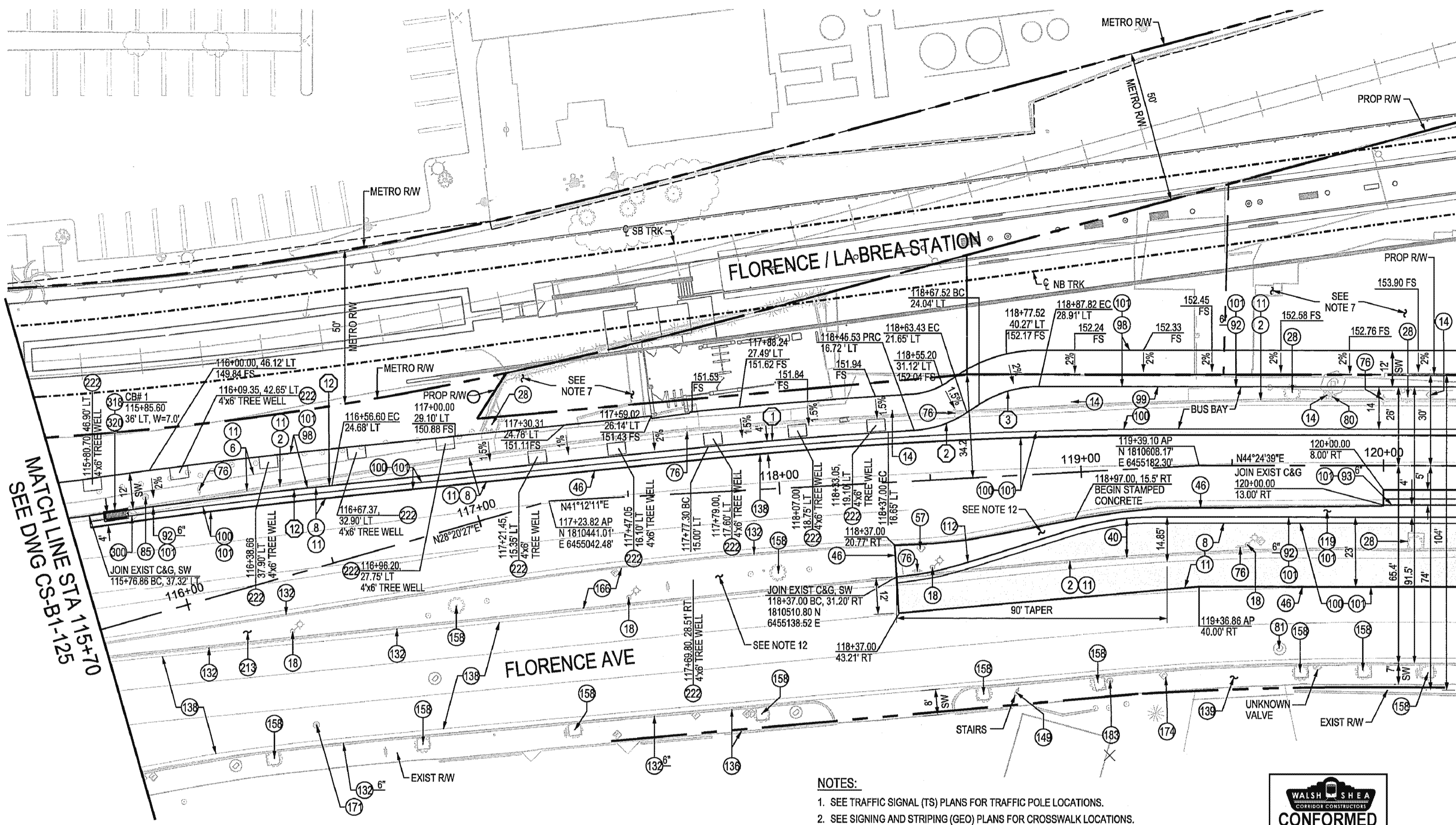

MATCH LINE STA 115+70
SEE DWG CS-B1-125

THE CITY OF INGLEWOOD OR ITS OFFICERS OR AGENTS SHALL NOT BE RESPONSIBLE FOR THE ACCURACY OR COMPLETENESS OF ELECTRONIC COPIES OF THIS PLAN SHEET

REVISIONS (ISSUANCE ONLY)

No.	RADIUS	DELTA	LENGTH	TANGENT
1	1514.00'	2°15'22" LT	59.62'	29.81'
2	36.00'	29°53'29" RT	18.78'	9.61'
3	36.00'	33°43'01" RT	21.18'	10.91'
12	2033.00'	2°16'32" RT	80.74'	40.38'

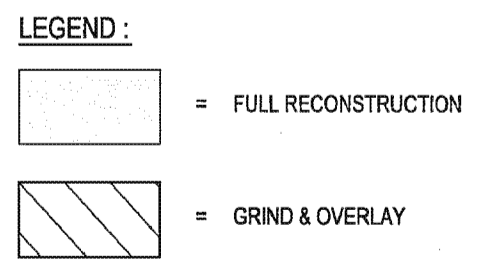

NOTES:

1. SEE TRAFFIC SIGNAL (TS) PLANS FOR TRAFFIC POLE LOCATIONS.
2. SEE SIGNING AND STRIPING (GEO) PLANS FOR CROSSWALK LOCATIONS.
3. SB TRACK IS TRACK 3 AND NB TRACK IS TRACK 4.
4. SEE STREET LIGHTING (CL) PLANS FOR IMPROVEMENTS TO STREET LIGHTING.
5. FOR TYPICAL SECTION INFORMATION, SEE DWG CX-B1-108.
6. FOR RAISED MEDIAN ISLAND DETAILS, SEE DETAIL "A" ON CDT-B1-121.
7. SEE PACKAGE B-1.4 STATIONS - STATION GRADING (CR) PLANS FOR GRADING IMPROVEMENTS WITHIN STATION AND PARK & RIDE AREA.
8. SEE PACKAGE B-1.4 STATIONS - ARCHITECTURAL (A) PLANS FOR STATION IMPROVEMENTS.
9. FOR ADDITIONAL BACK OF WALK ELEVATIONS, SEE PACKAGE B-1.4 STATIONS DWG CR-3004 & CR-3005.
10. SEE PACKAGE PW 23 - STATIONS LANDSCAPING FOR SURFACE TREATMENT WITHIN THE PLAZA AREA.
11. CONTRACTOR TO VERIFY ELEVATIONS OF EXISTING SURFACE PRIOR TO CONSTRUCTION.
12. SEE PLANTING (LP) PLANS FOR PROPOSED LANDSCAPING IMPROVEMENTS & IMPACTS OF EXISTING LANDSCAPING AREAS.



CRENSHAW/LAX TRANSIT CORRIDOR DESIGN/BUILD

APPROVED

APPROVED AS NOTED, NO RESUBMITTAL REQUIRED

REJECTED, REVISE AND RESUBMIT

RECORD ONLY

Director, Construction MGR / Engineer: *Mark Van Dessel* Date: *1/20/16*

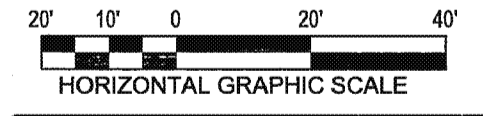

PACKAGE B-1.5
APPROVED FOR CONSTRUCTION
SUBMITTAL

**CITY OF INGLEWOOD, CALIFORNIA
PUBLIC WORKS DEPARTMENT**

SUBMITTED BY/ APPROVED BY: *[Signature]* 1-19-16
ELOY CASTILLO, P.E. C69100, PRINCIPAL CIVIL ENGINEER

THE PREPARATION OF THIS DRAWING HAS BEEN FINANCED IN PART THROUGH A GRANT FROM THE U.S. DEPARTMENT OF TRANSPORTATION, FEDERAL TRANSIT ADMINISTRATION (FTA), UNDER THE FEDERAL TRANSIT ACT OF 1994, AS AMENDED, AND IN PART BY THE TAXES OF THE CITIZENS OF LOS ANGELES COUNTY AND OF THE STATE OF CALIFORNIA.						DESIGNED BY MANUEL BARRIOS	
						DRAWN BY RUBEN VENEGAS	
						CHECKED BY RAVI PUDI PEDDI	
						IN CHARGE NOAH BUSCH	
0	1/15/16					DATE 1/15/2016	
REV	DATE	BY	APP	REG NO	EXPIRES	SEAL HOLDER	
						DESCRIPTION	
						AFC SUBMITTAL	

LOS ANGELES COUNTY METROPOLITAN TRANSPORTATION AUTHORITY
Metro

WALSH-SHEA CORRIDOR CONSTRUCTORS
1777 Oakland Blvd.
Walnut Creek, CA 94596

HNTB

V&A INC.
1330 S. HENRY ST., SUITE 121
LOS ANGELES, CA 90013

**CRENSHAW/LAX
TRANSIT CORRIDOR PROJECT
SEGMENT B1 - STREET MODIFICATION PLAN
FLORENCE AVE W/O LOCUST ST**

CONTRACT NO. C0988
DRAWING NO. CS-B1-126
SCALE: 1" = 20'
SHEET NO.



THE CITY OF INGLEWOOD OR ITS OFFICERS OR AGENTS SHALL NOT BE RESPONSIBLE FOR THE ACCURACY OR COMPLETENESS OF ELECTRONIC COPIES OF THIS PLAN SHEET.

MATCH LINE STA 124+50
SEE DWG CS-B1-128

MATCH LINE STA 128+50
SEE DWG CS-B1-133

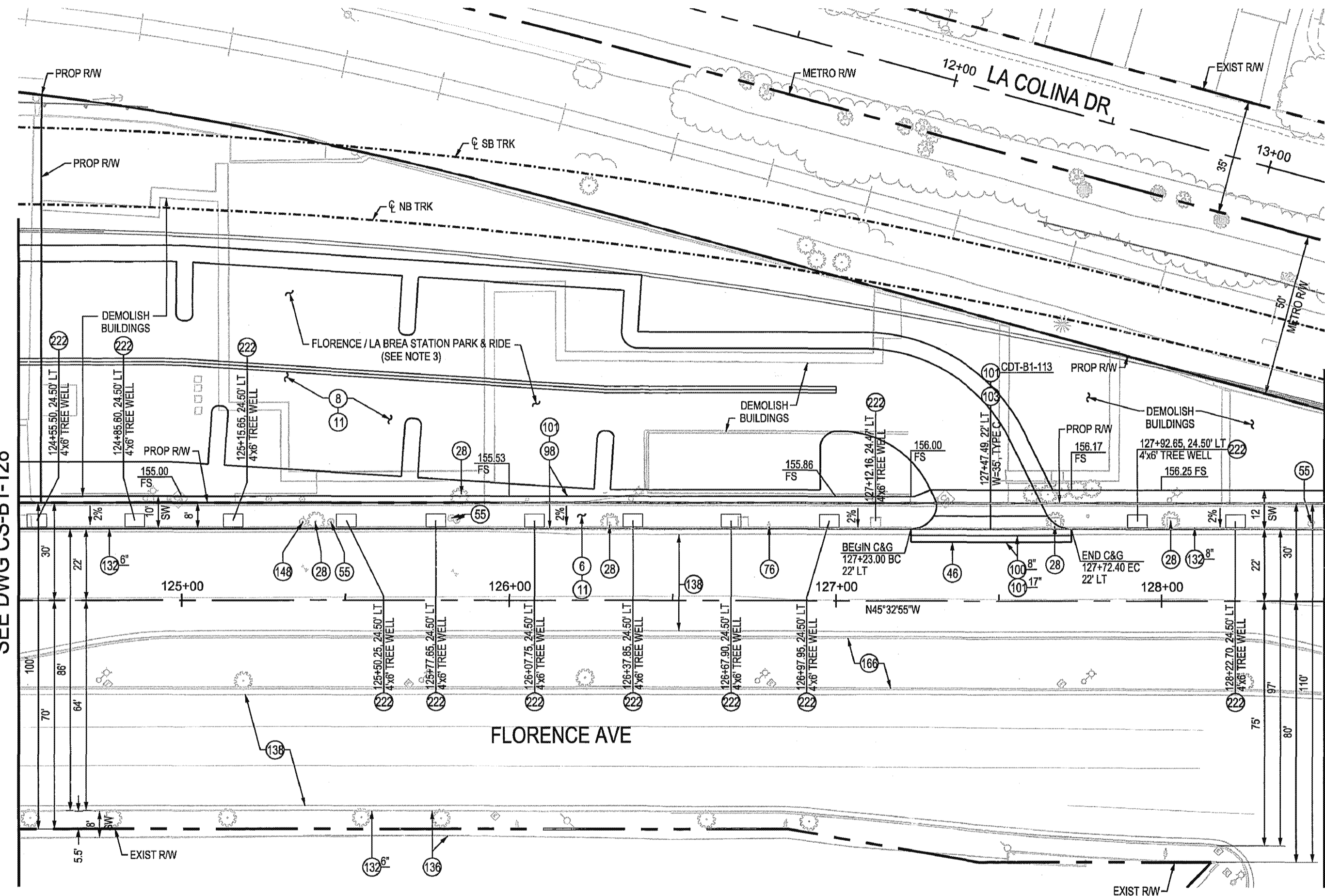

CONSTRUCTION NOTES

- ⑥ REMOVE EXISTING EXISTING SIDEWALK/ DRIVEWAY APPROACH/ CURB RAMP
- ⑧ REMOVE EXISTING ASPHALT CONCRETE PAVEMENT
- ⑪ REMOVE EXISTING CRUSHED MISCELLANEOUS BASE
- ⑳ REMOVE EXISTING TREE
- ④⑥ SAWCUT/ JOIN EXISTING PAVEMENT
- ⑤⑤ ADJUST EXIST WATER METER TO GRADE
- ⑦⑥ RELOCATE EXISTING STREET SIGN AND POST
- ⑨⑧ CONSTRUCT 4" THICK PCC SIDEWALK, JOINTS PER SPPWC STD. PLAN 112-2
- ⑩⑨ INSTALL A.C. PAVEMENT SECTION, THICKNESS SHOWN ON TYPICAL SECTION
- ⑩⑩ INSTALL CRUSHED MISCELLANEOUS BASE (CMB) OVER COMPACTED NATIVE, THICKNESS SHOWN ON TYPICAL SECTION
- ⑩③ CONSTRUCT DRIVEWAY APPROACH PER SPPWC STD. PLAN 110-2, "TYPE, W, X & Y" PER PLAN
- ⑬② EXISTING CURB & GUTTER TO REMAIN IN PLACE
- ⑬⑥ EXISTING CONCRETE SIDEWALK TO REMAIN IN PLACE
- ⑬⑧ EXISTING ASPHALT CONCRETE PAVEMENT TO REMAIN IN PLACE
- ⑭④ EXISTING FIRE HYDRANT TO REMAIN IN PLACE
- ⑯⑥ EXISTING MEDIAN TO REMAIN IN PLACE
- ②② CONSTRUCT TREE WELL PER PLANTING (LP) PLANS, DIMENSIONS PER PLAN



CRENSHAW/LAX TRANSIT CORRIDOR DESIGN/BUILD

APPROVED

APPROVED AS NOTED, NO RESUBMITTAL REQUIRED

REJECTED, REVISE AND RESUBMIT

RECORD ONLY

Director, Construction MGR / Engineer: *Mark Van Deesed* Date: *1/20/16*

LEGEND:

= FULL RECONSTRUCTION

NOTES:

1. SEE STREET LIGHTING (CL) PLANS FOR IMPROVEMENTS TO STREET LIGHTING.
2. SEE SIGNING AND STRIPING (GEO) PLANS FOR CROSSWALK LOCATIONS.
3. SEE PACKAGE B-1.4 STATIONS - STATION GRADING (CR) PLANS FOR FLORENCE/LA BREA STATION PARK & RIDE DETAILS.
4. SB TRACK IS TRACK 3 AND NB TRACK IS TRACK 4.
5. FOR TYPICAL SECTION INFORMATION, SEE DWG CX-B1-108.
6. FOR ADDITIONAL BACK OF WALK ELEVATIONS, SEE PACKAGE B-1.4 STATIONS - STATION GRADING (CR) PLANS.
7. CONTRACTOR TO VERIFY ELEVATIONS OF EXISTING SURFACE PRIOR TO CONSTRUCTION.

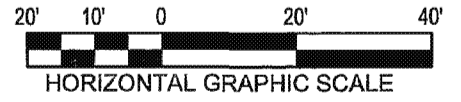

PACKAGE B-1.5
APPROVED FOR CONSTRUCTION
SUBMITTAL

**CITY OF INGLEWOOD, CALIFORNIA
PUBLIC WORKS DEPARTMENT**

SUBMITTED BY/ APPROVED BY: *[Signature]* 1-19-16
ELOY CASTILLO, P.E. C09100, PRINCIPAL CIVIL ENGINEER

THE PREPARATION OF THIS DRAWING HAS BEEN FINANCED IN PART THROUGH A GRANT FROM THE U.S. DEPARTMENT OF TRANSPORTATION, FEDERAL TRANSIT ADMINISTRATION (FTA), UNDER THE FEDERAL TRANSIT ACT OF 1964, AS AMENDED, AND IN PART BY THE TAXES OF THE CITIZENS OF LOS ANGELES COUNTY AND OF THE STATE OF CALIFORNIA.						
REV	DATE	BY	APP	REG NO	EXPIRES	SEAL HOLDER
0	1/15/16					AFC SUBMITTAL

DESIGNED BY
MANUEL BARRIOS

DRAWN BY
DAVID PARDEZ

CHECKED BY
RAVI PUDIPEDDI

IN CHARGE
NOAH BUSCH

DATE
1/15/2016

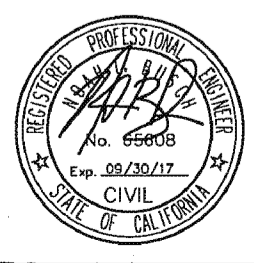

M LOS ANGELES COUNTY METROPOLITAN TRANSPORTATION AUTHORITY
Metro

WALSH-SHEA CORRIDOR CONSTRUCTORS
1777 Oakland Blvd.
Walnut Creek, CA 94596

HNTB

V&A INC.
830 S. HENRIETT ST., SUITE 121
LOS ANGELES, CA 90013

**CRENSHAW/LAX
TRANSIT CORRIDOR PROJECT
SEGMENT B1 - STREET MODIFICATION PLAN
FLORENCE AVE E/O LOCUST ST**

CONTRACT NO. **C0988**

DRAWING NO. **CS-B1-131** REV. **0**

SCALE **1" = 20'**

SHEET NO.

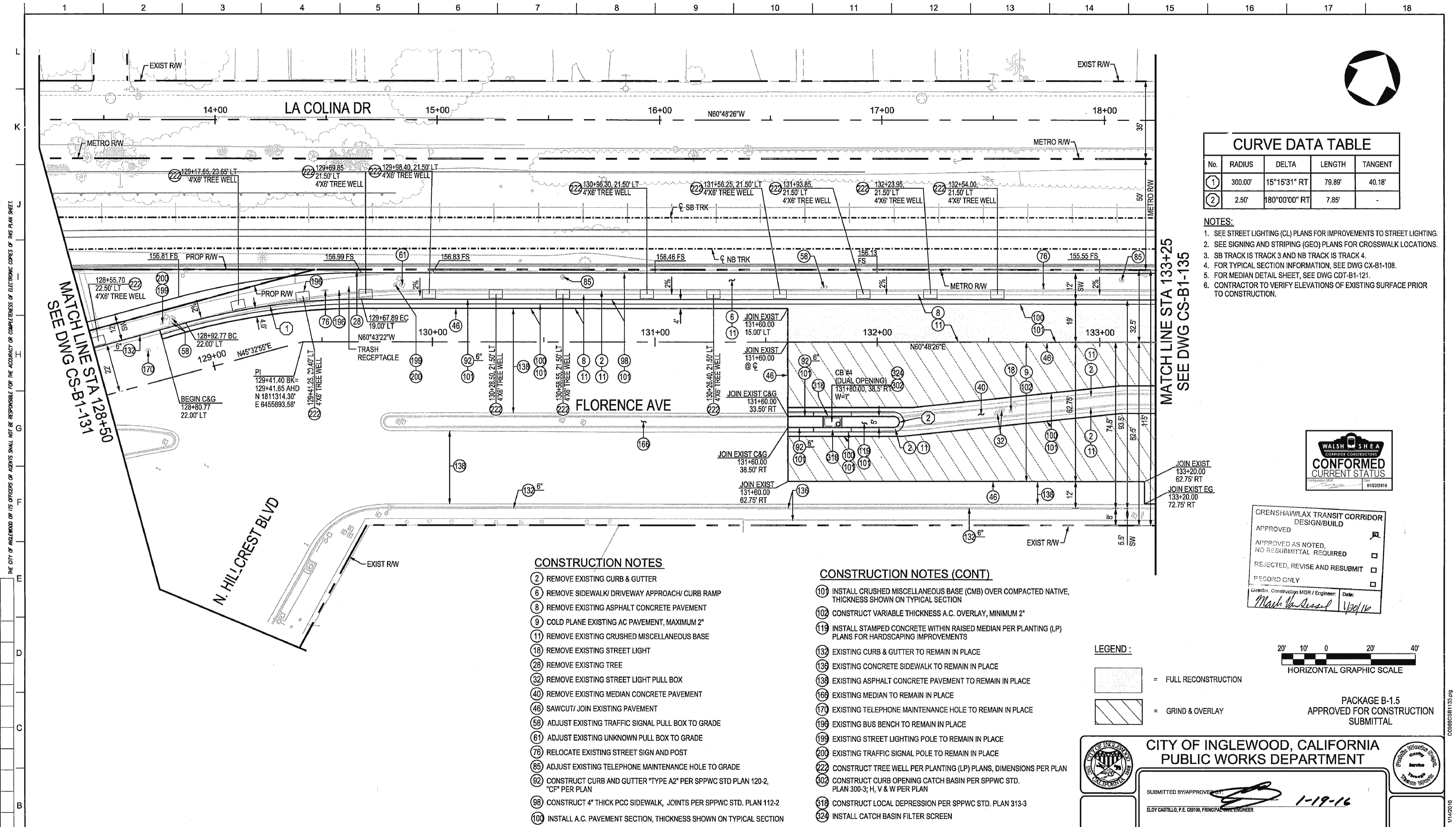

CURVE DATA TABLE				
No.	RADIUS	DELTA	LENGTH	TANGENT
①	300.00'	15°15'31" RT	79.89'	40.18'
②	2.50'	180°00'00" RT	7.85'	-

- NOTES:**
- SEE STREET LIGHTING (CL) PLANS FOR IMPROVEMENTS TO STREET LIGHTING.
 - SEE SIGNING AND STRIPING (GEO) PLANS FOR CROSSWALK LOCATIONS.
 - SB TRACK IS TRACK 3 AND NB TRACK IS TRACK 4.
 - FOR TYPICAL SECTION INFORMATION, SEE DWG CX-B1-108.
 - FOR MEDIAN DETAIL SHEET, SEE DWG CDT-B1-121.
 - CONTRACTOR TO VERIFY ELEVATIONS OF EXISTING SURFACE PRIOR TO CONSTRUCTION.



CRENSHAW/LAX TRANSIT CORRIDOR
DESIGN/BUILD
APPROVED
APPROVED AS NOTED,
NO RESUBMITTAL REQUIRED
REJECTED, REVISE AND RESUBMIT
RECORD ONLY
Director, Construction MGR / Engineer: Date: *Mark W. ... 1/19/16*

CONSTRUCTION NOTES

- ② REMOVE EXISTING CURB & GUTTER
- ⑥ REMOVE SIDEWALK/ DRIVEWAY APPROACH/ CURB RAMP
- ⑧ REMOVE EXISTING ASPHALT CONCRETE PAVEMENT
- ⑨ COLD PLANE EXISTING AC PAVEMENT, MAXIMUM 2"
- ⑪ REMOVE EXISTING CRUSHED MISCELLANEOUS BASE
- ⑱ REMOVE EXISTING STREET LIGHT
- ⑳ REMOVE EXISTING TREE
- ㉓ REMOVE EXISTING STREET LIGHT PULL BOX
- ④④ REMOVE EXISTING MEDIAN CONCRETE PAVEMENT
- ④⑥ SAWCUT JOIN EXISTING PAVEMENT
- ⑤⑧ ADJUST EXISTING TRAFFIC SIGNAL PULL BOX TO GRADE
- ⑥① ADJUST EXISTING UNKNOWN PULL BOX TO GRADE
- ⑦⑥ RELOCATE EXISTING STREET SIGN AND POST
- ⑧⑤ ADJUST EXISTING TELEPHONE MAINTENANCE HOLE TO GRADE
- ⑨② CONSTRUCT CURB AND GUTTER "TYPE A2" PER SPPWC STD PLAN 120-2, "CF" PER PLAN
- ⑨⑧ CONSTRUCT 4" THICK PCC SIDEWALK, JOINTS PER SPPWC STD. PLAN 112-2
- ⑩① INSTALL A.C. PAVEMENT SECTION, THICKNESS SHOWN ON TYPICAL SECTION

CONSTRUCTION NOTES (CONT)

- ⑩① INSTALL CRUSHED MISCELLANEOUS BASE (CMB) OVER COMPACTED NATIVE, THICKNESS SHOWN ON TYPICAL SECTION
- ⑩② CONSTRUCT VARIABLE THICKNESS A.C. OVERLAY, MINIMUM 2"
- ⑩⑨ INSTALL STAMPED CONCRETE WITHIN RAISED MEDIAN PER PLANTING (LP) PLANS FOR HARDSCAPING IMPROVEMENTS
- ⑬③ EXISTING CURB & GUTTER TO REMAIN IN PLACE
- ⑬⑥ EXISTING CONCRETE SIDEWALK TO REMAIN IN PLACE
- ⑬⑧ EXISTING ASPHALT CONCRETE PAVEMENT TO REMAIN IN PLACE
- ⑬⑨ EXISTING MEDIAN TO REMAIN IN PLACE
- ⑰⑦ EXISTING TELEPHONE MAINTENANCE HOLE TO REMAIN IN PLACE
- ⑱⑥ EXISTING BUS BENCH TO REMAIN IN PLACE
- ⑱⑨ EXISTING STREET LIGHTING POLE TO REMAIN IN PLACE
- ⑳① EXISTING TRAFFIC SIGNAL POLE TO REMAIN IN PLACE
- ㉒② CONSTRUCT TREE WELL PER PLANTING (LP) PLANS, DIMENSIONS PER PLAN
- ㉓② CONSTRUCT CURB OPENING CATCH BASIN PER SPPWC STD. PLAN 300-3; H, V & W PER PLAN
- ㉔⑧ CONSTRUCT LOCAL DEPRESSION PER SPPWC STD. PLAN 313-3
- ㉕② INSTALL CATCH BASIN FILTER SCREEN

LEGEND:

- = FULL RECONSTRUCTION
- = GRIND & OVERLAY

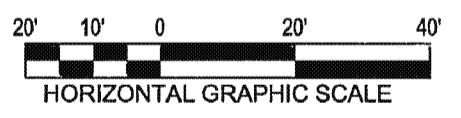

PACKAGE B-1.5
APPROVED FOR CONSTRUCTION
SUBMITTAL

**CITY OF INGLEWOOD, CALIFORNIA
PUBLIC WORKS DEPARTMENT**

SUBMITTED BY/APPROVED BY: *[Signature]* 1-19-16
ELOY CASTILLO, P.E. CB910, PRINCIPAL CIVIL ENGINEER

CONTRACT NO. **C0988**
DRAWING NO. **CS-B1-133** REV **0**
SCALE **1" = 20'**
SHEET NO.

THE PREPARATION OF THIS DRAWING HAS BEEN FINANCED IN PART THROUGH A GRANT FROM THE U.S. DEPARTMENT OF TRANSPORTATION, FEDERAL TRANSIT ADMINISTRATION (FTA), UNDER THE FEDERAL TRANSIT ACT OF 1964, AS AMENDED, AND IN PART BY THE TAXES OF THE CITIZENS OF LOS ANGELES COUNTY AND OF THE STATE OF CALIFORNIA.					
DESIGNED BY	MANUEL BARRIOS	DATE	1/15/2016	REG NO.	
DRAWN BY	DEVIN FANNIN	APPROVED		EXPIRES	
CHECKED BY	RAVI PUDIPEDDI	SEAL HOLDER		DESCRIPTION	AFC SUBMITTAL
IN CHARGE	NOAH BUSCH				
DATE	1/15/2016				

DESIGNED BY
MANUEL BARRIOS

DRAWN BY
DEVIN FANNIN

CHECKED BY
RAVI PUDIPEDDI

IN CHARGE
NOAH BUSCH

DATE
1/15/2016

M LOS ANGELES COUNTY METROPOLITAN TRANSPORTATION AUTHORITY
Metro

WALSH-SHEA CORRIDOR CONSTRUCTORS
1777 Oakland Blvd.
Walnut Creek, CA 94596

HNTB

W&A INC.
330 S. HIGHT ST., SUITE 121
LOS ANGELES, CA 90013
310.472.7000

**CRENSHAW/LAX
TRANSIT CORRIDOR PROJECT
SEGMENT B1 - STREET MODIFICATION PLAN
FLORENCE AVE AT HILLCREST BLVD**

CONTRACT NO. **C0988**
DRAWING NO. **CS-B1-133** REV **0**
SCALE **1" = 20'**
SHEET NO.