

DEMOLITION NOTES:

1123 REDONDO BLVD. YEAR OF CONSTRUCTION 1968, GROSS BUILDING AREA 21,337 SQUARE FEET; 2- STORIES THE BUILDING HAS A CONCRETE FOUNDATION WITH A CONCRETE BLOCK STRUCTURAL FRAME. EXTERIOR WALLS ARE MASONRY WITH PAINTED STUCCO AND THE ROOF IS BUILT-UP COMPOSITION COVER OVER DIAGONAL WOOD UNDERLAYMENT

1125 REDONDO BLVD. YEAR OF CONSTRUCTION 1948, GROSS BUILDING AREA 8,400 SQUARE FEET; 1- STORIES THE BUILDING HAS A CONCRETE FOUNDATION WITH A CONCRETE BLOCK STRUCTURAL FRAME. EXTERIOR WALLS ARE MASONRY WITH PAINTED STUCCO AND THE ROOF IS BUILT-UP COMPOSITION COVER OVER DIAGONAL WOOD UNDERLAYMENT

1133 REDONDO BLVD. YEAR OF CONSTRUCTION 1953, GROSS BUILDING AREA 13,942 SQUARE FEET; 2- STORIES THE BUILDING HAS A CONCRETE FOUNDATION WITH A CONCRETE BLOCK STRUCTURAL FRAME. EXTERIOR WALLS ARE MASONRY WITH PAINTED STUCCO AND THE ROOF IS BUILT-UP COMPOSITION COVER OVER DIAGONAL WOOD UNDERLAYMENT

1137 REDONDO BLVD. YEAR OF CONSTRUCTION 1951 GROSS BUILDING AREA 11,713 SQUARE FEET; 2- STORIES THE BUILDING HAS A CONCRETE FOUNDATION WITH A CONCRETE BLOCK STRUCTURAL FRAME. EXTERIOR WALLS ARE MASONRY WITH PAINTED STUCCO AND THE ROOF IS BUILT-UP COMPOSITION COVER OVER DIAGONAL WOOD UNDERLAYMENT

EXISTING BUILDING UTILITIES

SANITARY SEWER: CITY OF INGLEWOOD	ACTION:
WATER: CITY OF INGLEWOOD	ACTION:
GAS: SOUTHERN CALIFORNIA GAS COMPANY	ACTION:
ELECTRICITY: SOUTHERN CALIFORNIA EDISON	ACTION:
PHONE: TIME WARNER, VERIZON, AT&T	ACTION:

NOTES:

1. PLAN VIEW DRAWINGS ARE BASED ON GOOGLE EARTH IMAGE THEREFORE CONTRACTOR IS TO MAKE A PRE-BID SITE VISIT TO DETERMINE OVERALL SITE DIMENSIONS BEFORE BIDDING.
2. CONTRACTOR TO PERFORM A SITE SURVEY BEFORE CONSTRUCTION STARTS AND PROVIDE TO METRO TO MODIFY PARKING LAYOUT TO MAXIMIZE USE OF THE AREA.

A CONSTRUCTION PLAN
SCALE: 1/16"=1'-0"

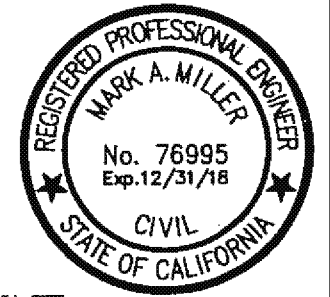

NOTE: IF DWG. IS NOT 22"x34", IT IS NOT FULL SIZE

<table border="0"> <tr> <td>DESIGNED</td> <td>MAM</td> </tr> <tr> <td>DRAWN BY</td> <td>MM</td> </tr> <tr> <td>CHECKED</td> <td>AW</td> </tr> <tr> <td>DATE</td> <td>MAY 2018</td> </tr> </table>				DESIGNED	MAM	DRAWN BY	MM	CHECKED	AW	DATE	MAY 2018	<p>LOS ANGELES COUNTY METROPOLITAN TRANSPORTATION AUTHORITY PROGRAM MANAGEMENT</p>		<p>FAIRVIEW HEIGHTS STATION PARKING LOT CONSTRUCTION</p>		<p>FILE/REV NUMBER</p>	
DESIGNED	MAM																
DRAWN BY	MM																
CHECKED	AW																
DATE	MAY 2018																
<table border="0"> <tr> <td>REV.</td> <td>DATE</td> <td>BY</td> <td>APP.</td> <td>DESCRIPTION</td> </tr> <tr> <td> </td> <td> </td> <td> </td> <td> </td> <td> </td> </tr> </table>				REV.	DATE	BY	APP.	DESCRIPTION						<p>CONSTRUCTION PLAN AND DEMOLITION NOTES</p>		<p>SCALE AS NOTED</p>	
REV.	DATE	BY	APP.	DESCRIPTION													
						<p>NO. 76995</p>											
						<p>Exp. 12/31/18</p>											
						<p>CIVIL</p>											
						<p>STATE OF CALIFORNIA</p>											
						<p>2 OF 7</p>											

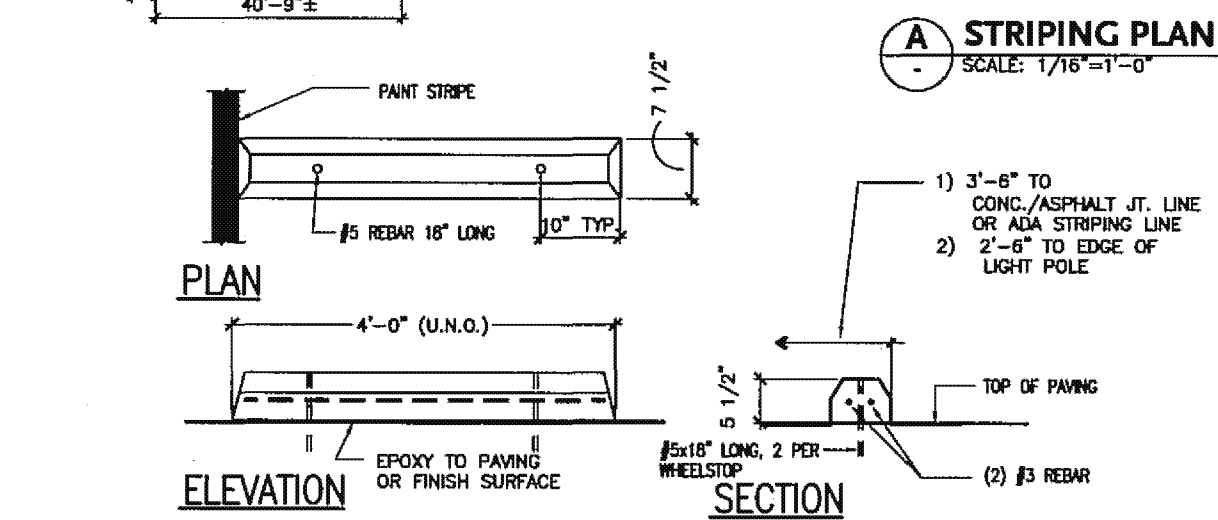
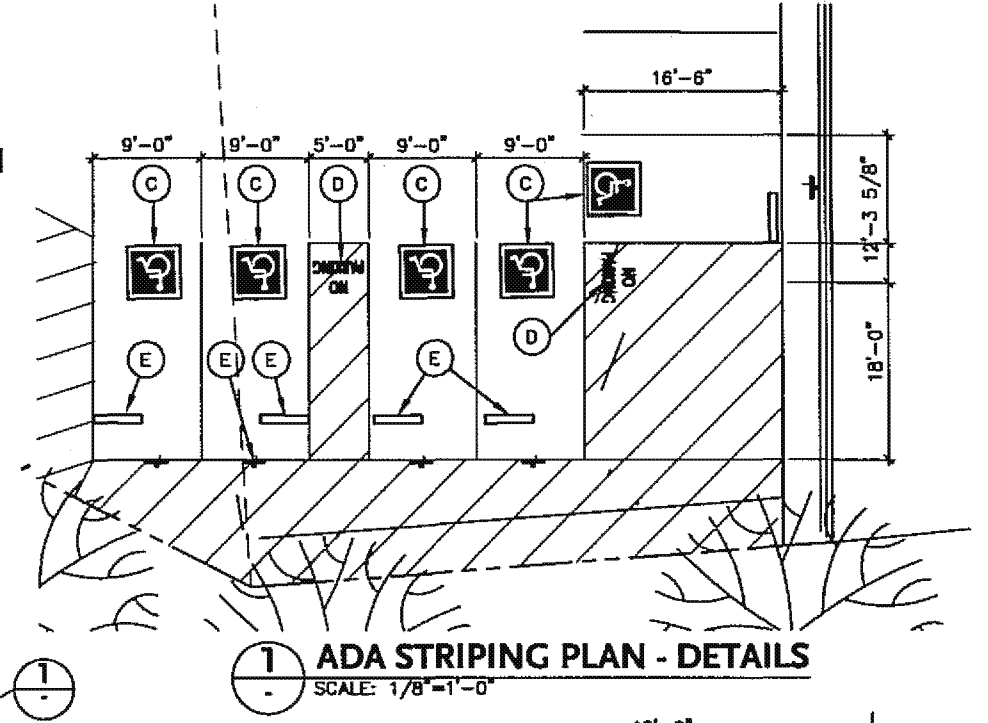
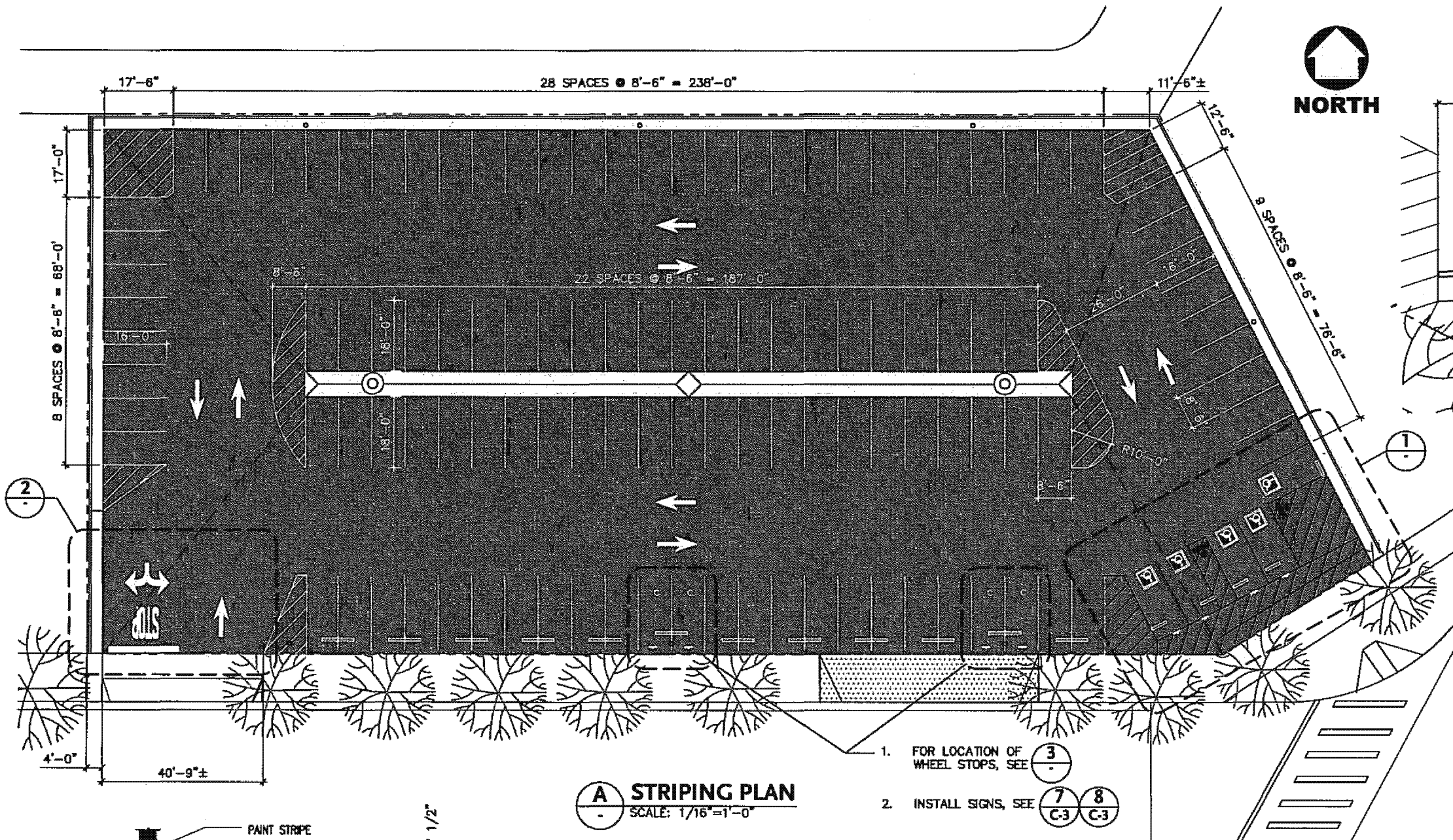

A STRIPING PLAN
SCALE: 1/16"=1'-0"

3 CONCRETE WHEEL STOP DETAIL
SCALE: 1 1/2"=1'-0"

- FOR LOCATION OF WHEEL STOPS, SEE **3**
- INSTALL SIGNS, SEE **7** **8**
C-3 **C-3**

ADA STRIPING NOTES:

- A** 4" WIDE BLUE STRIPE
- B** 4" WIDE BLUE EDGE STRIPE WITH 4" WIDE BLUE DIAGONAL STRIPING @ 24" O.C.
- C** ADA PAVEMENT SIGN **2** **C-3**
- D** 12" HIGH WHITE, SEE **5** **C-3**
- E** WHEEL STOP, SEE **3**
- F** ADA SIGN ON POLE, SEE **1** **3**
S-3 **S-3**

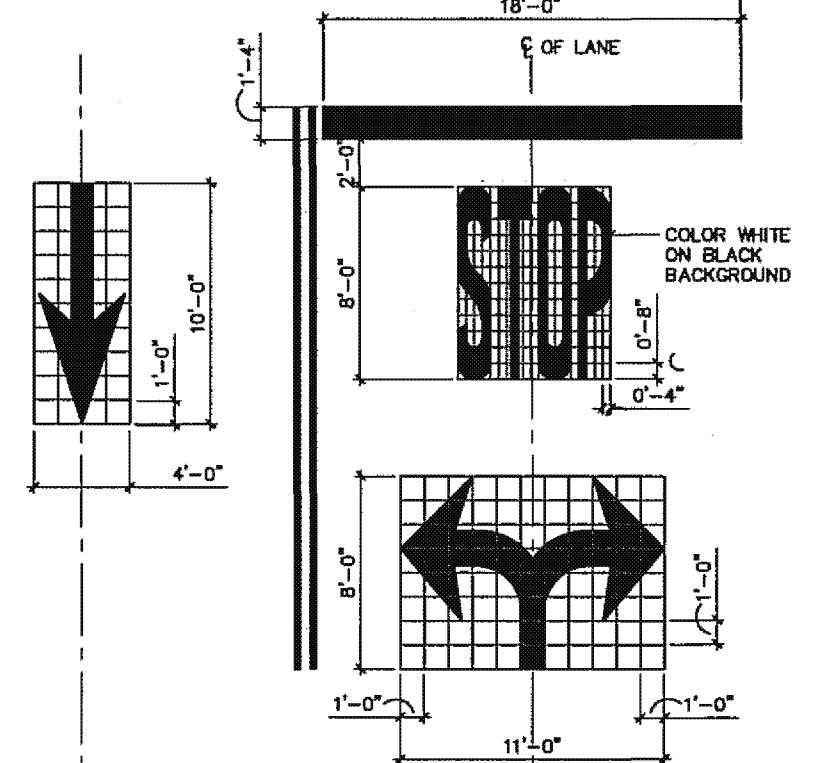

2 PAVEMENT MARKING DETAILS
SCALE: 1/4"=1'-0"

PARKING STALLS:
REGULAR STALLS = 114
ADA STALLS = 5



NOTE: IF DWG. IS NOT 22"x34", IT IS NOT FULL SIZE

REVISIONS NO. DATE BY APP. DESCRIPTION				DRAWN BY MAM CHECKED BY LWJ DATE MAY 2018	LOS ANGELES COUNTY METROPOLITAN TRANSPORTATION AUTHORITY PROGRAM MANAGEMENT	FILE/REV NUMBER SCALE AS NOTED SHEET NO. ST-1 SHEET 7 OF 7
PROJECT: FAIRVIEW HEIGHTS STATION DRAWING: PARKING LOT CONSTRUCTION TITLE: STRIPING PLAN AND STRIPING DETAILS				RECOMMENDED DATE APPROVED DATE		