

- NOTES:**
- ① INSTALL HIGH REFLECTIVITY YELLOW PAINT ON CURB FACE. EXTEND PAINT ON TOP OF CURB AND CURB FACE TO BC, EC, OR END OF FLARE.
 - ② INSTALL OM1-3 MARKER, R6-2 AND/OR R4-7 SIGN(S), ON "TELESPAR" POST, WHEN CALLED FOR ON PLAN.

CURVE TABLE

CURVE	R	Δ	L	T
A	60'	14°54'57"	15.62'	7.85'

- CONSTRUCTION NOTES:**
- ① INSTALL 4" WHITE LINE AND PAVEMENT MARKERS PER DETAIL 9, CALTRANS STD. PLAN A20A.
 - ② INSTALL LEAD LINE PAVEMENT MARKERS PER "LEAD LINE DETAIL" ON SHEET SPD-101.
 - ③ INSTALL 8" WHITE LINE AND PAVEMENT MARKERS PER DETAIL 38, CALTRANS STD. PLAN A20D.
 - ⑦ INSTALL DOUBLE 4" YELLOW LINE AND PAVEMENT MARKERS PER DETAIL 22, CALTRANS STD PLAN A20A.
 - ⑧ INSTALL 4" WHITE LINE FOR LANE LINE EXTENSION THROUGH INTERSECTION PER DETAIL 40, CALTRANS STD. PLAN A20D.
 - ⑨ INSTALL TYPE IV, LEFT OR RIGHT, ARROW PER CALTRANS STD PLAN A24A.
 - ⑪ INSTALL TYPE VII (R) ARROW PER CALTRANS STD PLAN A24A.
 - ⑬ INSTALL 12" WHITE LIMIT LINE OR CROSSWALK PER CALTRANS STD PLAN A24E. CROSSWALK WIDTH=15' CLEAR.
 - ⑭ FURNISH AND INSTALL 1 POST ROADSIDE SIGN PER CALTRANS STD PLANS R51.
 - ⑰ PAINT ISLAND NOSE YELLOW, SEE SPD-101 FOR DETAILS.
 - ⑳ INSTALL 4" YELLOW LINE FOR CENTERLINE EXTENSION THROUGH INTERSECTION PER DETAIL 41, CALTRANS STD PLAN A20D.
 - ㉒ INSTALL MEDIAN ISLAND DUAL DOUBLE 4" YELLOW LINE AND PAVEMENT MARKERS PER DETAIL 29, CALTRANS STD PLAN A20B.
 - ㉓ PROTECT IN PLACE EXISTING TRAFFIC SIGN.

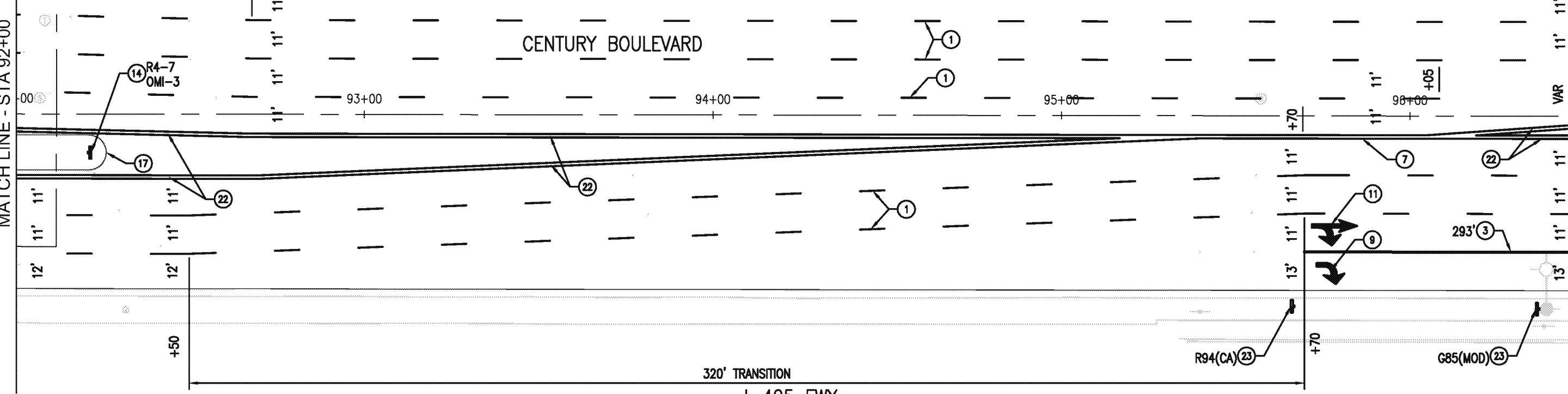

- LEGEND:**
- PROPOSED SIGNING OR STRIPING
 - ◊ EXISTING SIGNING OR STRIPING
 - Ⓢ SIGNALIZED INTERSECTION
 - ┆ 1 POST SIGN
 - 12" WHITE CROSSWALK OR LIMIT LINE
 - ☉ PROPOSED PEDESTRIAN LIGHTING
 - ↔ TYPE IV ARROW
 - ↔ TYPE VII ARROW
 - STOP "STOP" PAVEMENT MARKING
 - BUS "BUS" PAVEMENT MARKING
 - ONLY "ONLY" PAVEMENT MARKING
 - PROPOSED STREET LIGHTING
 - R/C RED CURB
 - Y/C YELLOW CURB

MATCH LINE - STA 96+50
SEE SHEET SPD-102 FOR CONTINUATION

MATCH LINE - STA 92+00
SEE BOTTOM LEFT FOR CONTINUATION

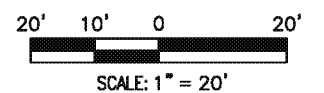

REVISIONS

MARK	DATE	DESCRIPTION

**CITY OF INGLEWOOD, CALIFORNIA
PUBLIC WORKS DEPARTMENT**

PROJECT TITLE:
PLANS FOR IMPROVEMENT OF
CENTURY BOULEVARD
LA CIENEGA BLVD TO FELTON AVE
SIGNS AND PVMT DELINEATION - 88+00 TO 96+50

DESIGNED BY:
DRAWN BY:
CHECKED BY:

SUBMITTED BY / APPROVED BY:
[Signature]
VANESSA MUNOZ, RCE 67883 / CONSULTANT TRAFFIC ENGINEER

DATE: 5/18/2015

PLAN SCALE: 1"=20'
PROFILE SCALE: VERTICAL N/A, HORIZONTAL N/A

PLAN NO.: SPD-101
SHEET NO.: 15 OF 28

CURVE TABLE				
CURVE	R	Δ	L	T
A	10.00'	90°00'00"	15.70'	10.00'

LEGEND:

- PROPOSED SIGNING OR STRIPING
- ◇ EXISTING SIGNING OR STRIPING
- Ⓢ SIGNALIZED INTERSECTION
- 1 POST SIGN
- 12" WHITE CROSSWALK OR LIMIT LINE
- ⊙ PROPOSED PEDESTRIAN LIGHTING
- R/C RED CURB
- ↖ TYPE IV ARROW
- ↗ TYPE VII ARROW
- STOP "STOP" PAVEMENT MARKING
- BUS "BUS" PAVEMENT MARKING
- ONLY "ONLY" PAVEMENT MARKING
- PROPOSED STREET LIGHTING
- Y/C YELLOW CURB

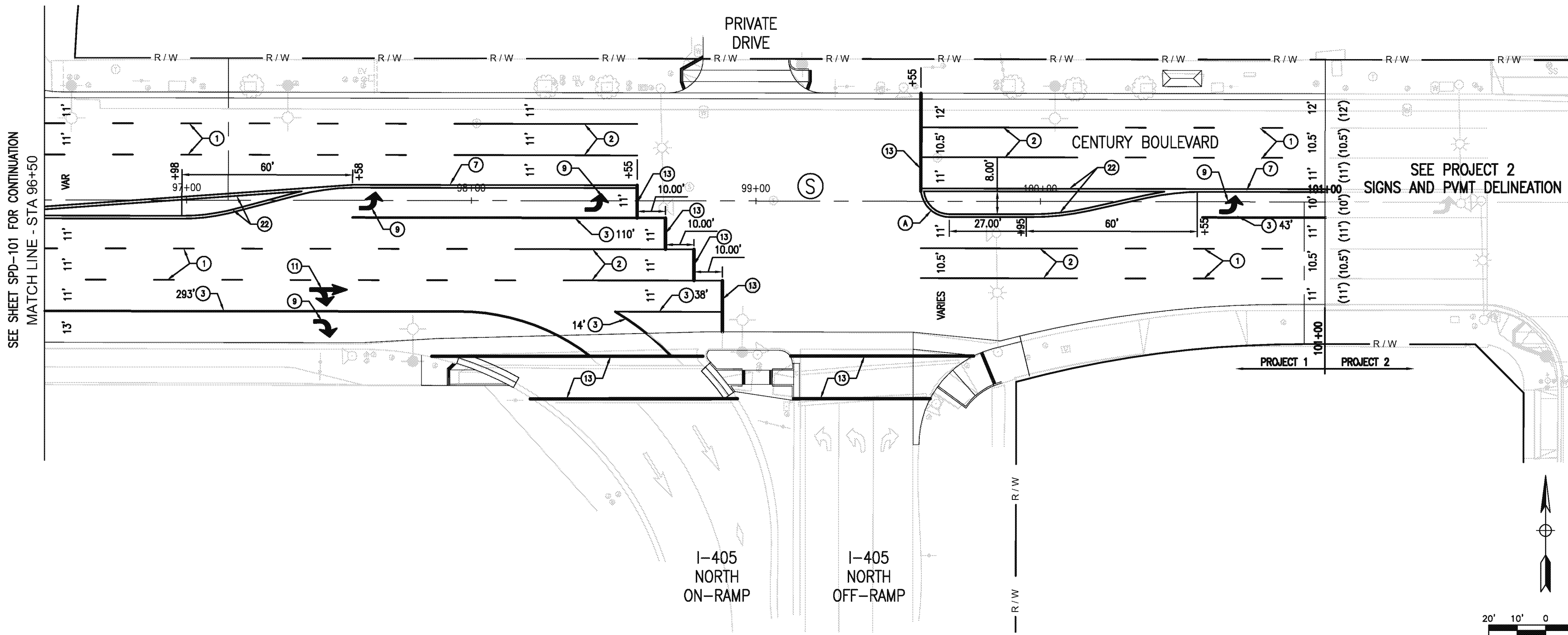

CONSTRUCTION NOTES:

- 1 INSTALL 4" WHITE LINE AND PAVEMENT MARKERS PER DETAIL 9, CALTRANS STD. PLAN A20A.
- 2 INSTALL LEAD LINE PAVEMENT MARKERS PER "LEAD LINE DETAIL" ON SHEET SPD-101.
- 3 INSTALL 8" WHITE LINE AND PAVEMENT MARKERS PER DETAIL 38, CALTRANS STD. PLAN A20D.
- 7 INSTALL DOUBLE 4" YELLOW LINE AND PAVEMENT MARKERS PER DETAIL 22, CALTRANS STD PLAN A20A.
- 9 INSTALL TYPE IV, LEFT OR RIGHT, ARROW PER CALTRANS STD PLAN A24A.
- 11 INSTALL TYPE VII (R) ARROW PER CALTRANS STD PLAN A24A.
- 13 INSTALL 12" WHITE LIMIT LINE OR CROSSWALK PER CALTRANS STD PLAN A24E. CROSSWALK WIDTH=15' CLEAR.
- 22 INSTALL MEDIAN ISLAND DUAL DOUBLE 4" YELLOW LINE AND PAVEMENT MARKERS PER DETAIL 29, CALTRANS STD PLAN A20B.

SEE SHEET SPD-101 FOR CONTINUATION
MATCH LINE - STA 96+50

SEE PROJECT 2
SIGNS AND PVMT DELINEATION

PROJECT 1 PROJECT 2

AECOM
 AECOM Technical Services, Inc.
 515 S. FLOWER ST., 4th FLOOR
 LOS ANGELES, CA 90071
 T 213.330.7200 F 213.330.7201
 www.aecom.com

Professional Engineer Seal: **JOSEPH J. TOMAT**, No. 10447, Exp. 03/30/16, CIVIL, STATE OF CALIFORNIA

REVISIONS		
MARK	DATE	DESCRIPTION

**CITY OF INGLEWOOD, CALIFORNIA
PUBLIC WORKS DEPARTMENT**

PROJECT TITLE:
**PLANS FOR IMPROVEMENT OF
CENTURY BOULEVARD
LA CIENEGA BLVD TO FELTON AVE
SIGNS AND PVMT DELINEATION - 96+50 TO 101+00**

DESIGNED BY: _____
 DRAWN BY: _____
 CHECKED BY: _____

SUBMITTED BY / APPROVED BY:

 VANESSA MUNOZ, P.E. 97883 / CONSULTANT TRAFFIC ENGINEER

DATE: **5/18/2015**

PLAN NO. SPD-102
 SHEET NO. 16 OF 28

Drawn's Name: \\SLA1F5001\proj\SLA1F001\DWG\96018083_CBR_Traffic\96018083\Project 1 - La Cienega to Felton 12 Signs and PVMT\PCB\SPD-102.dwg
Last Owner: May 14, 2015 - 9:24AM by: bason