

NOTES:

- 1. SEE TRAFFIC SIGNAL PLANS FOR ADDITIONAL SIGNS.

LEGEND:

- PROPOSED SIGNING OR STRIPING
- ◇ EXISTING SIGNING OR STRIPING
- ⊙ SIGNALIZED INTERSECTION
- 1 POST SIGN
- 12" CROSSWALK OR LIMIT LINE
- ⊙ PROPOSED PEDESTRIAN LIGHTING
- R/C RED CURB
- ↖ TYPE IV ARROW
- ↗ TYPE VII ARROW
- STOP "STOP" PAVEMENT MARKING
- BUS "BUS" PAVEMENT MARKING
- ONLY "ONLY" PAVEMENT MARKING
- PROPOSED STREET LIGHTING
- Y/C YELLOW CURB

CONSTRUCTION NOTES:

- 1. INSTALL 4" WHITE LINE AND PAVEMENT MARKERS PER DETAIL 9, CALTRANS STD. PLAN A20A.
- 2. INSTALL LEAD LINE PAVEMENT MARKERS PER "LEAD LINE DETAIL" ON SHEET SPD-301.
- 3. INSTALL 8" WHITE LINE AND PAVEMENT MARKERS PER DETAIL 38, CALTRANS STD. PLAN A20D.
- 4. INSTALL ROADSIDE SIGN USING STRAP AND SADDLE BRACKET METHOD PER CALTRANS STD PLAN RSA.
- 5. INSTALL 8" WHITE LINE AND PAVEMENT MARKERS FOR LANE DROP PER DETAIL 37B, CALTRANS STD. PLAN A20C.
- 6. INSTALL 4" WHITE LINE PER DETAIL 27B, CALTRANS STD PLAN A20B.
- 7. INSTALL DOUBLE 4" YELLOW LINE AND PAVEMENT MARKERS PER DETAIL 22, CALTRANS STD PLAN A20A.
- 8. INSTALL 4" WHITE LINE FOR LANE LINE EXTENSION THROUGH INTERSECTION PER DETAIL 40, CALTRANS STD. PLAN A20D.
- 9. INSTALL TYPE IV, LEFT OR RIGHT, ARROW PER CALTRANS STD PLAN A24A.
- 10. INSTALL 8" WHITE LINE AND PAVEMENT MARKERS PER DETAIL 38A, CALTRANS STD. PLAN A20D.
- 12. INSTALL PAVEMENT MARKING PER CALTRANS STD PLAN A24D AND A24E.
- 13. INSTALL 12" WHITE LIMIT LINE OR CROSSWALK PER CALTRANS STD PLAN A24E. CROSSWALK WIDTH=16' CLEAR.
- 14. FURNISH AND INSTALL 1 POST ROADSIDE SIGN PER CALTRANS STD PLANS RS1.
- 15. FURNISH AND INSTALL 1 POST ROADSIDE SIGN IN MEDIAN PER CALTRANS STD PLANS RS1 WITH MODIFIED GROUND CLEARANCE OF 1.5' FROM BOTTOM OF SIGN.
- 16. NOT USED
- 17. PAINT ISLAND NOSE YELLOW, SEE SPD-311 FOR DETAILS.
- 18. INSTALL 12" YELLOW CROSSWALK PER CALTRANS STD PLAN A24E. CROSSWALK WIDTH=15' CLEAR.
- 19. INSTALL EDGE OF TRAVELED WAY PAVEMENT MARKERS PER DETAIL 26, CALTRANS STD PLAN A20B.

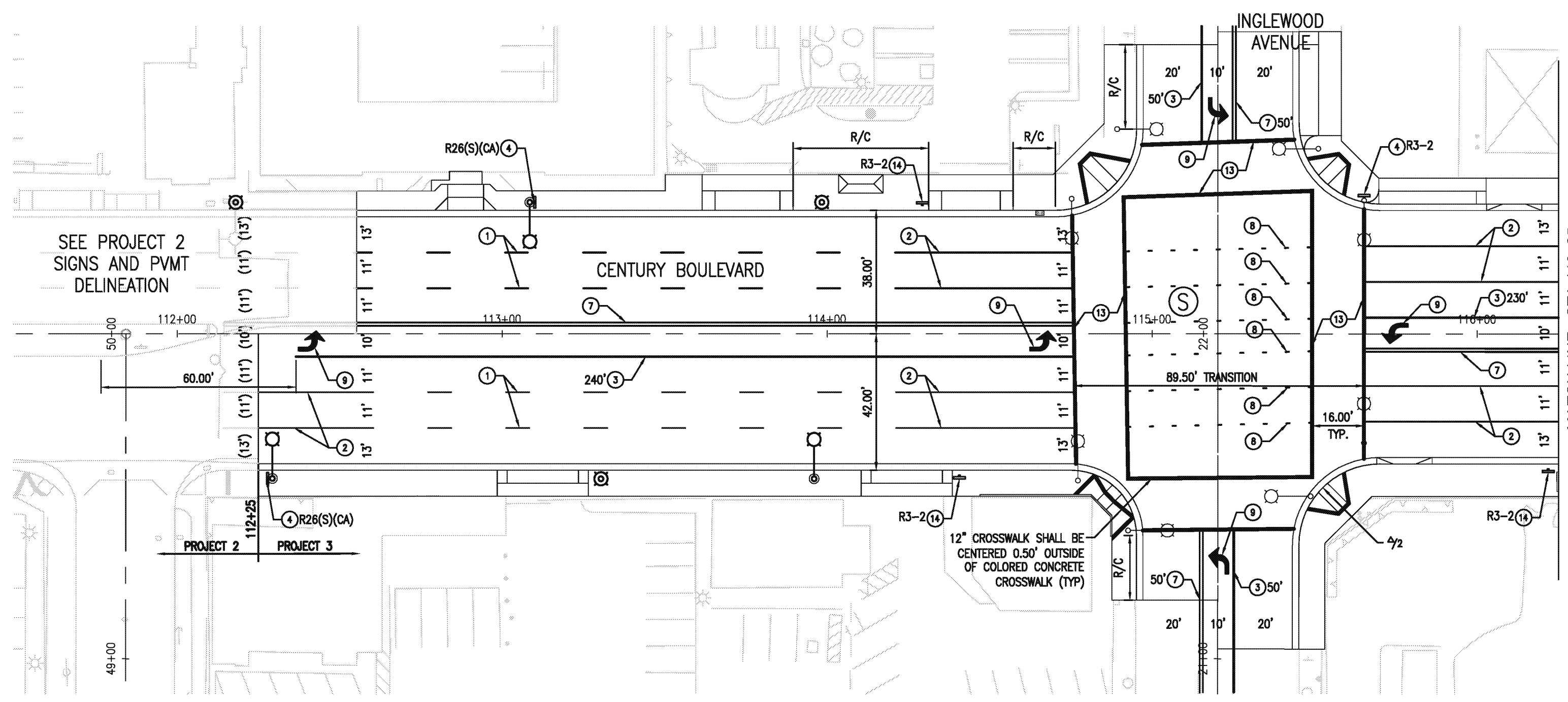

MATCH LINE - STA 116+25  
SEE SHEET SPD-302 FOR CONTINUATION

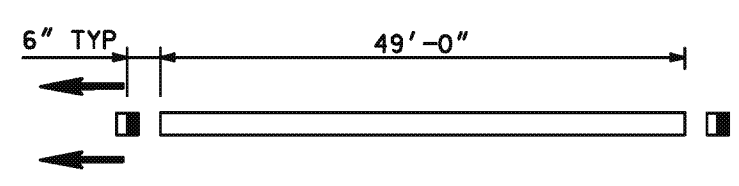
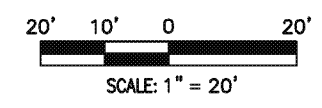

LEAD LINE DETAIL  
N.T.S.

DESIGN REVIEW SUBMITTAL,  
NOT FOR CONSTRUCTION

**AECOM**  
AECOM Technical Services, Inc.  
515 S. FLOWER ST., 4th FLOOR  
LOS ANGELES, CA 90071  
T 213.330.7200 F 213.330.7201  
www.aecom.com

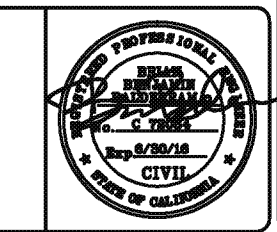

REVISIONS		
MARK	DATE	DESCRIPTION

**CITY OF INGLEWOOD, CALIFORNIA  
PUBLIC WORKS DEPARTMENT**

PROJECT TITLE:  
**PLANS FOR IMPROVEMENT OF  
CENTURY BOULEVARD  
INGLEWOOD AVE TO DOTY AVE  
SIGNS AND PVMT DELINEATION - 112+25 TO 116+25**

DESIGNED BY: \_\_\_\_\_  
DRAWN BY: \_\_\_\_\_  
CHECKED BY: \_\_\_\_\_

SUBMITTED BY / APPROVED BY: \_\_\_\_\_  
VANESSA MUNOZ, RCE 67583 / CONSULTANT TRAFFIC ENGINEER

PLAN NO. \_\_\_\_\_  
PROFILE SCALE: VERTICAL N/A, HORIZONTAL N/A

SHEET NO. **SPD-301** OF \_\_\_\_\_

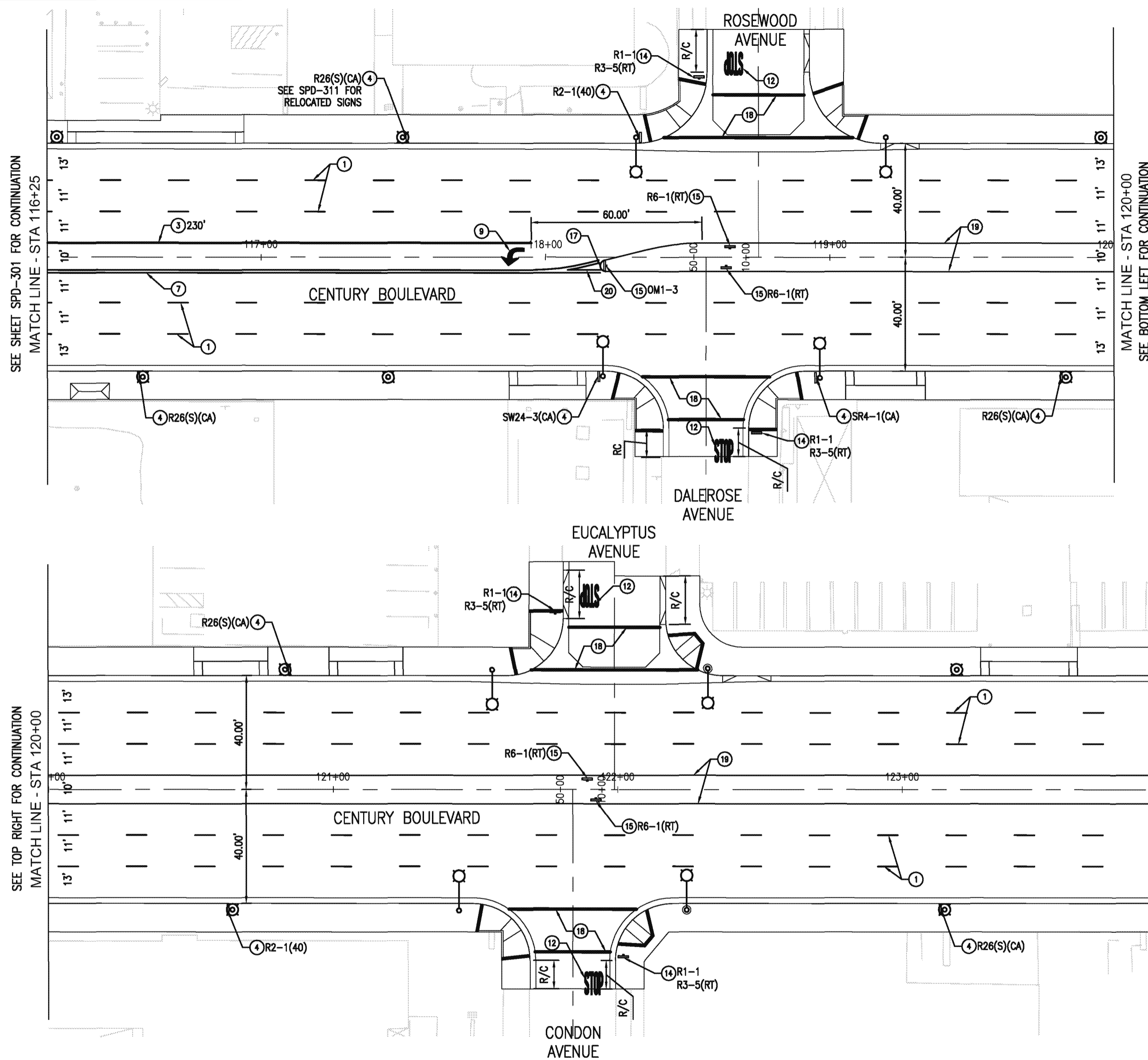

**NOTES:**

- 1. SEE TRAFFIC SIGNAL PLANS FOR ADDITIONAL SIGNS.

**LEGEND:**

- PROPOSED SIGNING OR STRIPING
- ◇ EXISTING SIGNING OR STRIPING
- ⊙ SIGNALIZED INTERSECTION
- 1 POST SIGN
- 12" CROSSWALK OR LIMIT LINE
- ⊙ PROPOSED PEDESTRIAN LIGHTING
- R/C RED CURB
- ↖ TYPE IV ARROW
- ↗ TYPE VII ARROW
- STOP "STOP" PAVEMENT MARKING
- BUS "BUS" PAVEMENT MARKING
- ONLY "ONLY" PAVEMENT MARKING
- PROPOSED STREET LIGHTING
- Y/C YELLOW CURB

**CONSTRUCTION NOTES:**

- INSTALL 4" WHITE LINE AND PAVEMENT MARKERS PER DETAIL 9, CALTRANS STD. PLAN A20A.
- INSTALL LEAD LINE PAVEMENT MARKERS PER "LEAD LINE DETAIL" ON SHEET SPD-301.
- INSTALL 8" WHITE LINE AND PAVEMENT MARKERS PER DETAIL 3B, CALTRANS STD. PLAN A20D.
- INSTALL ROADSIDE SIGN USING STRAP AND SADDLE BRACKET METHOD PER CALTRANS STD PLAN RS4.
- INSTALL 8" WHITE LINE AND PAVEMENT MARKERS FOR LANE DROP PER DETAIL 37B, CALTRANS STD. PLAN A20C.
- INSTALL 4" WHITE LINE PER DETAIL 27B, CALTRANS STD PLAN A20B.
- INSTALL DOUBLE 4" YELLOW LINE AND PAVEMENT MARKERS PER DETAIL 22, CALTRANS STD PLAN A20A.
- INSTALL 4" WHITE LINE FOR LANE LINE EXTENSION THROUGH INTERSECTION PER DETAIL 40, CALTRANS STD. PLAN A20D.
- INSTALL TYPE IV, LEFT OR RIGHT, ARROW PER CALTRANS STD PLAN A24A.
- INSTALL 8" WHITE LINE AND PAVEMENT MARKERS PER DETAIL 38A, CALTRANS STD. PLAN A20D.
- INSTALL PAVEMENT MARKING PER CALTRANS STD PLAN A24D AND A24E.
- INSTALL 12" WHITE LIMIT LINE OR CROSSWALK PER CALTRANS STD PLAN A24E. CROSSWALK WIDTH=15' CLEAR.
- FURNISH AND INSTALL 1 POST ROADSIDE SIGN PER CALTRANS STD PLANS RS1.
- FURNISH AND INSTALL 1 POST ROADSIDE SIGN IN MEDIAN PER CALTRANS STD PLANS RS1 WITH MODIFIED GROUND CLEARANCE OF 1.5' FROM BOTTOM OF SIGN.
- NOT USED
- PAINT ISLAND NOSE YELLOW, SEE SPD-311 FOR DETAILS.
- INSTALL 12" YELLOW CROSSWALK PER CALTRANS STD PLAN A24E. CROSSWALK WIDTH=15' CLEAR.
- INSTALL EDGE OF TRAVELED WAY PAVEMENT MARKERS PER DETAIL 26, CALTRANS STD PLAN A20B.
- INSTALL DOUBLE 4" YELLOW EDGE LINE AND PAVEMENT MARKERS LINE PER DETAIL 29, CALTRANS STD PLAN A20B.

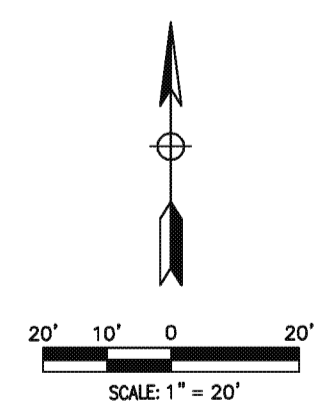

SEE SHEET SPD-301 FOR CONTINUATION  
MATCH LINE - STA 116+25

MATCH LINE - STA 120+00  
SEE BOTTOM LEFT FOR CONTINUATION

SEE TOP RIGHT FOR CONTINUATION  
MATCH LINE - STA 120+00

MATCH LINE - STA 124+00  
SEE SHEET SPD-303 FOR CONTINUATION

DESIGN REVIEW SUBMITTAL,  
NOT FOR CONSTRUCTION

**AECOM**  
AECOM Technical Services, Inc.  
510 S. FLOWER ST., 4TH FLOOR  
LOS ANGELES, CA 90071  
T 213.330.7200 F 213.330.7201  
www.aecom.com

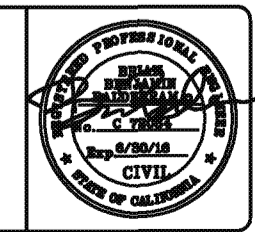

REVISIONS		
MARK	DATE	DESCRIPTION

**CITY OF INGLEWOOD, CALIFORNIA  
PUBLIC WORKS DEPARTMENT**

PROJECT TITLE:  
**PLANS FOR IMPROVEMENT OF  
CENTURY BOULEVARD  
INGLEWOOD AVE TO DOTY AVE  
SIGNS AND PVMT DELINEATION - 116+25 TO 124+00**

DESIGNED BY: \_\_\_\_\_  
DRAWN BY: \_\_\_\_\_  
CHECKED BY: \_\_\_\_\_

SUBMITTED BY / APPROVED BY:  
VANESSA MUNOZ, RCE 67683 / CONSULTANT TRAFFIC ENGINEER

DATE: \_\_\_\_\_

PLAN NO. \_\_\_\_\_  
PROFILE SCALE: VERTICAL N/A, HORIZONTAL N/A

PROJECT NO. **SPD-302**  
SHEET NO. \_\_\_\_\_ OF \_\_\_\_\_

ST-4696

ST-4696

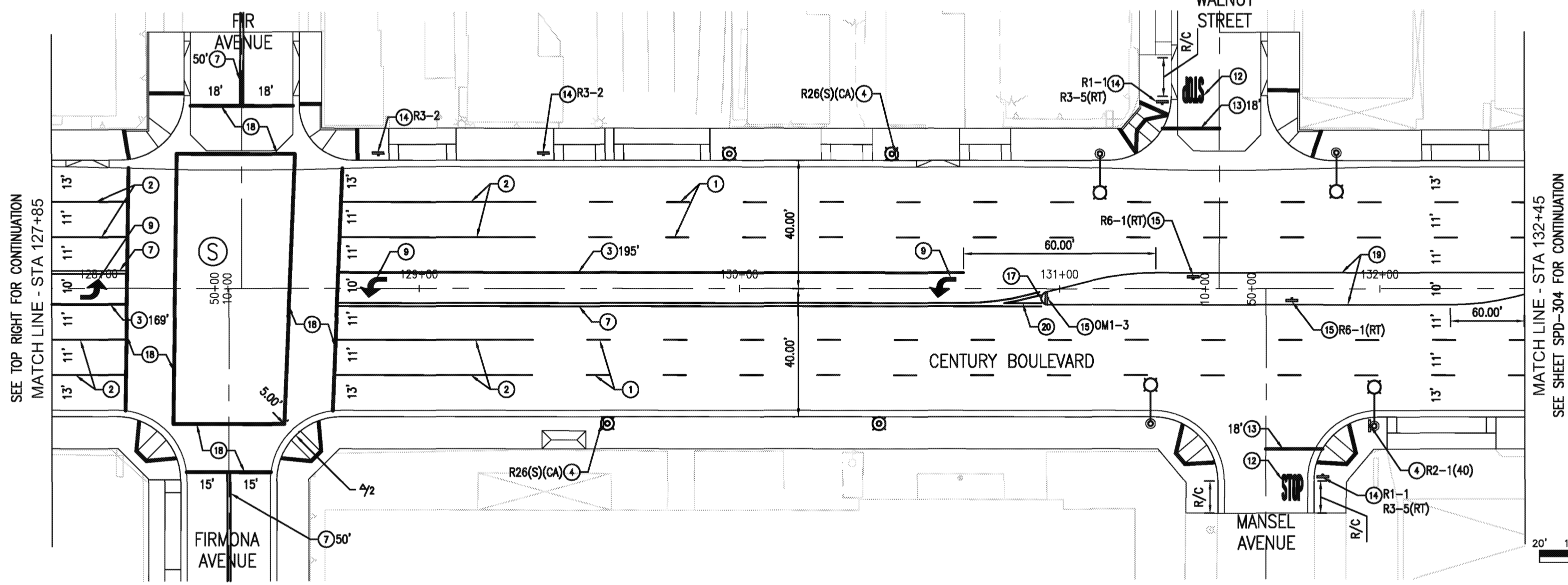
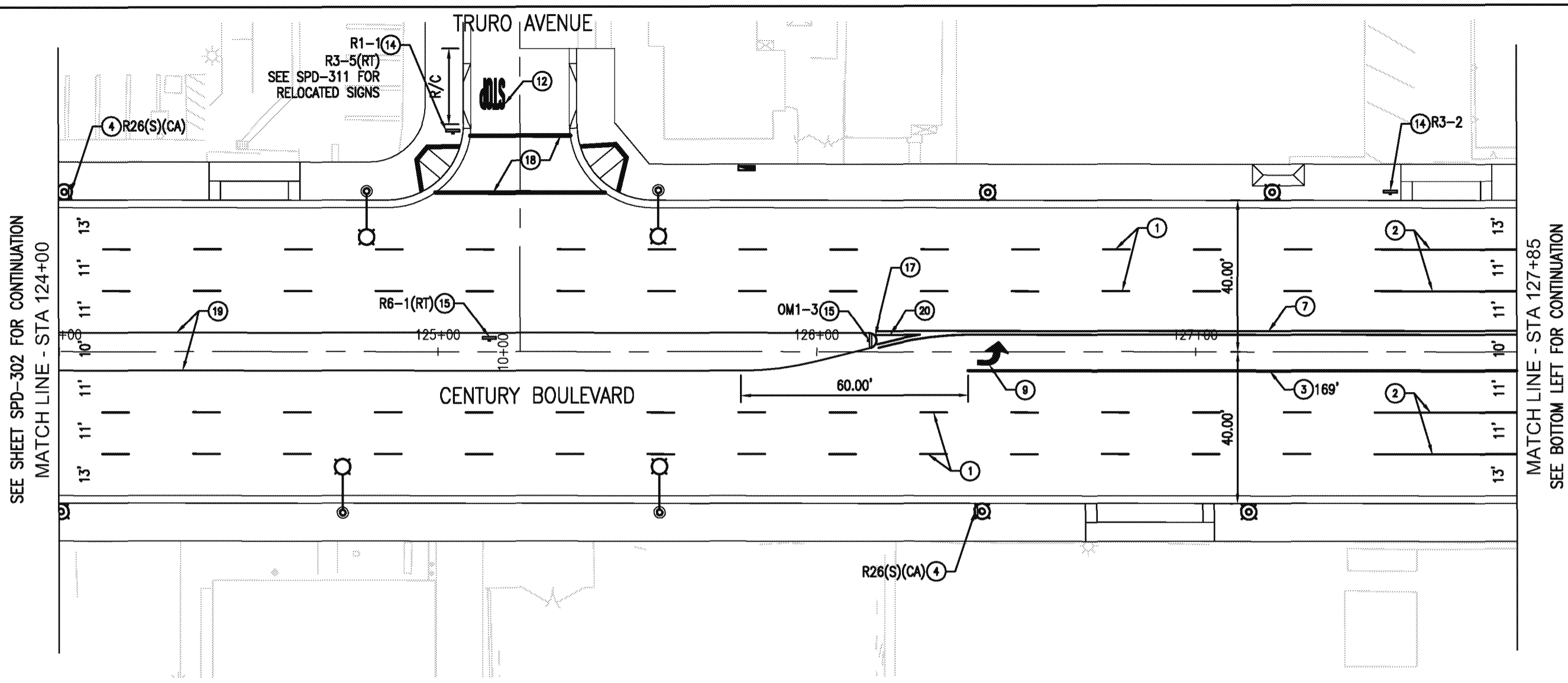

**NOTES:**

- 1. SEE TRAFFIC SIGNAL PLANS FOR ADDITIONAL SIGNS.

**LEGEND:**

- PROPOSED SIGNING OR STRIPING
- ◇ EXISTING SIGNING OR STRIPING
- ⊙ SIGNALIZED INTERSECTION
- 1 POST SIGN
- 12" CROSSWALK OR LIMIT LINE
- ⊙ PROPOSED PEDESTRIAN LIGHTING
- R/C RED CURB
- ↖ TYPE IV ARROW
- ↗ TYPE VII ARROW
- STOP "STOP" PAVEMENT MARKING
- BUS "BUS" PAVEMENT MARKING
- ONLY "ONLY" PAVEMENT MARKING
- PROPOSED STREET LIGHTING
- Y/C YELLOW CURB

**CONSTRUCTION NOTES:**

- INSTALL 4" WHITE LINE AND PAVEMENT MARKERS PER DETAIL 9, CALTRANS STD. PLAN A20A.
- INSTALL LEAD LINE PAVEMENT MARKERS PER "LEAD LINE DETAIL" ON SHEET SPD-301.
- INSTALL 8" WHITE LINE AND PAVEMENT MARKERS PER DETAIL 3B, CALTRANS STD. PLAN A20D.
- INSTALL ROADSIDE SIGN USING STRAP AND SADDLE BRACKET METHOD PER CALTRANS STD PLAN RS4.
- INSTALL 8" WHITE LINE AND PAVEMENT MARKERS FOR LANE DROP PER DETAIL 37B, CALTRANS STD. PLAN A20C.
- INSTALL 4" WHITE LINE PER DETAIL 27B, CALTRANS STD PLAN A20B.
- INSTALL DOUBLE 4" YELLOW LINE AND PAVEMENT MARKERS PER DETAIL 22, CALTRANS STD PLAN A20A.
- INSTALL 4" WHITE LINE FOR LANE LINE EXTENSION THROUGH INTERSECTION PER DETAIL 40, CALTRANS STD. PLAN A20D.
- INSTALL TYPE IV, LEFT OR RIGHT, ARROW PER CALTRANS STD PLAN A24A.
- INSTALL 8" WHITE LINE AND PAVEMENT MARKERS PER DETAIL 38A, CALTRANS STD. PLAN A20D.
- INSTALL PAVEMENT MARKING PER CALTRANS STD PLAN A24D AND A24E.
- INSTALL 12" WHITE LIMIT LINE OR CROSSWALK PER CALTRANS STD PLAN A24E. CROSSWALK WIDTH=15' CLEAR.
- FURNISH AND INSTALL 1 POST ROADSIDE SIGN PER CALTRANS STD PLANS RS1.
- FURNISH AND INSTALL 1 POST ROADSIDE SIGN IN MEDIAN PER CALTRANS STD PLANS RS1 WITH MODIFIED GROUND CLEARANCE OF 1.5' FROM BOTTOM OF SIGN.
- NOT USED
- PAINT ISLAND NOSE YELLOW, SEE SPD-311 FOR DETAILS.
- INSTALL 12" YELLOW CROSSWALK PER CALTRANS STD PLAN A24E. CROSSWALK WIDTH=15' CLEAR.
- INSTALL EDGE OF TRAVELED WAY PAVEMENT MARKERS PER DETAIL 26, CALTRANS STD PLAN A20B.
- INSTALL DOUBLE 4" YELLOW EDGE LINE AND PAVEMENT MARKERS LINE PER DETAIL 29, CALTRANS STD PLAN A20B.

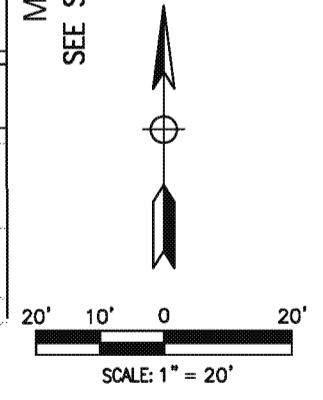

SEE SHEET SPD-302 FOR CONTINUATION  
MATCH LINE - STA 124+00

MATCH LINE - STA 127+85  
SEE BOTTOM LEFT FOR CONTINUATION

SEE TOP RIGHT FOR CONTINUATION  
MATCH LINE - STA 127+85

MATCH LINE - STA 132+45  
SEE SHEET SPD-304 FOR CONTINUATION

ST-4696

ST-4696

DESIGN REVIEW SUBMITTAL,  
NOT FOR CONSTRUCTION

REVISIONS		
MARK	DATE	DESCRIPTION

**CITY OF INGLEWOOD, CALIFORNIA  
PUBLIC WORKS DEPARTMENT**

PROJECT TITLE:  
**PLANS FOR IMPROVEMENT OF  
CENTURY BOULEVARD  
INGLEWOOD AVE TO DOTY AVE  
SIGNS AND PVMT DELINEATION - 124+00 TO 132+45**

DESIGNED BY: \_\_\_\_\_  
DRAWN BY: \_\_\_\_\_  
CHECKED BY: \_\_\_\_\_

SUBMITTED BY / APPROVED BY:  
VANESSA MUNOZ, RCE 67683 / CONSULTANT TRAFFIC ENGINEER  
DATE: \_\_\_\_\_

PLAN NO. \_\_\_\_\_  
PROFILE SCALE: VERTICAL N/A, HORIZONTAL N/A  
SHEET NO. **SPD-303** OF \_\_\_\_\_

**AECOM**

AECOM Technical Services, Inc.  
510 S. FLOWER ST., 4TH FLOOR  
LOS ANGELES, CA 90071  
T 213.330.7200 F 213.330.7201  
www.aecom.com

Professional Engineer Seal for VANESSA MUNOZ, RCE 67683, State of California, Civil Engineering, Exp. 8/30/16.

Drawing Name: I:\9847\F901\Projects\LA\F901\Drawings\SPD\SPD-303.dwg, User: vanm, Date: 12/15/2015 9:44AM, Title: Intranet

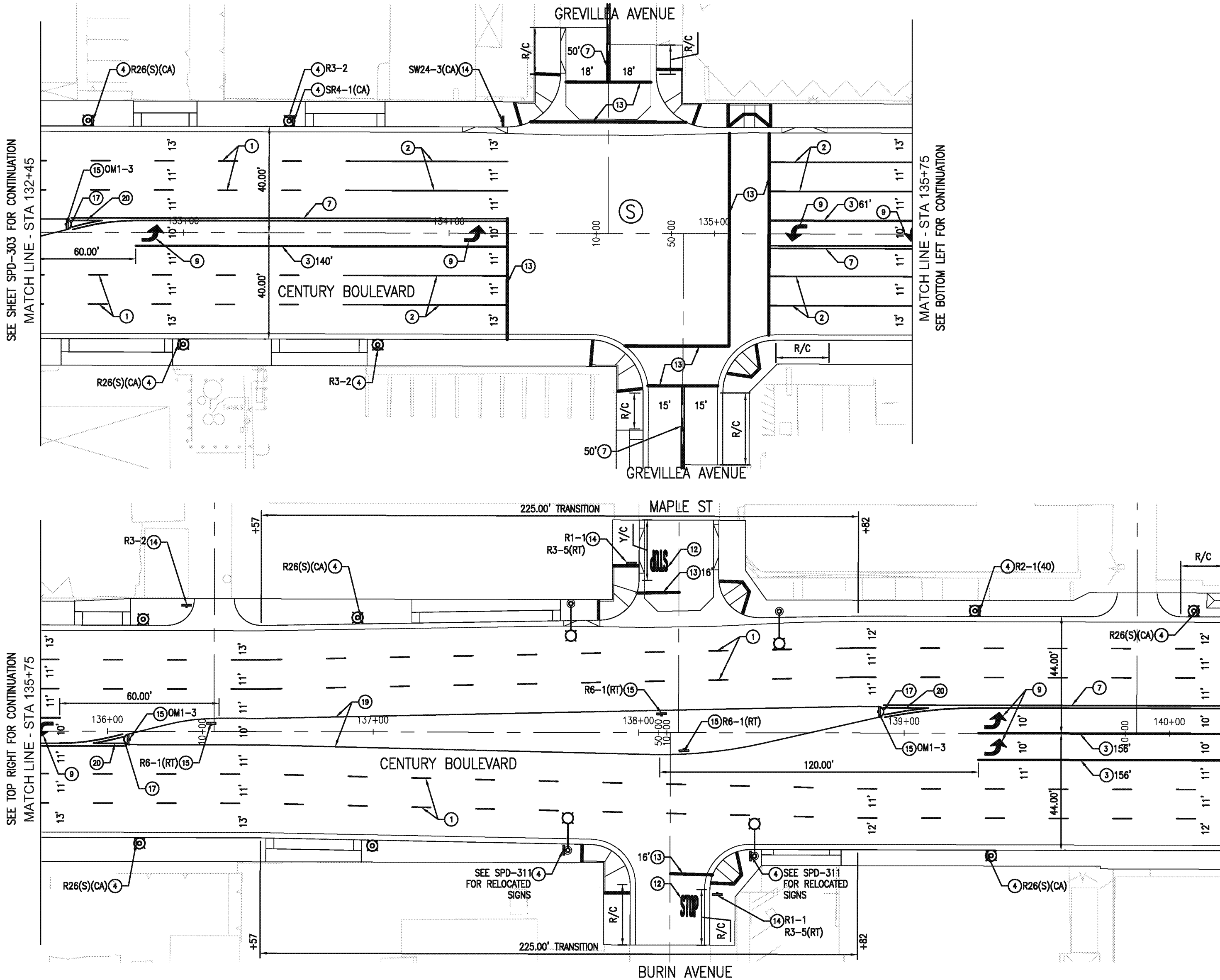

**NOTES:**

- SEE TRAFFIC SIGNAL PLANS FOR ADDITIONAL SIGNS.

**LEGEND:**

- PROPOSED SIGNING OR STRIPING
- ◇ EXISTING SIGNING OR STRIPING
- ⊙ SIGNALIZED INTERSECTION
- 1 POST SIGN
- 12" CROSSWALK OR LIMIT LINE
- ⊙ PROPOSED PEDESTRIAN LIGHTING
- R/C RED CURB
- ↩ TYPE IV ARROW
- ↪ TYPE VII ARROW
- STOP "STOP" PAVEMENT MARKING
- BUS "BUS" PAVEMENT MARKING
- ONLY "ONLY" PAVEMENT MARKING
- ⊙ PROPOSED STREET LIGHTING
- Y/C YELLOW CURB

**CONSTRUCTION NOTES:**

- INSTALL 4" WHITE LINE AND PAVEMENT MARKERS PER DETAIL 9, CALTRANS STD. PLAN A20A.
- INSTALL LEAD LINE PAVEMENT MARKERS PER "LEAD LINE DETAIL" ON SHEET SPD-301.
- INSTALL 8" WHITE LINE AND PAVEMENT MARKERS PER DETAIL 38, CALTRANS STD. PLAN A20D.
- INSTALL ROADSIDE SIGN USING STRAP AND SADDLE BRACKET METHOD PER CALTRANS STD PLAN RS4.
- INSTALL 8" WHITE LINE AND PAVEMENT MARKERS FOR LANE DROP PER DETAIL 37B, CALTRANS STD. PLAN A20C.
- INSTALL 4" WHITE LINE PER DETAIL 27B, CALTRANS STD PLAN A20B.
- INSTALL DOUBLE 4" YELLOW LINE AND PAVEMENT MARKERS PER DETAIL 22, CALTRANS STD PLAN A20A.
- INSTALL 4" WHITE LINE FOR LANE LINE EXTENSION THROUGH INTERSECTION PER DETAIL 40, CALTRANS STD. PLAN A20D.
- INSTALL TYPE IV, LEFT OR RIGHT, ARROW PER CALTRANS STD PLAN A24A.
- INSTALL 8" WHITE LINE AND PAVEMENT MARKERS PER DETAIL 38A, CALTRANS STD. PLAN A20D.
- INSTALL PAVEMENT MARKING PER CALTRANS STD PLAN A24D AND A24E.
- INSTALL 12" WHITE LIMIT LINE OR CROSSWALK PER CALTRANS STD PLAN A24E. CROSSWALK WIDTH=15' CLEAR.
- FURNISH AND INSTALL 1 POST ROADSIDE SIGN PER CALTRANS STD PLANS RS1.
- FURNISH AND INSTALL 1 POST ROADSIDE SIGN IN MEDIAN PER CALTRANS STD PLANS RS1 WITH MODIFIED GROUND CLEARANCE OF 1.5' FROM BOTTOM OF SIGN.
- NOT USED
- PAINT ISLAND NOSE YELLOW, SEE SPD-311 FOR DETAILS.
- INSTALL 12" YELLOW CROSSWALK PER CALTRANS STD PLAN A24E. CROSSWALK WIDTH=15' CLEAR.
- INSTALL EDGE OF TRAVELED WAY PAVEMENT MARKERS PER DETAIL 26, CALTRANS STD PLAN A20B.
- INSTALL DOUBLE 4" YELLOW EDGE LINE AND PAVEMENT MARKERS LINE PER DETAIL 29, CALTRANS STD PLAN A20B.

SEE TOP RIGHT FOR CONTINUATION  
MATCH LINE - STA 135+75

SEE SHEET SPD-303 FOR CONTINUATION  
MATCH LINE - STA 132+45

MATCH LINE - STA 135+75  
SEE BOTTOM LEFT FOR CONTINUATION

MATCH LINE - STA 140+20  
SEE SHEET SPD-305 FOR CONTINUATION

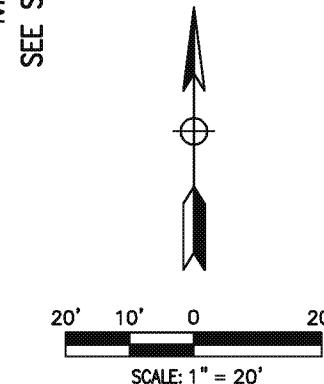

DESIGN REVIEW SUBMITTAL,  
NOT FOR CONSTRUCTION

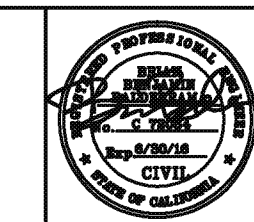

REVISIONS		
MARK	DATE	DESCRIPTION

	<b>CITY OF INGLEWOOD, CALIFORNIA</b> <b>PUBLIC WORKS DEPARTMENT</b>		
	PROJECT TITLE: <b>PLANS FOR IMPROVEMENT OF CENTURY BOULEVARD INGLEWOOD AVE TO DOTY AVE SIGNS AND PVMT DELINEATION - 132+45 TO 140+20</b>		
PLAN SCALE: N/A	DESIGNED BY: _____	SUBMITTED BY / APPROVED BY: VANESSA MUNOZ, RCE 07883 / CONSULTANT TRAFFIC ENGINEER	PROFILE SCALE: VERTICAL N/A HORIZONTAL N/A
DRAWN BY: _____	CHECKED BY: _____	DATE: _____	PLAN NO. <b>SPD-304</b> SHEET NO. OF

Drawing Name: \\SL1\F500\proj\SL\AFR010\Drawings\01\0803\_CBR\_1\Inglewood\CAD\Civil\Sheet\Project 3 - Inglewood to Doty\12 Signs and PVMT\SPD-304.dwg  
 List Owner: August 31, 2016 - 10:44AM by: hanson

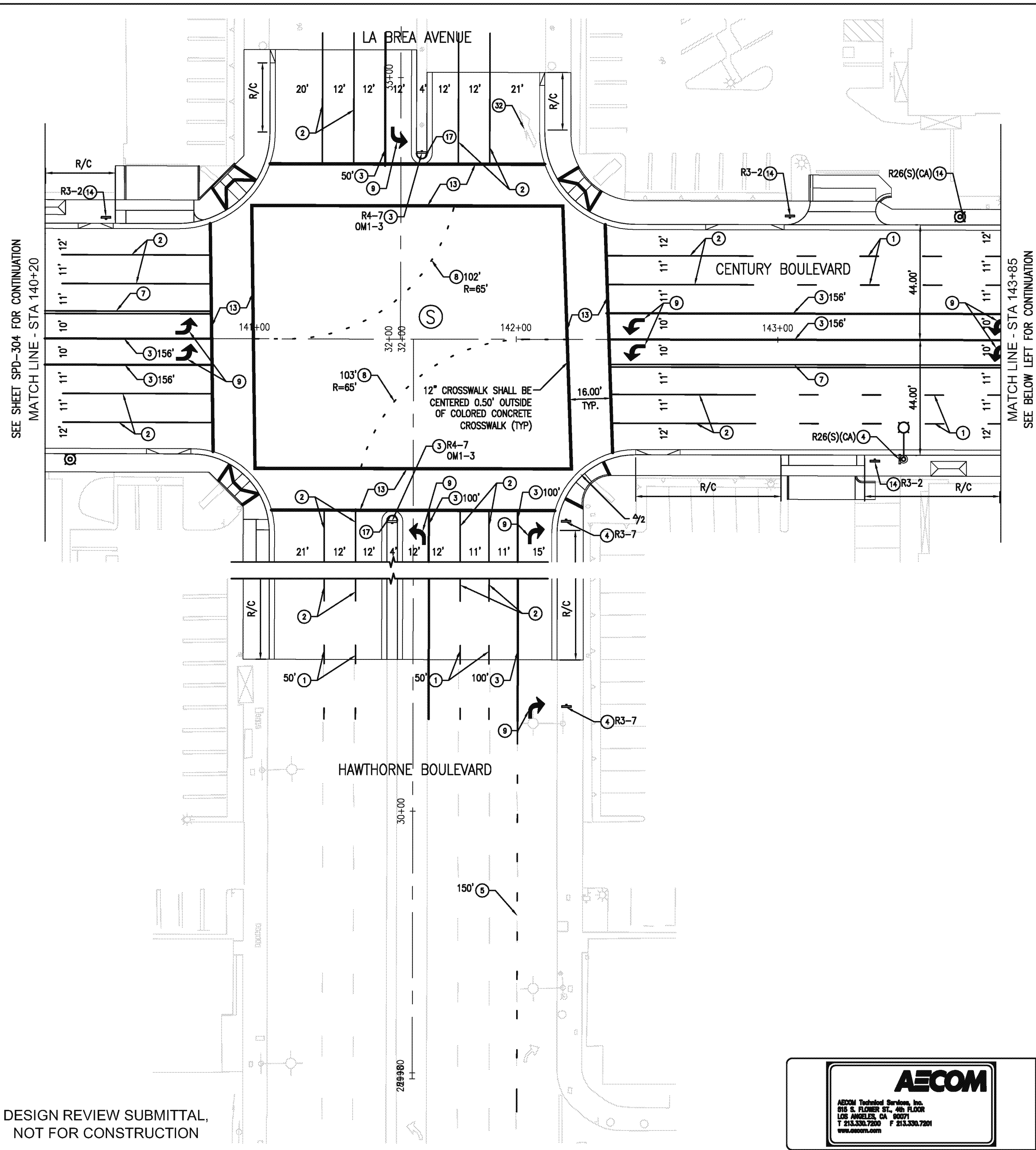

**NOTES:**

1. SEE TRAFFIC SIGNAL PLANS FOR ADDITIONAL SIGNS.

**LEGEND:**

- PROPOSED SIGNING OR STRIPING
- EXISTING SIGNING OR STRIPING
- SIGNALIZED INTERSECTION
- 1 POST SIGN
- 12" CROSSWALK OR LIMIT LINE
- PROPOSED PEDESTRIAN LIGHTING
- RED CURB
- TYPE IV ARROW
- TYPE VII ARROW
- "STOP" PAVEMENT MARKING
- "BUS" PAVEMENT MARKING
- "ONLY" PAVEMENT MARKING
- PROPOSED STREET LIGHTING
- YELLOW CURB

**CONSTRUCTION NOTES:**

- 1) INSTALL 4" WHITE LINE AND PAVEMENT MARKERS PER DETAIL 9, CALTRANS STD. PLAN A20A.
- 2) INSTALL LEAD LINE PAVEMENT MARKERS PER "LEAD LINE DETAIL" ON SHEET SPD-301.
- 3) INSTALL 8" WHITE LINE AND PAVEMENT MARKERS PER DETAIL 38, CALTRANS STD. PLAN A20D.
- 4) INSTALL ROADSIDE SIGN USING STRAP AND SADDLE BRACKET METHOD PER CALTRANS STD PLAN RSA.
- 5) INSTALL 8" WHITE LINE AND PAVEMENT MARKERS FOR LANE DROP PER DETAIL 37B, CALTRANS STD. PLAN A20C.
- 6) INSTALL 4" WHITE LINE PER DETAIL 27B, CALTRANS STD PLAN A20B.
- 7) INSTALL DOUBLE 4" YELLOW LINE AND PAVEMENT MARKERS PER DETAIL 22, CALTRANS STD PLAN A20A.
- 8) INSTALL 4" WHITE LINE FOR LANE LINE EXTENSION THROUGH INTERSECTION PER DETAIL 40, CALTRANS STD. PLAN A20D.
- 9) INSTALL TYPE IV, LEFT OR RIGHT, ARROW PER CALTRANS STD PLAN A24A.
- 10) INSTALL 8" WHITE LINE AND PAVEMENT MARKERS PER DETAIL 38A, CALTRANS STD. PLAN A20D.
- 12) INSTALL PAVEMENT MARKING PER CALTRANS STD PLAN A24D AND A24E.
- 13) INSTALL 12" WHITE LIMIT LINE OR CROSSWALK PER CALTRANS STD PLAN A24E. CROSSWALK WIDTH=16' CLEAR.
- 14) FURNISH AND INSTALL 1 POST ROADSIDE SIGN PER CALTRANS STD PLANS RS1.
- 15) FURNISH AND INSTALL 1 POST ROADSIDE SIGN IN MEDIAN PER CALTRANS STD PLANS RS1 WITH MODIFIED GROUND CLEARANCE OF 1.5' FROM BOTTOM OF SIGN.
- 16) NOT USED
- 17) PAINT ISLAND NOSE YELLOW, SEE SPD-311 FOR DETAILS.
- 18) INSTALL 12" YELLOW CROSSWALK PER CALTRANS STD PLAN A24E. CROSSWALK WIDTH=15' CLEAR.
- 19) INSTALL EDGE OF TRAVELED WAY PAVEMENT MARKERS PER DETAIL 26, CALTRANS STD PLAN A20B.

**REMOVAL NOTES:**

- 31) REMOVE WHITE LINE AND PAVEMENT MARKERS.
- 32) REMOVE TYPE VII (R) ARROW.

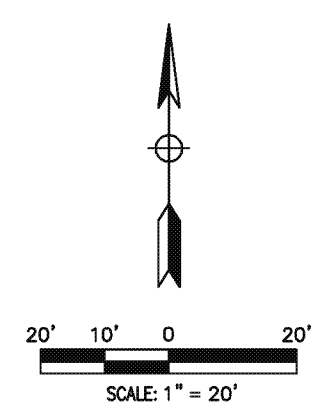

SEE SHEET SPD-304 FOR CONTINUATION  
MATCH LINE - STA 140+20

MATCH LINE - STA 143+85  
SEE BELOW LEFT FOR CONTINUATION

DESIGN REVIEW SUBMITTAL,  
NOT FOR CONSTRUCTION

**AECOM**  
 AECOM Technical Services, Inc.  
 515 S. FLOWER ST., 4th FLOOR  
 LOS ANGELES, CA 90071  
 T 213.330.7200 F 213.330.7201  
 www.aecom.com

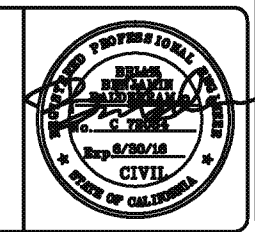

REVISIONS		
MARK	DATE	DESCRIPTION

**CITY OF INGLEWOOD, CALIFORNIA**  
**PUBLIC WORKS DEPARTMENT**

PROJECT TITLE:  
**PLANS FOR IMPROVEMENT OF  
 CENTURY BOULEVARD  
 INGLEWOOD AVE TO DOTY AVE  
 SIGNS AND PVMT DELINEATION - 140+20 TO 143+85**

DESIGNED BY: \_\_\_\_\_  
 DRAWN BY: \_\_\_\_\_  
 CHECKED BY: \_\_\_\_\_

SUBMITTED BY / APPROVED BY:  
 VANESSA MUNOZ, RCE 67983 / CONSULTANT TRAFFIC ENGINEER DATE \_\_\_\_\_

PLAN NO. \_\_\_\_\_  
**SPD-305**  
 SHEET NO. \_\_\_\_\_ OF \_\_\_\_\_

NOTES:

- 1. SEE TRAFFIC SIGNAL PLANS FOR ADDITIONAL SIGNS.

LEGEND:

- PROPOSED SIGNING OR STRIPING
- ◇ EXISTING SIGNING OR STRIPING
- ⊙ SIGNALIZED INTERSECTION
- 1 POST SIGN
- 12" CROSSWALK OR LIMIT LINE
- ⊙ PROPOSED PEDESTRIAN LIGHTING
- R/C RED CURB
- ↖ TYPE IV ARROW
- ↗ TYPE VII ARROW
- STOP "STOP" PAVEMENT MARKING
- BUS "BUS" PAVEMENT MARKING
- ONLY "ONLY" PAVEMENT MARKING
- PROPOSED STREET LIGHTING
- Y/C YELLOW CURB

CONSTRUCTION NOTES:

- 1) INSTALL 4" WHITE LINE AND PAVEMENT MARKERS PER DETAIL 9, CALTRANS STD. PLAN A20A.
- 2) INSTALL LEAD LINE PAVEMENT MARKERS PER "LEAD LINE DETAIL" ON SHEET SPD-301.
- 3) INSTALL 8" WHITE LINE AND PAVEMENT MARKERS PER DETAIL 38, CALTRANS STD. PLAN A20D.
- 4) INSTALL ROADSIDE SIGN USING STRAP AND SADDLE BRACKET METHOD PER CALTRANS STD PLAN RSA.
- 5) INSTALL 8" WHITE LINE AND PAVEMENT MARKERS FOR LANE DROP PER DETAIL 37B, CALTRANS STD. PLAN A20C.
- 6) INSTALL 4" WHITE LINE PER DETAIL 27B, CALTRANS STD PLAN A20B.
- 7) INSTALL DOUBLE 4" YELLOW LINE AND PAVEMENT MARKERS PER DETAIL 22, CALTRANS STD PLAN A20A.
- 8) INSTALL 4" WHITE LINE FOR LANE LINE EXTENSION THROUGH INTERSECTION PER DETAIL 40, CALTRANS STD. PLAN A20D.
- 9) INSTALL TYPE IV, LEFT OR RIGHT, ARROW PER CALTRANS STD PLAN A24A.
- 10) INSTALL 8" WHITE LINE AND PAVEMENT MARKERS PER DETAIL 38A, CALTRANS STD. PLAN A20D.
- 12) INSTALL PAVEMENT MARKING PER CALTRANS STD PLAN A24D AND A24E.
- 13) INSTALL 12" WHITE LIMIT LINE OR CROSSWALK PER CALTRANS STD PLAN A24E. CROSSWALK WIDTH=15' CLEAR.
- 14) FURNISH AND INSTALL 1 POST ROADSIDE SIGN PER CALTRANS STD PLANS RS1.
- 15) FURNISH AND INSTALL 1 POST ROADSIDE SIGN IN MEDIAN PER CALTRANS STD PLANS RS1 WITH MODIFIED GROUND CLEARANCE OF 1.5' FROM BOTTOM OF SIGN.
- 16) NOT USED
- 17) PAINT ISLAND NOSE YELLOW, SEE SPD-311 FOR DETAILS.
- 18) INSTALL 12" YELLOW CROSSWALK PER CALTRANS STD PLAN A24E. CROSSWALK WIDTH=15' CLEAR.
- 19) INSTALL EDGE OF TRAVELED WAY PAVEMENT MARKERS PER DETAIL 26, CALTRANS STD PLAN A20B.
- 20) INSTALL DOUBLE 4" YELLOW EDGE LINE AND PAVEMENT MARKERS LINE PER DETAIL 29, CALTRANS STD PLAN A20B.

SEE TOP RIGHT FOR CONTINUATION  
MATCH LINE - STA 143+85

MATCH LINE - STA 148+00  
SEE SHEET SPD-306 FOR CONTINUATION

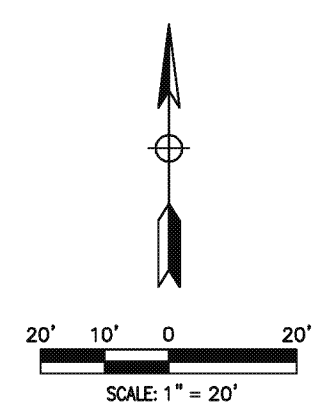
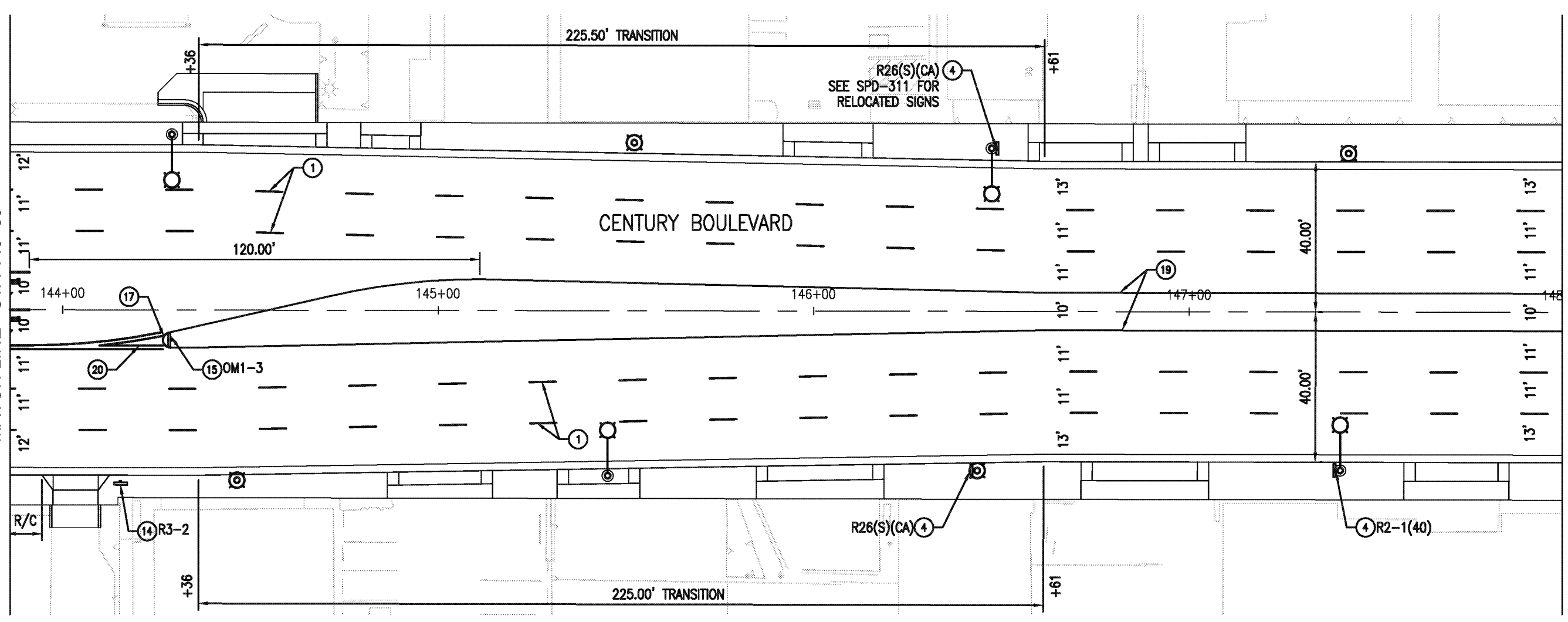

DESIGN REVIEW SUBMITTAL,  
NOT FOR CONSTRUCTION

 <b>AECOM</b> <small>AECOM Technical Services, Inc.          515 S. FLOWER ST., 4th FLOOR          LOS ANGELES, CA 90071          T 213.330.7200 F 213.330.7201          www.aecom.com</small>		<b>REVISIONS</b> MARK    DATE    DESCRIPTION		 <b>CITY OF INGLEWOOD, CALIFORNIA</b> <b>PUBLIC WORKS DEPARTMENT</b> PROJECT TITLE: <b>PLANS FOR IMPROVEMENT OF          CENTURY BOULEVARD          INGLEWOOD AVE TO DOTY AVE          SIGNS AND PVMT DELINEATION - 143+85 TO 148+00</b>	 PROFILE SCALE: VERTICAL: N/A HORIZONTAL: N/A
		DESIGNED BY: _____ DRAWN BY: _____ CHECKED BY: _____	SUBMITTED BY / APPROVED BY: VANESSA MUNOZ, RCE 07883 / CONSULTANT TRAFFIC ENGINEER    DATE _____		

ST-4696

ST-4696

SEE SHEET SPD-305 FOR CONTINUATION  
MATCH LINE - STA 148+00

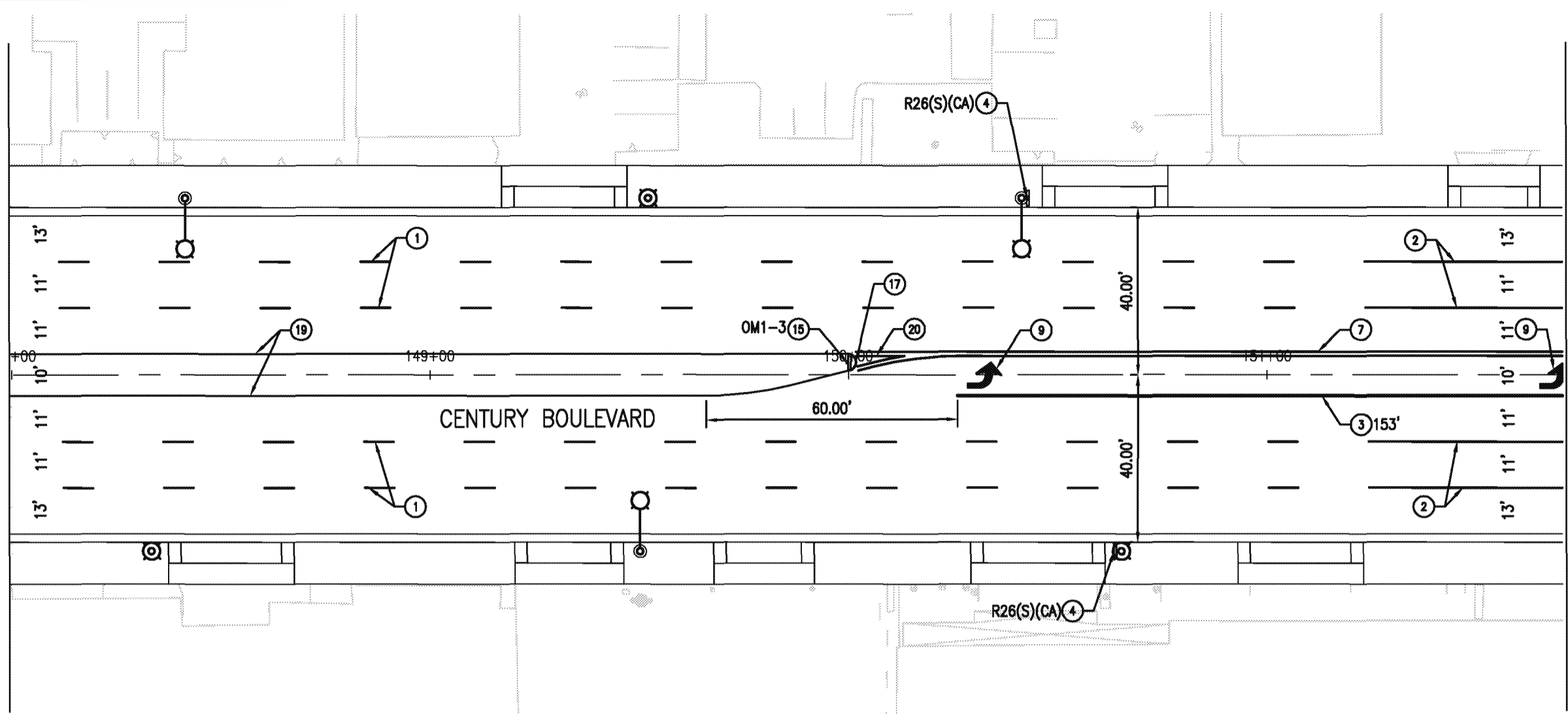

MATCH LINE - STA 151+70  
SEE BOTTOM LEFT FOR CONTINUATION

**NOTES:**

- 1. SEE TRAFFIC SIGNAL PLANS FOR ADDITIONAL SIGNS.

**LEGEND:**

- PROPOSED SIGNING OR STRIPING
- ◇ EXISTING SIGNING OR STRIPING
- ⊙ SIGNALIZED INTERSECTION
- 1 POST SIGN
- 12" CROSSWALK OR LIMIT LINE
- ⊙ PROPOSED PEDESTRIAN LIGHTING
- R/C RED CURB
- ↖ TYPE IV ARROW
- ↗ TYPE VII ARROW
- STOP "STOP" PAVEMENT MARKING
- BUS "BUS" PAVEMENT MARKING
- ONLY "ONLY" PAVEMENT MARKING
- PROPOSED STREET LIGHTING
- Y/C YELLOW CURB

**CONSTRUCTION NOTES:**

- 1. INSTALL 4" WHITE LINE AND PAVEMENT MARKERS PER DETAIL 9, CALTRANS STD. PLAN A20A.
- 2. INSTALL LEAD LINE PAVEMENT MARKERS PER "LEAD LINE DETAIL" ON SHEET SPD-301.
- 3. INSTALL 8" WHITE LINE AND PAVEMENT MARKERS PER DETAIL 3B, CALTRANS STD. PLAN A20D.
- 4. INSTALL ROADSIDE SIGN USING STRAP AND SADDLE BRACKET METHOD PER CALTRANS STD PLAN RS4.
- 5. INSTALL 8" WHITE LINE AND PAVEMENT MARKERS FOR LANE DROP PER DETAIL 37B, CALTRANS STD. PLAN A20C.
- 6. INSTALL 4" WHITE LINE PER DETAIL 27B, CALTRANS STD PLAN A20B.
- 7. INSTALL DOUBLE 4" YELLOW LINE AND PAVEMENT MARKERS PER DETAIL 22, CALTRANS STD PLAN A20A.
- 8. INSTALL 4" WHITE LINE FOR LANE LINE EXTENSION THROUGH INTERSECTION PER DETAIL 40, CALTRANS STD. PLAN A20D.
- 9. INSTALL TYPE IV, LEFT OR RIGHT, ARROW PER CALTRANS STD PLAN A24A.
- 10. INSTALL 8" WHITE LINE AND PAVEMENT MARKERS PER DETAIL 38A, CALTRANS STD. PLAN A20D.
- 12. INSTALL PAVEMENT MARKING PER CALTRANS STD PLAN A24D AND A24E.
- 13. INSTALL 12" WHITE LIMIT LINE OR CROSSWALK PER CALTRANS STD PLAN A24E. CROSSWALK WIDTH=15' CLEAR.
- 14. FURNISH AND INSTALL 1 POST ROADSIDE SIGN PER CALTRANS STD PLANS RS1.
- 15. FURNISH AND INSTALL 1 POST ROADSIDE SIGN IN MEDIAN PER CALTRANS STD PLANS RS1 WITH MODIFIED GROUND CLEARANCE OF 1.5' FROM BOTTOM OF SIGN.
- 16. NOT USED
- 17. PAINT ISLAND NOSE YELLOW, SEE SPD-311 FOR DETAILS.
- 18. INSTALL 12" YELLOW CROSSWALK PER CALTRANS STD PLAN A24E. CROSSWALK WIDTH=15' CLEAR.
- 19. INSTALL EDGE OF TRAVELED WAY PAVEMENT MARKERS PER DETAIL 26, CALTRANS STD PLAN A20B.
- 20. INSTALL DOUBLE 4" YELLOW EDGE LINE AND PAVEMENT MARKERS LINE PER DETAIL 29, CALTRANS STD PLAN A20B.

SEE TOP RIGHT FOR CONTINUATION  
MATCH LINE - STA 151+70

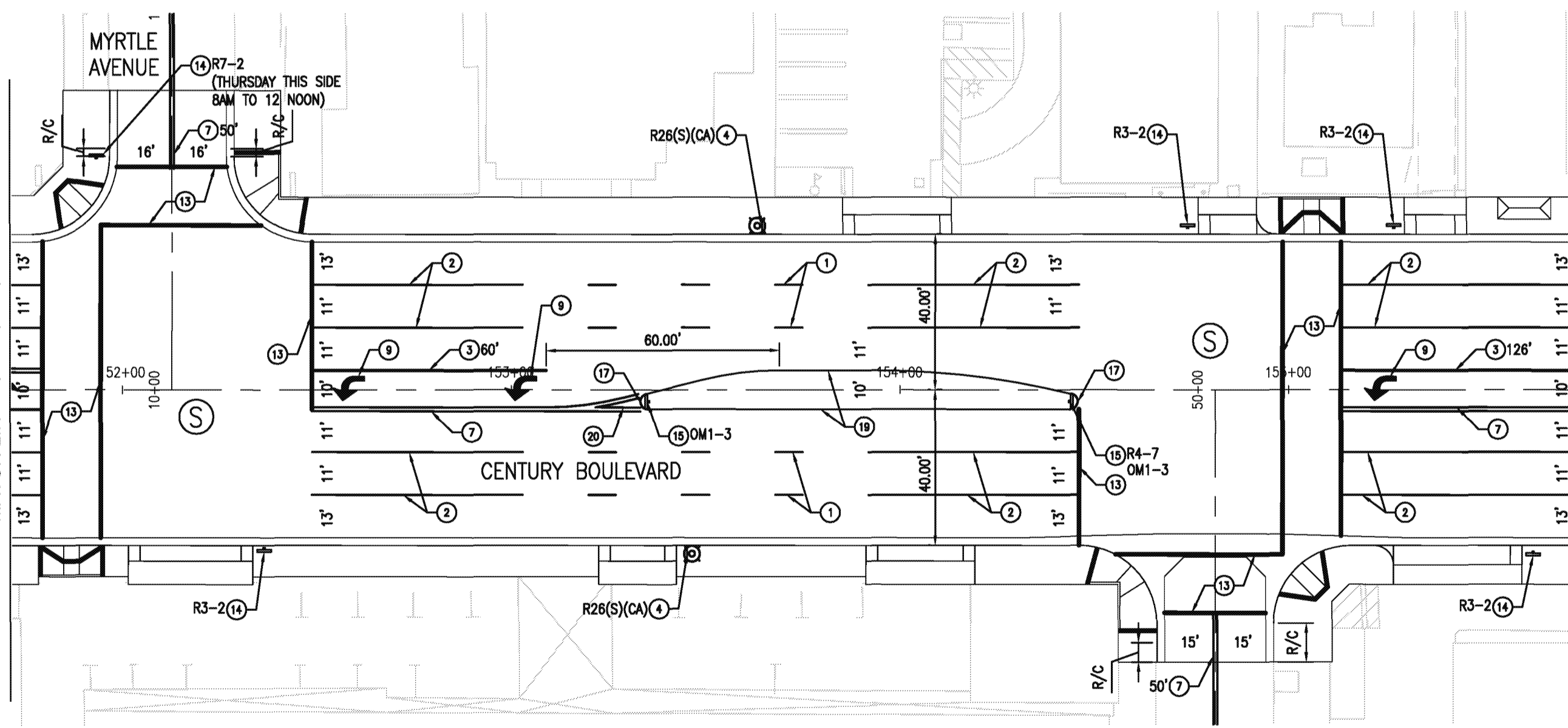

MATCH LINE - STA 155+75  
SEE SHEET SPD-307 FOR CONTINUATION

FREEMAN AVENUE

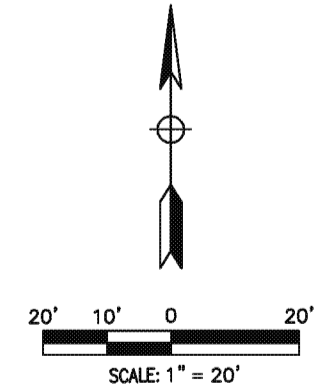

ST-4696

DESIGN REVIEW SUBMITTAL,  
NOT FOR CONSTRUCTION

**AECOM**  
AECOM Technical Services, Inc.  
510 S. FLOWER ST., 4th FLOOR  
LOS ANGELES, CA 90071  
T 213.330.7200 F 213.330.7201  
www.aecom.com

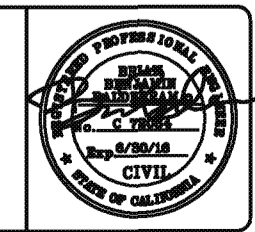

REVISIONS		
MARK	DATE	DESCRIPTION

**CITY OF INGLEWOOD, CALIFORNIA  
PUBLIC WORKS DEPARTMENT**

PROJECT TITLE:  
**PLANS FOR IMPROVEMENT OF  
CENTURY BOULEVARD  
INGLEWOOD AVE TO DOTY AVE  
SIGNS AND PVMT DELINEATION - 148+00 TO 155+75**

DESIGNED BY: \_\_\_\_\_  
DRAWN BY: \_\_\_\_\_  
CHECKED BY: \_\_\_\_\_

SUBMITTED BY / APPROVED BY:  
VANESSA MUNOZ, RCE 67683 / CONSULTANT TRAFFIC ENGINEER

DATE: \_\_\_\_\_

PLAN NO. SPD-307  
SHEET NO. \_\_\_\_\_ OF \_\_\_\_\_

Drawing Name: W:\01\0000\_CBSR\_Improvement\CAD\DWG\Sheet\Project 3 - Inglewood to Doty\16 Signs and PVMT SPD-307.dwg  
Last Updated: August 31, 2015 - 9:46AM by: hmanon

ST-4696

ST-4696

ST-4696

FLOWER STREET

CENTURY BOULEVARD

R26(S)(CA) ④

R1-14  
R3-5(RT)

⑫

⑬

⑭

⑮

⑯

⑰

⑱

⑲

⑳

㉑

㉒

㉓

㉔

㉕

㉖

㉗

㉘

㉙

㉚

㉛

㉜

㉝

㉞

㉟

㊱

㊲

㊳

㊴

㊵

㊶

㊷

㊸

㊹

㊺

㊻

㊼

㊽

㊾

㊿

1

2

3

4

5

6

7

NOTES:

- 1. SEE TRAFFIC SIGNAL PLANS FOR ADDITIONAL SIGNS.

LEGEND:

- PROPOSED SIGNING OR STRIPING
- ◇ EXISTING SIGNING OR STRIPING
- Ⓢ SIGNALIZED INTERSECTION
- ⊥ 1 POST SIGN
- ▬ 12" CROSSWALK OR LIMIT LINE
- ⊙ PROPOSED PEDESTRIAN LIGHTING
- R/C RED CURB
- ⤴ TYPE IV ARROW
- ⤵ TYPE VII ARROW
- Ⓢ "STOP" PAVEMENT MARKING
- Ⓛ "BUS" PAVEMENT MARKING
- ONLY "ONLY" PAVEMENT MARKING
- PROPOSED STREET LIGHTING
- Y/C YELLOW CURB

CONSTRUCTION NOTES:

- ① INSTALL 4" WHITE LINE AND PAVEMENT MARKERS PER DETAIL 9, CALTRANS STD. PLAN A20A.
- ② INSTALL LEAD LINE PAVEMENT MARKERS PER "LEAD LINE DETAIL" ON SHEET SPD-301.
- ③ INSTALL 8" WHITE LINE AND PAVEMENT MARKERS PER DETAIL 38, CALTRANS STD. PLAN A20D.
- ④ INSTALL ROADSIDE SIGN USING STRAP AND SADDLE BRACKET METHOD PER CALTRANS STD PLAN RS4.
- ⑤ INSTALL 8" WHITE LINE AND PAVEMENT MARKERS FOR LANE DROP PER DETAIL 37B, CALTRANS STD. PLAN A20C.
- ⑥ INSTALL 4" WHITE LINE PER DETAIL 27B, CALTRANS STD PLAN A20B.
- ⑦ INSTALL DOUBLE 4" YELLOW LINE AND PAVEMENT MARKERS PER DETAIL 22, CALTRANS STD PLAN A20A.
- ⑧ INSTALL 4" WHITE LINE FOR LANE LINE EXTENSION THROUGH INTERSECTION PER DETAIL 40, CALTRANS STD. PLAN A20D.
- ⑨ INSTALL TYPE IV, LEFT OR RIGHT, ARROW PER CALTRANS STD PLAN A24A.
- ⑩ INSTALL 8" WHITE LINE AND PAVEMENT MARKERS PER DETAIL 38A, CALTRANS STD. PLAN A20D.
- ⑪ INSTALL PAVEMENT MARKING PER CALTRANS STD PLAN A24D AND A24E.
- ⑫ INSTALL 12" WHITE LIMIT LINE OR CROSSWALK PER CALTRANS STD PLAN A24E. CROSSWALK WIDTH=15' CLEAR.
- ⑬ FURNISH AND INSTALL 1 POST ROADSIDE SIGN PER CALTRANS STD PLANS RS1.
- ⑭ FURNISH AND INSTALL 1 POST ROADSIDE SIGN IN MEDIAN PER CALTRANS STD PLANS RS1 WITH MODIFIED GROUND CLEARANCE OF 1.5' FROM BOTTOM OF SIGN.
- ⑮ NOT USED
- ⑯ PAINT ISLAND NOSE YELLOW, SEE SPD-311 FOR DETAILS.
- ⑰ INSTALL 12" YELLOW CROSSWALK PER CALTRANS STD PLAN A24E. CROSSWALK WIDTH=15' CLEAR.
- ⑱ INSTALL EDGE OF TRAVELED WAY PAVEMENT MARKERS PER DETAIL 26, CALTRANS STD PLAN A20B.
- ⑳ INSTALL DOUBLE 4" YELLOW EDGE LINE AND PAVEMENT MARKERS LINE PER DETAIL 29, CALTRANS STD PLAN A20B.

SEE SHEET SPD-306 FOR CONTINUATION  
MATCH LINE - STA 155+75

SEE TOP RIGHT FOR CONTINUATION  
MATCH LINE - STA 160+35

MATCH LINE - STA 160+35  
SEE BOTTOM LEFT FOR CONTINUATION

MATCH LINE - STA 164+75  
SEE SHEET SPD-308 FOR CONTINUATION

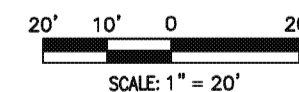

**AECOM**  
AECOM Technical Services, Inc.  
510 S. FLOWER ST., 4TH FLOOR  
LOS ANGELES, CA 90071  
T 213.330.7200 F 213.330.7201  
www.aecom.com

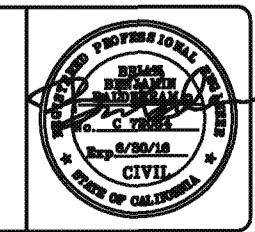

REVISIONS		
MARK	DATE	DESCRIPTION

**CITY OF INGLEWOOD, CALIFORNIA  
PUBLIC WORKS DEPARTMENT**

PROJECT TITLE:  
**PLANS FOR IMPROVEMENT OF  
CENTURY BOULEVARD  
INGLEWOOD AVE TO DOTY AVE  
SIGNS AND PVMT DELINEATION - 155+75 TO 164+75**

DESIGNED BY: \_\_\_\_\_  
DRAWN BY: \_\_\_\_\_  
CHECKED BY: \_\_\_\_\_

SUBMITTED BY / APPROVED BY:  
VANESSA MUNOZ, RCE 67683 / CONSULTANT TRAFFIC ENGINEER

DATE: \_\_\_\_\_

PLAN NO.  
**SPD-308**  
SHEET NO.  
OF

ST-4696

DESIGN REVIEW SUBMITTAL,  
NOT FOR CONSTRUCTION

ST-4696



ST-4696

ST-4696

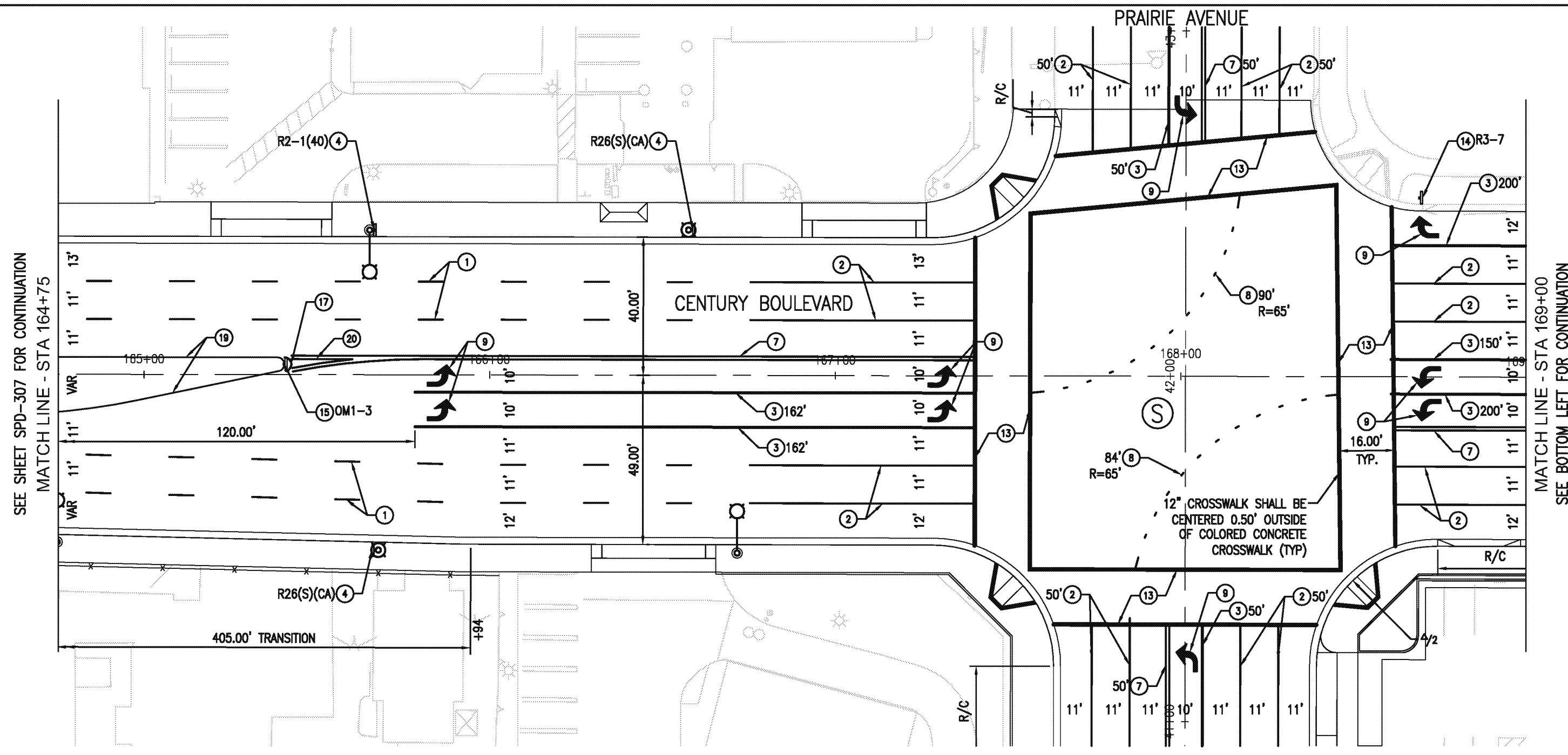

**NOTES:**

- SEE TRAFFIC SIGNAL PLANS FOR ADDITIONAL SIGNS.

**LEGEND:**

- PROPOSED SIGNING OR STRIPING
- EXISTING SIGNING OR STRIPING
- SIGNALIZED INTERSECTION
- 1 POST SIGN
- 12" CROSSWALK OR LIMIT LINE
- PROPOSED PEDESTRIAN LIGHTING
- RED CURB
- YELLOW CURB
- TYPE IV ARROW
- TYPE VII ARROW
- "STOP" PAVEMENT MARKING
- "BUS" PAVEMENT MARKING
- "ONLY" PAVEMENT MARKING
- PROPOSED STREET LIGHTING
- YELLOW CURB

**CONSTRUCTION NOTES:**

- INSTALL 4" WHITE LINE AND PAVEMENT MARKERS PER DETAIL 9, CALTRANS STD. PLAN A20A.
- INSTALL LEAD LINE PAVEMENT MARKERS PER "LEAD LINE DETAIL" ON SHEET SPD-301.
- INSTALL 8" WHITE LINE AND PAVEMENT MARKERS PER DETAIL 38, CALTRANS STD. PLAN A20D.
- INSTALL ROADSIDE SIGN USING STRAP AND SADDLE BRACKET METHOD PER CALTRANS STD PLAN RSA.
- INSTALL 8" WHITE LINE AND PAVEMENT MARKERS FOR LANE DROP PER DETAIL 37B, CALTRANS STD. PLAN A20C.
- INSTALL 4" WHITE LINE PER DETAIL 27B, CALTRANS STD PLAN A20B.
- INSTALL DOUBLE 4" YELLOW LINE AND PAVEMENT MARKERS PER DETAIL 22, CALTRANS STD PLAN A20A.
- INSTALL 4" WHITE LINE FOR LANE LINE EXTENSION THROUGH INTERSECTION PER DETAIL 40, CALTRANS STD. PLAN A20D.
- INSTALL TYPE IV, LEFT OR RIGHT, ARROW PER CALTRANS STD PLAN A24A.
- INSTALL 8" WHITE LINE AND PAVEMENT MARKERS PER DETAIL 38A, CALTRANS STD. PLAN A20D.
- INSTALL PAVEMENT MARKING PER CALTRANS STD PLAN A24D AND A24E.
- INSTALL 12" WHITE LIMIT LINE OR CROSSWALK PER CALTRANS STD PLAN A24E. CROSSWALK WIDTH=16' CLEAR.
- FURNISH AND INSTALL 1 POST ROADSIDE SIGN PER CALTRANS STD PLANS RS1.
- FURNISH AND INSTALL 1 POST ROADSIDE SIGN IN MEDIAN PER CALTRANS STD PLANS RS1 WITH MODIFIED GROUND CLEARANCE OF 1.5' FROM BOTTOM OF SIGN.
- NOT USED
- PAINT ISLAND NOSE YELLOW, SEE SPD-311 FOR DETAILS.
- INSTALL 12" YELLOW CROSSWALK PER CALTRANS STD PLAN A24E. CROSSWALK WIDTH=15' CLEAR.
- INSTALL EDGE OF TRAVELED WAY PAVEMENT MARKERS PER DETAIL 26, CALTRANS STD PLAN A20B.
- INSTALL DOUBLE 4" YELLOW EDGE LINE AND PAVEMENT MARKERS LINE PER DETAIL 29, CALTRANS STD PLAN A20B.

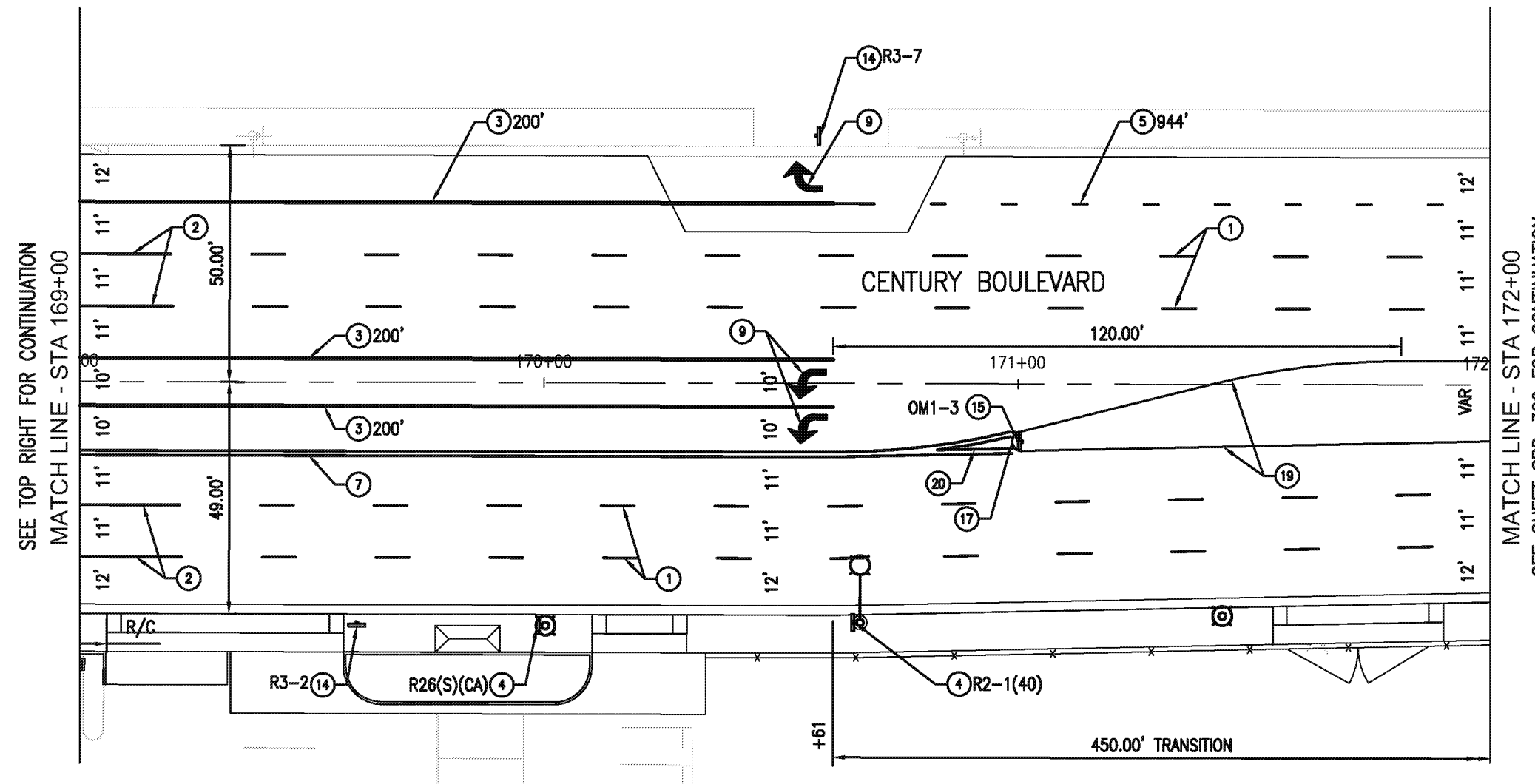

SEE TOP RIGHT FOR CONTINUATION  
MATCH LINE - STA 169+00

MATCH LINE - STA 172+00  
SEE SHEET SPD-309 FOR CONTINUATION

DESIGN REVIEW SUBMITTAL,  
NOT FOR CONSTRUCTION

ST-4696

ST-4696

**AECOM**  
AECOM Technical Services, Inc.  
515 S. FLOWER ST., 4th FLOOR  
LOS ANGELES, CA 90071  
T 213.330.7200 F 213.330.7201  
www.aecom.com

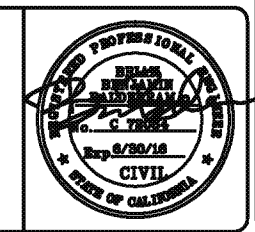

REVISIONS		
MARK	DATE	DESCRIPTION

**CITY OF INGLEWOOD, CALIFORNIA  
PUBLIC WORKS DEPARTMENT**

PROJECT TITLE:  
**PLANS FOR IMPROVEMENT OF  
CENTURY BOULEVARD  
INGLEWOOD AVE TO DOTY AVE  
SIGNS AND PVMT DELINEATION - 164+75 TO 172+00**

DESIGNED BY: \_\_\_\_\_  
DRAWN BY: \_\_\_\_\_  
CHECKED BY: \_\_\_\_\_

SUBMITTED BY / APPROVED BY: \_\_\_\_\_  
VANESSA MUNOZ, RCE 67883 / CONSULTANT TRAFFIC ENGINEER

PLAN NO. \_\_\_\_\_  
PROFILE SCALE: VERTICAL N/A, HORIZONTAL N/A

SHEET NO. **SPD-309** OF \_\_\_\_\_

SEE SHEET SPD-308 FOR CONTINUATION  
MATCH LINE - STA 172+00

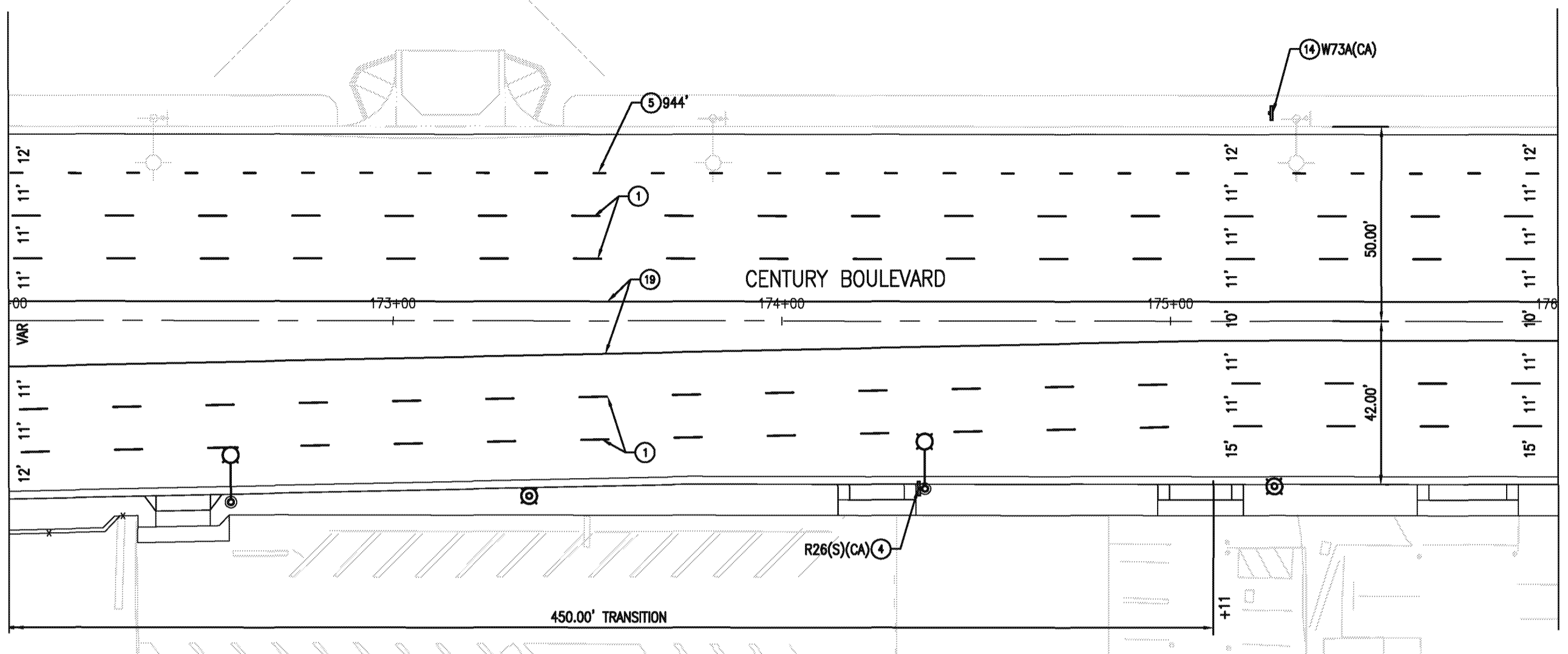

MATCH LINE - STA 176+00  
SEE BOTTOM LEFT FOR CONTINUATION

**NOTES:**

- 1. SEE TRAFFIC SIGNAL PLANS FOR ADDITIONAL SIGNS.

**LEGEND:**

- PROPOSED SIGNING OR STRIPING
- ◇ EXISTING SIGNING OR STRIPING
- Ⓢ SIGNALIZED INTERSECTION
- ⊥ 1 POST SIGN
- 12" CROSSWALK OR LIMIT LINE
- ⊙ PROPOSED PEDESTRIAN LIGHTING
- R/C RED CURB
- ↖ TYPE IV ARROW
- ↗ TYPE VII ARROW
- STOP "STOP" PAVEMENT MARKING
- BUS "BUS" PAVEMENT MARKING
- ONLY "ONLY" PAVEMENT MARKING
- PROPOSED STREET LIGHTING
- Y/C YELLOW CURB

**CONSTRUCTION NOTES:**

- INSTALL 4" WHITE LINE AND PAVEMENT MARKERS PER DETAIL 9, CALTRANS STD. PLAN A20A.
- INSTALL LEAD LINE PAVEMENT MARKERS PER "LEAD LINE DETAIL" ON SHEET SPD-301.
- INSTALL 8" WHITE LINE AND PAVEMENT MARKERS PER DETAIL 38, CALTRANS STD. PLAN A20D.
- INSTALL ROADSIDE SIGN USING STRAP AND SADDLE BRACKET METHOD PER CALTRANS STD PLAN RS4.
- INSTALL 8" WHITE LINE AND PAVEMENT MARKERS FOR LANE DROP PER DETAIL 37B, CALTRANS STD. PLAN A20C.
- INSTALL 4" WHITE LINE PER DETAIL 27B, CALTRANS STD PLAN A20B.
- INSTALL DOUBLE 4" YELLOW LINE AND PAVEMENT MARKERS PER DETAIL 22, CALTRANS STD PLAN A20A.
- INSTALL 4" WHITE LINE FOR LANE LINE EXTENSION THROUGH INTERSECTION PER DETAIL 40, CALTRANS STD. PLAN A20D.
- INSTALL TYPE IV, LEFT OR RIGHT, ARROW PER CALTRANS STD PLAN A24A.
- INSTALL 8" WHITE LINE AND PAVEMENT MARKERS PER DETAIL 38A, CALTRANS STD. PLAN A20D.
- INSTALL PAVEMENT MARKING PER CALTRANS STD PLAN A24D AND A24E.
- INSTALL 12" WHITE LIMIT LINE OR CROSSWALK PER CALTRANS STD PLAN A24E. CROSSWALK WIDTH=15' CLEAR.
- FURNISH AND INSTALL 1 POST ROADSIDE SIGN PER CALTRANS STD PLANS RS1.
- FURNISH AND INSTALL 1 POST ROADSIDE SIGN IN MEDIAN PER CALTRANS STD PLANS RS1 WITH MODIFIED GROUND CLEARANCE OF 1.5' FROM BOTTOM OF SIGN.
- NOT USED
- PAINT ISLAND NOSE YELLOW, SEE SPD-311 FOR DETAILS.
- INSTALL 12" YELLOW CROSSWALK PER CALTRANS STD PLAN A24E. CROSSWALK WIDTH=15' CLEAR.
- INSTALL EDGE OF TRAVELED WAY PAVEMENT MARKERS PER DETAIL 26, CALTRANS STD PLAN A20B.
- INSTALL DOUBLE 4" YELLOW EDGE LINE AND PAVEMENT MARKERS LINE PER DETAIL 29, CALTRANS STD PLAN A20B.

SEE TOP RIGHT FOR CONTINUATION  
MATCH LINE - STA 176+00

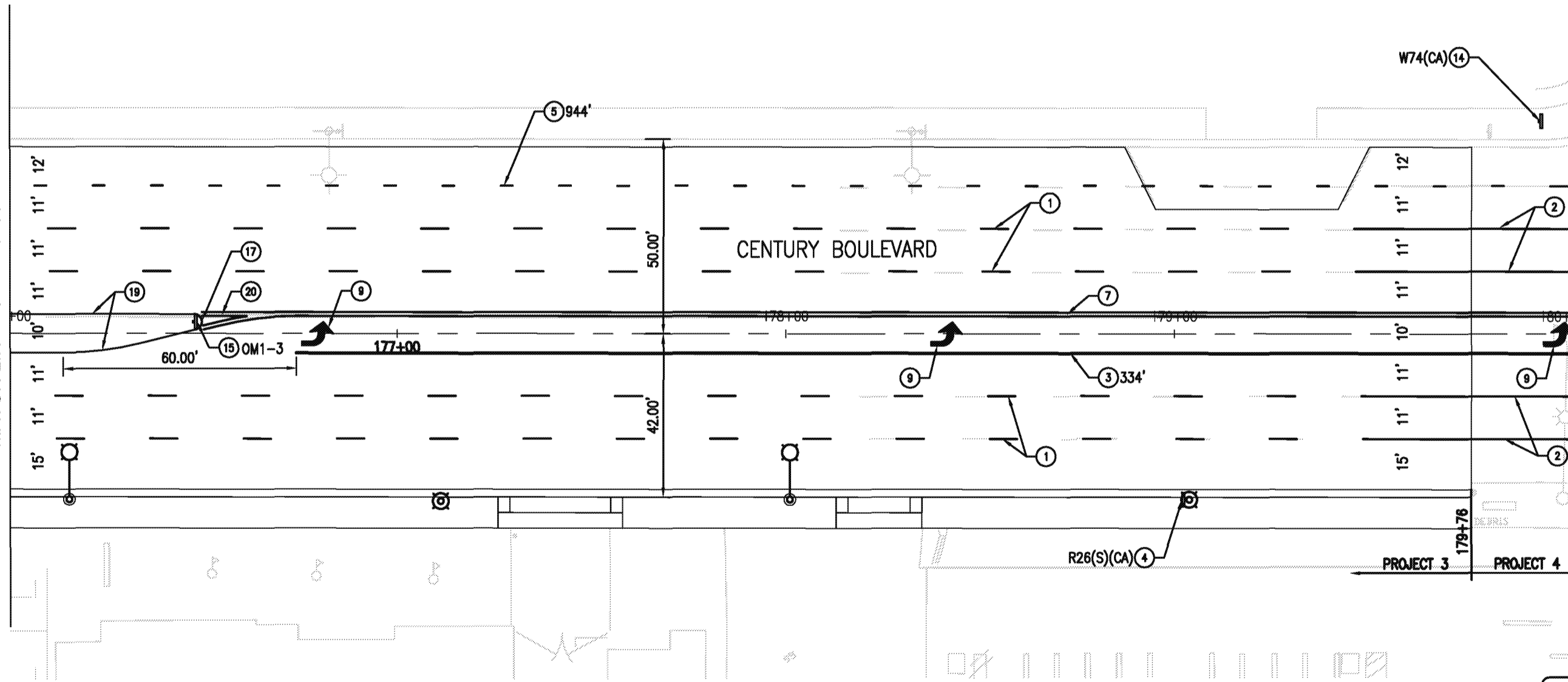

SEE PROJECT 4  
SIGNS AND PVMT DELINEATION

STREET "O"

DOTY AVENUE  
SCALE: 1" = 20'

REVISIONS		
MARK	DATE	DESCRIPTION

CITY OF INGLEWOOD, CALIFORNIA  
PUBLIC WORKS DEPARTMENT

PROJECT TITLE:  
**PLANS FOR IMPROVEMENT OF  
CENTURY BOULEVARD  
INGLEWOOD AVE TO DOTY AVE  
SIGNS AND PVMT DELINEATION - 172+00 TO 179+76**

DESIGNED BY: \_\_\_\_\_  
DRAWN BY: \_\_\_\_\_  
CHECKED BY: \_\_\_\_\_

SUBMITTED BY / APPROVED BY: \_\_\_\_\_  
VANESSA MUNOZ, RCE 67683 / CONSULTANT TRAFFIC ENGINEER

PLAN NO. SPD-310  
SHEET NO. \_\_\_\_\_ OF \_\_\_\_\_

**AECOM**

AECOM Technical Services, Inc.  
210 S. FLOWER ST., 4th FLOOR  
LOS ANGELES, CA 90071  
T 213.330.7200 F 213.330.7201  
www.aecom.com

REGISTERED PROFESSIONAL ENGINEER  
STATE OF CALIFORNIA  
CIVIL  
No. 67683  
Exp. 8/30/16

DESIGN REVIEW SUBMITTAL,  
NOT FOR CONSTRUCTION

Drawing Name: W:\01\0000\_CBSR\Inglewood\CAD\City\Sheet\Project 3 - Inglewood to Doty\12 Signs and PVMT SPD-310.dwg  
Last Updated: December 20, 2015 - 2:11PM - hrammam