



DEVELOPER
MURPHY'S BOWL
LLC
10400 NE 4TH ST, SUITE 3000
BELLEVUE, WA 98004
DEVELOPER'S MANAGING AGENT
WILSON MEANY
8701 Center Drive, Suite 950
Los Angeles, CA 90045
310.382.8500
http://wilsonmeany.com/

**ARCHITECT / PLANNING /
ENGINEERING / TRANSPORTATION**

AECOM
AECOM TECHNICAL SERVICES, INC
2380 McGee, Suite 200
Kansas City, MO 64108
816.861.4443 tel 816.561.2863 fax
www.aecom.com

CIVIL ENGINEER
D&D
ENGINEERING, INC
8901 S. La Cienega Blvd. Suite 106
Inglewood, CA 90501
494.393.4122 tel

DRY UTILITY SYSTEMS
BJ PALMER &
ASSOCIATES, INC
28245 Crocker Avenue
Valencia, CA 91355
760.842.7510 tel

PARKING
WALKER
CONSULTANTS
606 S. Olive St, Suite 1100
Los Angeles, CA 90014
213.488.4911 tel

SHORING ENGINEER
DRS
ENGINEERING, INC
3584 Sagunto Street, Suite 468
Santa Ynez, CA 93460
818.402.3962 tel

REGISTRATION
This drawing has been prepared for the use of
AECOM's client and may not be used, reproduced or
relied upon by third parties, except as agreed by
AECOM and its client, as required by law or for use by
governmental reviewing agencies. AECOM accepts
no responsibility, and denies any liability whatsoever,
to any party that modifies this drawing without
AECOM's express written consent. Do not scale this
document. All measurements must be obtained from
the stated dimensions.

**NOT FOR
CONSTRUCTION**

ISSUE/REVISION

NO.	DATE	DESCRIPTION

KEY PLAN



PROJECT NUMBER

SHEET TITLE

SITE PLAN

SHEET NUMBER

P101A
© 2015 AECOM TECHNICAL SERVICES, INC

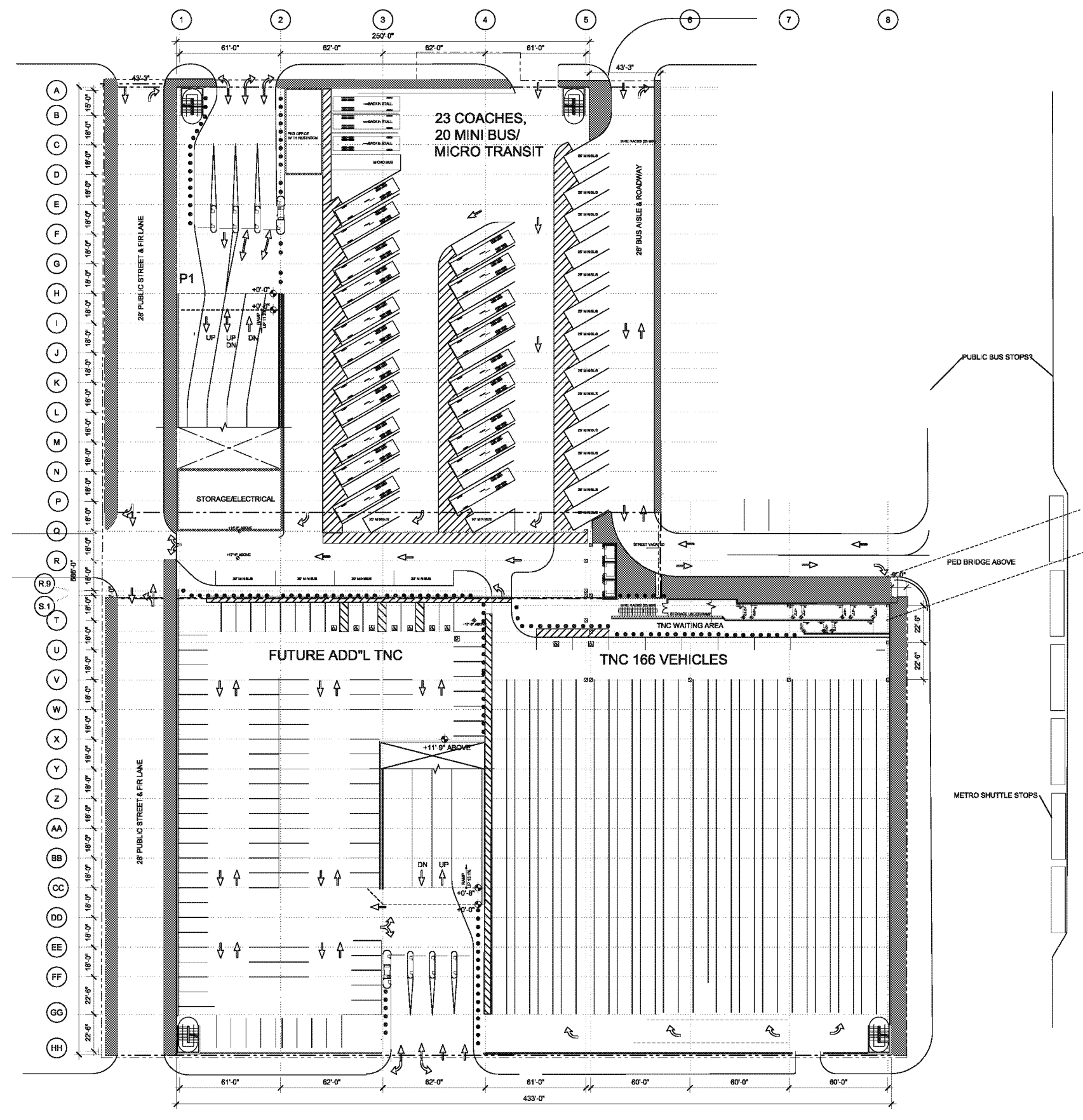

Project Management Initials
Last Printed
Filename
Printed on Post Consumer Recycled Content Paper



DEVELOPER
MURPHY'S BOWL LLC
10400 NE 4TH ST, SUITE 3000
BELLEVUE, WA 98004

DEVELOPER'S MANAGING AGENT
WILSON MEANY
6701 Center Drive, Suite 050
Los Angeles, CA 90045
310.352.0500 tel
http://wilsonmeany.com/

ARCHITECT / PLANNING /
ENGINEERING / TRANSPORTATION
AECOM

AECOM TECHNICAL SERVICES, INC.
2380 McGee, Suite 200
Kansas City, MO 64108
816.951.4443 tel / 816.561.2863 fax
www.aecom.com

CIVIL ENGINEER
D&D ENGINEERING, INC
8801 S. La Cienega Blvd, Suite 106
Inglewood, CA 90301
424.393.4122 tel

DRY UTILITY SYSTEMS
BJ PALMER & ASSOCIATES, INC
28245 Crocker Avenue
Valencia, CA 91355
760.842.7510 tel

PARKING
WALKER CONSULTANTS
606 S. Olive St, Suite 1100
Los Angeles, CA 90014
213.458.4911 tel

SHORING ENGINEER
DRS ENGINEERING, INC
3584 Sagunto Street, Suite 488
Santa Ynez, CA 93480
818.402.3982 tel

CAR COUNT												
9'-0" 90' STANDARD SPACE												
TIER	TEAM	STANDARD	CAR ACCESSIBLE	VAN ACCESSIBLE	EVCS EQUIPPED (3%)	EVCS READY (6%)	EV AMB ACCESSIBLE	EV CAR ACCESSIBLE	EV VAN ACCESSIBLE	TOTAL	AREA (SQ FT)	EFFICIENCY (SQ FT/STALL)
P1 (+90'-9")		50	1	2	13	26	2	1	1	98	35800	374
TEAM @ P1	87		3	1		6	1	1	1	100	34870	348
P2 (+102'-3")		223	1	1		0				225	73012	324
P3 (+113'-8")		227	1	1		0				229	70772	309
TOTAL	87	500	6	5	13	32	3	2	2	650	214,554	330

3% EVCS AT OPENING DAY = 19 TOTAL ALLOCATED AS 3 TEAM (ALL ACCESSIBLE) & 16 VIP
+5% (6% TOTAL) EVCS READY = 33 (52 TOTAL) ALLOCATED AS 6 ADD'L TEAM REST VIP
SAME ACCESSIBLE REQUIRED FOR BOTH OPENING DAY AND 6% TOTAL
1 VAN, 3 CAR, 3 AMBULATORY ALLOCATED TO TEAM 1 @ VAN, CAR & AMBULATORY
REST TO VIP, BUT CHANGED 1 CAR TO VAN SO HAVE 1 VAN, 1 CAR AND 2 AMB.
REMAINING SPACES AT OPENING DAY = 650 - 52 = 598 SPACES
91 TEAM REQUIRES 1 VAN AND 3 CAR ACCESSIBLE
507 VIP REQUIRES 2 VAN AND 9 CAR ACCESSIBLE

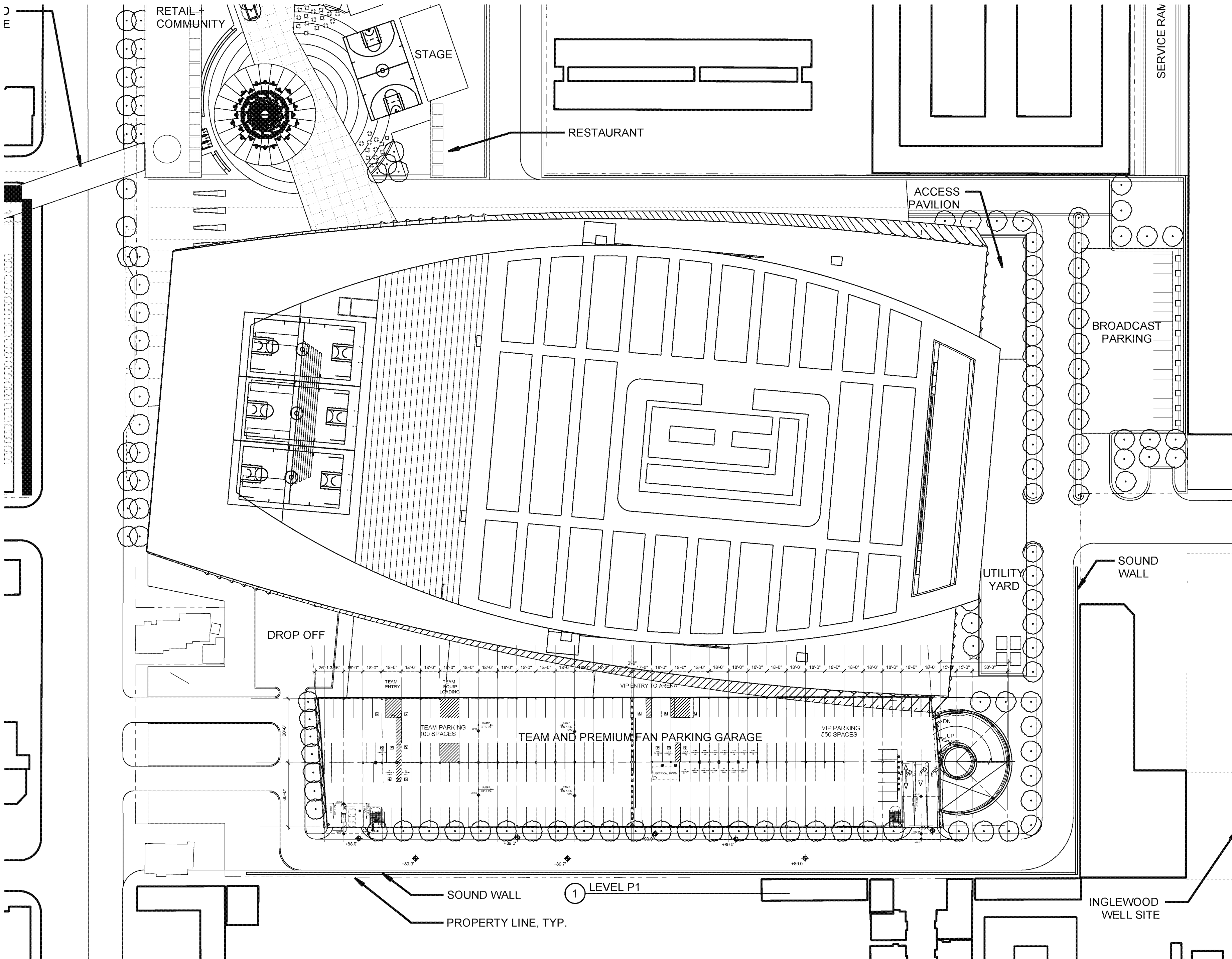

REGISTRATION
This drawing has been prepared for the use of AECOM's client and may not be used, reproduced or relied upon by third parties, except as agreed by AECOM and its client, as required by law or for use by governmental reviewing agencies. AECOM accepts no responsibility, and denies any liability whatsoever, to any party that modifies this drawing without AECOM's express written consent. Do not scale this document. All measurements must be obtained from the stated dimensions.

NOT FOR CONSTRUCTION
ISSUE/REVISION

NO.	DATE	DESCRIPTION
1	SEP 12, 2018	CONCEPT DESIGN

KEY PLAN



PROJECT NUMBER
60545923
SHEET TITLE
SITE PLAN
SHEET NUMBER

P201A
© 2015 AECOM TECHNICAL SERVICES, INC.

ARCH: 36" x 48" (top),
 ARCH: 36" x 48" (middle),
 ARCH: 36" x 48" (bottom)

Project Management Initials:
 Lead Planner:
 File Name:
 Project: Proj-Condor
 Revised: Corrected Paper

ARCH: 38' x 48'



PROJECT
PROJECT CONDOR,
INGLEWOOD CALIFORNIA



DEVELOPER

MURPHY'S BOWL
LLC
10400 NE 4TH ST, SUITE 3000
BELLEVUE, WA 98004

DEVELOPER'S MANAGING AGENT

WILSON MEANY
6701 Center Drive, Suite 950
Los Angeles, CA 90045
310.382.8500 tel
http://wilsonmeany.com/

ARCHITECT / PLANNING /
ENGINEERING / TRANSPORTATION

AECOM
AECOM TECHNICAL SERVICES, INC.
2380 McCaw, Suite 200
Kansas City, MO 64108
816.561.4443 tel 816.561.2863 fax
www.aecom.com

CIVIL ENGINEER

D&D
ENGINEERING, INC
8901 S. La Cienega Blvd. Suite 106
Inglewood, CA 90501
494.393.4122 tel

DRY UTILITY SYSTEMS

BJ PALMER &
ASSOCIATES, INC
28245 Crocker Avenue
Valencia, CA 91355
760.842.7510 tel

PARKING

WALKER
CONSULTANTS
606 S. Olive St, Suite 1100
Los Angeles, CA 90014
213.488.4911 tel

SHORING ENGINEER

DRS
ENGINEERING, INC
3564 Sagunto Street, Suite 488
Santa Ynez, CA 93460
818.402.3992 tel

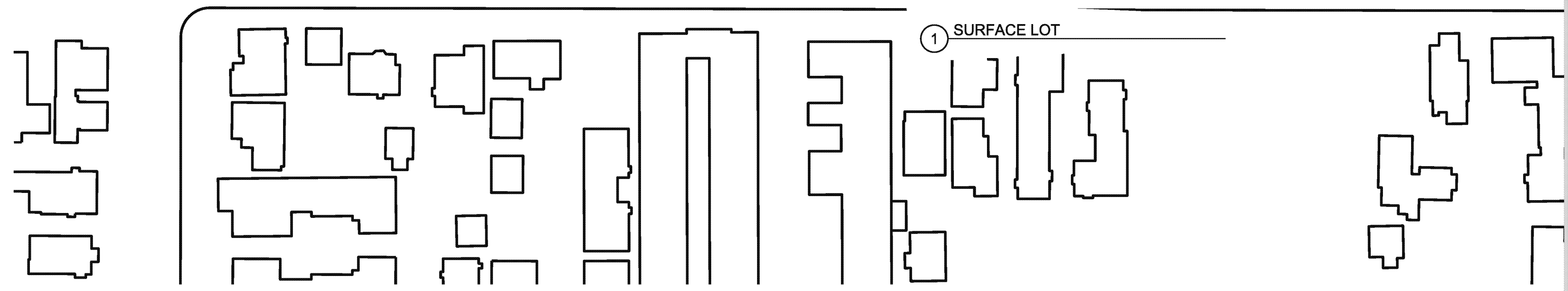
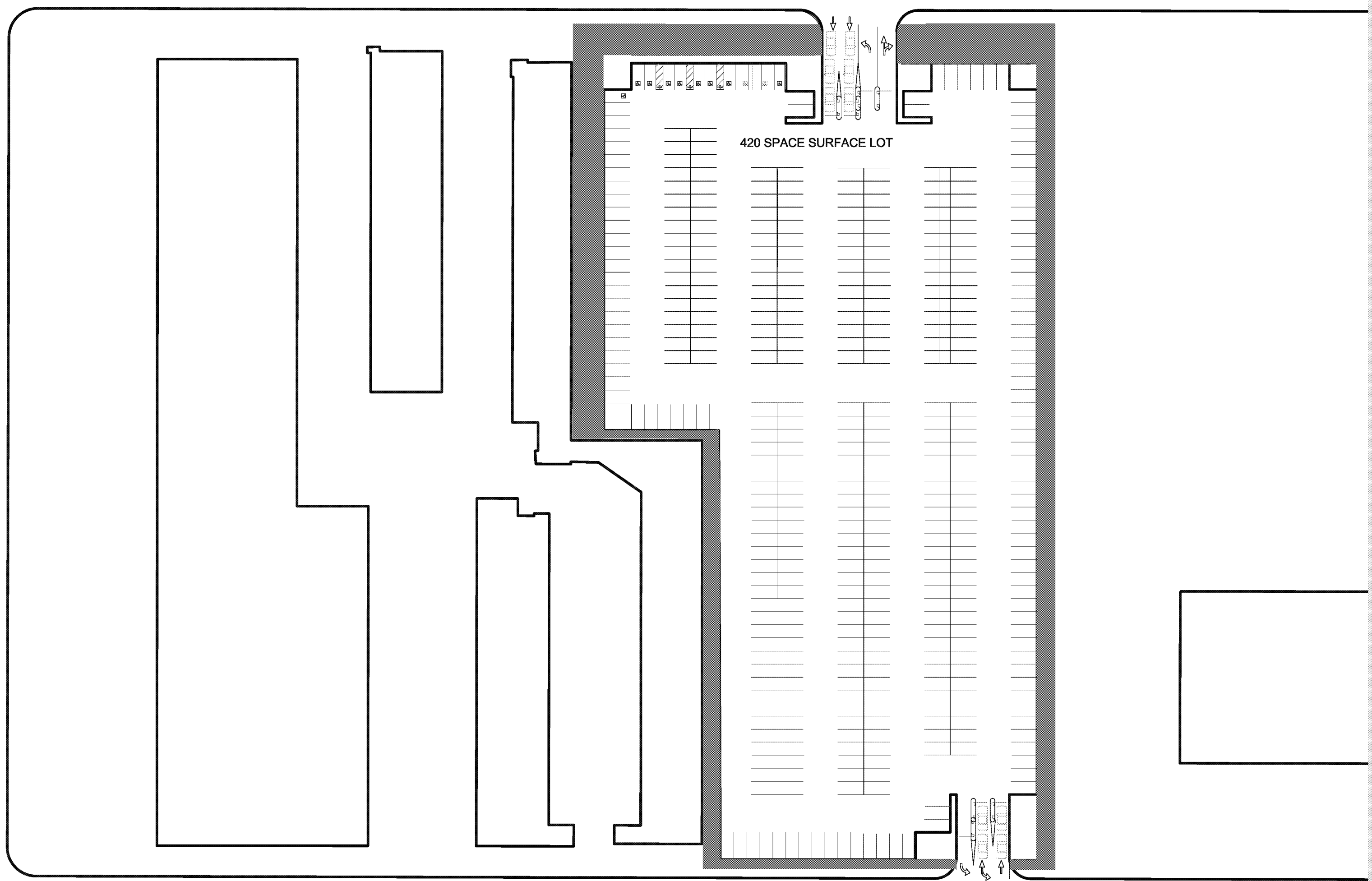

REGISTRATION

This drawing has been prepared for the use of AECOM's client and may not be used, reproduced or relied upon by third parties, except as agreed by AECOM and its client, as required by law or for use by governmental reviewing agencies. AECOM accepts no responsibility, and denies any liability whatsoever, to any party that modifies this drawing without AECOM's express written consent. Do not scale this document. All measurements must be obtained from the stated dimensions.

NOT FOR
CONSTRUCTION

ISSUE/REVISION

NO.	DATE	DESCRIPTION

KEY PLAN

SEP 12, 2016 CONCEPT DESIGN
UR DATE DESCRIPTION



PROJECT NUMBER

60545923

SHEET TITLE

SITE PLAN

SHEET NUMBER

P301A

Project Management Initials: CHK Approved: APR
User: P301A_01 Jan 09 2010
Filename: P301A.rvt

Printed: Plot: Concrete
Revised: Contact: Paper