



FINAL

**MITIGATED NEGATIVE DECLARATION OF  
ENVIRONMENTAL IMPACTS**

**WELL NO. 7**

**Environmental # EA-MND-2014-76**

Approved by City Inglewood City Council through Public Hearing on November 18, 2014

Lead Agency / Applicant:  
CITY OF INGLEWOOD  
PUBLIC WORKS DEPARTMENT  
ONE WEST MANCHESTER BOULEVARD  
INGLEWOOD, CALIFORNIA 90301  
(310) 412-5333

NOVEMBER 2014

## **FORMAT OF THIS DOCUMENT**

This document is organized in the following manner:

- A. **INTRODUCTION.** This section explains the purpose of this document and provides the background of the project and the draft mitigated negative declaration process to date.
- B. **INITIAL STUDY CHECKLIST.** This section contains the Initial Study Checklist containing the topics to be assessed pursuant to the provisions of the CEQA Guidelines. The Initial Study Checklist provides the threshold of environmental impact as assessed by the preparer of the Initial Study.
- C. **CHECKLIST RESPONSES.** This section contains the responses to all Initial Study questions, including the "No Impact" category.

### **A. INTRODUCTION**

The City of Inglewood (City) provides approximately 10,500 acre-feet potable water per year to its customers. The City currently has four active groundwater production wells; Well No. 1, Well No. 2, Well No. 4, and Well No. 6, which produce approximately 21% of total water consumption. The remaining 79% is purchased from the Metropolitan Water District (MWD) thru West Basin Municipal Water District (WBMWD).

Well No. 1 and No. 2 were built in the 1970s and are the two oldest wells out of the four active groundwater production wells in the City. Water production from Well No. 1 is far below average (design production capacity of 3,000 gallon per minute (gpm) vs. current production capacity of 100 gpm). Currently this well is going through well rehabilitation, and the work will begin in the summer of 2014. In 2009, Well No. 2 was cleaned, redeveloped, and rehabilitated. After rehabilitation, production capability of Well No. 2 has increased up to 850 gpm, but it gradually came down to 200 gpm. Well No. 4 was constructed in 1990 with design capacity of 2,500 gpm. In recent years, the water production from this well has reduced substantially to current level of 175 gpm. Well No. 6 was constructed in 2003 with design capacity of 2,500 gpm. In December 2012, Well No. 6 was patched to seal the holes in the well casing, and was cleaned by brushing. As a result, the production from Well No. 6 increased from 800 gpm to 1,200 gpm. Currently, the Well No. 6 is producing at 1,000 gpm.

The cost incurred to produce groundwater is less than the cost to purchase imported water. Per estimates, the current production cost for the City groundwater wells is approximately \$910/acre-foot whereas the purchased potable water from WBMWD is \$1157/acre-foot. Thus, it's more economical for the City to produce its own water. For the past two years, the City Public Works staff evaluated various sites for a suitable location for a new well. The construction of proposed well will improve the groundwater production.

Pursuant to the provisions of Division 13 of the State of California Public Resources Code that the California Legislature finds and declares that is the policy of the state that projects to be carried out by public agencies be subject to the same level of review and consideration under this division as that of private projects required to be approved by public agencies. (CEQA § 21001.1)

Furthermore, CEQA Section 15070 states:

“A public agency shall prepare or have prepared a proposed negative declaration or mitigated negative declaration for a project subject to CEQA when...the initial study shows that there is no substantial evidence, in light of the whole record before the agency, that the project may have a significant effect on the environment...”

## **A.1 PROJECT LOCATION, NEIGHBORHOOD, AND RELEVANT DATA**

The project will be located at 101 West Arbor Vitae Street, Inglewood, California 90301. The lot (Assessor's ID # 4022-029-900) dimension is 75' wide and 118' length. Currently the site is being used as a parking lot with 9 parking spaces. Once the project is approved by all government agencies and the Inglewood City Council, the Well No. 7 construction will move forward.

### **Neighborhood**

The City of Inglewood (City) is predominantly a residential community located near the California coastline in Los Angeles County. It is bordered to the south by the City of Hawthorne and to the east, north, and west by portions of unincorporated Los Angeles County and the City of Los Angeles. The regional location map is shown on Figure 1.

The City provides water to 84 percent of the residences and businesses in the City. The service area, shown on Figure 2, is limited to those communities receiving water service from the City. It covers approximately 4,600 acres within the City's boundaries. A small portion of the City on the northwest corner is served by the California-America Water Company. The Golden State Water Company provides water service to a significant area located generally south of Century Boulevard to the City boundary. The area bounded by Century Boulevard, Van Ness Avenue, 108th Street, and Yukon Avenue is served by the City. A small area bounded by Imperial Highway, Crenshaw Boulevard, Century Freeway (I-105), and Yukon Avenue is also served by the City.

The City's service area is divided into three distinct pressure zones because of the elevation differences. Zone 1 is located at the southernmost part of the City. It is bounded by Imperial Highway to the north, Crenshaw Boulevard to the west, Century Freeway to the south, and Yukon Avenue to the east. Zone 2 is located generally between Centinela Avenue and Century Boulevard west of Prairie Avenue, and includes Hollywood Park. Zone 3 covers the remaining northern and eastern parts of the City as shown on Figure 2.

### **Topographical Description and Geology**

Elevations within the service area vary from 60 feet to 247 feet above mean sea level. The majority of the City slopes from the northeast to the southwest, while a small portion to the northeast slopes into northeast direction. The proposed well location is within Best Coast Basin.

The predominant geologic features in the study area are the Charnock Fault and the Newport-Inglewood Uplift. The Charnock Fault is located westerly of the proposed well location. It extends in a northwest to southeast direction at Imperial Highway west of Hawthorne Boulevard, and at Rosecrans Avenue west of Crenshaw Boulevard. The Newport-Inglewood Uplift extends southeasterly along the easterly portion of the proposed well location paralleling the coastline. It defines the boundary between the West Coast and Central Basins, and is a partial barrier to the movement of groundwater. Most of the natural replenishment of the West Coast Basin takes place across the Newport-Inglewood Uplift with underflow from the Central Basin. Water bearing formations include the unconsolidated and semi-consolidated marine and alluvial sediments of Holocene, Pleistocene, and Pliocene ages. The area overlies the Gage, Lynwood, Silverado, and Sunnyside aquifers of the West Coast Basin.

The West Coast Basin covers 91,300 acres (142 square miles), and extends between the Newport-Inglewood Uplift and Santa Monica Bay. It is bounded on the north by the Ballona Escarpment, and on the south and west by the Pacific Ocean and Palos Verdes Hills.

Because the aquifers of the West Coast Basin are connected to the Pacific Ocean, sea water intrusion was experienced along Santa Monica Bay due to over pumping in the West Coast Basin. Sea water intrusion has been essentially stopped with the West Coast Basin Barrier Project, which consists of 154 injection wells extending from Los Angeles International Airport to the Palos Verdes Hills.

The Los Angeles County Department of Public Works (LACDPW) Hydrology and Sedimentation Appendix provides information on the soil characteristics within Los Angeles County. This document shows that the soils found in the City include, Ramona Loam (Soil Type 013), Yolo Loam (Soil Type 016), and Yolo Sandy Loam (Soil Type 020). All three types have medium infiltration capabilities of 1 to 3 feet per day.

The entirety of Zones 1 and 3 are classified as Ramona Loam. Yolo Loam and Yolo Sandy Loam are found in the south westerly portion of Zone 2, generally west of Prairie Avenue and south of Florence Avenue.

### **City Population and Service Area Population**

Since its incorporation in 1908, the City of Inglewood has grown from a population of 1,200 in 1908 to 109,673 in the year 2010 (U.S. Census Bureau and California Department of Finance).

In the year 2000, the total number of housing units and City population was 39,102 (City of Inglewood, 2000 Housing Element) and 112,681, respectively. This results in an average population density of 2.9 persons per household. In 2003, the total City population increased slightly to 114,104, but in 2010, the City's population dropped down to 109,673. Due to the upcoming major development at Hollywood Park, it is estimated that the ultimate population for the City of Inglewood will be at approximately 128,000 people citywide and 108,000 in the water service area. Beside this large development, a significant increase in population and water use is not expected because the City is nearly fully developed.

Some residential areas within the City's boundary are served by other water agencies; therefore, the City's service area population does not completely coincide with the total City population shown in Figure 3. It is estimated that approximately 18,265 City residents receive water service from Golden State Water or Cal-America Water Company. The City provides water service to approximately 99,000 consumers through 14,948 service connections (residential, commercial, industrial, municipal, and fire).

## **A.2 WATER CAPITAL IMPROVEMENT PROJECTS PROGRAM**

The City of Inglewood (City) completed its Water Master Plan (WMP) in 2003. The 2003 WMP evaluated the capacity of the water systems in the City to provide service to the City's constituents and recommended Capital Improvement Projects (CIPs) to fix & upgrade its entire water system. The Water CIPs program is a 25-year program (2003 to 2028) of improvement projects for the City. The Water CIPs Program is designed to fix the deficiencies in the City's water system. These deficiencies include: 1) aging facilities such as wells and under-sized pipelines, 2) lack of backup supply, 3) inability of the system to provide fire flow protection that meets the current operating standards, and 4) decreasing reliability and redundancy as the system continues to age and further restrictions are imposed on water import and water quality. Specific improvements proposed by City engineers include: High Capacity Water Well, Pipeline Improvements & Replacements throughout City, Fire Hydrant Replacement, Meter and Service Replacements, Service Connection to Inglewood Water Distribution System, Rehabilitate existing wells (Well No. 1 and No. 4), and Constructing a new reservoir.

Aging and deficient water mains (A.C. pipe or Cast-Iron pipe) are being replaced with new/larger Ductile-Iron pipe (DIP) water mains each year. Also in recent years, wells (No. 2 and No.6) were rehabilitated to improve production rate, and other water facilities were fixed and maintained to its upmost capacity to serve the City's customers.

## **A.3 MITIGATED NEGATIVE DECLARATION PROCESS**

Pursuant to the provisions of the California Environmental Quality Act (CEQA), the proposed Water Capital Improvement Project for Well No. 7 was evaluated per the CEQA requirements. As a result of this evaluation, it's determined that the proposed action constituted a "project" as defined by CEQA (§ 21065). Therefore, it was necessary to prepare an Initial Study Checklist of the proposed project. The completion

of an Initial Study Checklist resulted in the recommendation for the adoption of a Mitigated Negative Declaration.

Upon the completion of the draft Mitigated Negative Declaration of Environmental Impacts, public notice will be placed in the Inglewood News on Friday, October 31, 2014 and on Friday, November 7, 2014. The public notice identifies the time and place of the City Council consideration of the Mitigated Negative Declaration and invited public review of the draft Mitigated Negative Declaration.

The City Council will consider and approve the Mitigated Negative Declaration of Environmental Impacts Report during November 18, 2014 Council Meeting.

#### **A.4 FINDING OF A MITIGATED NEGATIVE DECLARATION**

The proposed project, the Water Capital Improvement Project for Well No. 7, will not result in the potential for a significant negative effect on the environment, in that it will not permanently alter the physical configuration of the environment. In addition, proposed modifications to the system will improve the service and reliability of the system.

The Water Capital Improvement Project for Well No. 7 will not create significant environmental impacts when individually assessed, and also when considered cumulatively will not result in a significant effect upon the environment. The proposed system modifications are not designed to provide service to areas that are currently unserved; instead they will improve the service and reliability of a system.

Construction of the improvements described in the Water Capital Improvement Project for Well No. 7 will not adversely affect the environment, in that the project will not result in any ongoing and permanent impacts upon the environment. The City of Inglewood is a "built-out" community located within the southeast portion of Los Angeles County. The development pattern of the City includes fully developed streets, sidewalks, commercial and residential land uses. The installation of the proposed project will result in an increase in the efficiency and reliability of water service to the City of Inglewood residents and businesses.

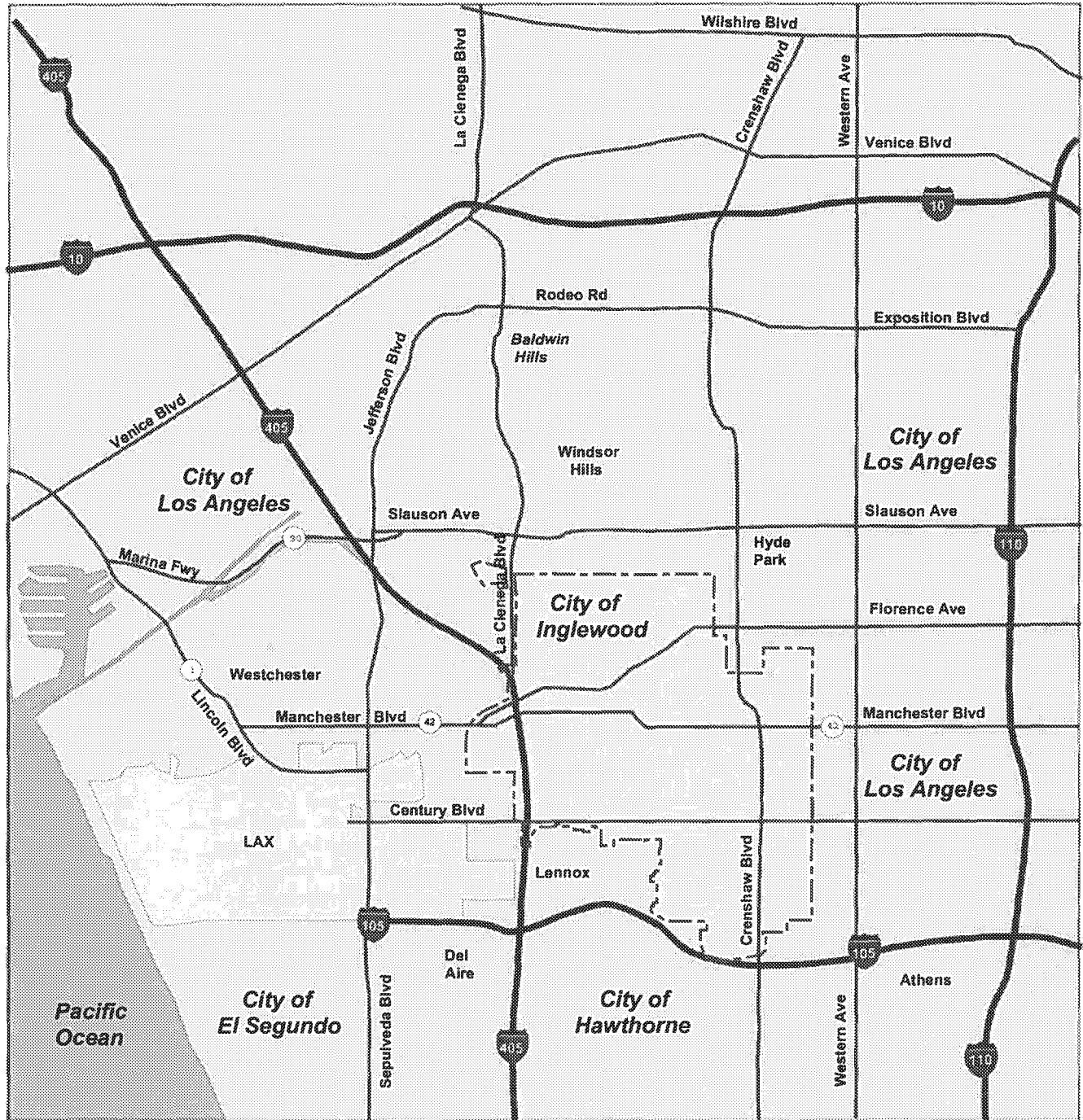

  
 N  
 Not to Scale



City of Inglewood

**Regional Location Map**

Figure 1

# CITY OF INGLEWOOD WATER SERVICE AREAS AND FACILITIES

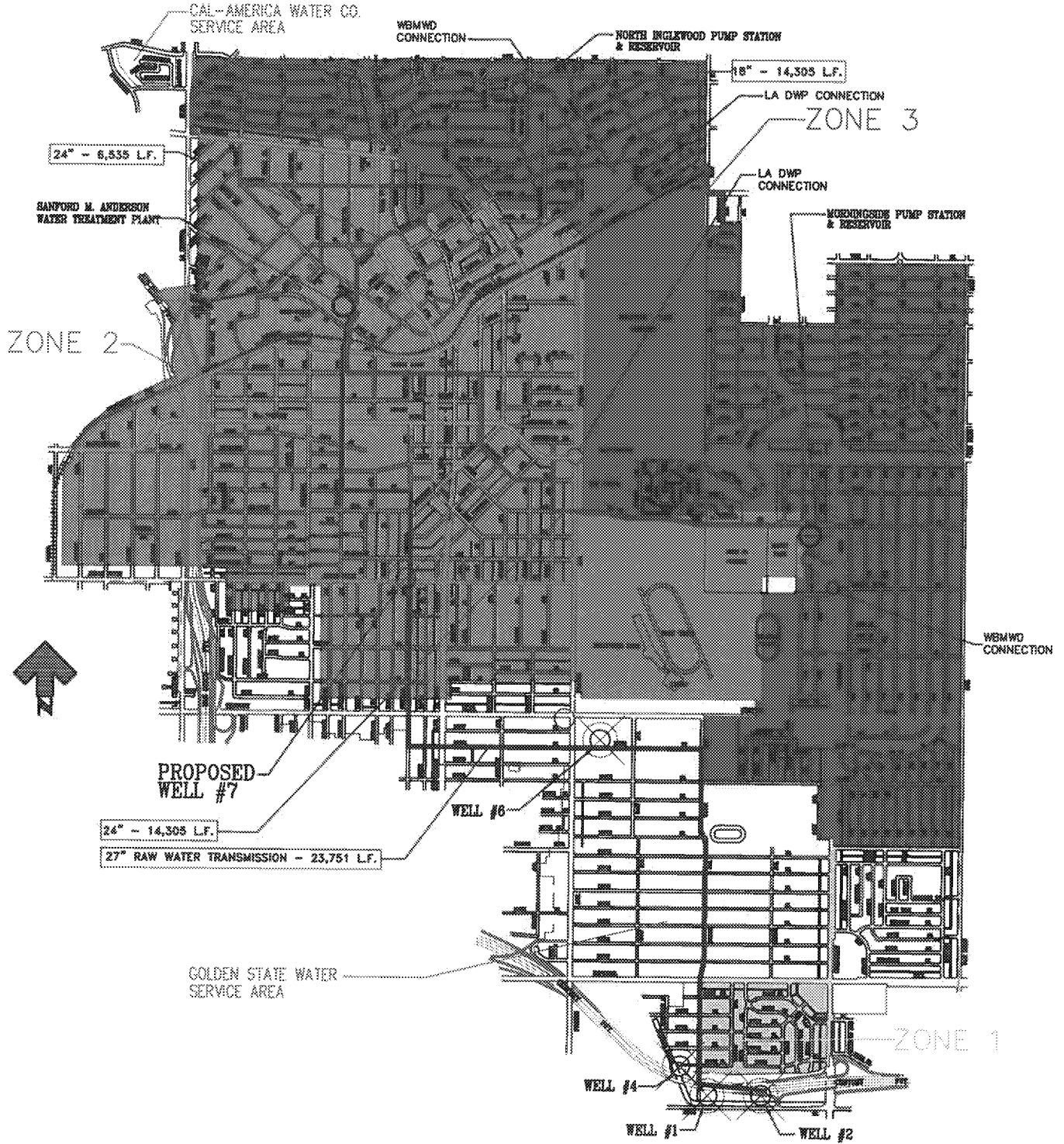

FIGURE 2





**CITY OF INGLEWOOD**

**CITY OF INGLEWOOD WELL NO. 7  
SITE LOCATION MAP  
FIGURE 3**

May 2014

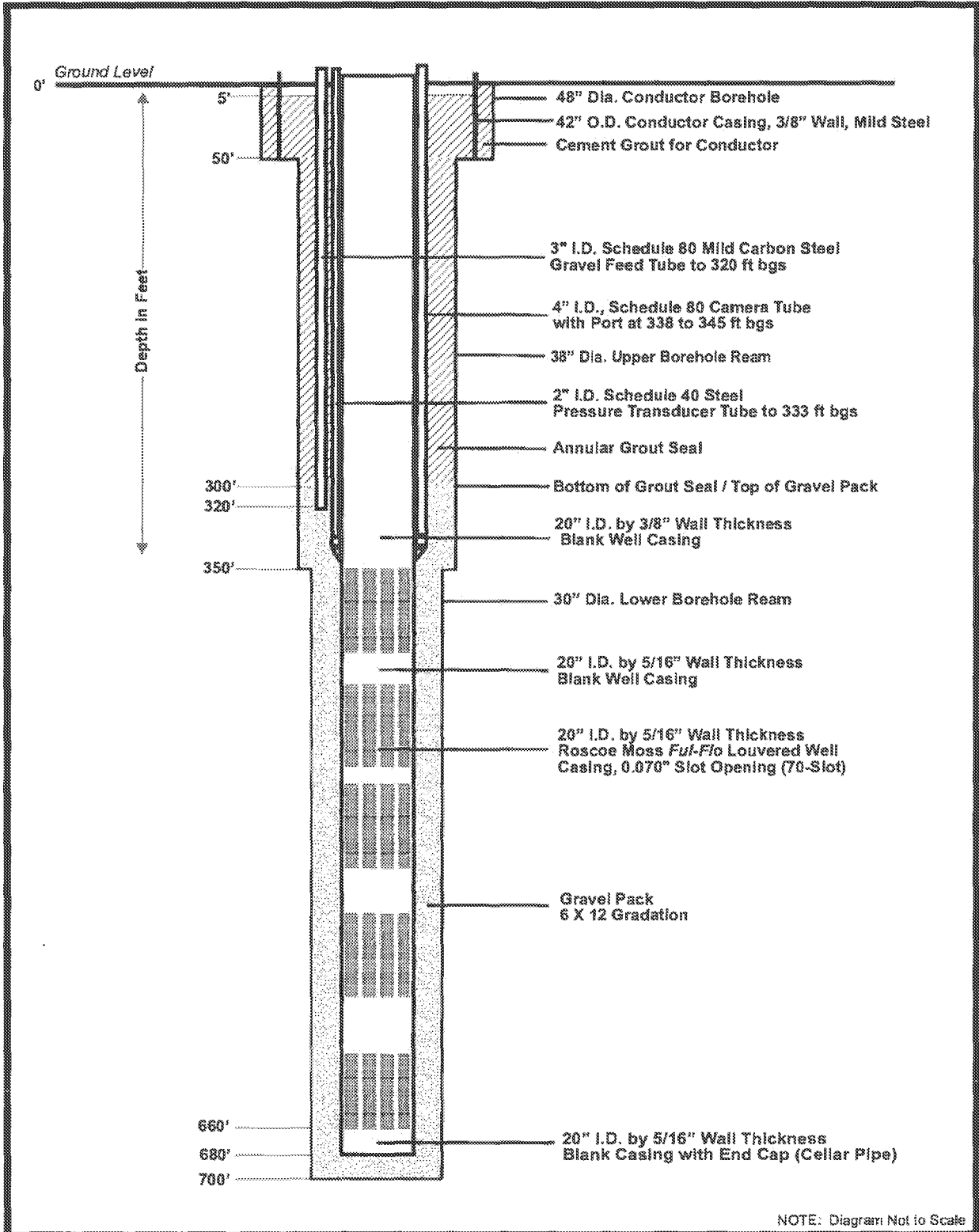

CITY OF INGLEWOOD

**PRELIMINARY WELL DESIGN DIAGRAM  
PROPOSED INGLEWOOD WELL NO. 7  
FIGURE 4**

March 2014

4/1/2014 12:24:23 PM P:\0514126-0014-1-00\INC\430-HEHLE\SC-704\WELL SITE.FIG.11.DWG - JERKINS, ERICA

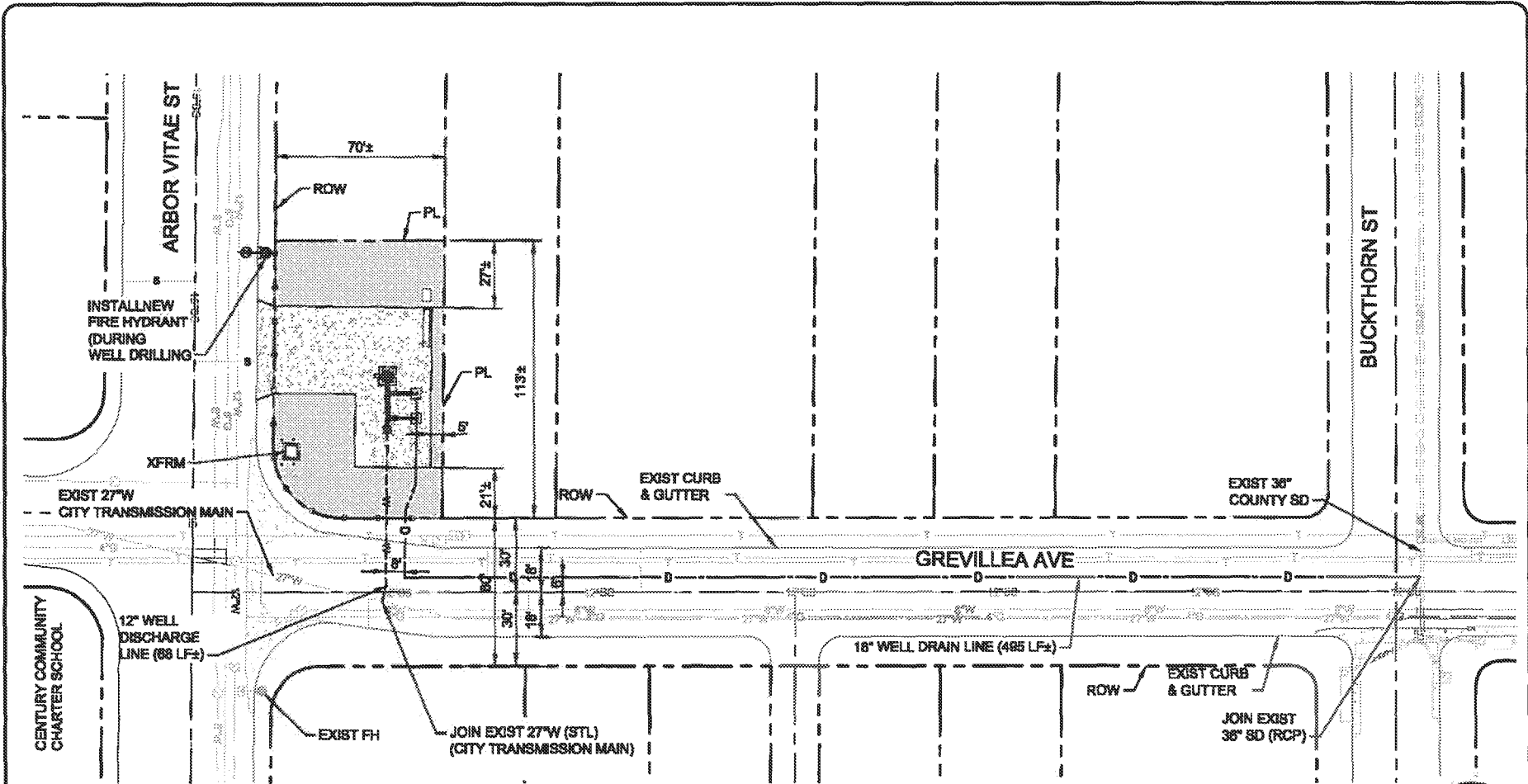

THE TRAFFIC CONCEPT FOR THE PROPOSED STORM DRAIN CONSTRUCTION WILL REQUIRE CLOSURE OF THE SOUTHBOUND LANE ON GREVILLEA AVENUE WHILE MAINTAINING THE NORTHBOUND TRAFFIC. IT IS ANTICIPATED THAT CONSTRUCTION WILL OCCUR AFTER THE CENTURY COMMUNITY CHARTER SCHOOL IS IN SESSION AND THE ROAD WILL OPEN BACK UP BEFORE SCHOOL IS OVER, THUS REDUCING THE TOTAL DAILY CONSTRUCTION WORKING TIME.

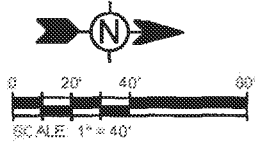

**TETRA TECH**  
[www.tetra-tech.com](http://www.tetra-tech.com)  
 17860 Van Hornan Avenue, Suite 020  
 Irvine, CA 92614-6213  
 T: (949) 250-2020 F: (949) 250-2020

City of Inglewood  
**PRELIMINARY WELL SITE LAYOUT**

Project No.: 135-09114-14021  
 Date: FEBRUARY 2014  
 Designed By: ECU  
**FIGURE 5**

ENVIRONMENTAL INFORMATION CHECKLIST

Project: City of Inglewood Well No. 7 at 101 West Arbor Vitae Street, Inglewood, California 90301

## B. INITIAL STUDY AND CHECKLIST

Inglewood Planning Department

### General Information

PROJECT TITLE: City of Inglewood Well No. 7

LEAD AGENCY: *City of Inglewood*

PROJECT SPONSOR: *City of Inglewood, One West Manchester Boulevard, Inglewood, California 90301*

ADDRESS OF PROJECT: *101 West Arbor Vitae Street, Inglewood, California 90301*

CONTACT PERSON: *Thomas Lee, P.E., Public Works Department (310)412-5333*

OTHER PERMITS AND APPROVALS: *Well Drilling Permit, NPDES, Planning Division Review*

LEGAL DESCRIPTION: *MAPBOOK 9-96 SOUTH 5 FEET OF EAST 118 FEET OF LOT 7 AND EAST 118 FEET OF LOT 8 BLOCK B*

GENERAL PLAN DESIGNATION: *Commercial. C-2.*

ZONING CLASSIFICATION: *General Commercial.*

PROJECT DESCRIPTION (Describe the whole action involved, including but not limited to later phases of the project, and any secondary, support, or off-site features necessary for its implementation. Attach additional sheets if necessary.):

*The project requires that the Contractor furnish all labors, materials, and equipment for the Construction of new Well No. 7. The scope of work includes:*

- 1) Remove the existing pavement and trees for site preparation.*
- 2) Install construction fence for protection and install sound wall for noise mitigation (design and height of wall to be determined by well design company).*
- 3) Drill a well with 20" diameter x 700' deep well casing with Louver perforation set at 350'-660' below ground surface (bgs).*
- 4) Install a temporary test pump assemblies and test run the new well to determine maximum/best production capacity.*
- 5) Based on the result from test run, furnish & Install New water motor and pump assemblies with 10" DIP column pipe. And the pipe will connect to the existing*

ENVIRONMENTAL INFORMATION CHECKLIST

Project: City of Inglewood Well No. 7 at 101 West Arbor Vitae Street, Inglewood, California 90301

*27" raw-water transmission main to transmit water to the City of Inglewood Sanford Anderson Water Treatment Plant. Install all valves, fittings, and meter.*

- 6) Construct 495 linear feet of 12" PVC/DIP pipe to connect the discharged line from well to the existing Los Angeles County Storm Water Main for groundwater discharge.*
- 7) Perform the cleaning and disinfection*
- 8) Finish all work and start operation with proper adjustments to all pump motors and equipment.*
- 9) Monitor the operation during first 3 month and make adjustment if needed.*

SURROUNDING LAND USES AND SETTING (Briefly describe the project's surroundings.):

Existing urban development: Multi-family residential, commercial, industrial, and institutional uses. Multi-family residential complex is directly adjacent to the site on the North.

OTHER AGENCIES WHOSE APPROVAL IS REQUIRED (i.e., permits, financing approval, or participation agreement.):

- California Department of Public Health
- City of Inglewood Planning and Building Department
- City of Inglewood Public Works Department

ENVIRONMENTAL INFORMATION CHECKLIST

Project: City of Inglewood Well No. 7 at 101 West Arbor Vitae Street, Inglewood, California 90301

**ENVIRONMENTAL FACTORS POTENTIALLY AFFECTED:**

The environmental factors checked below would be potentially affected by this project, involving at least one impact that is a "Potentially Significant Impact" as indicated by the checklist on the following pages.

- |  |   |   |
|--|---|---|
| <input type="checkbox"/> Aesthetics                        | <input type="checkbox"/> Agriculture Resources        | <input type="checkbox"/> Air Quality                        |
| <input type="checkbox"/> Biological Resources              | <input type="checkbox"/> Cultural Resources           | <input type="checkbox"/> Geology/Soils                      |
| <input type="checkbox"/> Greenhouse Gas Emissions          | <input type="checkbox"/> Hazard & Hazardous Materials | <input type="checkbox"/> Hydrology/Water Quality            |
| <input type="checkbox"/> Land Use/Planning                 | <input type="checkbox"/> Mineral Resources            | <input checked="" type="checkbox"/> Noise                   |
| <input type="checkbox"/> Population & Housing              | <input type="checkbox"/> Public Services              | <input type="checkbox"/> Recreation                         |
| <input checked="" type="checkbox"/> Transportation/Traffic | <input type="checkbox"/> Utilities/Service Systems    | <input type="checkbox"/> Mandatory Findings of Significance |

**DETERMINATION** (To be completed by the Lead Agency): On the basis of this initial evaluation:

- I find that the proposed project **COULD NOT** have a significant effect on the environment, and a **NEGATIVE DECLARATION** will be prepared.
- I find that although the proposed project could have a significant effect on the environment, there will not be a significant effect in this case because revisions in the project have been made by or agreed to by the project proponent. A **MITIGATED NEGATIVE DECLARATION** will be prepared.
- I find that the proposed project **MAY** have a significant effect on the environment, and an **ENVIRONMENTAL IMPACT REPORT** is required.
- I find that the proposed project **MAY** have a "potentially significant impact" or "potentially significant unless mitigated" impact on the environment, but at least one effect 1) has been adequately analyzed in an earlier document pursuant to applicable legal standards, and 2) has been addressed by mitigation measures based on the earlier analysis as described on attached sheets. An **ENVIRONMENTAL IMPACT REPORT** is required, but it must analyze only the effects that remain to be addressed.
- I find that although the proposed project could have a significant effect on the environment, because all potentially significant effects a) have been analyzed adequately in an earlier EIR or **NEGATIVE DECLARATION** pursuant to applicable standards, and b) have been avoided or mitigated pursuant to that earlier EIR or **NEGATIVE DECLARATION**, including revisions or mitigation measures that are imposed upon the proposed project, nothing further is required.

ENVIRONMENTAL INFORMATION CHECKLIST

Project: City of Inglewood Well No. 7 at 101 West Arbor Vitae Street, Inglewood, California 90301

**CERTIFICATION:**

I hereby certify that the above statements and attached exhibits present the data and information required for this initial evaluation, and that the facts, statements, and information presented are true and correct to the best of my knowledge and belief.

PREPARED BY:

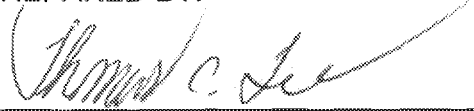
  
\_\_\_\_\_  
Thomas Lee, P.E., Associate Engineer  
City of Inglewood Public Works Department

9/24/2014   
\_\_\_\_\_  
Date

REVIEWED BY:

  
\_\_\_\_\_  
Mindy Wilcox, AICP, Senior Planner  
City of Inglewood Planning and Building Department

9-25-14  
\_\_\_\_\_  
Date

## ENVIRONMENTAL INFORMATION CHECKLIST

Project: City of Inglewood Well No. 7 at 101 West Arbor Vitae Street, Inglewood, California 90301

### EVALUATION OF ENVIRONMENTAL IMPACTS

- 1) A brief explanation is required for all answers except "No Impact" answers that are adequately supported by the information sources a lead agency cites in the parentheses following each question. A "No Impact" answer is adequately supported if the referenced information sources show that the impact simply does not apply to projects like the one involved (i.e., the project falls outside a fault rupture zone). A "No Impact" answer should be explained where it is based on project-specific factors as well as general standards (i.e., the project will not expose sensitive receptors to pollutants, based on a project-specific screening analysis).
- 2) All answers must take into account of the whole action involved, including off-site as well as on-site, cumulative as well as project-level, indirect as well as direct, and construction as well as operational impacts.
- 3) Once the lead agency has determined that a particular physical impact may occur, then the checklist answers must indicate whether the impact is potentially significant, less than significant with mitigation, or less than significant. If there are one or more "Potentially Significant Impact" entries when the determination is made, an EIR is required.
- 4) "Negative Declaration: Less Than Significant With Mitigation Incorporated" applies where the incorporation of mitigation measures has reduced an effect from "Potentially Significant Impact" to a "Less Than Significant Impact". The lead agency must describe the mitigation measures, and briefly explain how they reduce the effect to a less than significant level.
- 5) Earlier analysis may be used where, pursuant to the tiering, program EIR, or other CEQA process, an effect has been adequately analyzed in an earlier EIR or negative declaration. Section 15063(c)(3)(D). In this case, a brief discussion should identify the following:
  - a) Earlier Analysis Used. Identify and state where they are available for review.
  - b) Impacts Adequately Addressed. Identify which effects from the above checklist were within the scope of and adequately analyzed in an earlier document pursuant to applicable legal standards, and state whether such effects were addressed by mitigation measures based on earlier analysis.
  - c) Mitigation Measures. For effects that are "Less than Significant with Mitigation Measures Incorporated", describe the mitigation measures which were incorporated or refined from the earlier document and the extent to which they address site-specific conditions for the project.
- 6) Lead agencies are encouraged to incorporate into the checklist references to information sources for potential impacts (i.e., general plans, zoning ordinances). Reference to a previously prepared or outside document should, where appropriate, include a reference to the page or pages where the statement is substantiated.
- 7) Supporting Information Sources: A source list should be attached, and other sources used or individuals contacted should be cited in the discussion.
- 8) This is only a suggested form, and lead agencies are free to use different formats; however, lead agencies should normally address the questions from this checklist that are relevant to a project's environmental effects in whatever format is selected.
- 9) The explanation of each issue should identify:
  - a) The significance criteria or threshold, if any, used to evaluate each question; and
  - b) The mitigation measure identified, if any, to reduce the impact to less than significance.



ENVIRONMENTAL INFORMATION CHECKLIST

Project Title: City of Inglewood Well No. 7 at 101 West Arbor Vitae Street, Inglewood, California 90301

**EVALUATION OF ENVIRONMENTAL IMPACTS:**

ISSUES		Potentially Significant Impact	Less than Significant with Mitigation Incorporation	Less than Significant Impact	No Impact
--------	--	--------------------------------	---	------------------------------	-----------

<b>I. AESTHETICS.</b> Would the project:	a) Have a substantial adverse effect on a scenic vista?	<input type="checkbox"/>	<input type="checkbox"/>	<input type="checkbox"/>	<input checked="" type="checkbox"/>
	b) Substantially damage scenic resources, including but not limited to, trees, rock outcroppings, and historic buildings within a state scenic highway?	<input type="checkbox"/>	<input type="checkbox"/>	<input checked="" type="checkbox"/>	<input type="checkbox"/>
	c) Substantially degrade the existing visual character or quality of the site and its surroundings?	<input type="checkbox"/>	<input type="checkbox"/>	<input type="checkbox"/>	<input checked="" type="checkbox"/>
	d) Create a new source of substantial light or glare which would adversely affect day or nighttime views in the area?	<input type="checkbox"/>	<input type="checkbox"/>	<input type="checkbox"/>	<input checked="" type="checkbox"/>

**Comments:**

- a) No Impact. There are no scenic vistas within or adjacent to the project site.
- b) Less than Significant Impact. The project is located on the parking lot in a high-density commercial/multi-family residential area. The project site is not on a local street adjacent to a scenic highway and does not have historic buildings or scenic resources. Two trees in the middle of the lot will be removed in order to drill a well, and the pump, motor, and its pipings for new well will be built. The trees and bushes along the Northern property line will remain and protect. New bush/tree will be planted along the South & West Boundary inside a new fence for the well. The anticipated impact is considered to be less than significant.
- c) No Impact. The project is surrounded by urban land uses. The visual quality of the area will not change as a result of the project. Public Hearing and Review is required prior to approval.
- d) No Impact. Existing lighting will temporarily relocated. New lighting will be reinstalled to the project site and lighting will be shielded, diffused, or indirect to avoid glare to pedestrians or motorists and adjacent residents. Lighting fixtures will be selected and located to confine the area of illumination to within the project site.

<b>II. AGRICULTURE RESOURCES.</b> In determining whether impacts to agricultural resources are significant environmental effects, lead agencies may refer to the California Agricultural Land Evaluation and Site Assessment Model (1997) prepared by the California Dept. of Conservation as an optional model to use in assessing impacts on agriculture and farmland. In determining whether	a) Convert Prime Farmland, Unique Farmland, or Farmland of Statewide Importance (Farmland), as shown on the maps prepared pursuant to the Farmland Mapping and Monitoring Program of the California Resources Agency, to non-agricultural use?	<input type="checkbox"/>	<input type="checkbox"/>	<input type="checkbox"/>	<input checked="" type="checkbox"/>
	b) Conflict with existing zoning for agricultural use, or a Williamson Act contract?	<input type="checkbox"/>	<input type="checkbox"/>	<input type="checkbox"/>	<input checked="" type="checkbox"/>
	c) Conflict with existing zoning for, or cause rezoning of, forest land (as defined in Public Resources Code section 12220(g)), timberland (as defined by Public Resources	<input type="checkbox"/>	<input type="checkbox"/>	<input type="checkbox"/>	<input checked="" type="checkbox"/>

ENVIRONMENTAL INFORMATION CHECKLIST

Project Title: City of Inglewood Well No. 7 at 101 West Arbor Vitae Street, Inglewood, California 90301

EVALUATION OF ENVIRONMENTAL IMPACTS:

ISSUES		Potentially Significant Impact	Less than Significant with Mitigation Incorporation	Less than Significant Impact	No Impact
--------	--	--------------------------------	---	------------------------------	-----------

<p>impacts to forest resources, including timberland, are significant environmental effects, lead agencies may refer to information compiled by the California Department of Forestry and Fire Protection regarding the state's inventory of forest land, including the Forest and Range Assessment Project and the Forest Legacy Assessment project; and forest carbon measurement methodology provided in Forest Protocols adopted by the California Air Resources Board. Would the project:</p>	<p>Code section 4526), or timberland zoned Timberland Production (as defined by Government Code section 51104(g))?                      d) Result in the loss of forest land or conversion of forest land to non-forest use?                      e) Involve other changes in the existing environment which, due to their location or nature, could result in conversion of Farmland, to non-agricultural use?</p>	<p><input type="checkbox"/> <input type="checkbox"/></p>	<p><input type="checkbox"/> <input type="checkbox"/></p>	<p><input type="checkbox"/> <input type="checkbox"/></p>	<p><input checked="" type="checkbox"/> <input checked="" type="checkbox"/></p>
--	---	--	--	--	--

Comments:

- a) No Impact. The project site is surrounded by urban land uses. No farming activities have taken place at the site or are planned for the site.
- b) No Impact. Based on the urban setting there is not conflict with existing zoning for agricultural use or the Williamson Act contract.
- c) No Impact. The project site is located in an urban area that is developed with business and multi-family residential.
- d) No Impact. Refer to response "c".
- e) No Impact. Refer to response "c".

<p>III. AIR QUALITY. Where available, the significance criteria established by the applicable air quality management or air pollution control district may be relied upon to make the following determinations. Would the project:</p>	<p>a) Conflict with or obstruct implementation of the applicable air quality plan?                      b) Violate any air quality standard or contribute substantially to an existing or projected air quality violation?                      c) Result in a cumulatively considerable net increase of any criteria pollutant for which the project region is non-attainment under an applicable federal or state ambient air quality standard (including releasing emissions which exceed quantitative thresholds for ozone precursors)?                      d) Expose sensitive receptors to substantial pollutants concentrations?                      e) Create objectionable odors affecting a substantial number of people?</p>	<p><input type="checkbox"/> <input type="checkbox"/> <input type="checkbox"/> <input type="checkbox"/> <input type="checkbox"/></p>	<p><input type="checkbox"/> <input type="checkbox"/> <input type="checkbox"/> <input type="checkbox"/> <input type="checkbox"/></p>	<p><input type="checkbox"/> <input checked="" type="checkbox"/> <input checked="" type="checkbox"/> <input checked="" type="checkbox"/> <input type="checkbox"/></p>	<p><input checked="" type="checkbox"/> <input type="checkbox"/> <input type="checkbox"/> <input type="checkbox"/> <input checked="" type="checkbox"/></p>
--	---	---	---	--	---

Comments:

ENVIRONMENTAL INFORMATION CHECKLIST

Project Title: City of Inglewood Well No. 7 at 101 West Arbor Vitae Street, Inglewood, California 90301

**EVALUATION OF ENVIRONMENTAL IMPACTS:**

ISSUES		Potentially Significant Impact	Less than Significant with Mitigation Incorporation	Less than Significant Impact	No Impact
--------	--	--------------------------------	---	------------------------------	-----------

<p>a) No Impact. The project is located in the South Coast Air Quality Management District and will comply with all air quality standards.</p> <p>b) Less than Significant Impact. During the construction phase, heavy equipments and vehicles of workers will generate emissions. Emissions will be controlled by routine, mandatory low-emissions tune-ups for on-site equipment. In addition, fugitive dust would also be generated during the minimum grading to flatten out the existing lot for a period of less than a week. Construction activities will be mainly well drilling, where water will be used to minimize the air pollution. If it does occur, most of the dust would settle on or near the project site. The following measures will be implemented to control the dust.</p> <ol style="list-style-type: none"> <li>1. Use of dust control during clearing, grading and construction. The measures will include regular watering of the site or other dust-preventative measures. Grading and construction operations will cease when wind speeds are 25 mph or greater.</li> <li>2. Minimization of construction interference with regional non-project traffic movement, including: <ul style="list-style-type: none"> <li>• Scheduling receipt of construction materials to non-peak travel periods.</li> <li>• Routing construction traffic through areas of least impact sensitivity.</li> <li>• Limiting lane closures and detours to off-peak travel periods.</li> </ul> <p>The anticipated impact is considered to be less than significant.</p> </li> </ol> <p>c) Less than Significant Impact. It is not anticipated that the construction of the water pumping plant or the operation of the water pumping will result in a cumulatively considerable net increase of any criteria pollutant. The anticipated impact is considered to be less than significant.</p> <p>d) Less than Significant Impact. Sensitive receptors are defined as populations that are more susceptible to the effects of pollution than the population at large. The SCAQMD identifies the following as sensitive receptors: long-term health care facilities, rehabilitation centers, convalescent homes, residences, schools, playgrounds, childcare centers, and athletic facilities. According to the SCAQMD, projects have the potential to create significant impacts if they are located within one-quarter mile of sensitive receptors and would emit toxic air contaminants identified in SCAQMD Rule 1401. The project site is located in a commercial/residential area, and while there a school approximately 220' away, however it is not anticipated that there will be a significant increase in the level of air toxics from the construction activities. No significant adverse impacts are anticipated.</p> <p>e) No Impact. The proposed project does not create objectionable odors.</p>					
--	--	--	--	--	--

<p><b>IV. BIOLOGICAL RESOURCES.</b> Would the project:</p>	<p>a) Have a substantial adverse effect, either directly or through habitat modifications, on any species identified as a candidate, sensitive, or special status species in local or regional plans, policies, or regulations, or by the California Department of Fish and Game or U.S. Fish and Wildlife Service?</p> <p>b) Have a substantial adverse effect on any riparian habitat or other sensitive natural</p>	<p><input type="checkbox"/></p> <p><input type="checkbox"/></p>	<p><input type="checkbox"/></p> <p><input type="checkbox"/></p>	<p><input type="checkbox"/></p> <p><input type="checkbox"/></p>	<p><input checked="" type="checkbox"/></p> <p><input checked="" type="checkbox"/></p>
--	--	---	---	---	---

ENVIRONMENTAL INFORMATION CHECKLIST

Project Title: City of Inglewood Well No. 7 at 101 West Arbor Vitae Street, Inglewood, California 90301

EVALUATION OF ENVIRONMENTAL IMPACTS:

ISSUES		Potentially Significant Impact	Less than Significant with Mitigation Incorporation	Less than Significant Impact	No Impact
--------	--	--------------------------------	---	------------------------------	-----------

	community identified in local or regional plans, policies, regulations, or by the California Department of Fish and Game or U.S. Fish and Wildlife Service? c) Have a substantial adverse effect on federally protected wetlands as defined by Section 404 of the Clean Water Act (including, but not limited to, marsh, vernal pool, coastal, etc.) through direct removal, filling, hydrological interruption, or other mean? d) Interfere substantially with the movement of any native resident or migratory fish or wildlife species or with established native resident or migratory wildlife corridors, or impede the use of native wildlife nursery sites? e) Conflict with any local policies or ordinances protecting biological resources, such as a tree preservation policy or ordinance? f) Conflict with the provisions of an adopted Habitat Conservation Plan, or other approved local, regional, or state habitat conservation plan?	<input type="checkbox"/>                      	<input type="checkbox"/>                      	<input type="checkbox"/>                      	<input checked="" type="checkbox"/>                      
--	--	--	--	--	---

**Comments:**

- a) No Impact. The proposed project does not have the potential to degrade the quality of the environment, reduce the fish and wildlife habitat, threaten plant, fish or wildlife species, or eliminate historical, archeological, or cultural resources. No adverse impacts are anticipated.
- b) No Impact. The project site is located in an urban area with no natural communities. No riparian habitat exists on site, meaning the project will not have any impacts.
- c) No Impact. No wetland habitat is present on site. As a result, project implementation would have no impact on these resources.
- d) No Impact. The majority of the surrounding area has been developed, thereby disrupting any wildlife corridors that may have existed. No adverse impacts are anticipated.
- e) No Impact. The proposed project is not in conflict with any local ordinance.
- f) No Impact. The project is located in an area characterized by existing urban and commercial development. No habitat conservation plans have been adopted for the area where the proposed project is located. No conflicts with habitat conservation plans will occur.

V. CULTURAL	a) Cause a substantial adverse change in the significance of a historical resource as	<input type="checkbox"/>	<input type="checkbox"/>	<input type="checkbox"/>	<input checked="" type="checkbox"/>
-------------	---	--------------------------	--------------------------	--------------------------	-------------------------------------

ENVIRONMENTAL INFORMATION CHECKLIST

Project Title: City of Inglewood Well No. 7 at 101 West Arbor Vitae Street, Inglewood, California 90301

**EVALUATION OF ENVIRONMENTAL IMPACTS:**

ISSUES		Potentially Significant Impact	Less than Significant with Mitigation Incorporation	Less than Significant Impact	No Impact
--------	--	--------------------------------	---	------------------------------	-----------

<b>RESOURCES.</b> Would the project:	defined in Section 15064.5? b) Cause a substantial adverse change in the significance of an archaeological resource pursuant to Section 15064.5? c) Directly or indirectly destroy a unique paleontological resource or site or unique geologic feature? d) Disturb any human remains, including those interred outside of formal cemeteries?	<input type="checkbox"/>  <input type="checkbox"/>  <input type="checkbox"/>	<input type="checkbox"/>  <input type="checkbox"/>  <input type="checkbox"/>	<input type="checkbox"/>  <input type="checkbox"/>  <input type="checkbox"/>	<input checked="" type="checkbox"/>  <input checked="" type="checkbox"/>  <input checked="" type="checkbox"/>
---	--	--	--	--	---

**Comments:**

- a) No Impact. The project site is currently a 9-space parking space. It has not been identified as a historic resource. No historical sites or resources have been recorded.
- b) No Impact. No archaeological sites or resources have been recorded.
- c) No Impact. No paleontological sites or resources have been recorded at the site.
- d) No Impact. The proposed project is in an area that has already been disturbed by existing development from car repair shop in 1980s to existing 9-space parking space in 1995. No known religious or sacred sites exist within the project area.

<b>VI. GEOLOGY AND SOILS.</b> Would the project:	a) Expose people or structures to potential substantial adverse effects, including the risk of loss, injury, or death involving: i) Rupture of a known earthquake fault, as delineated on the most recent Alquist-Priolo Earthquake Fault Zoning Map issued by the State Geologist for the area or based on other substantial of a known fault? Refer to Division of Mines and Geology Special Publication 42. ii) Strong seismic ground shaking? iii) Seismic-related ground failure, including liquefaction? iv) Landslides? b) Result in substantial soil erosion or the loss of topsoil? c) Be located on a geologic unit or soil that is unstable, or that would become unstable as a result of the project, and potentially result in on- or off-site landslide, lateral spreading, subsidence, liquefaction or collapse? d) Be located on expansive soil, as defined in Table 18-1-B of the Uniform Building Code (1994), creating substantial risks to life	<input type="checkbox"/>  <input type="checkbox"/>  <input type="checkbox"/>  <input type="checkbox"/>  <input type="checkbox"/>  <input type="checkbox"/>  <input type="checkbox"/>  <input type="checkbox"/>	<input type="checkbox"/>  <input type="checkbox"/>  <input type="checkbox"/>  <input type="checkbox"/>  <input type="checkbox"/>  <input type="checkbox"/>  <input type="checkbox"/>	<input checked="" type="checkbox"/>  <input checked="" type="checkbox"/>  <input checked="" type="checkbox"/>  <input checked="" type="checkbox"/>  <input type="checkbox"/>  <input checked="" type="checkbox"/>  <input type="checkbox"/>	<input type="checkbox"/>  <input type="checkbox"/>  <input type="checkbox"/>  <input checked="" type="checkbox"/>  <input type="checkbox"/>  <input checked="" type="checkbox"/>
---	--	--	--	---	--

ENVIRONMENTAL INFORMATION CHECKLIST

Project Title: City of Inglewood Well No. 7 at 101 West Arbor Vitae Street, Inglewood, California 90301

**EVALUATION OF ENVIRONMENTAL IMPACTS:**

ISSUES		Potentially Significant Impact	Less than Significant with Mitigation Incorporation	Less than Significant Impact	No Impact
--------	--	--------------------------------	---	------------------------------	-----------

	or property? e) Have soils incapable of adequately supporting the use of septic tanks or alternative waste water disposal systems where sewers are not available for the disposal of waste water?	<input type="checkbox"/>	<input type="checkbox"/>	<input type="checkbox"/>	<input checked="" type="checkbox"/>
--	--	--------------------------	--------------------------	--------------------------	-------------------------------------

**Comments:**

- a) i) Less than Significant Impact. The project is located 1 mile away from the Newport-Inglewood Fault Zone, which is a B fault. The project will be unmanned and will include a pump, motor and electrical panel. The impact is anticipated to be less than significant.
- ii) Less than Significant Impact. The Newport-Inglewood fault is capable of a 6.9 magnitude earthquake, which is capable of substantial damage. The project will be designed and built according to the codes and standards of the City of Inglewood. All construction will be in compliance with the American Water Works (AWWA) standards, Uniform Building Code (UBC) and ordinances adopted by the City related to construction and safety. The impact is anticipated to be less than significant.
- iii) Less than Significant Impact. The risk of ground failure/liquefaction is possible in areas of high ground water (generally less than 50 feet deep). Static groundwater levels at the site are approximately 130 feet below ground level. In general water levels at these depths do not contribute to ground failure including liquefaction.
- iv) No Impact. The project site is located at the relatively flat topography. The chance of landslides does not exist/occur.
- b) Less than Significant Impact. Construction may result in the minor soil erosion or loss of topsoil. The contractor will provide dust control during clearing, grading and construction. Fugitive dust generated during cleaning, grading, earth moving, or excavation should be controlled by regular watering or other dust-preventative measures.
- c) No Impact. As previously discussed, the potential for liquefaction and landslides associated with the project is less than significant. The West Coast Basin is an adjudicated groundwater basin and the pumping activities are carefully monitored.
- d) No Impact. The project is located on a silty clay soil that exhibits little expansion. The project will be constructed according to the American Water Works (AWWA) standards, and will comply with Uniform Building Code (1994) and all other provisions.
- e) No Impact. The area is served by the local sewer system and the use of alternative systems is not necessary. There will be no impact to the sewage system.

<b>VII. GREENHOUSE GAS EMISSIONS.</b> Would the project:	a) Generate greenhouse gas emissions, either directly or indirectly, that may have a significant impact on the environment? b) Conflict with any applicable plan, policy or regulation of an agency adopted for the purpose of reducing the emissions of greenhouse gases?	<input type="checkbox"/>	<input type="checkbox"/>	<input type="checkbox"/>	<input checked="" type="checkbox"/>
		<input type="checkbox"/>	<input type="checkbox"/>	<input type="checkbox"/>	<input checked="" type="checkbox"/>

ENVIRONMENTAL INFORMATION CHECKLIST

Project Title: City of Inglewood Well No. 7 at 101 West Arbor Vitae Street, Inglewood, California 90301

EVALUATION OF ENVIRONMENTAL IMPACTS:

ISSUES		Potentially Significant Impact	Less than Significant with Mitigation Incorporation	Less than Significant Impact	No Impact
--------	--	--------------------------------	---	------------------------------	-----------

Comments:

- a) No Impact. The proposed project does not create objectionable greenhouse gas emissions.
- b) No Impact. Refer to response "a".

<p><b>VIII. HAZARDS AND HAZARDOUS MATERIALS.</b> Would the project:</p>	<p>a) Create a significant hazard to the public or the environment through the routine transport, use or disposal of hazardous materials?</p> <p>b) Create a significant hazard to the public or the environment through reasonably foreseeable upset and accident conditions involving the release of hazardous materials into the environment?</p> <p>c) Emit hazardous emissions or handle hazardous or acutely hazardous materials, substances, or waste within one-quarter mile of an existing or proposed school?</p> <p>d) Be located on a site which is included on a list of hazardous materials sites compiled pursuant to Government Code Section 65962.5 and , as a result, would create a significant hazard to the public or environment?</p> <p>e) For a project located within an airport land use plan or, where such a plan has not been adopted, within two miles of a public airport or public use airport, would the project result in a safety hazard for people residing or working in the project area?</p> <p>f) For a project within the vicinity of a private airstrip, would the project result in a safety hazard for people residing or working within the project area?</p> <p>g) Impair implementation of, or physically interfere with, an adopted emergency response plan or emergency evacuation plan?</p> <p>h) Expose people or structures to a significant risk of loss, injury or death involving wildland fires, including where wildlands are adjacent to urbanized areas or where residences are intermixed with wildlands?</p>	<p><input type="checkbox"/></p> <p><input type="checkbox"/></p> <p><input type="checkbox"/></p> <p><input type="checkbox"/></p> <p><input type="checkbox"/></p> <p><input type="checkbox"/></p> <p><input type="checkbox"/></p> <p><input type="checkbox"/></p> <p><input type="checkbox"/></p>	<p><input type="checkbox"/></p> <p><input type="checkbox"/></p> <p><input type="checkbox"/></p> <p><input type="checkbox"/></p> <p><input type="checkbox"/></p> <p><input type="checkbox"/></p> <p><input type="checkbox"/></p> <p><input type="checkbox"/></p>	<p><input type="checkbox"/></p> <p><input type="checkbox"/></p> <p><input type="checkbox"/></p> <p><input type="checkbox"/></p> <p><input type="checkbox"/></p> <p><input type="checkbox"/></p> <p><input type="checkbox"/></p> <p><input type="checkbox"/></p>	<p><input checked="" type="checkbox"/></p> <p><input checked="" type="checkbox"/></p> <p><input checked="" type="checkbox"/></p> <p><input checked="" type="checkbox"/></p> <p><input checked="" type="checkbox"/></p> <p><input checked="" type="checkbox"/></p> <p><input checked="" type="checkbox"/></p> <p><input checked="" type="checkbox"/></p> <p><input checked="" type="checkbox"/></p>
---	---	---	---	---	--

ENVIRONMENTAL INFORMATION CHECKLIST

Project Title: City of Inglewood Well No. 7 at 101 West Arbor Vitae Street, Inglewood, California 90301

**EVALUATION OF ENVIRONMENTAL IMPACTS:**

ISSUES		Potentially Significant Impact	Less than Significant with Mitigation Incorporation	Less than Significant Impact	No Impact
--------	--	--------------------------------	---	------------------------------	-----------

**Comments:**

- a) No Impact. The project will not involve the transport, use or disposal of hazardous materials.
- b) No Impact. The proposed project does not involve the use of hazardous materials or volatile fuels.
- c) No Impact. The proposed project does not involve the use of hazardous materials or volatile fuels.
- d) No Impact. The site is not listed as a hazardous materials site.
- e) No Impact. The project is located within 2 miles of a public airport. However, there are no hazardous materials used at the site and it will not result in a safety hazard for the people working or residing in the area. The proposed use will comply with the standards for mitigating noise.
- f) No Impact. There are no hazardous materials used at the site and it will not result in a safety hazard for the people working or residing in the area.
- g) No Impact. The project is not located adjacent to any emergency evacuation route. The project will comply with all standards and City codes. The project is required to comply with all applicable City codes, no adverse impacts are anticipated.
- h) No Impact. The project is not located in an area subject to wild land fires or adjacent to wild lands. The project is within an urban area.

<p><b>IX. HYDROLOGY AND WATER QUALITY.</b> Would the project:</p>	<p>a) Violate any water quality standards or waste discharge requirements?</p> <p>b) Substantially deplete groundwater supplies or interfere substantially with groundwater recharge such that there would be a net deficit in aquifer volume or a lowering of the local groundwater table level (i.e., the production rate of pre-existing nearby wells would drop to a level which would not support existing land uses or planned uses for which permits have been granted)?</p> <p>c) Substantially alter the existing drainage pattern of the site or area, including through the alteration of the course of a stream or river, in a manner which would result in substantial erosion or siltation on- or offsite?</p> <p>d) Substantially alter the existing drainage pattern of the site or area, including through the alteration of the course of a stream or river, or substantially increase the rate or amount of surface runoff in a manner which would result in flooding on- or off-site?</p>	<p><input type="checkbox"/></p> <p><input type="checkbox"/></p> <p><input type="checkbox"/></p> <p><input type="checkbox"/></p>	<p><input type="checkbox"/></p> <p><input type="checkbox"/></p> <p><input type="checkbox"/></p> <p><input type="checkbox"/></p>	<p><input type="checkbox"/></p> <p><input checked="" type="checkbox"/></p> <p><input type="checkbox"/></p> <p><input type="checkbox"/></p>	<p><input checked="" type="checkbox"/></p> <p><input type="checkbox"/></p> <p><input checked="" type="checkbox"/></p> <p><input checked="" type="checkbox"/></p>
---	---	---	---	--	--



ENVIRONMENTAL INFORMATION CHECKLIST

Project Title: City of Inglewood Well No. 7 at 101 West Arbor Vitae Street, Inglewood, California 90301

EVALUATION OF ENVIRONMENTAL IMPACTS:

ISSUES		Potentially Significant Impact	Less than Significant with Mitigation Incorporation	Less than Significant Impact	No Impact
<p>e) Create or contribute runoff water which would exceed the capacity of existing or planned stormwater drainage systems or provide substantial additional sources of polluted runoff?</p> <p>f) Otherwise substantially degrade water quality?</p> <p>g) Place housing within 100-year flood hazard area as mapped on a federal Flood Hazard Boundary or Flood Insurance Rate Map or other flood hazard delineation map?</p> <p>h) Place within a 100-year flood hazard area structures which would impede or redirect flood flows?</p> <p>i) Expose people or structures to a significant risk of loss, injury or death involving flooding, including flooding as a result of the failure of a levee or dam?</p> <p>j) Inundation by seiche, tsunami, or mudflow?</p>		<p><input type="checkbox"/></p> <p><input type="checkbox"/></p> <p><input type="checkbox"/></p> <p><input type="checkbox"/></p> <p><input type="checkbox"/></p> <p><input type="checkbox"/></p>	<p><input type="checkbox"/></p> <p><input type="checkbox"/></p> <p><input type="checkbox"/></p> <p><input type="checkbox"/></p> <p><input type="checkbox"/></p> <p><input type="checkbox"/></p>	<p><input checked="" type="checkbox"/></p> <p><input checked="" type="checkbox"/></p> <p><input type="checkbox"/></p> <p><input type="checkbox"/></p> <p><input type="checkbox"/></p> <p><input type="checkbox"/></p>	<p><input type="checkbox"/></p> <p><input type="checkbox"/></p> <p><input checked="" type="checkbox"/></p> <p><input checked="" type="checkbox"/></p> <p><input checked="" type="checkbox"/></p> <p><input checked="" type="checkbox"/></p>
<p><b>Comments:</b></p> <p>a) No Impact. There will be minimal use of water at the site or waste discharge from the site. All discharges will meet the requirements of the National Pollution Discharge Elimination System permit obtained for the project.</p> <p>b) Less than Significant Impact. The project will not substantially deplete groundwater supplies or interfere substantially with groundwater recharge. The project is located in the West Coast Basin (West Basin). West Basin is a large groundwater basin and extractions from the basin are under the jurisdiction of the West Basin Watermaster (Watermaster). The Watermaster maintains the basin for the benefit of all parties. The City of Inglewood (City) has annual adjudicated water rights of 4,449.89 acre-feet per year. This is approximately 6.9% of the rights to produce from the basin. In recent years the groundwater production from City's four active wells is 2100 acre-feet per year. The new well and pumping facilities are being constructed to allow the City to fully utilize their groundwater pumping rights. The well is estimated to produce approximately 1,500 gallons per minute, which is about 2,300 acre-feet per year, and the new well is not estimated to affect the direction of groundwater flow. No significant adverse impacts are anticipated.</p> <p>c) No Impact. No streams or streambeds are present on the site. The areas immediately off-site are paved urban street and no erosion is anticipated off-site.</p> <p>d) No Impact. The project will not alter the existing drainage from the site and will not result in the increase in the rate and amount of surface runoff. In addition, it is not anticipated that the changes from parking lot to water pumping facility will result in flooding on or off-site. Thus no adverse impact is anticipated.</p> <p>e) Less than Significant Impact. Runoff water above ground construction will be minimal. The new</p>					

ENVIRONMENTAL INFORMATION CHECKLIST

Project Title: City of Inglewood Well No. 7 at 101 West Arbor Vitae Street, Inglewood, California 90301

**EVALUATION OF ENVIRONMENTAL IMPACTS:**

ISSUES		Potentially Significant Impact	Less than Significant with Mitigation Incorporation	Less than Significant Impact	No Impact
--------	--	--------------------------------	---	------------------------------	-----------

well site will have more infiltration area, so it will result in a decrease in paving or impervious surfaces that would create an increase in the amount of surface runoff exceeding the capacity of existing or planned stormwater drainage systems. However, the increase in run-off during the construction is expected to be short and temporary, but it will be mitigated through NPDES standards and regulations.

f) Less than Significant Impact. Grading activities associated with construction may result in a temporary increase in suspended solids if there is a storm during the construction period. The project will comply with the requirements of the National Pollution Discharge Elimination System and the standards of the City of Inglewood. Any potential impacts are expected to be temporary and less than significant.

g) No Impact. The site is not within a 100-year flood zone.

h) No Impact. Refer to response "g".

i) No Impact. No dams or levees are located near the site.

j) No Impact. There are no lakes or reservoirs near the site; therefore impacts from a seiche are not anticipated. The site is relatively flat and mudflows are also not anticipated. The site is located 6.6 miles from the Pacific Ocean. Because of the distance, it is not anticipated that a tsunami will inundate the site.

<p><b>X. LAND USE AND PLANNING.</b> Would the project:</p>	<p>a) Physically divide an established community?</p>	<input type="checkbox"/>	<input type="checkbox"/>	<input type="checkbox"/>	<input checked="" type="checkbox"/>
	<p>b) Conflict with any applicable land use plan, policy, or regulation of any agency with jurisdiction over the project (including, but not limited to the general plan, specific plan, local coastal program, or zoning ordinance) adopted for the purpose of avoiding or mitigating an environmental effect?</p>	<input type="checkbox"/>	<input type="checkbox"/>	<input type="checkbox"/>	<input checked="" type="checkbox"/>
	<p>c) Conflict with any applicable habitat conservation plan or natural community conservation plan?</p>	<input type="checkbox"/>	<input type="checkbox"/>	<input type="checkbox"/>	<input checked="" type="checkbox"/>

**Comments:**

a) No Impact. The project is being constructed in an urban area with existing residential and commercial uses. The project will become a part of the larger community.

b) No Impact. The project is consistent with the City of Inglewood General Plan and does not conflict with any policies for environmental protection.

c) No Impact. The project is within an established urban area with residential and commercial uses.

<p><b>XI. MINERAL RESOURCES.</b> Would the project:</p>	<p>a) Result in the loss of availability of a known mineral resource that would be of value to the region and the residents of the state?</p>	<input type="checkbox"/>	<input type="checkbox"/>	<input type="checkbox"/>	<input checked="" type="checkbox"/>
	<p>b) Result in the loss of availability of a</p>	<input type="checkbox"/>	<input type="checkbox"/>	<input type="checkbox"/>	<input checked="" type="checkbox"/>

ENVIRONMENTAL INFORMATION CHECKLIST

Project Title: City of Inglewood Well No. 7 at 101 West Arbor Vitae Street, Inglewood, California 90301

**EVALUATION OF ENVIRONMENTAL IMPACTS:**

ISSUES		Potentially Significant Impact	Less than Significant with Mitigation Incorporation	Less than Significant Impact	No Impact
--------	--	--------------------------------	---	------------------------------	-----------

	locally-important mineral resource recovery site delineated on a local general plan, specific plan or other land use plan?				
--	--	--	--	--	--

**Comments:**

- a) No Impact. The project is within an established urban area with residential and commercial uses. There are no known mineral resources in the area.
- b) No Impact. There are no known mineral resources in the area.

<p><b>XII. NOISE.</b> Would the project result in:</p>	a) Exposure of persons to or generation of noise levels in excess of standards established in the local general plan or noise ordinance, or applicable standards of other agencies?	<input type="checkbox"/>	<input type="checkbox"/>	<input type="checkbox"/>	<input checked="" type="checkbox"/>
	b) Exposure of persons to or generation of excessive groundborne vibration or groundborne noise levels?	<input type="checkbox"/>	<input type="checkbox"/>	<input type="checkbox"/>	<input checked="" type="checkbox"/>
	c) A substantial permanent increase in ambient noise levels in the project vicinity above levels existing without the project?	<input type="checkbox"/>	<input type="checkbox"/>	<input checked="" type="checkbox"/>	<input type="checkbox"/>
	d) A substantial temporary or periodic increase in ambient noise levels in the project vicinity above levels existing without the project?	<input type="checkbox"/>	<input type="checkbox"/>	<input checked="" type="checkbox"/>	<input type="checkbox"/>
	e) For a project located within an airport land use plan or, where such a plan has not been adopted, within two miles of a public airport or public use airport would the project expose people residing or working in the project area to excessive noise levels?	<input type="checkbox"/>	<input type="checkbox"/>	<input type="checkbox"/>	<input checked="" type="checkbox"/>
	f) For a project within the vicinity of a private airstrip, would the project expose people residing or working in the project area to excessive noise levels?	<input type="checkbox"/>	<input type="checkbox"/>	<input type="checkbox"/>	<input checked="" type="checkbox"/>

**Comments:**

- a) No Impact. The pumping equipment will meet all applicable city standards and codes. A new sound-proof wall will be installed to reduce the noise level to minimal, and also the noise from the well drilling for a month is only temporary. Operational noise from the submersible pump for the well would be minimal or none.
- b) No Impact. The pumping equipment will meet all applicable city standards and codes. The uses associated with this project normally do not induce excessive groundborne vibrations and noise level. A new sound-proof wall will be installed to reduce the noise level to minimal, and also the noise from the well drilling for a month is only temporary. Vibration from the operation of the

ENVIRONMENTAL INFORMATION CHECKLIST

Project Title: City of Inglewood Well No. 7 at 101 West Arbor Vitae Street, Inglewood, California 90301

**EVALUATION OF ENVIRONMENTAL IMPACTS:**

ISSUES		Potentially Significant Impact	Less than Significant with Mitigation Incorporation	Less than Significant Impact	No Impact
--------	--	--------------------------------	---	------------------------------	-----------

submersible pump would be undetectable or minimal.

c) Less than Significant Impact. There is no anticipated increase in permanent ambient noise levels due to operational noise associated with this project. Operational impacts from the well would be minimal because underground submersible pump is most likely to be installed for the new well to minimize the noises to minimal/none. The pumping equipment will meet all applicable City standards and codes.

d) Less than Significant Impact. The construction activities will generate noises, primarily from the drilling of well in 24 hours a day operation. To drill a 800-foot well will require approximately 30 days for 24 hour/day in preventing well collapse if it stops. During construction, the drilling of the well is anticipated to produce noise levels of 80~90 dB within 50 feet. A temporary 35~40 foot high sound-proof (rated STC-28) wall, which will design by registered Professional Engineer/Acoustical Specialist, will be constructed around the drilling area. It is anticipated to reduce down to estimated 30~45 dB level as measured at the property lines. As this mitigated sound level is below that permitted under the City's noise regulations, it is considered a less than significant impact as mitigated. Because the construction activity will occur 24 hours a day, the project is required to receive approval by the Permits and Licensing Committee through the Finance Department. In addition, the drilling of a new well is only temporary for a month. *Note: STC stands for Sound Transmission Class; the higher the STC, the more sound is stopped.* Also noise generated from construction vehicles would be temporary in the day time period only, and all construction machinery will be maintained according to industry standards to help minimize the impacts. These temporary construction activities associated with the project will be done during the working period from 9:00AM to 4:00PM per City Municipal Code. Thus, the impact is expected to be less than significant.

e) No Impact. The project is within 2 miles of a public airport but it will not expose people residing or working in the project area to excessive noise levels. A new sound-proof wall will be installed to reduce the noise level to minimal. Also the noise from the well drilling for a month is only temporary. Operation from the submersible pump for the well would be minimal.

f) No Impact. The project will not expose people residing or working in the project area to excessive noise levels. A new sound-proof wall will be installed to reduce the noise level to minimal. Also the noise from the well drilling for a month is only temporary. Operation from the submersible pump for the well would be minimal.

<p><b>XIII. POPULATION AND HOUSING.</b> would the project:</p>	<p>a) Induce substantial population growth in an area, either directly (for example, by proposing new homes and businesses) or indirectly (for example, through extension of roads or other infrastructure)?</p> <p>b) Displace substantial numbers of existing housing, necessitating the construction of replacement housing elsewhere?</p> <p>c) Displace substantial numbers of people, necessitating the construction of</p>	<p><input type="checkbox"/></p> <p><input type="checkbox"/></p> <p><input type="checkbox"/></p>	<p><input type="checkbox"/></p> <p><input type="checkbox"/></p> <p><input type="checkbox"/></p>	<p><input type="checkbox"/></p> <p><input type="checkbox"/></p> <p><input type="checkbox"/></p>	<p><input checked="" type="checkbox"/></p> <p><input checked="" type="checkbox"/></p> <p><input checked="" type="checkbox"/></p>
--	---	---	---	---	--

ENVIRONMENTAL INFORMATION CHECKLIST

Project Title: City of Inglewood Well No. 7 at 101 West Arbor Vitae Street, Inglewood, California 90301

**EVALUATION OF ENVIRONMENTAL IMPACTS:**

ISSUES		Potentially Significant Impact	Less than Significant with Mitigation Incorporation	Less than Significant Impact	No Impact
--------	--	--------------------------------	---	------------------------------	-----------

	replacement housing elsewhere?				
<p><b>Comments:</b></p> <p>a) No Impact. The project is to build a new well on the existing parking lot for the water production. There will be no direct or indirect effect to induce substantial growth in the area as a result of the construction of the project.</p> <p>b) No Impact. No homes will be destroyed as a result of the project. The project is located on a parking lot.</p> <p>c) No Impact. No people will be displaced as a result of the project. The project is located on a parking lot.</p>					

<p><b>XIV. PUBLIC SERVICES.</b></p>	<p>a) Would the project result in substantial adverse physical impacts associated with the provision of new or physically altered governmental facilities, need for new or physically altered governmental facilities, the construction of which could cause significant environmental impacts, in order to maintain acceptable service ratios, response times or other performance objectives for any of the public services:</p> <p>a) Fire protection?</p> <p>b) Police protection?</p> <p>c) Schools?</p> <p>d) Parks?</p> <p>e) Other public facilities?</p>	<input type="checkbox"/> <input type="checkbox"/> <input type="checkbox"/> <input type="checkbox"/> <input type="checkbox"/>	<input type="checkbox"/> <input type="checkbox"/> <input type="checkbox"/> <input type="checkbox"/> <input type="checkbox"/>	<input type="checkbox"/> <input type="checkbox"/> <input type="checkbox"/> <input type="checkbox"/> <input type="checkbox"/>	<input checked="" type="checkbox"/> <input checked="" type="checkbox"/> <input checked="" type="checkbox"/> <input checked="" type="checkbox"/> <input checked="" type="checkbox"/>
-------------------------------------	---	--	--	--	---

<p><b>Comments:</b></p> <p>a) No Impact. The project is located in a developed area served by the County of Los Angeles Fire Department. The project will not require the construction of any new facilities, the alteration of existing facilities or a decline in the level of service.</p> <p>b) No impact. The project is located in a developed area served by the Inglewood Police Department. The project will not require the construction of any new facilities, the alteration of existing facilities or a decline in the level of service.</p> <p>c) No Impact. The project is located in a developed area served by the Inglewood Unified School District. The project will not require the construction of any new facilities, the alteration of existing facilities or a decline in the level of service. No Impact. The project is located in a developed area served by the City of Inglewood. The project will not require the construction of any new facilities, the alteration of existing facilities or a decline in the level of service.</p> <p>d) No Impact. The project is located in a developed area served by the City of Inglewood. The project will not require the construction of any new facilities, the alteration of existing facilities or a decline in the level of service.</p>					
---	--	--	--	--	--

<b>XV.</b>	a) Would the project increase the use of	<input type="checkbox"/>	<input type="checkbox"/>	<input type="checkbox"/>	<input checked="" type="checkbox"/>
------------	--	--------------------------	--------------------------	--------------------------	-------------------------------------



ENVIRONMENTAL INFORMATION CHECKLIST

Project Title: City of Inglewood Well No. 7 at 101 West Arbor Vitae Street, Inglewood, California 90301

**EVALUATION OF ENVIRONMENTAL IMPACTS:**

ISSUES		Potentially Significant Impact	Less than Significant with Mitigation Incorporation	Less than Significant Impact	No Impact
--------	--	--------------------------------	---	------------------------------	-----------

	the performance or safety of such facilities?				
<p><b>Comments:</b></p> <p>a) Less than Significant Impact. The project is located on the 75'x118' parking lot on the intersection of Grevillea Avenue and Arbor Vitae Street. During the construction of the project, would be temporary short-term impact on the local street traffic. The traffic would increase because of the temporary movement and parking of heavy construction vehicles for setup and laying down materials. Once it is in construction, the lot is able to accommodate all construction vehicles and materials. In addition, the project will not create a substantial increase in the number of vehicle trips, traffic volume or congestion at intersections.</p> <p>b) No Impact. The project is located in an urban area with existing street improvements. The project will not have a negative effect on the level of service standards on the adjacent streets.</p> <p>c) No Impact. The project will not create a substantial safety risk or interfere with air traffic patterns at Los Angeles International Airport.</p> <p>d) No Impact. The project is located in an urban area with existing street improvements. No alterations are proposed for the adjacent streets or intersections.</p> <p>e) No Impact. The project will provide adequate access for all emergency vehicles and will not create inadequate emergency access. The project will conform to all City of Inglewood codes.</p> <p>f) Less than Significant Impact. The project is located in an urban area with existing street improvements. The existing bus stop (with pole only but no bench) will be relocated Eastward across Grevillea Avenue, where existing two curb-side meter parking spaces will be used for public access to get on/off bus as bus stop. No other alterations are proposed for the adjacent streets or intersections. The project will comply with all City adopted policies and plans to ensure no decline in the level of service with regard to public in safety/performance will be occurred.</p>					

<p><b>XVII. UTILITIES AND SERVICE SYSTEMS.</b> Would the project:</p>	<p>a) Exceed wastewater treatment requirements of the applicable Regional Water Quality Control Board?</p> <p>b) Require or result in the construction of new water or wastewater treatment facilities or expansion of existing facilities, the construction of which could cause significant environmental effects?</p> <p>c) Require or result in the construction of new storm water drainage facilities or expansion of existing facilities, the construction of which could cause significant environmental effects?</p> <p>d) Have sufficient water supplies available to serve the project from existing entitlements and resources, or are new or expanded entitlements needed?</p>	<p><input type="checkbox"/></p> <p><input type="checkbox"/></p> <p><input type="checkbox"/></p> <p><input type="checkbox"/></p>	<p><input type="checkbox"/></p> <p><input type="checkbox"/></p> <p><input type="checkbox"/></p> <p><input type="checkbox"/></p>	<p><input type="checkbox"/></p> <p><input checked="" type="checkbox"/></p> <p><input checked="" type="checkbox"/></p> <p><input type="checkbox"/></p>	<p><input checked="" type="checkbox"/></p> <p><input type="checkbox"/></p> <p><input type="checkbox"/></p> <p><input checked="" type="checkbox"/></p>
---	---	---	---	---	---

ENVIRONMENTAL INFORMATION CHECKLIST

Project Title: City of Inglewood Well No. 7 at 101 West Arbor Vitae Street, Inglewood, California 90301

**EVALUATION OF ENVIRONMENTAL IMPACTS:**

ISSUES		Potentially Significant Impact	Less than Significant with Mitigation Incorporation	Less than Significant Impact	No Impact
	e) Result in a determination by the wastewater treatment provider which serves or may serve the project that it has adequate capacity to serve the project's projected demand in addition to the provider's existing commitments? f) Be served by a landfill with sufficient permitted capacity to accommodate the project's solid waste disposal needs? g) Comply with federal, state, and local statutes and regulations related to solid waste?	<input type="checkbox"/>  <input type="checkbox"/>  <input type="checkbox"/>	<input type="checkbox"/>  <input type="checkbox"/>  <input type="checkbox"/>	<input type="checkbox"/>  <input type="checkbox"/>  <input checked="" type="checkbox"/>	<input checked="" type="checkbox"/>  <input checked="" type="checkbox"/>  <input type="checkbox"/>
<p><b>Comments:</b></p> <p>a) No Impact. The project will not generate significant quantities of wastewater, which would require the increase of treatment capacity. The projects will only result in an overall improvement to the existing water service infrastructure. Therefore, the projects will not have the potential to create a significant environmental effect due to the exceeding of wastewater treatment requirements.</p> <p>b) Less than Significant Impact. As proposed, the Well No. 7 project will not result in an expansion of a service but rather the upgrading of the existing service. The addition of the pipeline and the new high capacity water supply well will only improve the existing level of service. No new wastewater treatment facilities or an expansion of existing facilities be necessary. Therefore, there will be a less than significant effect upon the environment in terms of the necessity for new water or wastewater treatment facilities or expansion of existing facilities.</p> <p>c) Less than Significant Impact. The proposed projects will not require or result in an increase in the amount of impervious surface or the increase of surface runoff. However, new 8" storm drainage line will be constructed and connected to nearby Los Angeles County Storm Water drainage line. The line will be used only for the flushing or discharge during the repair or test run from the well. So it happens only occasionally. It will not require increased capacity of existing stormwater drainage facilities, or the construction of new stormwater drainage facilities. Therefore, the proposed projects will not create a potential for a significant effect upon the environment as a result of requiring new or expanded stormwater drainage facilities. Thus, the impact is expected to be less than significant.</p> <p>d) No Impact. The proposed project will improve water delivery service to existing customers in the City of Inglewood. The proposed interconnection pipeline would provide a mechanism for exchanging water during both normal and emergency use, the high-capacity potable water well would provide safe and reliable water for general and emergency uses, and the water system improvements would increase water distribution reliability. The projects will not create additional demand for water. As a result, no additional or expanded water entitlements will be necessary. No impact will result.</p> <p>e) No Impact. The projects will not alter the wastewater treatment or create an increased demand for wastewater treatment services. Therefore, there will not be the potential for a significant effect upon the environment as a result of the wastewater treatment provider's ability to provide</p>					



ENVIRONMENTAL INFORMATION CHECKLIST

Project Title: City of Inglewood Well No. 7 at 101 West Arbor Vitae Street, Inglewood, California 90301

**EVALUATION OF ENVIRONMENTAL IMPACTS:**

ISSUES		Potentially Significant Impact	Less than Significant with Mitigation Incorporation	Less than Significant Impact	No Impact
--------	--	--------------------------------	---	------------------------------	-----------

capacity and meet existing commitments.

f) No Impact. The project will not generate significant quantities of solid waste. The City of Inglewood has contracted Waste Management Company to provide waste disposal services to the City. The Waste Management Company's existing facilities and landfills have sufficient capacity to handle the solid waste generated by the proposed Well No. 7 site. It would be the responsibility of the future contractor of the Well No. 7 to remove and properly dispose of all spoils associated with well drilling. Because the project's solid waste disposal needs can be met, there is no impact.

g) Less than Significant Impact. The project will meet all federal, state and local statutes and regulations. The City of Inglewood contracts with Waste Management Company for solid waste disposal services. Any solid waste generated from construction of the Well No. 7 project would be disposed of in accordance with applicable local, state, and federal requirements. When appropriate, concrete rubble and earthen material would be used as backfill material. In addition, many of the existing pipe lines that are being replaced will remain in place. As a result, the project will not significantly impact the demand for landfill capacity and it will comply will all solid waste statutes and regulations.

<p><b>XVIII. MANDATORY FINDINGS OF SIGNIFICANCE.</b></p>	<p>a) Does the project have the potential to degrade the quality of the environment, substantially reduce the habitat of a fish or wildlife species, cause a fish or wildlife population to drop below self-sustaining levels, threaten to eliminate a plant or animal community, reduce the number or restrict the range of a rare or endangered plant or animal or eliminate important examples of the major periods of California history or prehistory?</p> <p>b) Does the project have impacts that are individually limited, but cumulatively considerable? ("Cumulatively considerable" means that the incremental effects of a project are considerable when viewed in connection with the effects of past projects, the effects of other current projects, and the effects of probable future projects.)</p> <p>c) Does the project have environmental effects which will cause substantial adverse effects on human beings, either directly or indirectly?</p>	<p><input type="checkbox"/></p> <p><input type="checkbox"/></p> <p><input type="checkbox"/></p>	<p><input type="checkbox"/></p> <p><input type="checkbox"/></p> <p><input type="checkbox"/></p>	<p><input type="checkbox"/></p> <p><input type="checkbox"/></p> <p><input type="checkbox"/></p>	<p><input checked="" type="checkbox"/></p> <p><input checked="" type="checkbox"/></p> <p><input checked="" type="checkbox"/></p>
--	--	---	---	---	--

**Comments:**

a) No Impact. The project does not have the potential to degrade the quality of the environment,

ENVIRONMENTAL INFORMATION CHECKLIST

Project Title: City of Inglewood Well No. 7 at 101 West Arbor Vitae Street, Inglewood, California 90301

**EVALUATION OF ENVIRONMENTAL IMPACTS:**

ISSUES		Potentially Significant Impact	Less than Significant with Mitigation Incorporation	Less than Significant Impact	No Impact
--------	--	--------------------------------	---	------------------------------	-----------

reduce the fish and wildlife habitat, threaten plant, fish or wildlife species, or eliminate historical, archeological or cultural resources. The project is located on a parking lot in an urbanized area with residential and commercial uses.

b) No Impact. The project does not have impacts that are cumulatively considerable.

c) No Impact. The project does not have environmental effects that will cause substantial adverse effects on human being, either directly or indirectly.