

ST-4696

ST-4696

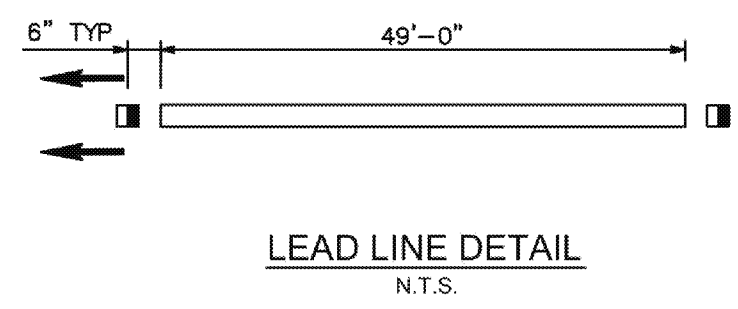

- NOTES:
- 1 INSTALL HIGH REFLECTIVITY YELLOW PAINT ON CURB FACE. EXTEND PAINT ON TOP OF CURB AND CURB FACE TO BC, EC, OR END OF FLARE.
  - 2 INSTALL OM1-3 MARKER, R6-2 AND/OR R4-7 SIGN(S), ON "TELESPAR" POST, WHEN CALLED FOR ON PLAN.

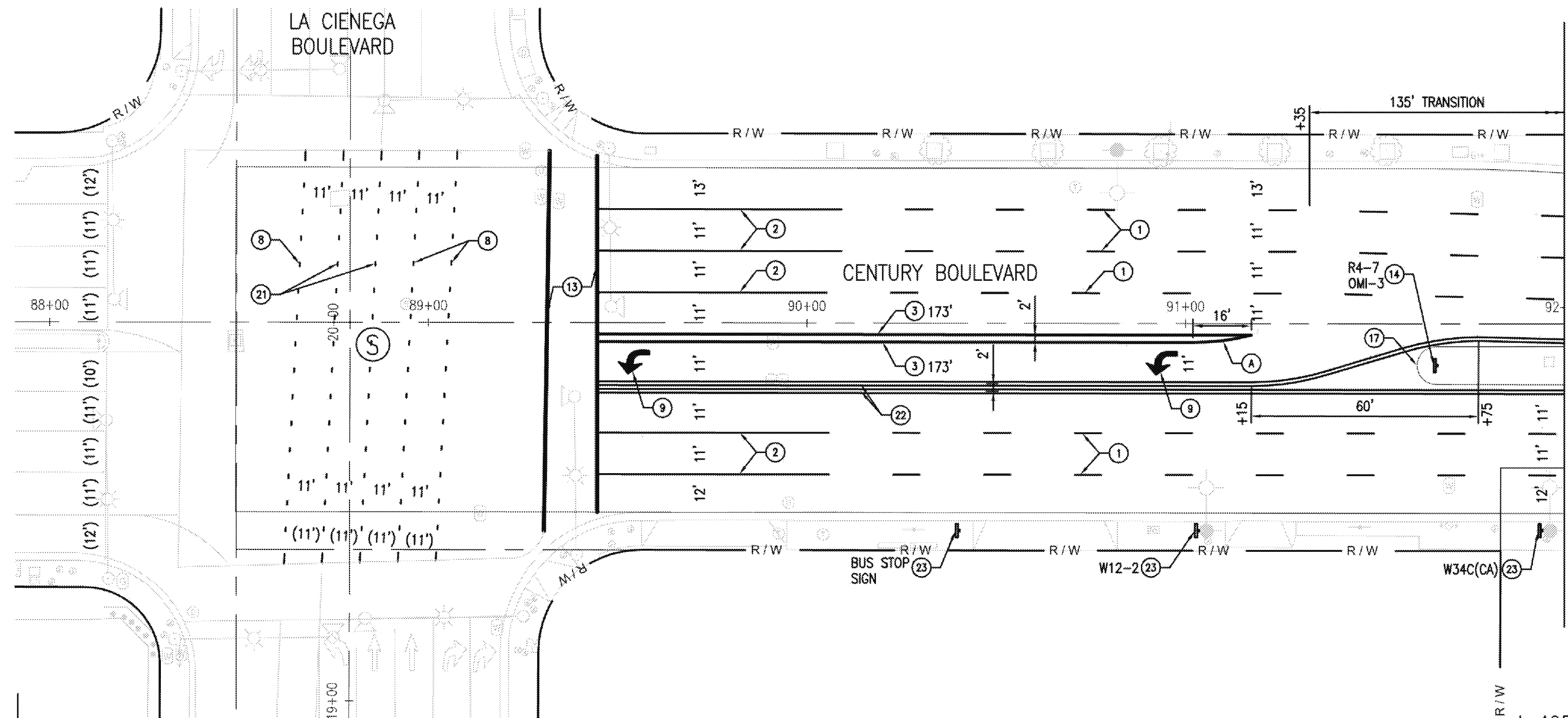
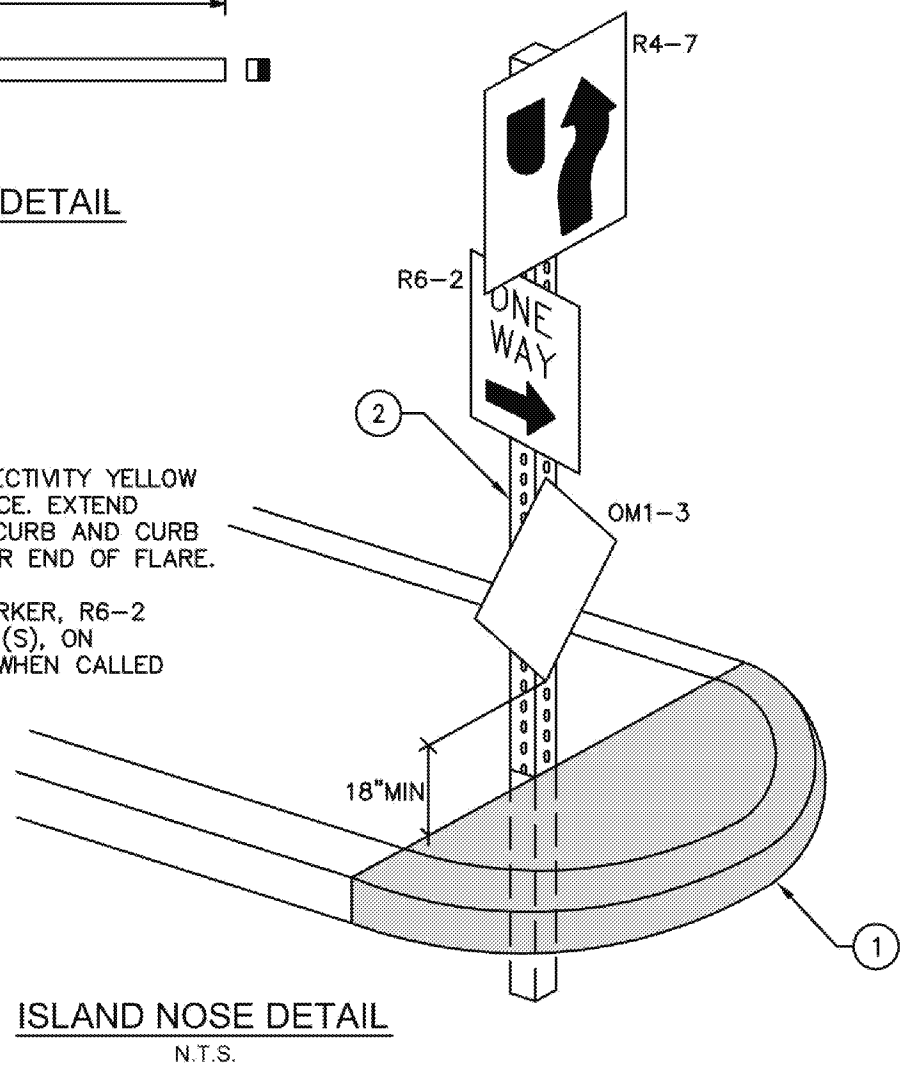

MATCH LINE - STA 92+00  
SEE BOTTOM LEFT FOR CONTINUATION

CURVE TABLE				
CURVE	R	Δ	L	T
A	60'	14°54'57"	15.62'	7.85'

- CONSTRUCTION NOTES:
- 1 INSTALL 4" WHITE LINE AND PAVEMENT MARKERS PER DETAIL 9, CALTRANS STD. PLAN A20A.
  - 2 INSTALL LEAD LINE PAVEMENT MARKERS PER "LEAD LINE DETAIL" ON SHEET SPD-101.
  - 3 INSTALL 8" WHITE LINE AND PAVEMENT MARKERS PER DETAIL 38, CALTRANS STD. PLAN A20D.
  - 7 INSTALL DOUBLE 4" YELLOW LINE AND PAVEMENT MARKERS PER DETAIL 22, CALTRANS STD PLAN A20A.
  - 8 INSTALL 4" WHITE LINE FOR LANE LINE EXTENSION THROUGH INTERSECTION PER DETAIL 40, CALTRANS STD. PLAN A20D.
  - 9 INSTALL TYPE IV, LEFT OR RIGHT, ARROW PER CALTRANS STD PLAN A24A.
  - 11 INSTALL TYPE VII (R) ARROW PER CALTRANS STD PLAN A24A.
  - 13 INSTALL 12" WHITE LIMIT LINE OR CROSSWALK PER CALTRANS STD PLAN A24E. CROSSWALK WIDTH=15' CLEAR.
  - 14 FURNISH AND INSTALL 1 POST ROADSIDE SIGN PER CALTRANS STD PLANS R51.
  - 17 PAINT ISLAND NOSE YELLOW, SEE SPD-101 FOR DETAILS.
  - 21 INSTALL 4" YELLOW LINE FOR CENTERLINE EXTENSION THROUGH INTERSECTION PER DETAIL 41, CALTRANS STD PLAN A20D.
  - 22 INSTALL MEDIAN ISLAND DUAL DOUBLE 4" YELLOW LINE AND PAVEMENT MARKERS PER DETAIL 29, CALTRANS STD PLAN A20B.
  - 23 PROTECT IN PLACE EXISTING TRAFFIC SIGN.

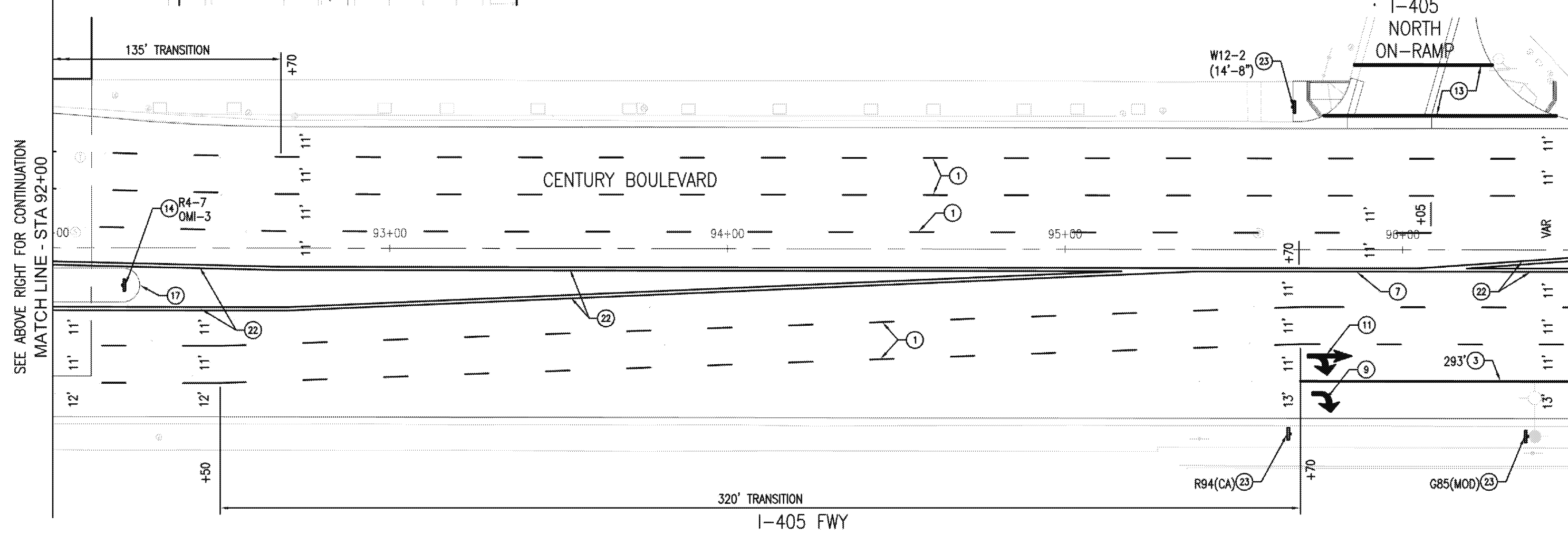

SEE ABOVE RIGHT FOR CONTINUATION  
MATCH LINE - STA 92+00

MATCH LINE - STA 96+50  
SEE SHEET SPD-102 FOR CONTINUATION

- LEGEND:
- PROPOSED SIGNING OR STRIPING
  - ◊ EXISTING SIGNING OR STRIPING
  - Ⓢ SIGNALIZED INTERSECTION
  - ↑ 1 POST SIGN
  - 12" WHITE CROSSWALK OR LIMIT LINE
  - ⊙ PROPOSED PEDESTRIAN LIGHTING
  - ↖ TYPE IV ARROW
  - ↗ TYPE VII ARROW
  - STOP "STOP" PAVEMENT MARKING
  - BUS "BUS" PAVEMENT MARKING
  - ONLY "ONLY" PAVEMENT MARKING
  - PROPOSED STREET LIGHTING
  - R/C RED CURB
  - Y/C YELLOW CURB

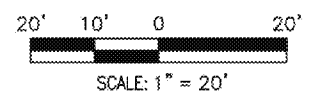

REVISIONS		
MARK	DATE	DESCRIPTION

**AECOM**  
AECOM Technical Services, Inc.  
515 S. FLOWER ST., 4th FLOOR  
LOS ANGELES, CA 90071  
T 213.330.7200 F 213.330.7201  
www.aecom.com

PROFESSIONAL ENGINEER  
JOSEPH J. JOHNSON  
No. 10447  
Exp. 09/30/16  
CIVIL  
STATE OF CALIFORNIA

CITY OF INGLEWOOD, CALIFORNIA  
PUBLIC WORKS DEPARTMENT

PROJECT TITLE:  
PLANS FOR IMPROVEMENT OF  
CENTURY BOULEVARD  
LA CIENEGA BLVD TO FELTON AVE  
SIGNS AND PVMT DELINEATION - 88+00 TO 96+50

DESIGNED BY: \_\_\_\_\_  
DRAWN BY: \_\_\_\_\_  
CHECKED BY: \_\_\_\_\_

SUBMITTED BY / APPROVED BY:  
*Vanessa Munoz*  
VANESSA MUNOZ, RCE 07583 / CONSULTANT TRAFFIC ENGINEER

DATE: 5/18/2015

PLAN NO. 1"=20'  
PROFILE SCALE: VERTICAL N/A, HORIZONTAL N/A

PLAN NO. SPD-101  
SHEET NO. 15 OF 28

ST-4696

ST-4696

CURVE TABLE				
CURVE	R	Δ	L	T
A	10.00'	90°00'00"	15.70'	10.00'

LEGEND:

- PROPOSED SIGNING OR STRIPING
- ◇ EXISTING SIGNING OR STRIPING
- Ⓢ SIGNALIZED INTERSECTION
- 1 POST SIGN
- 12" WHITE CROSSWALK OR LIMIT LINE
- ⊙ PROPOSED PEDESTRIAN LIGHTING
- R/C RED CURB
- ↖ TYPE IV ARROW
- ↗ TYPE VII ARROW
- STOP "STOP" PAVEMENT MARKING
- BUS "BUS" PAVEMENT MARKING
- ONLY "ONLY" PAVEMENT MARKING
- PROPOSED STREET LIGHTING
- Y/C YELLOW CURB

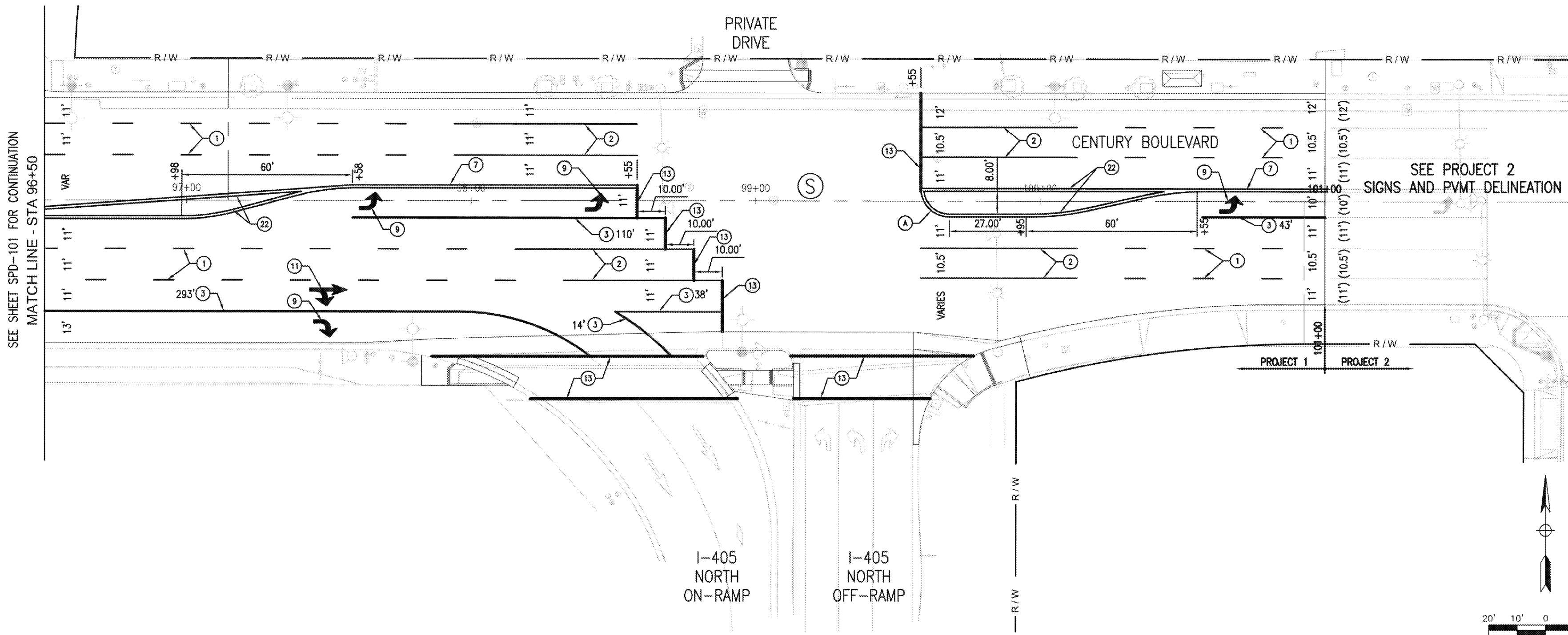

CONSTRUCTION NOTES:

- ① INSTALL 4" WHITE LINE AND PAVEMENT MARKERS PER DETAIL 9, CALTRANS STD. PLAN A20A.
- ② INSTALL LEAD LINE PAVEMENT MARKERS PER "LEAD LINE DETAIL" ON SHEET SPD-101.
- ③ INSTALL 8" WHITE LINE AND PAVEMENT MARKERS PER DETAIL 38, CALTRANS STD. PLAN A20D.
- ⑦ INSTALL DOUBLE 4" YELLOW LINE AND PAVEMENT MARKERS PER DETAIL 22, CALTRANS STD PLAN A20A.
- ⑨ INSTALL TYPE IV, LEFT OR RIGHT, ARROW PER CALTRANS STD PLAN A24A.
- ⑪ INSTALL TYPE VII (R) ARROW PER CALTRANS STD PLAN A24A.
- ⑬ INSTALL 12" WHITE LIMIT LINE OR CROSSWALK PER CALTRANS STD PLAN A24E. CROSSWALK WIDTH=15' CLEAR.
- ⑳ INSTALL MEDIAN ISLAND DUAL DOUBLE 4" YELLOW LINE AND PAVEMENT MARKERS PER DETAIL 29, CALTRANS STD PLAN A20B.

SEE PROJECT 2  
SIGNS AND PVMT DELINEATION

SEE SHEET SPD-101 FOR CONTINUATION  
MATCH LINE - STA 96+50

REVISIONS		
MARK	DATE	DESCRIPTION

**AECOM**

AECOM Technical Services, Inc.  
515 S. FLOWER ST., 4th FLOOR  
LOS ANGELES, CA 90071  
T 213.330.7200 F 213.330.7201  
www.aecom.com

PROFESSIONAL  
SEAL OF  
JOSEPH  
CIVIL  
ENGINEER  
STATE OF CALIFORNIA  
No. 47147  
Exp. 09/30/16

**CITY OF INGLEWOOD, CALIFORNIA  
PUBLIC WORKS DEPARTMENT**

PROJECT TITLE:  
**PLANS FOR IMPROVEMENT OF  
CENTURY BOULEVARD  
LA CIENEGA BLVD TO FELTON AVE  
SIGNS AND PVMT DELINEATION - 96+50 TO 101+00**

DESIGNED BY: \_\_\_\_\_

DRAWN BY: \_\_\_\_\_

CHECKED BY: \_\_\_\_\_

SUBMITTED BY / APPROVED BY:  
*[Signature]*  
VANESSA MURDOZ, RCE 07583 / CONSULTANT TRAFFIC ENGINEER

DATE: **5/18/2015**

PLAN SCALE:  
1"=20'

PROFILE SCALE:  
VERTICAL: N/A  
HORIZONTAL: N/A

PLAN NO.  
**SPD-102**

SHEET NO.  
16 OF 28