

**VESTING TENTATIVE TRACT MAP NO. 80314**  
 IN THE CITY OF INGLEWOOD, CA  
 FOR MERGER, RESUBDIVISION AND CONDOMINIUM PURPOSES

MATCH LINE SEE SHEET 14

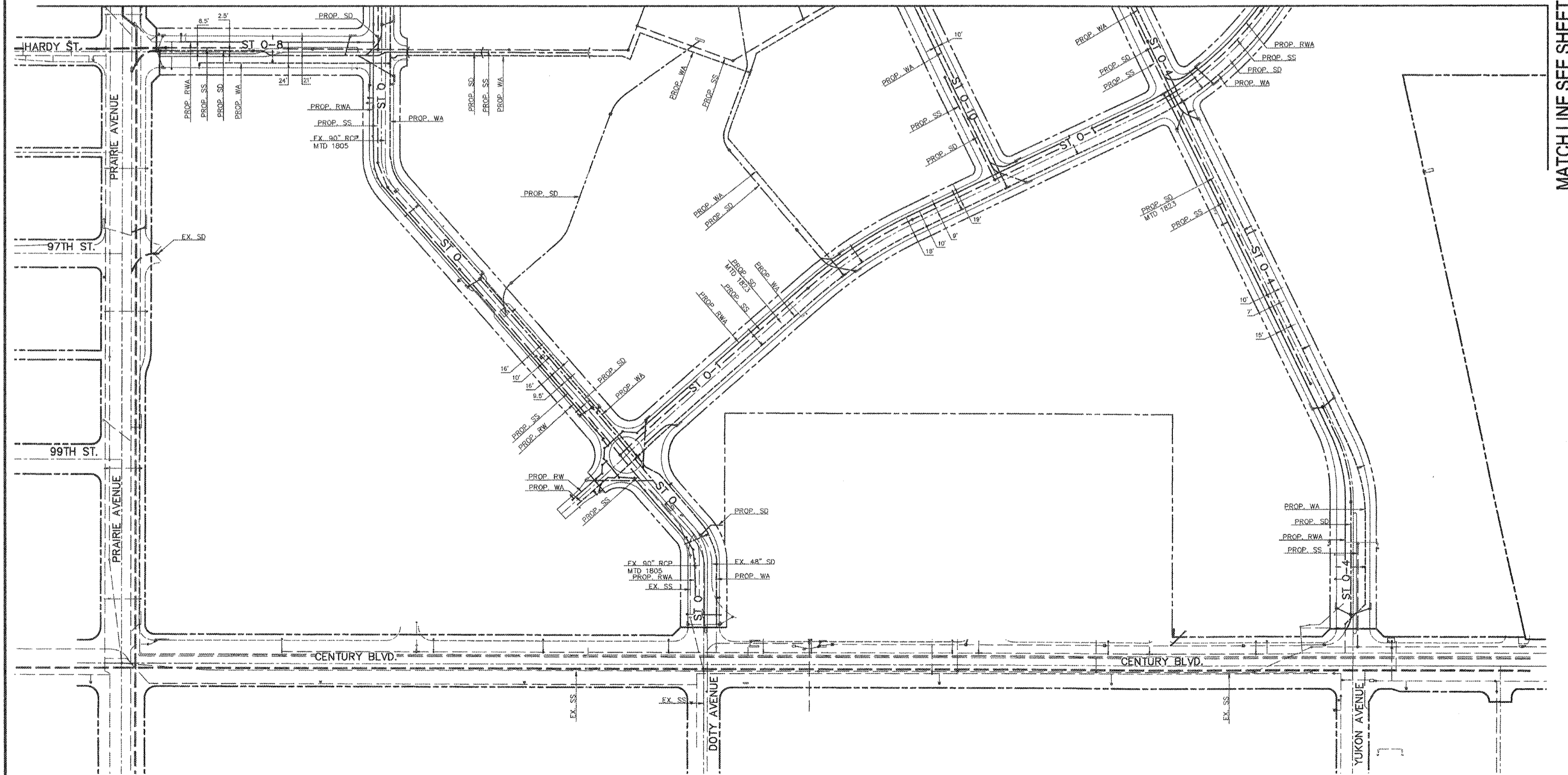

MATCH LINE SEE SHEET 16

03/07/18

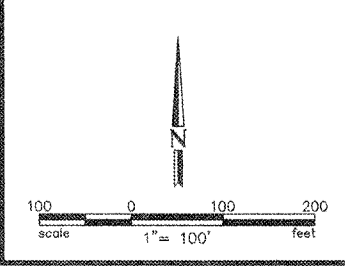

LEGEND	
---	EX. CURB
---	PROPOSED ROW/ PROPERTY LINE
---	PROPOSED CURB
---	PROPOSED LOT LINE
---	EX. BOUNDARY
---	PROPOSED BOUNDARY
---	CENTER LINE
---	PROP. WATER (WA)
---	PROP. RECYCLED WATER (RWA)
---	PROP. ONSITE STORM DRAIN (SD)
---	PROP. SANITARY SEWER (SS)
---	EXISTING OFFSITE UTILITIES

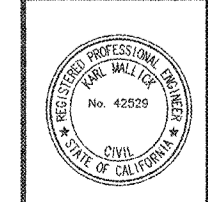

**DAVID EVANS AND ASSOCIATES, INC.**  
 201 S. FIGUEROA STREET, SUITE 240  
 LOS ANGELES, CA 90012  
 Phone: 213.337.3680

PREPARED UNDER THE SUPERVISION OF:  
 KARL MALICK, R.C.E. 42529 DATE

HOLLYWOOD PARK LAND CO., LLC		L.A. STADIUM AND ENTERTAINMENT DISTRICT AT HOLLYWOOD PARK	
DRAWN BY:	LR	DATE:	N.T.S.
DESIGNED BY:	KM	DATE:	03/07/18
CHECKED BY:	KM	DATE:	
APPROVED BY:		DATE:	
VESTING TENTATIVE TRACT MAP NO. 80314 UTILITIES		SHEET NO. 13 of 25	

Drawing Name: M:\2018\80314\80314-2018-02\80314-2018-02\Drawings\UTILITIES\13.DWG  
 Last Date: Mar 07, 2018 7:08pm By: km