

LEGEND

--- --	MU10 LIMIT OF WORK
---	DRAINAGE AREA OUTLINE
■ (light gray)	ROOF DRAINAGE AREA. SEE SHEET 3.02
■ (dark gray)	PODIUM DRAINAGE AREA
■ (stippled)	BIO-FILTRATION PLANTERS
■ (dotted)	FILTERRA BIOSCAPE BIOFILTRATION SYSTEM

- CONSTRUCTION NOTES:**
- STORMWATER PLANTER CONSTRUCTED PER LA COUNTY LID STANDARDS MANUAL. REFER TO DETAIL X, SHEET C3.XX.
 - TWO STAGE STORMWATER PLANTER CONSTRUCTED PER LA COUNTY LID STANDARDS MANUAL. REFER TO DETAIL X, SHEET C3.XX.
 - FILTERRA BIOSCAPE BIOFILTRATION SYSTEM. REFER TO DETAIL X, SHEET C3.XX.

NOTE

- LID PLANTERS AT PODIUM LEVEL ARE TO DISCHARGE INTO SEPARATE PLUMBING SYSTEM.

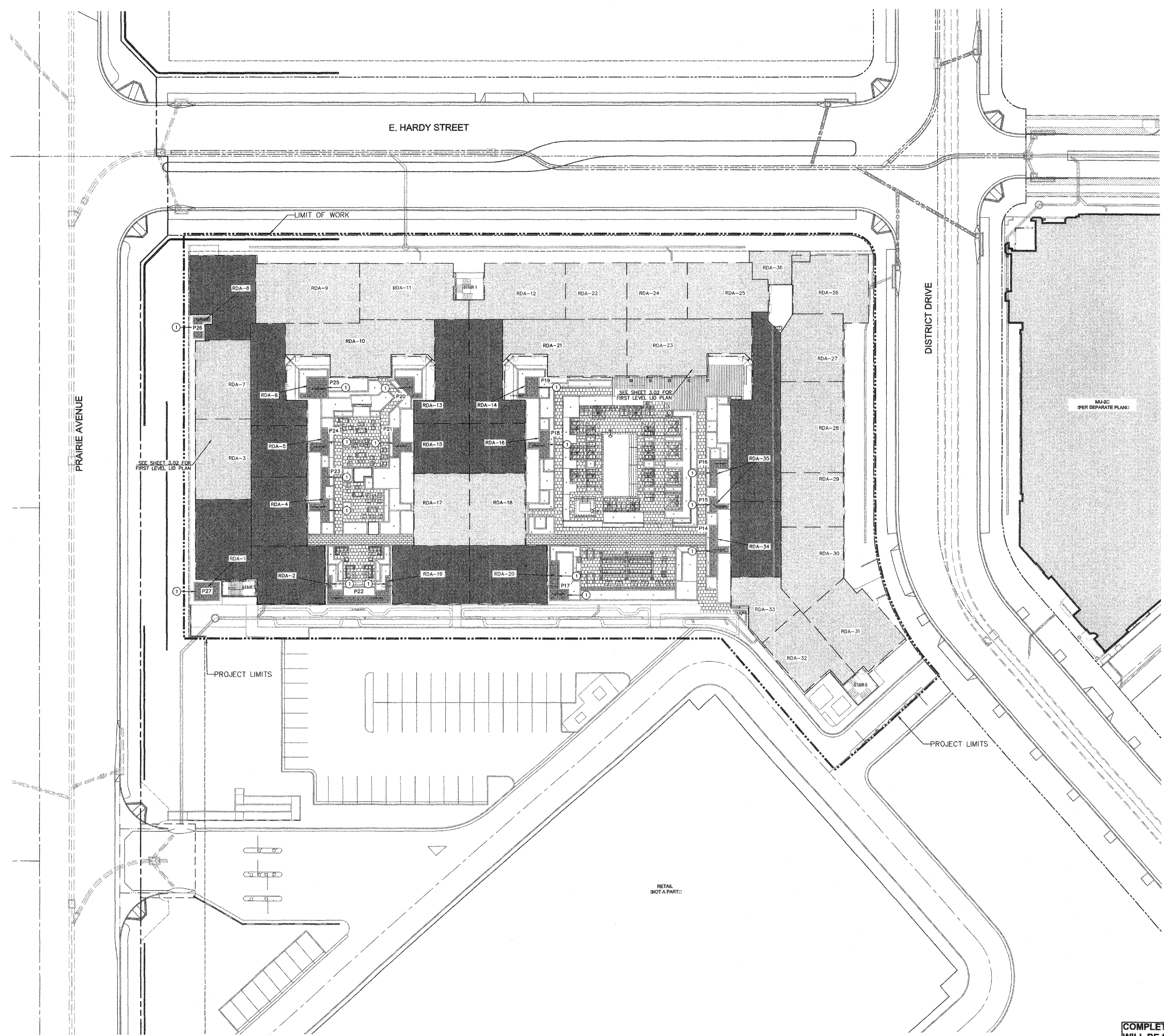

DATE

DESCRIPTION

REVISION

1	ISSUED FOR PERMITS
2	ISSUED FOR CONSTRUCTION

HOLLYWOOD PARK RESIDENTIAL - MU-10
INGLEWOOD, CALIFORNIA
HOLLYWOOD PARK RETAIL AND COMMERCIAL INVESTORS, LLC

PODIUM LEVEL LOW IMPACT DEVELOPMENT (LID) PLAN
NOT FOR CONSTRUCTION

THIS SET OF CONSTRUCTION DOCUMENTS HAS BEEN PREPARED FOR THE CONSTRUCTION OF AN APARTMENT PROJECT.

C3.03
2017-083-01
JOB NUMBER
1" = 20'
SCALE
PLOT PLAN
RESUBMITTAL
DATE
03-21-2018
DATE

COMPLETE DRAWINGS WILL BE SUBMITTED WITH BUILDING PLAN CHECK.
OR REFERENCE ONLY.

