

CODE NOTES

- SEE SHEET G.10 FOR APPLICABLE GENERAL NOTES.
- SEE SHEET COVER SHEET FOR SYMBOLS & ABBREVIATIONS.
- DOOR SHALL SWING IN THE DIRECTION OF EGRESS TRAVEL WHERE SERVING AN OCCUPANT LOAD OF 50 OR MORE PERSONS.
- PROVIDE HIGH LEVEL EXIT SIGNS CENTERED ON CEILING/PORTALS, UNLESS DIRECTED OTHERWISE BY INSPECTOR OR OWNER.
- BUILDING IS EQUIPPED WITH AUTOMATIC SPRINKLER SYSTEM IN ACCORDANCE WITH NFPA 13. THE SEPARATION DISTANCE BETWEEN 2 EXIT DOORS OR EXIT ACCESS DOORS SHALL BE NOT LESS THAN ONE-THIRD OF THE LENGTH OF THE MAXIMUM OVERALL DIAGONAL DIMENSION OF THE AREA SERVED.



LOS ANGELES | IRVINE | OAKLAND
The Architecture Firm of TCA Architects, Inc.
©2016 All rights reserved. Wilson Meany TCA Architects is a service mark.

WILSON MEANY

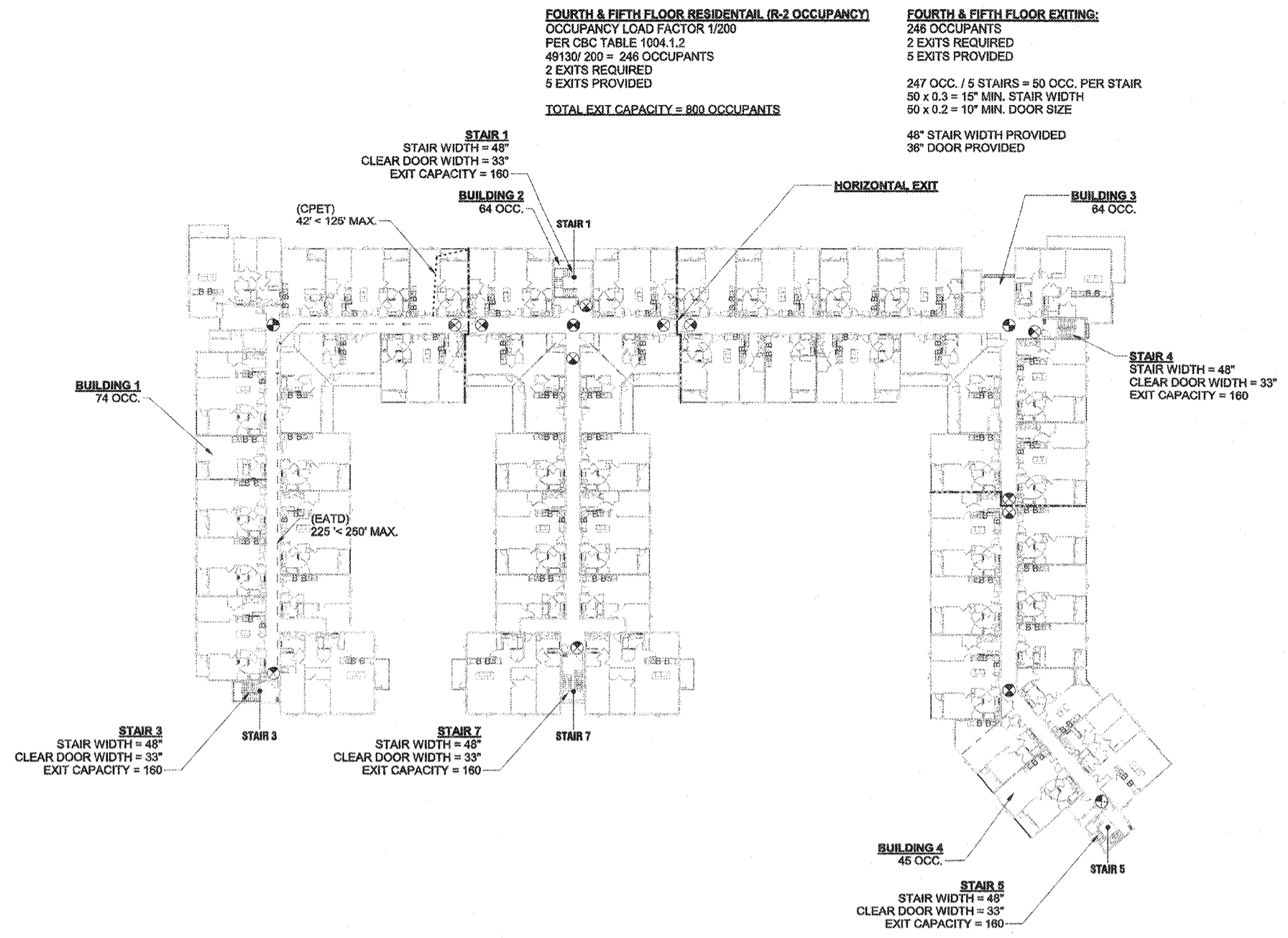

2 EXITING PLAN - 4th & 5th STORY (HOSE PULL SEE 3RD FLOOR SIMILAR)
1" = 30'-0"

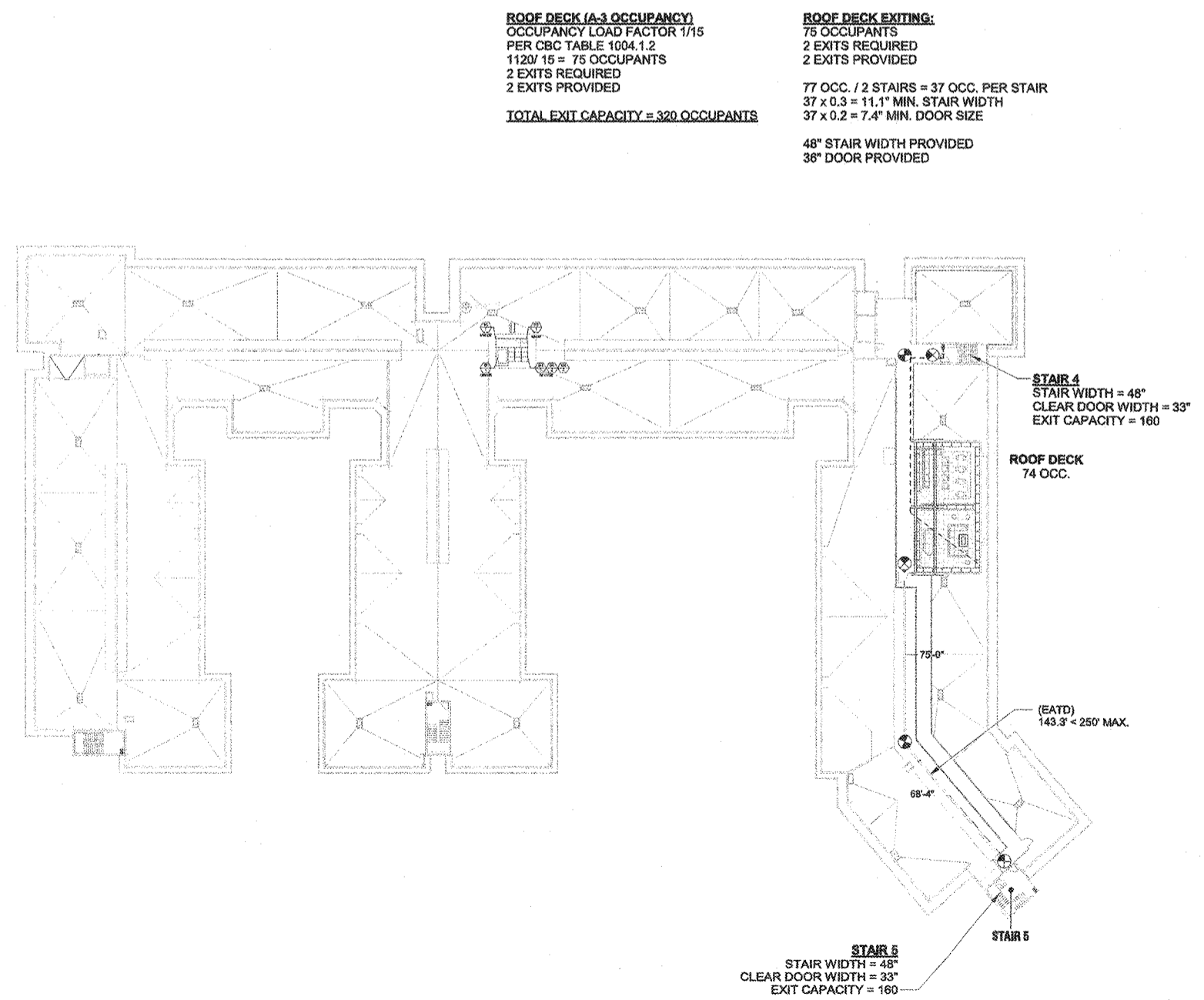

3 EXITING PLAN - ROOF
1" = 30'-0"

STAIR MATRIX

STAIR LEVEL	STAIR ACCESS MATRIX						
	1	2	3	4	5	6	7
ROOF			●	●	●	●	
5			●	●	●	●	
4	●	●	●	●	●	●	
3	●	●	●	●	●	●	
2	●	●	●	●	●	●	
1	●	●	●	●	●	●	
B1	●	●	●	●	●	●	
STANDPIPE	●	●	●	●	●	●	

- STAIR ACCESS
- PASS THROUGH FLOOR, NO ACCESS

LEGEND

- COMMON PATH OF EGRESS TRAVEL (CPET)
- MAXIMUM DISTANCES (TABLE 1006.2.1):
GROUP R-2: 125 FT
GROUP S-2: 100 FT
GROUP B: 100 FT
GROUP A-3: 75 FT
- OVERALL DIAGONAL
- - - - - EXIT ACCESS TRAVEL DISTANCE (EATD) BETWEEN EXITS:
MAXIMUM DISTANCES (TABLE 1017.2):
GROUP R-2: 250 FT
GROUP S-2: 400 FT
GROUP B: 300 FT
GROUP A-3: 250 FT
- 2 HOUR FIRE WALL
- EXIT POINT OF EGRESS
- WET STANDPIPE - CLASS I
- ILLUMINATED EXIT SIGN, TYP., PROVIDE REFLECTIVE EXIT SIGN 18" A.F.F.
- 150 FT. HOSE PULL TYP.

HOLLYWOOD PARK RESIDENTIAL - MU-10
INGLEWOOD, CALIFORNIA
HOLLYWOOD PARK RETAIL AND COMMERCIAL INVESTORS, LLC

CONTRACT NUMBER
CODE ANALYSIS - EXITING PLANS - STORY 4 - ROOF
NOT FOR CONSTRUCTION

THIS SET OF CONSTRUCTION DOCUMENTS HAS BEEN PREPARED FOR THE CONSTRUCTION OF AN APARTMENT PROJECT.

G.21

2017-083-02
JOB NUMBER
As Indicated
PLOT PLAN
RESUBMITTAL
06/21/2018
ISSUE DATE