

NOTES

1. ALL ROOF RUN OFF TO DRAIN TO STORMWATER PLANTERS & FILTERA PER CIVIL PLANS.
2. ALL ROOF TOP ILLUMINATION WILL BE CONFINED TO THE SITE AND WILL NOT CAUSE ANY GLARE TO ADJACENT PROPERTIES.
3. ALL ROOF-TOP EQUIPMENT TO BE SCREENED FROM PUBLIC VIEW.

ROOFING MATERIAL:
ROOFING MATERIAL TO COMPLY WITH THE FOLLOWING PER 2016 GREEN BUILDING CODE:

04.106.5.1. SOLAR REFLECTANCE. ROOFING MATERIAL SHALL HAVE A MINIMUM 3-YEAR AGED SOLAR REFLECTANCE EQUAL TO OR GREATER THAN THE VALUES SPECIFIED IN TABLE 4.106.5.

04.106.5.2. THERMAL EMITTANCE. ROOFING MATERIALS SHALL HAVE A COOL ROOFING COUNCIL (CRRC) INITIAL OR AGED THERMAL EMITTANCE EQUAL TO OR GREATER THAN THOSE SPECIFIED IN TABLE 4.106.5.

SOLAR REFLECTANCE VALUES SHALL BE BASED ON THE AGED REFLECTANCE VALUE OF THE ROOFING PRODUCT OR THE EQUATION IN SECTION A4.1.06.5.1 IF THE CRRC CERTIFIED AGED SOLAR REFLECTANCE ARE NOT AVAILABLE.

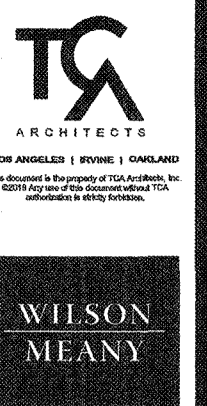

SOLAR ZONE PER BUILDING ENERGY EFFICIENCY STANDARDS
59,309 S.F. OF ROOF AREA X 15% = 8,897 S.F. REQUIRED
9288 S.F. PROVIDED.
SOLAR ZONES TO BE APPROVED UNDER SEPERATE PERMIT

SOLAR ZONE	AREA
SOLAR ZONE 1	678.00 SF
SOLAR ZONE 2	862.00 SF
SOLAR ZONE 3	613.00 SF
SOLAR ZONE 4	684.00 SF
SOLAR ZONE 5	700.00 SF
SOLAR ZONE 6	1073.00 SF
SOLAR ZONE 7	434.00 SF
SOLAR ZONE 8	434.00 SF
SOLAR ZONE 9	1813.00 SF
SOLAR ZONE 10	480.00 SF
SOLAR ZONE 11	480.00 SF
SOLAR ZONE 12	1024.00 SF
TOTAL	9288.00 SF

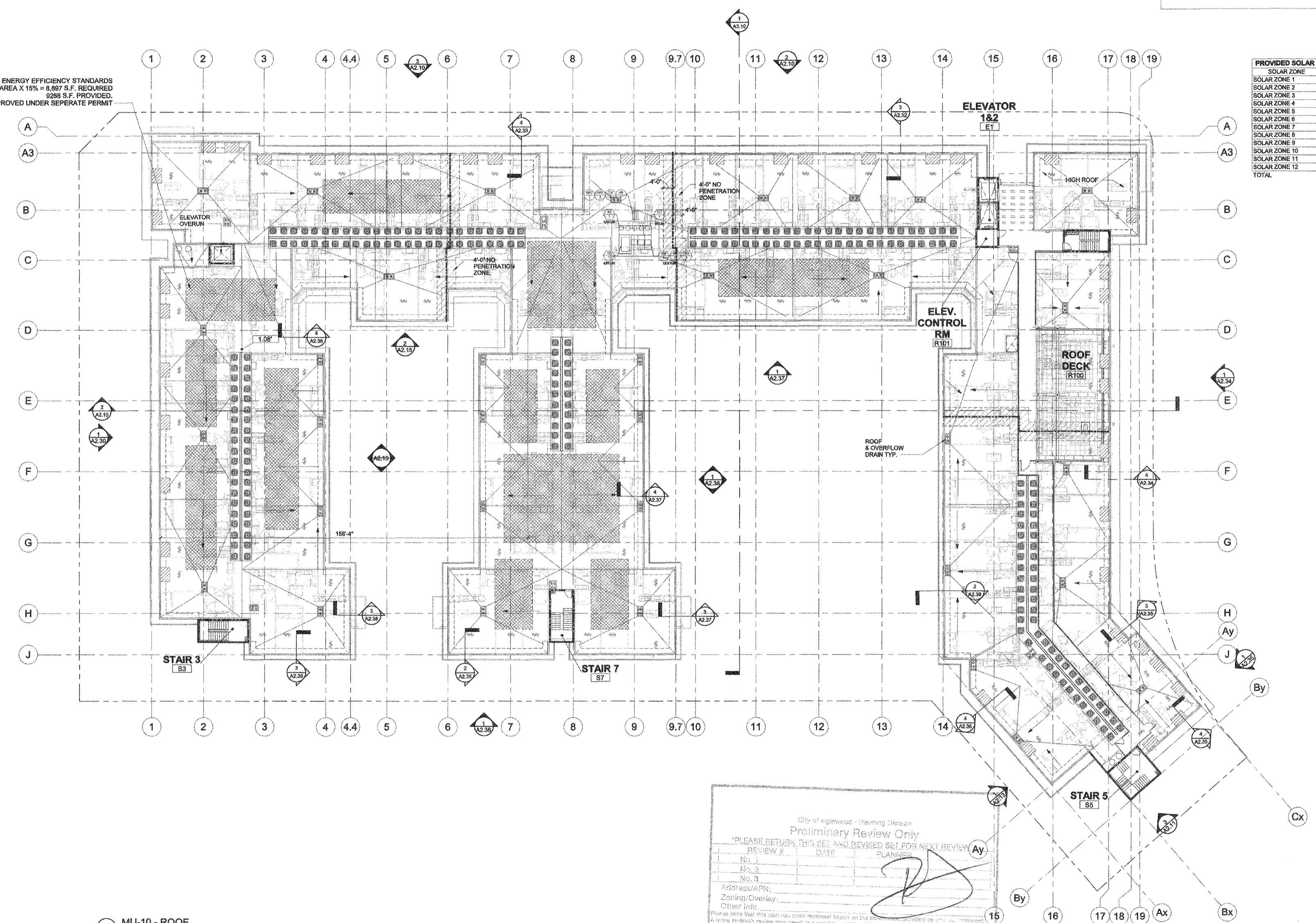

1 MU-10 - ROOF
1/16" = 1'-0"
0 16 32 64

City of Inglewood - Planning Division
Preliminary Review Only
"PLEASE RETURN THIS SET AND REVISED SET FOR NEXT REVIEW"
REVIEW # _____ DATE _____ PLANNER _____
No. 1 _____
No. 2 _____
No. 3 _____
Address/APN: _____
Zoning/Overlay: _____
Other Info: _____
Please note that this plan has been reviewed based on the information provided by the applicant. A more in-depth review may result in a need for additional information. The City of Inglewood is not responsible for the accuracy of the information provided. Those who have "NOT" been advised by the Planning Division will require further review. See Specific Comments on plans (in red).

HOLLYWOOD PARK RESIDENTIAL - MU-10
INGLEWOOD, CALIFORNIA
HOLLYWOOD PARK RETAIL AND
COMMERCIAL INVESTORS, LLC

ROOF PLAN
NOT FOR CONSTRUCTION

THIS SET OF CONSTRUCTION DOCUMENTS HAS BEEN PREPARED FOR THE CONSTRUCTION OF AN APARTMENT BUILDING.
A1.07
2017-093-02
DATE ISSUED
1/16" = 1'-0"
SCALE
PLOT PLAN
RESUBMITTAL
REVISED AS
06/21/2018
DATE DATE