

VESTING TENTATIVE TRACT MAP NO. 80314
 IN THE CITY OF INGLEWOOD, CA
 FOR MERGER, RESUBDIVISION AND CONDOMINIUM PURPOSES

MATCH LINE SEE SHEET 14

MATCH LINE SEE SHEET 16

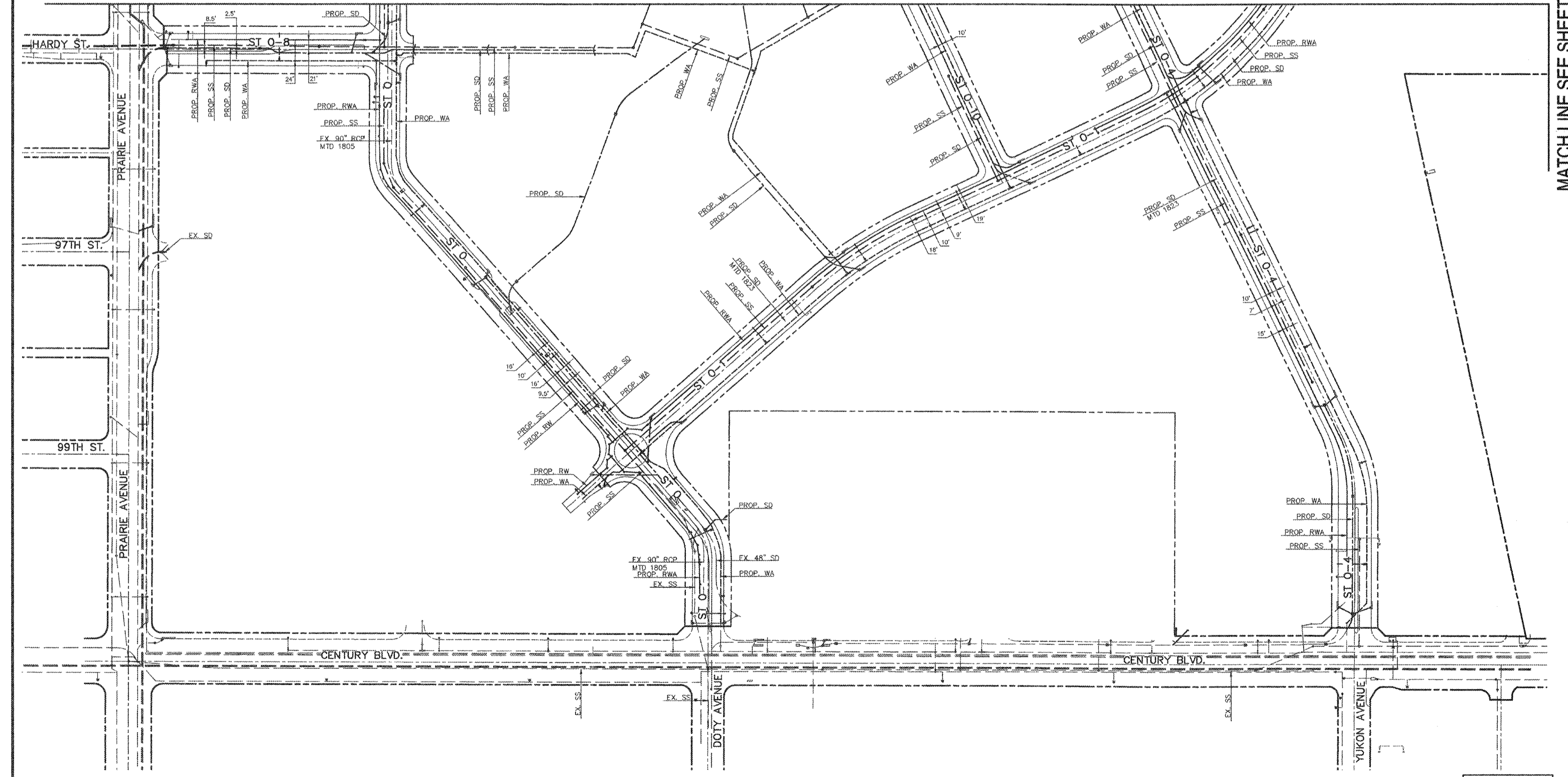

03/07/18

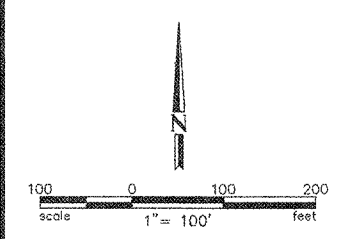

LEGEND			
---	EX. CURB	---	PROP. WATER (WA)
---	PROPOSED ROW/ PROPERTY LINE	---	PROP. RECYCLED WATER (RWA)
---	PROPOSED CURB	---	PROP. ONSITE STORM DRAIN (SD)
---	PROPOSED LOT LINE	---	PROP. SANITARY SEWER (SS)
---	EX. BOUNDARY	---	EXISTING OFFSITE UTILITIES
---	PROPOSED BOUNDARY		
---	CENTER LINE		

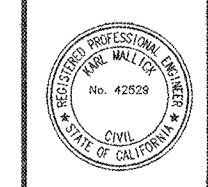

DAVID EVANS AND ASSOCIATES INC.
 201 S. FIGUEROA STREET, SUITE 240
 LOS ANGELES, CA 90012
 Phone: 213.337.9890

PREPARED UNDER THE SUPERVISION OF:
 KARL MALICK, R.C.E. 42529 DATE

HOLLYWOOD PARK LAND CO., LLC		SCALE: N.T.S.
L.A. STADIUM AND ENTERTAINMENT DISTRICT AT HOLLYWOOD PARK		
DRAWN BY: LR	VESTING TENTATIVE TRACT MAP MAP NO. 80314 UTILITIES	DATE: 03/07/18
DESIGNED BY: KM		APPROVED BY: DATE
CHECKED BY: KM	CITY ENGINEER	DATE
13		of 25

Copyright © 2018, David Evans and Associates, Inc. All rights reserved. No part of this drawing may be reproduced without the written permission of David Evans and Associates, Inc.