

**PUBLIC STREETS, STRIPING AND SIGNAL
PLANS TO BE SUBMITTED BY LEGENDS
VIA SEPERATE SUBMITTAL/APPROVAL**

**PRIVATE STREET ARE INCLUDE IN THIS
PACKAGE**

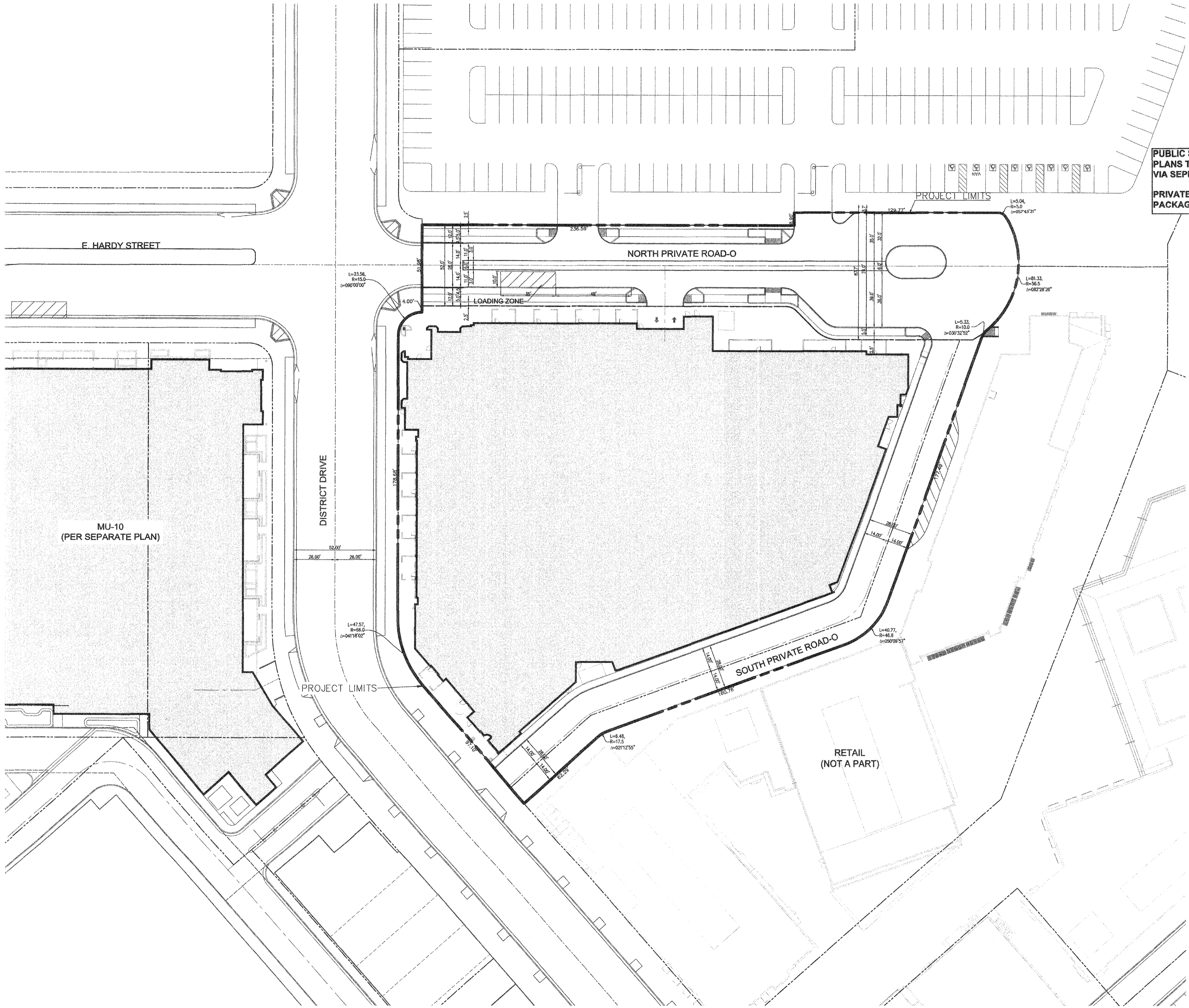

HOLLYWOOD PARK RESIDENTIAL - MU-2C
INGLEWOOD, CALIFORNIA
**HOLLYWOOD PARK RETAIL AND
COMMERCIAL INVESTORS, LLC**

HORIZONTAL CONTROL PLAN
NOT FOR CONSTRUCTION

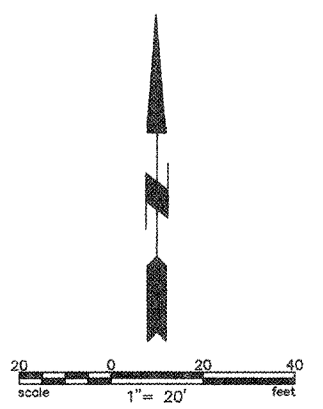

THIS SET OF CONSTRUCTION
DOCUMENTS HAS BEEN
PREPARED FOR THE
CONSTRUCTION OF AN
APARTMENT PROJECT.

C1.02
2017-083-01
JOB NUMBER
1" = 20'
DATE
**PLOT PLAN
RESUBMITTAL**
SUBMITTAL
06-21-2018
ISSUE DATE