

TREE LEGEND:

| SYMBOL | BOTANICAL NAME 'COMMON NAME' | SIZE | WUCOLS |
|----------|---|------|--------|
| [Symbol] | Cordiaum Desert Mesquite | 36" | VL |
| [Symbol] | Desert Mesquite Palo Verde | | |
| [Symbol] | Arbutus unedo Strawberry Tree | 36" | L |
| [Symbol] | Anacardium occidentale Cashew Tree | 36" | M |
| [Symbol] | Chilopsis linearis Desert Willow | 36" | VL |
| [Symbol] | Trachycarpus fortunei Windmill Palm | 36" | M |
| [Symbol] | Strelitzia reginae Giant Bird of Paradise | 36" | M |
| [Symbol] | Tipuana tipu Tipu tree | 36" | M |

SHRUB, VINE, AND GROUNDCOVER LEGEND:

| SYMBOL | BOTANICAL NAME 'COMMON NAME' | SIZE | WUCOLS | SPACING |
|----------|---|-------|--------|----------|
| [Symbol] | Zamia furfuracea Cardinal Palm | 5 GAL | M | SEE PLAN |
| [Symbol] | Ficus pumila Creeping Fig | 5 GAL | M | SEE PLAN |
| [Symbol] | Bauhinia dracaenifolia Palm | 5 GAL | M | SEE PLAN |
| [Symbol] | Cordyline 'Ballet' Cordyline | 5 GAL | L | SEE PLAN |
| [Symbol] | Albermaria 'Echeverria' Alberrmar | 5 GAL | L | SEE PLAN |
| [Symbol] | Phormium tenax 'Variegatum' Green-Yellow New Zealand Flax | 5 GAL | L | SEE PLAN |
| [Symbol] | Woodwardia tobinia Giant Chain Fern | 5 GAL | M | SEE PLAN |
| [Symbol] | Phalodendron 'Xanadu' Phalodendron | 5 GAL | L | SEE PLAN |
| [Symbol] | Asplenium nidus Black Nest Fern | 5 GAL | M | SEE PLAN |
| [Symbol] | Cissampelos 'Kangaroo Vine' Kangaroo Vine | 5 GAL | M | SEE PLAN |
| [Symbol] | Asplenium 'Serrifolium Myers' Foxtail Fern | 5 GAL | M | SEE PLAN |
| [Symbol] | Agave 'Blue Flame' Blue Flame Agave | 5 GAL | L | SEE PLAN |
| [Symbol] | Agave attenuata Foxtail Agave | 5 GAL | L | SEE PLAN |
| [Symbol] | Anemone 'Tini Saucer' Green Anemone | 5 GAL | L | SEE PLAN |
| [Symbol] | Agave 'Desmetiana Variegata' Variegated Dwarf Agave | 5 GAL | L | SEE PLAN |
| [Symbol] | Agave 'Blue Glow' Blue Glow Agave | 5 GAL | L | SEE PLAN |
| [Symbol] | Sansevieria 'Lancelotti' Blue Finger | 5 GAL | L | 12" O.C. |
| [Symbol] | Polystichum munitum Western Sword Fern | 5 GAL | M | SEE PLAN |
| [Symbol] | Dietes 'Indolita' Fortnight Lily | 5 GAL | L | 12" O.C. |

| | | | | |
|----------|--|-------|---|----------|
| [Symbol] | Eucalyptus japonicus 'Microphylla' Variegated Boxleaf Eucalyptus | 5 GAL | M | SEE PLAN |
| [Symbol] | Rhodanthe affinis 'Upright' Upright Rosemary | 5 GAL | L | SEE PLAN |
| [Symbol] | Freulacia ovata glauca Blue Fescue | 5 GAL | L | SEE PLAN |
| [Symbol] | Agave parryi 'var. truncata' Parry's Agave | 5 GAL | L | SEE PLAN |
| [Symbol] | Agave victoriae-reginae Queen Victoria Agave | 5 GAL | L | SEE PLAN |
| [Symbol] | Bougainvillea 'Monika' Co-La-La Bougainvillea | 5 GAL | L | SEE PLAN |
| [Symbol] | Onoclea europaea 'Little Oble' Little Oble | 5 GAL | L | SEE PLAN |
| [Symbol] | Aloe striata Coral Aloe | 5 GAL | L | SEE PLAN |
| [Symbol] | Phormium 'White Block' Black New Zealand Flax | 5 GAL | M | SEE PLAN |
| [Symbol] | Nesaea tenuissima Mexican Feathergrass | 5 GAL | L | SEE PLAN |
| [Symbol] | Senecio vitifolius Narrow-leaf Chalcotricha | 5 GAL | L | SEE PLAN |
| [Symbol] | Lavandula angustifolia 'Hidcote Blue' Hidcote Blue Lavender | 5 GAL | L | SEE PLAN |
| [Symbol] | Myrtus communis Dwarf Myrtle | 1 GAL | L | 9" O.C. |
| [Symbol] | Dichroa argentea 'Silver Falls' Silver Falls Dichroa | 1 GAL | L | SEE PLAN |
| [Symbol] | Senecio rostratus Stork of Paradise | 1 GAL | L | SEE PLAN |
| [Symbol] | Leymus condensatus 'Canyon Phipps' Native Blue Rye | 5 GAL | L | 36" O.C. |
| [Symbol] | Juniperus procumbens 'Elli Blue' Elk Blue California Gray Rush | 5 GAL | L | 18" O.C. |
| [Symbol] | Muhlenbergia capillaris Gulf muhly Grass | 5 GAL | M | 24" O.C. |
| [Symbol] | Muhlenbergia rigens Deer Grass | 5 GAL | L | 24" O.C. |

| | | | | |
|----------|---|-------|---|----------|
| [Symbol] | Panicum alopecuroides Dwarf Fourtail Grass | 5 GAL | M | 12" O.C. |
| [Symbol] | Trachelospermum jasminoides Star Jasmine | 5 GAL | M | SEE PLAN |
| [Symbol] | Westringia 'Grey Box' Dwarf Coast Rosemary | 6 GAL | L | SEE PLAN |
| [Symbol] | Eucalyptus fortunei 'Emerald Queen' White Variegated Winter Creeper | 5 GAL | M | SEE PLAN |
| [Symbol] | Dietes bicolor Fortnight Lily | 5 GAL | L | SEE PLAN |
| [Symbol] | Iris douglasiana Douglas Iris | 5 GAL | L | SEE PLAN |
| [Symbol] | Dianella tasmanica 'Variegata' Variegated Flax Lily | 5 GAL | M | SEE PLAN |
| [Symbol] | Phlox subulata Compacta Dwarf Phlox | 5 GAL | M | SEE PLAN |
| [Symbol] | Ligustrum japonicum Japanese Privet | 5 GAL | M | SEE PLAN |
| [Symbol] | Gardenia jasminoides 'White Gem' White Gem Gardenia | 5 GAL | M | SEE PLAN |
| [Symbol] | Myoporum laetifolium 'Prostratum' Myoporum | 5 GAL | L | SEE PLAN |
| [Symbol] | Phytolacca americana 'White Gem' White Gem Phytolacca | 5 GAL | M | SEE PLAN |
| [Symbol] | Rhaphis indica Indian Hawthorne | 5 GAL | L | SEE PLAN |
| [Symbol] | Carex macrocarpa 'Tulle' Dwarf Reed Plum | 5 GAL | L | SEE PLAN |
| [Symbol] | Dianella arifolia Little Rav Flax Lily | 5 GAL | L | SEE PLAN |
| [Symbol] | Carex pensilvanica California Meadow Sedge | 5 GAL | M | SEE PLAN |
| [Symbol] | Baccharis 'Twin Peak' Coyote Brush | 5 GAL | L | SEE PLAN |
| [Symbol] | Sedum 'Cape Blanco' Cape Blanco Stonecrop | 5 GAL | L | SEE PLAN |

| | | | | |
|----------|---|-------|----|----------|
| [Symbol] | Ribes 'Sycamore Mesa' Evergreen Currant | 5 GAL | VL | SEE PLAN |
| [Symbol] | Yucca baccata Yucca | 5 GAL | M | SEE PLAN |
| [Symbol] | Casuarina 'Cotton Top' Prostrate Weeping Oak | 5 GAL | L | SEE PLAN |
| [Symbol] | Phlox subulata Compacta Dwarf Phlox | 5 GAL | M | SEE PLAN |
| [Symbol] | Rhodanthe affinis 'Upright' Upright Rosemary | 5 GAL | L | SEE PLAN |
| [Symbol] | Salvia 'Santa Barbara' Santa Barbara Sage | 5 GAL | L | SEE PLAN |
| [Symbol] | Sollya heterophylla Australian Bluebell Creeper | 5 GAL | L | SEE PLAN |
| [Symbol] | Agapanthus africanus Lily of the Nile | 5 GAL | M | SEE PLAN |
| [Symbol] | Carex divisa Bartley Sedge | 5 GAL | L | SEE PLAN |
| [Symbol] | Rosa edulis 'White Rose of York' White Rose | 5 GAL | M | SEE PLAN |
| [Symbol] | Helium oleander Cleander | 5 GAL | L | SEE PLAN |
| [Symbol] | Phlox subulata Compacta Dwarf Phlox | 5 GAL | M | SEE PLAN |

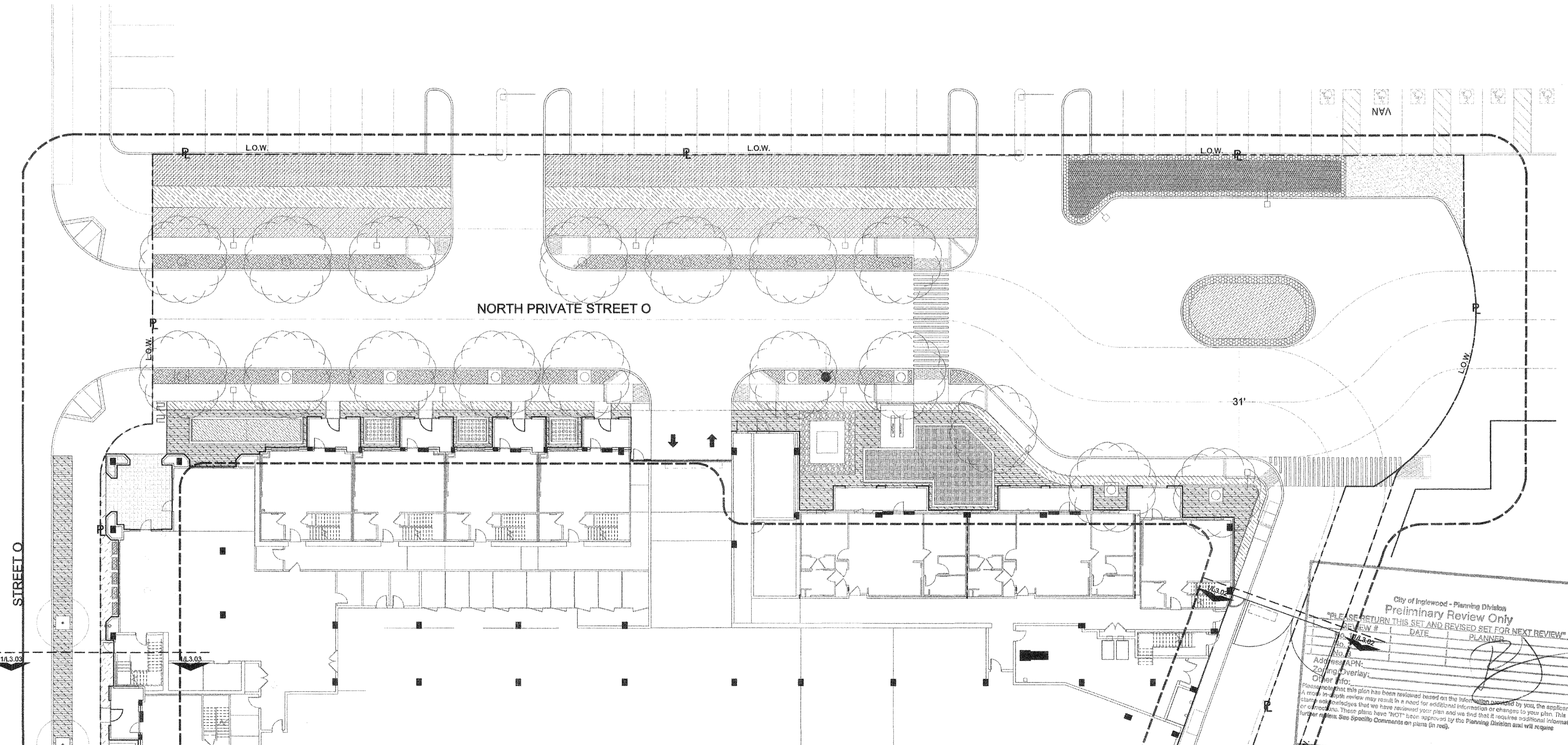

City of Inglewood - Planning Division
Preliminary Review Only
PLEASE RETURN THIS SET AND REVISED SET FOR NEXT REVIEW.
REVIEW # _____ DATE _____ PLANNER _____
No. _____
Address: APN: _____
Zoning Overlay: _____
Other Info: _____
Please note that this plan has been reviewed based on the information provided by you, the applicant. It is the applicant's responsibility to provide all necessary information and to ensure that the plan complies with all applicable laws and regulations. These plans have "NOT" been approved by the Planning Division and will require further review. See Specific Comments on plans (in red).

1 LANDSCAPE PLANTING PLAN LEVEL 1 ENLARGEMENT
SCALE: 3/32" = 1'-0"

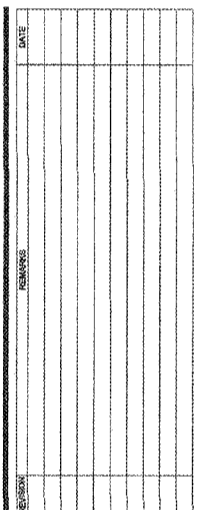

HOLLYWOOD PARK
RESIDENTIAL - MU-2C
INGLEWOOD, CALIFORNIA
HOLLYWOOD PARK RETAIL AND COMMERCIAL INVESTORS, LLC

LANDSCAPE PLANTING
PLAN LEVEL 1 ENLARGEMENT
NOT FOR CONSTRUCTION

THIS SET OF CONSTRUCTION DOCUMENTS HAS BEEN PREPARED FOR THE CONSTRUCTION OF AN APARTMENT PROJECT.
LP3.01
2017-083
JOB NUMBER
DATE
PLOT PLAN
RESUBMITTAL
06-21-2019
ISSUE DATE