

NOTES

1. ALL ROOF RUN OFF TO DRAIN TO STORMWATER PLANTERS & FILTERA PER CIVIL PLANS.
2. ALL ROOF TOP ILLUMINATION WILL BE CONFINED TO THE SITE AND WILL NOT CAUSE ANY GLARE TO ADJACENT PROPERTIES.
3. ALL ROOF-TOP EQUIPMENT TO BE SCREENED FROM PUBLIC VIEW.

ROOFING MATERIAL:
ROOFING MATERIAL TO COMPLY WITH THE FOLLOWING PER 2016 GREEN BUILDING CODE:

04.106.5.1. SOLAR REFLECTANCE, ROOFING MATERIAL SHALL HAVE A MINIMUM 3-YEAR AGED SOLAR REFLECTANCE EQUAL TO OR GREATER THAN THE VALUES SPECIFIED IN TABLE 4.106.5.

04.106.5.2. THERMAL EMITTANCE, ROOFING MATERIALS SHALL HAVE A COOL ROOFING COUNCIL (CRR) INITIAL OR AGED THERMAL EMITTANCE EQUAL TO OR GREATER THAN THOSE SPECIFIED IN TABLE 4.106.5.

SOLAR REFLECTANCE VALUES SHALL BE BASED ON THE AGED REFLECTANCE VALUE OF THE ROOFING PRODUCT OR THE EQUATION IN SECTION A4.1.06.5.1 IF THE CRR CERTIFIED AGED SOLAR REFLECTANCE ARE NOT AVAILABLE.

ALL ROOF-TOP EQUIPMENT TO BE SCREENED FROM PUBLIC VIEW.

SOLAR ZONE	AREA
SOLAR ZONE 1	794.71 SF
SOLAR ZONE 2	591.25 SF
SOLAR ZONE 3	485.00 SF
SOLAR ZONE 4	697.00 SF
SOLAR ZONE 5	332.50 SF
SOLAR ZONE 6	248.50 SF
SOLAR ZONE 7	420.00 SF
SOLAR ZONE 8	252.00 SF
SOLAR ZONE 9	497.00 SF
SOLAR ZONE 10	181.25 SF
SOLAR ZONE 11	530.00 SF
TOTAL	4957.21 SF

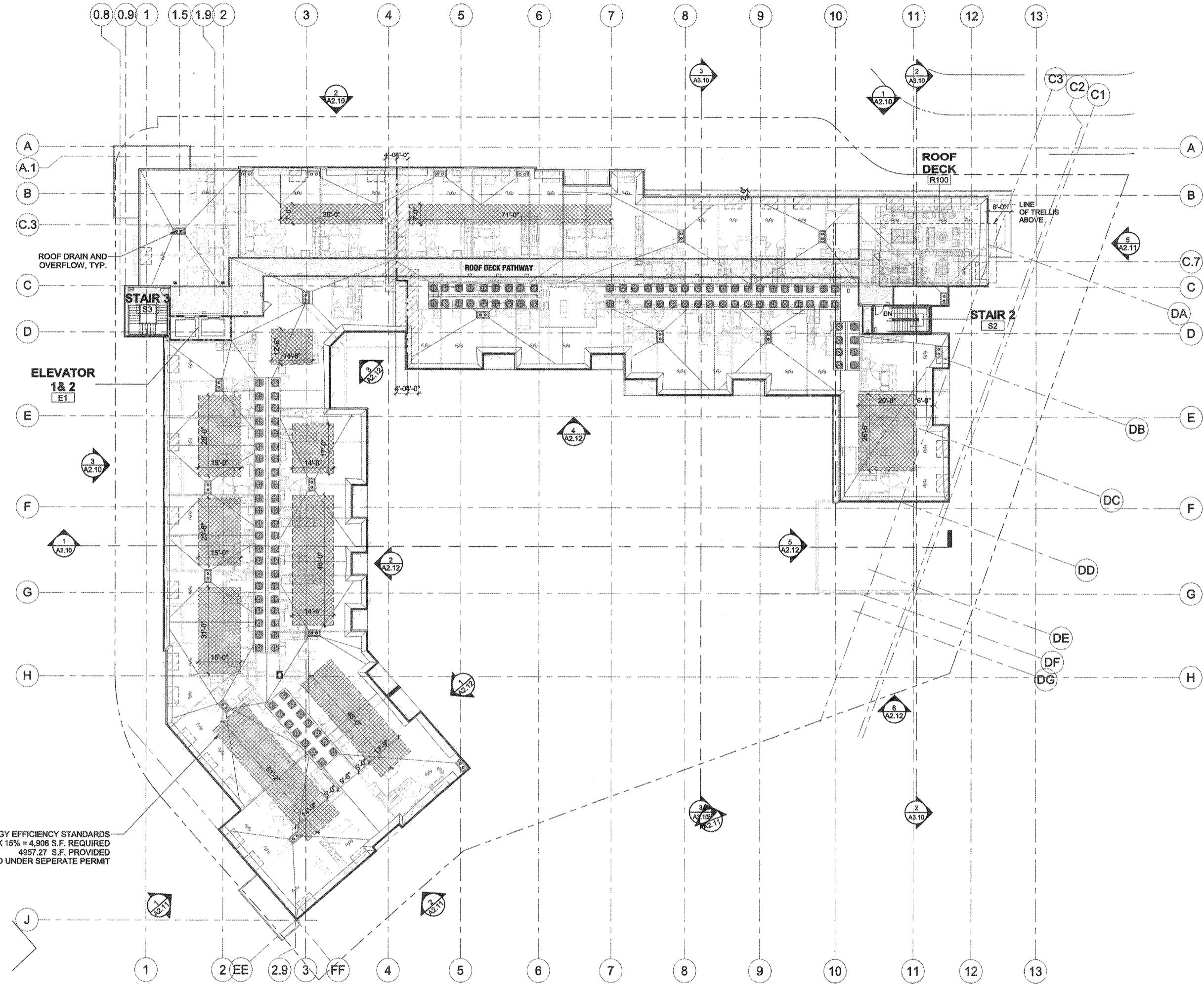

SOLAR ZONE PER BUILDING ENERGY EFFICIENCY STANDARDS
32,702 S.F. OF ROOF AREA X 15% = 4,906 S.F. REQUIRED
4957.27 S.F. PROVIDED
SOLAR ZONES TO BE APPROVED UNDER SEPERATE PERMIT

1 MU-2C - ROOF
1/16" = 1'-0"
0 16 32 64

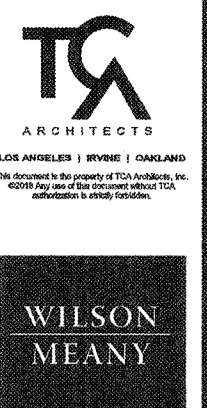

HOLLYWOOD PARK RESIDENTIAL - MU-2C
INGLEWOOD, CALIFORNIA
HOLLYWOOD PARK RETAIL AND COMMERCIAL INVESTORS, LLC

ROOF PLAN
NOT FOR CONSTRUCTION

THIS SET OF CONSTRUCTION DOCUMENTS HAS BEEN PREPARED FOR THE CONSTRUCTION OF AN APARTMENT PROJECT
A1.06
2017-083-01
JOB NUMBER
1/16" = 1'-0"
SCALE
PLOT PLAN RESUBMITTAL
ISSUED AS
06/21/2018
DATE