

ARCHITECT'S SCALE: 1/32" = 1'-0"

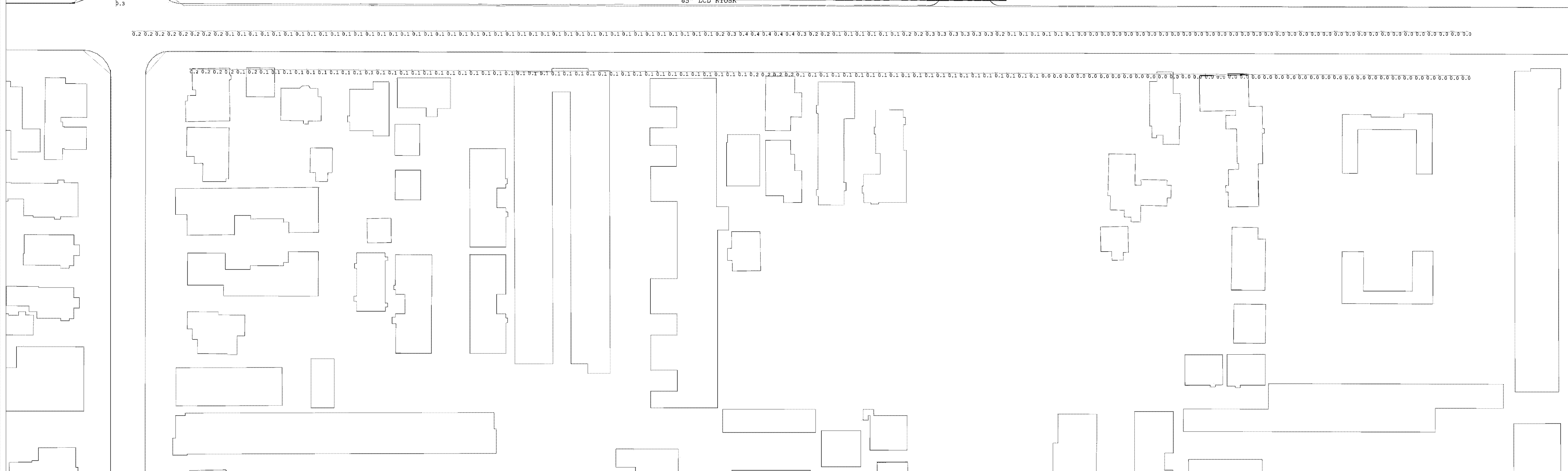
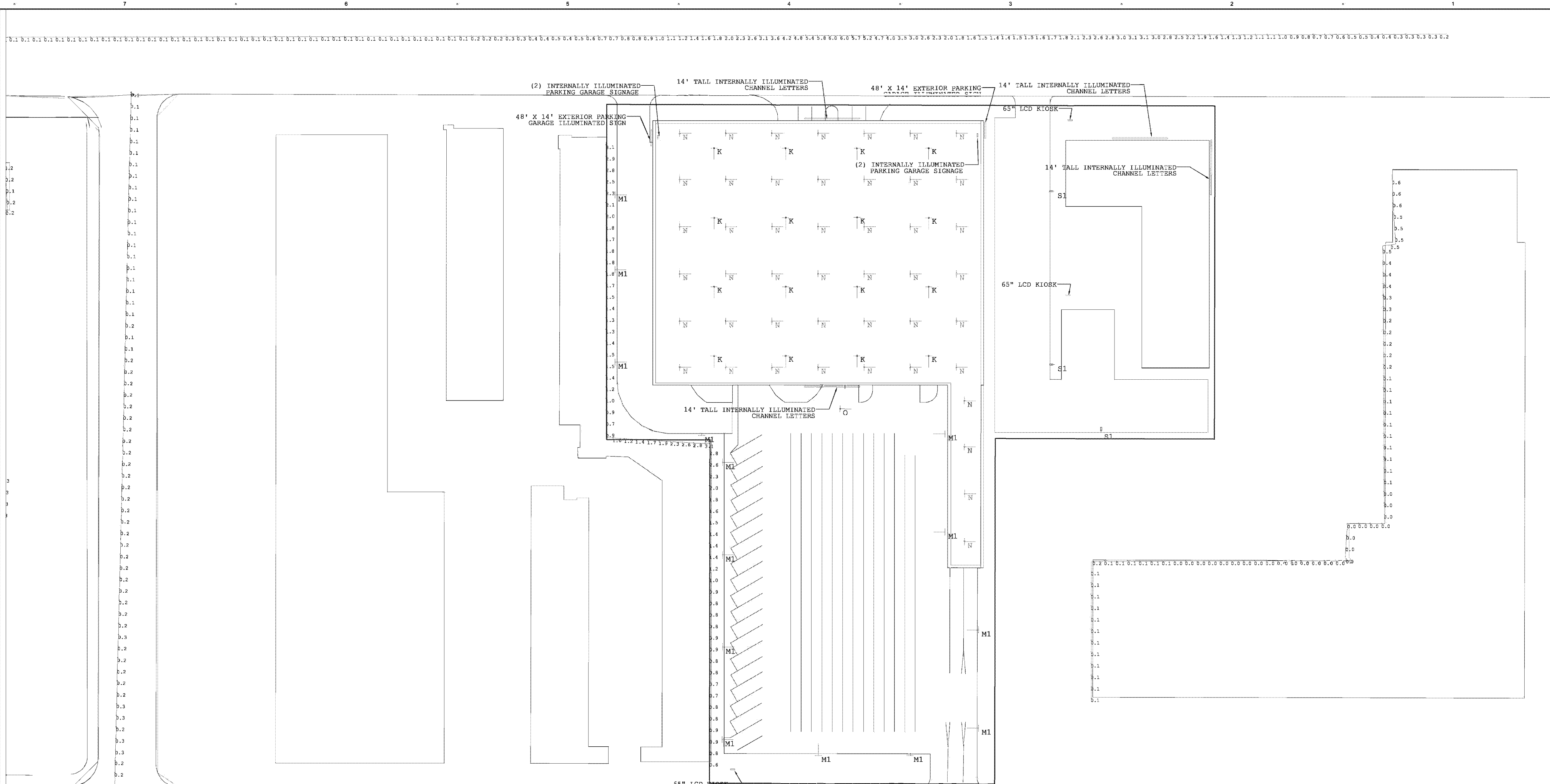

1 EIR ALTERNATE PHOTOMETRICS WITH CENTURY BLVD PEDESTRIAN BRIDGE - SURFACE PARKING EAST PLAN  
1/32" = 1'-0"

**PROJECT**  
IBEC PROJECT  
INGLEWOOD, CALIFORNIA

**DEVELOPER**  
MURPHY'S BOWL  
LLC  
10400 NE 4th St, Suite 3000  
Bellevue, WA 98004

**DEVELOPER'S MANAGING AGENT**  
WILSON MEANY  
6701 Center Drive, Suite 950  
Los Angeles, CA 90045  
310.382.8000 tel  
http://wilsonmeany.com

**ARCHITECT / PLANNING /  
ENGINEERING / TRANSPORTATION**

**AECOM**  
AECOM TECHNICAL SERVICES, INC.  
2380 McGehee, Suite 200  
Kansas City, MO 64108  
816.561.4433 tel 816.561.2863 fax  
www.aecom.com

**CIVIL ENGINEER**  
D&D  
ENGINEERING, INC  
8901 S. La Cienega Blvd, Suite 106  
Inglewood, CA 90301  
424.351.6800 tel

**DRY UTILITY SYSTEMS**  
BJ PALMER &  
ASSOCIATES, INC  
28245 Crocker Avenue  
Valencia, CA 91355  
760.842.7510 tel

**PARKING**  
WALKER  
CONSULTANTS  
606 S. Olive St, Suite 1100  
Los Angeles, CA 90014  
213.486.6911 tel

**SHORING ENGINEER**  
DRS  
ENGINEERING, INC  
3564 Sagunto Street, Suite 468  
Santa Ynez, CA 93460  
818.402.3962 tel

**REGISTRATION**  
This drawing has been prepared for the use of AECOM's client and may not be used, reproduced or relied upon by third parties, except as agreed by AECOM and its client, as required by law or for use by governmental reviewing agencies. AECOM accepts no responsibility, and denies any liability whatsoever, to any party that modifies this drawing without AECOM's express written consent. Do not scale this document. All measurements must be obtained from the stated dimensions.

**NOT FOR  
CONSTRUCTION**

**ISSUE/REVISION**

NO.	DATE	DESCRIPTION

**KEY PLAN**

**PROJECT NUMBER**  
60545923

**SHEET TITLE**  
EIR PHOTOMETRICS BASE - PARKING  
EAST PLAN

**SHEET NUMBER**  
E102