

L.A. STADIUM AND ENTERTAINMENT DISTRICT AT HOLLYWOOD PARK OFF-SITE SIGNING AND STRIPING PLANS

FOR QUESTIONS, CALL MONA AT (661) 607-4544

GENERAL NOTES

- TRAFFIC SIGNING AND STRIPING SHALL CONFORM TO 2010 CALTRANS STANDARD PLANS AND SPECIFICATION AND THE STATE OF CALIFORNIA MUTCD, BOTH IN THE LATEST EDITION, UNLESS OTHERWISE INDICATED.
- PAINTING PROCEDURES FOR STRIPING SHALL CONFORM TO THE STANDARD SPECIFICATIONS FOR PUBLIC WORKS CONSTRUCTION, LATEST REVISION.
- ANY SALVAGEABLE MATERIALS (SIGNS, POSTS, MARKERS, ETC.) SHALL BE DELIVERED TO THE CITY OF INGLEWOOD, BY CONTACTING DON WEEKS AT (310) 412-5333.
- EXISTING STRIPING, ARROWS OR LEGENDS CONFLICTING WITH THIS PLAN SHALL BE REMOVED BY WET SANDBLASTING METHOD. ALL CONFLICTING STRIPING SHALL BE REMOVED.
- STRIPING SHALL BE CAT-TRACKED FOR THE TRAFFIC/TRANSPORTATION ENGINEER OR HIS DESIGNEE'S APPROVAL PRIOR TO FINAL INSTALLATION. A MINIMUM OF FIVE WORKING DAYS MAY BE REQUIRED FOR THE TRAFFIC/TRANSPORTATION ENGINEER OR HIS DESIGNEE TO INVESTIGATE/APPROVE CAT-TRACKED SITE.
- ALL EXISTING STRIPING WITHIN THE PROJECT LIMITS THAT IS TO REMAIN SHALL BE REPAIRED.
- ANY PROPOSED SIGN INSTALLATION OCCURRING WITHIN 20 FT OF A STREET LIGHT POLE SHALL BE INSTALLED ON THE STREET LIGHT POLE ITSELF.

THERMOPLASTIC TRAFFIC STRIPES AND PAVEMENT MARKINGS

THIS SECTION OF THE SPECIAL PROVISIONS IS SUPERSEDED BY THE DEPARTMENT OF PUBLIC WORKS POLICY FOR TRAFFIC STRIPING AND MARKINGS THAT WAS APPROVED ON NOVEMBER 3, 2005.

ALL PAVEMENT LEGEND STENCILS SHALL BE PER 2010 CALTRANS STANDARD PLANS AND THE BLUE RAISED REFLECTIVE PAVEMENT MARKER, PLACED 6 INCH FROM THE CENTERLINE STRIPE

PAVEMENT MARKERS

PAVEMENT MARKERS SHALL CONFORM TO THE PROVISIONS IN SECTION 85, "PAVEMENT MARKERS", OF THE CALTRANS STANDARD SPECIFICATIONS, AS AMENDED AND THE SPECIAL PROVISIONS.

IN ADDITION TO THE PAVEMENT MARKERS TO BE FURNISHED AND INSTALLED WITH THE NEW PERMANENT TRAFFIC STRIPES, THE CONTRACTOR SHALL PROVIDE AND INSTALL TWO-TWO-WAY REFLECTIVE BLUE PAVEMENT MARKERS AT THE CENTERLINE OF THE STREET ADJACENT TO ALL FIRE HYDRANTS OR AS DIRECTED BY THE ENGINEER. THE TWO-WAY REFLECTIVE BLUE PAVEMENT MARKERS SHALL BE INSTALLED AFTER THE FINAL PAVEMENT LIFT IS COMPLETED.

BLUE RAISED

ROADSIDE TRAFFIC SIGNS

ROADSIDE SIGNS SHALL CONFORM TO PROVISIONS IN SECTION 56-2 "ROADSIDE SIGNS" OF THE CALTRANS STANDARD SPECIFICATIONS, AS AMENDED, LATEST EDITION OF THE STATE OF CALIFORNIA MANUAL OF UNIFORM TRAFFIC CONTROL DEVICES (MUTCD), AND THE SPECIAL PROVISIONS.

THE CONTRACTOR SHALL FURNISH AND INSTALL SIGN PANELS FOR ROADSIDE SIGNS AS SHOWN ON THE PLANS. SIGN PANELS SHALL CONFORM TO THE LATEST EDITION OF THE STATE OF CALIFORNIA MUTCD FOR MATERIALS AND LEGEND AND THE FOLLOWING SPECIAL PROVISIONS.

SIGN PANELS SHALL BE REFLECTORIZED WITH 3M DIAMOND GRADE 063 REFLECTIVE SHEETING WITH 1160 PROTECTIVE OVERLAY FILM ON 0.125" THICK ALUMINUM PANELS.

MOUNTING HARDWARE FOR SIGN PANELS ON LIGHTING STANDARDS SHALL CONFORM TO STATE STANDARD PLAN RS-4, RS4

POSTS FOR POST-MOUNTED SIGN PANELS SHALL BE PRE-PUNCHED 12 GAUGE 2" TELESPAR SQUARE TUBE SIGN SUPPORTS MANUFACTURED BY "UNISTRUT" SET IN A TWO PIECE 12 GAUGE BREAKAWAY ANCHOR, OR APPROVED EQUAL, 3/8" RIVETS, "UNISTRUT" PART NO. TL3806, OR APPROVED EQUAL, SHALL BE USED TO CONNECT THE SIGN SUPPORT TO THE SLEEVE AND THE SIGN PANEL TO THE SUPPORT.

THE CONTRACTOR SHALL REMOVE, PROTECT, AND SALVAGE TO THE CITY OF INGLEWOOD MAINTENANCE FACILITY ALL EXISTING TRAFFIC SIGNS THAT CONFLICT WITH THE WORK. THE CONTRACTOR SHALL NOTIFY THE ENGINEER NO LESS THAN 3 WORKING DAYS PRIOR TO THE NEED TO REMOVE OR RELOCATE TRAFFIC SIGNS. NO SEPARATE PAYMENT SHALL BE MADE FOR WORK RELATED TO EXISTING TRAFFIC SIGNS.

EXISTING ROADSIDE SIGNS SHALL NOT BE REMOVED UNTIL REPLACEMENT SIGNS HAVE BEEN INSTALLED OR UNTIL THE EXISTING SIGNS ARE NO LONGER REQUIRED FOR THE DIRECTION OF PUBLIC TRAFFIC, UNLESS OTHERWISE DIRECTED BY THE ENGINEER.

2010 conflicts with the statement about the "Latest Edition" and 2010 should be removed, still use the latest edition even if approved on-site plan was based on the 2010 edition. Please note that Caltrans Standard Plans 2018 was updated on 10/18/2019 and MUTCD 2014 Rev. 4 was updated on March 2019

CONSTRUCTION NOTES	
NO.	DESCRIPTION OFF-SITE SIGNING AND STRIPING NOTES
1	INSTALL 12" WHITE STOP BAR/MARKINGS
2	INSTALL PAVEMENT MARKING AS SHOWN WHERE IS THIS USED?
3	INSTALL TYPE IV RIGHT ARROW LANE LINE
4	INSTALL TYPE IV LEFT ARROW LANE LINE
5	INSTALL TYPE I ARROW (10 FT) VERIFY IF DETAIL 29 ON PINCAY DRIVE IS USED
6	INSTALL 4" WHITE PER DETAIL 38 CHANNELIZING LINE
7	INSTALL DETAIL 28
8	INSTALL 8" WHITE PER DETAIL 38 VERIFY IF DETAIL 29 ON PINCAY DRIVE IS USED
9	INSTALL DETAIL 40
10	INSTALL DETAIL 21
11	INSTALL 8" WHITE PER DETAIL 38A THIS ITEM NOT SHOWN ON PLAN
12	INSTALL DETAIL 29
13	INSTALL 12" WHITE CROSSWALK STRIPING PER CA MUTCD & CALTRANS STD PLANS USING 2" SPACING WITH 4" THICK SIDES
14	INSTALL R3-7 SIGN
15	PAINT CURB RED
16	INSTALL TYPE VI RIGHT ARROW
17	INSTALL 12" YELLOW LADDER CROSSWALK PER CA MUTCD & CALTRANS STD PLANS SOLID WHITE LINE
18	INSTALL DETAIL 22
19	INSTALL DETAIL 23
20	INSTALL 4" WHITE LANE (TYP. 50')
21	GRIND EXISTING THERMOPLASTIC OR COLD PLANE CONFLICTING STRIPING AND LEGENDS AS NEEDED. SLURRY SEAL ALL REMOVALS.
22	INSTALL 8" WHITE PER DETAIL 37B
23	SIGNALIZED INTERSECTION NOT AN ITEM, ALREADY INCLUDED IN LEGEND BELOW.

Pincay is posted 45 mph. Detail 11 should be used for this speed. (CA MUTCD Figure 3A.102 (CH) P.653)

UTILITIES

WATER:
POTABLE: LOS ANGELES DEPARTMENT OF WATER AND POWER (LADWP)
 111 NORTH HOPE ST.
 LOS ANGELES, CA 90012
 (213) 367-2330

CITY OF INGLEWOOD WATER UTILITY DIVISION
 ONE MANCHESTER BLVD.
 INGLEWOOD, CA 90301
 (310) 412-6111

GOLDEN STATE WATER CO.
 630 E. FOOTHILL BLVD.
 SAN DIMAS, CA 91773
 (909) 394-3600

RECLAIMED: WEST BASIN MUNICIPAL WATER DISTRICT
 17140 S. AVALON BLVD.,
 SUITE 210
 CARSON, CA 90746-1296
 RECLAIMED WATER
 (310) 217-2411

SEWER:
 COUNTY SANITATION DISTRICTS OF LOS ANGELES COUNTY (CSD)
 1955 WORKMAN MILL ROAD
 WHITTIER, CA 90601-1400
 (562) 899-7411

STORM DRAIN:
 LOS ANGELES COUNTY FLOOD CONTROL DISTRICT
 900 S. FREMONT AVE.
 ALHAMBRA, CA 91803
 (626) 456-5100

GAS:
 SOUTHERN CALIFORNIA GAS COMPANY (SCE&G)
 3124 W. 36TH ST.
 LOS ANGELES, CA 90018-3605
 (310) 605-4128

ELECTRIC:
 SOUTHERN CALIFORNIA EDISON
 505 MAPLE AVE.
 TORRANCE, CA 90503
 (310) 783-9398

TELECOMMUNICATIONS:
 AT&T
 100 W. ALONDRA BLVD.,
 BLDG A, ROOM 202
 GARDENIA, CA 90248
 (310) 515-4212

LEGEND

	STOP BAR		EXISTING STRIPING AND MARKINGS TO REMAIN
	PAVEMENT MARKING "STOP"		PROPOSED STRIPING AND MARKINGS
	TYPE IV RIGHT ARROW		STREET LIGHT
	TYPE I ARROW		FIRE HYDRANT REFLECTIVE PAVEMENT MARKER
	TYPE IV LEFT ARROW		PROPOSED CATCH BASIN
	C&G CURB & GUTTER		PROPOSED CATCH BASIN
	EP EDGE OF PAVEMENT		PROPOSED TRAFFIC SIGNAL
	R/W RIGHT OF WAY		EXISTING TRAFFIC SIGNAL
	SIGNALIZED INTERSECTION		
	STREET LIGHT		
	EXISTING SIGN		
	PROPOSED SIGN		
	PROPERTY LINE		

KEY MAP

SCALE: 1"=500'
 (X) = SHEET NUMBER

LEGAL DESCRIPTION

PARCELS A AND B OF PARCEL MAP NO. 25640, IN THE CITY OF INGLEWOOD, COUNTY OF LOS ANGELES, STATE OF CALIFORNIA, FILED IN BOOK 289, PAGES 53 THROUGH 61, INCLUSIVE OF MAPS, IN THE OFFICE OF THE COUNTY RECORDER OF SAID COUNTY.

TOGETHER WITH PARCELS A, C, D AND THE REMINDER PARCEL, ALL OF PARCEL MAP NO. 72283, IN THE CITY OF INGLEWOOD, COUNTY OF LOS ANGELES, STATE OF CALIFORNIA, AS FILED IN BOOK 378, PAGES 73 THROUGH 79, INCLUSIVE OF PARCEL MAPS, IN THE OFFICE OF THE COUNTY RECORDER OF SAID COUNTY.

PRIVATE ENGINEER'S NOTICE TO CONTRACTORS

THE EXISTENCE AND LOCATION OF ANY UNDERGROUND UTILITY PIPES OR STRUCTURES SHOWN ON THESE PLANS ARE OBTAINED BY A SEARCH OF THE AVAILABLE RECORDS. TO THE BEST OF OUR KNOWLEDGE, THERE ARE NO EXISTING UTILITIES EXCEPT AS SHOWN ON THESE PLANS. THE CONTRACTOR IS REQUIRED TO TAKE DUE PRECAUTIONARY MEASURES TO PROTECT THE UTILITY LINES SHOWN AND ANY OTHER LINES NOT OF RECORD OR SHOWN ON THESE DRAWINGS. THESE DRAWINGS

R.C.E. SIGNATURE _____ DATE _____

DECLARATION OF RESPONSIBLE CHARGE

I HEREBY DECLARE THAT I AM THE ENGINEER OF WORK FOR THIS PROJECT, THAT I HAVE EXERCISED RESPONSIBLE CHARGE OVER THE DESIGN OF THE PROJECT AS DEFINED IN SECTION 6703 OF THE BUSINESS AND PROFESSIONS CODE, AND THAT THE DESIGN IS CONSISTENT WITH CURRENT STANDARDS. I UNDERSTAND THAT THE CHECK OF PROJECT DRAWINGS AND SPECIFICATIONS BY THE CITY OF INGLEWOOD DOES NOT RELIEVE ME, AS ENGINEER OF WORK, OF MY RESPONSIBILITIES FOR PROJECT DESIGN.

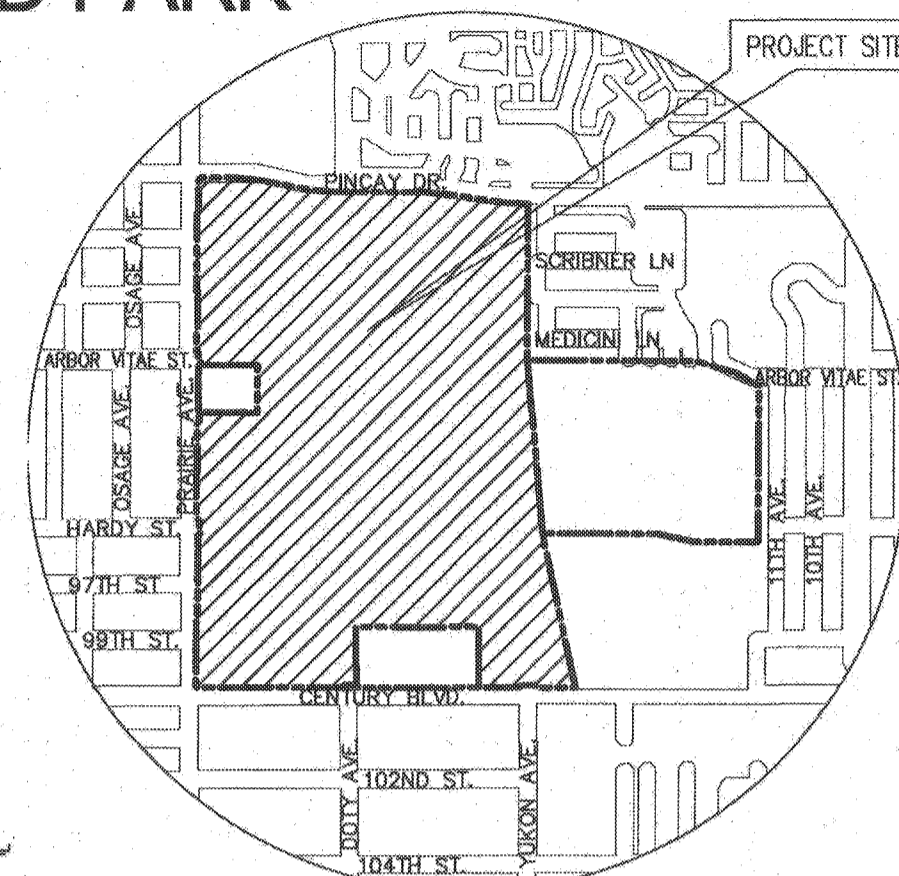

VICINITY MAP

SCALE: 1"=1000'

SHEET INDEX

SHEET NO.	DESCRIPTION
1	COVER SHEET
2	PRAIRIE AVENUE FROM ARBOR VITAE STREET TO PINCAY DRIVE
3	PINCAY DRIVE FROM PRAIRIE DRIVE TO STA 30+00
4	PINCAY DRIVE FROM STA 30+00 TO STREET 0-9

ENGINEER'S NOTICE TO CONTRACTOR

THE EXISTENCE AND LOCATION OF ANY AND ALL CONDUITS, UTILITY PIPES, AND STRUCTURES SHOWN ON THIS SET OF PLANS ARE OBTAINED BY A SEARCH OF THE AVAILABLE RECORDS AT THE TIME OF DESIGN. TO THE BEST OF OUR KNOWLEDGE THERE ARE NO EXISTING UTILITIES WITHIN THE CONSTRUCTION LIMITS OF THIS PROJECT AT THE TIME OF DESIGN EXCEPT AS SHOWN ON THIS SET OF PLANS. THE CONTRACTOR IS REQUIRED TO TAKE DUE PRECAUTIONARY MEASURES TO PROTECT ANY AND ALL UTILITY LINES SHOWN ON THIS SET OF PLANS. THE CONTRACTOR FURTHER ASSUMES ANY AND ALL LIABILITY AND RESPONSIBILITY FOR THE CONDUITS, UTILITY PIPES, AND STRUCTURES SHOWN ON THIS SET OF DRAWINGS. THE CONTRACTOR AGREES THAT HE SHALL ASSUME SOLE AND COMPLETE RESPONSIBILITY FOR THE JOB SITE CONDITIONS DURING THE COURSE OF CONSTRUCTION OF THIS PROJECT. THIS STIPULATION INCLUDES THE SAFETY OF ANY AND ALL PERSONS AND PROPERTY. THE CONTRACTOR SHALL FURTHER DEFEND, INDEMNIFY, AND HOLD THE OWNER AND ENGINEER HARMLESS FROM ANY AND ALL LIABILITY, REAL OR ALLEGED, IN CONNECTION WITH THE PERFORMANCE OF WORK ON THIS PROJECT, WITH THE EXCEPTION OF LIABILITY ARISING FROM THE SOLE NEGLIGENCE OF THE OWNER OR ENGINEER.

CITY OF INGLEWOOD, CALIFORNIA
PUBLIC WORKS DEPARTMENT

TRAFFIC SIGNAL IMPROVEMENT PLANS
HOLLYWOOD PARK PROJECT
OFF-SITE SIGNING AND STRIPING PLANS
COVER SHEET

PERMIT NUMBER: _____ PLAN SCALE: **AS NOTED** SHEET NO. **01 OF 4** PLAN NO. **SS-XXXX**

BENCH MARK

COUNTY OF LA BM# Y-6855. CSEM MON IN WELL
 300MM W/O CP 6.7M S/O BCR @ SW COR
 CRENSHAW BLVD AND MANCHESTER BLVD 31.7M S &
 12.2M W/O C/L INT MKD (BM 27-66 1953 RE 63).

WATTS QUAD ELEV. = 216.519 FT. NAVD88, QUAD
 YEAR 1995, 2000 ADJUSTMENT.

BASIS OF BEARING

THE BEARING OF N89°51'16"W ALONG THE CENTERLINE OF CENTURY BLVD., AS SHOWN AS N89°59'39"W ON PARCEL MAP NO. 25640 RECORDED IN BOOK 289 PAGES 53-61 OF PARCEL MAPS, RECORDS OF LOS ANGELES, WAS TAKEN AS THE BASIS OF BEARINGS FOR THESE PLANS

PRELIMINARY PLANS
NOT APPROVED FOR CONSTRUCTION

OWNER / DEVELOPER:

HOLLYWOOD PARK LAND CO., LLC
 6100 CENTER DRIVE, SUITE 1020
 LOS ANGELES, CA 90045
 RE: HOLLYWOOD PARK, INGLEWOOD



DAVID EVANS AND ASSOCIATES INC.
 145 S. SPRING STREET, SUITE 120
 LOS ANGELES, CA 90012
 Phone: 213.785.7887

PREPARED UNDER THE SUPERVISION OF:

Karl M. Mallow
 KARL MALLOW, R.C.E. 42529
 10/01/2019
 DATE

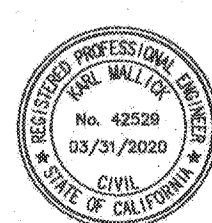

NO.	DATE	REVISION DESCRIPTION	REVISED BY	APPROVED BY	DATE

APPROVED BY: PUBLIC WORKS DIRECTOR

LOUIS A. ATWELL, R.C.E. 53062 DATE _____

SUBMITTED BY:

DAVID EVANS AND ASSOCIATES, INC.

CHECKED BY:

ATKINS NORTH AMERICA, INC.

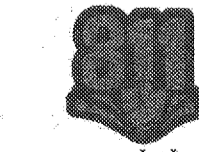

CALL 811
 AT LEAST TWO DAYS BEFORE YOU DIG.
Call before you dig.

UNDERGROUND SERVICE ALERT OF SOUTHERN CALIFORNIA