



DEVELOPER
MURPHY'S BOWL LLC
10400 NE 4TH ST, SUITE 3000
BELLEVUE, WA 98004

DEVELOPER'S MANAGING AGENT
WILSON MEANY
6701 Center Drive, Suite 050
Los Angeles, CA 90045
310.352.0000 tel
http://wilsonmeany.com/

ARCHITECT / PLANNING /
ENGINEERING / TRANSPORTATION

AECOM
AECOM TECHNICAL SERVICES, INC.
2380 McGee, Suite 200
Kansas City, MO 64108
816.951.4443 tel / 816.561.2863 fax
www.aecom.com

CIVIL ENGINEER
D&D ENGINEERING, INC
8801 S. La Cienega Blvd, Suite 106
Inglewood, CA 90301
424.393.4122 tel

DRY UTILITY SYSTEMS
BJ PALMER & ASSOCIATES, INC
28245 Crocker Avenue
Valencia, CA 91355
760.842.7510 tel

PARKING
WALKER CONSULTANTS
606 S. Olive St, Suite 1100
Los Angeles, CA 90014
213.458.4911 tel

SHORING ENGINEER
DRS ENGINEERING, INC
3584 Sagunto Street, Suite 488
Santa Ynez, CA 93480
818.402.3982 tel

TIER	TEAM	CAR COUNT										TOTAL	AREA (SQ FT)	EFFICIENCY (SQ FT/STALL)
		STANDARD	CAR ACCESSIBLE	VAN ACCESSIBLE	EVCS EQUIPPED (3%)	EVCS READY (6%)	EV AMB ACCESSIBLE	EV CAR ACCESSIBLE	EV VAN ACCESSIBLE	EV VAN ACCESSIBLE	EV VAN ACCESSIBLE			
P1 (+90'-9")		50	1	2	13	26	2	1	1	1	1	98	35800	374
TEAM @ P1	87		3	1		6	1	1	1	1	1	100	34870	348
P2 (+102'-3")		223	1	1		0						225	73012	324
P3 (+113'-8")		227	1	1		0						229	70772	309
TOTAL	87	500	6	5	13	32	3	2	2	2	2	650	214,554	330

3% EVCS AT OPENING DAY = 19 TOTAL ALLOCATED AS 3 TEAM (ALL ACCESSIBLE) & 16 VIP
 +5% (6% TOTAL) EVCS READY = 33 (52 TOTAL) ALLOCATED AS 6 ADD'L TEAM REST VIP
 SAME ACCESSIBLE REQUIRED FOR BOTH OPENING DAY AND 6% TOTAL
 1 VAN, 3 CAR, 3 AMBULATORY ALLOCATED TO TEAM 1 @ VAN, CAR & AMBULATORY
 REST TO VIP, BUT CHANGED 1 CAR TO VAN SO HAVE 1 VAN, 1 CAR AND 2 AMB.
 REMAINING SPACES AT OPENING DAY = 650 - 52 = 598 SPACES
 91 TEAM REQUIRES 1 VAN AND 3 CAR ACCESSIBLE
 507 VIP REQUIRES 2 VAN AND 9 CAR ACCESSIBLE

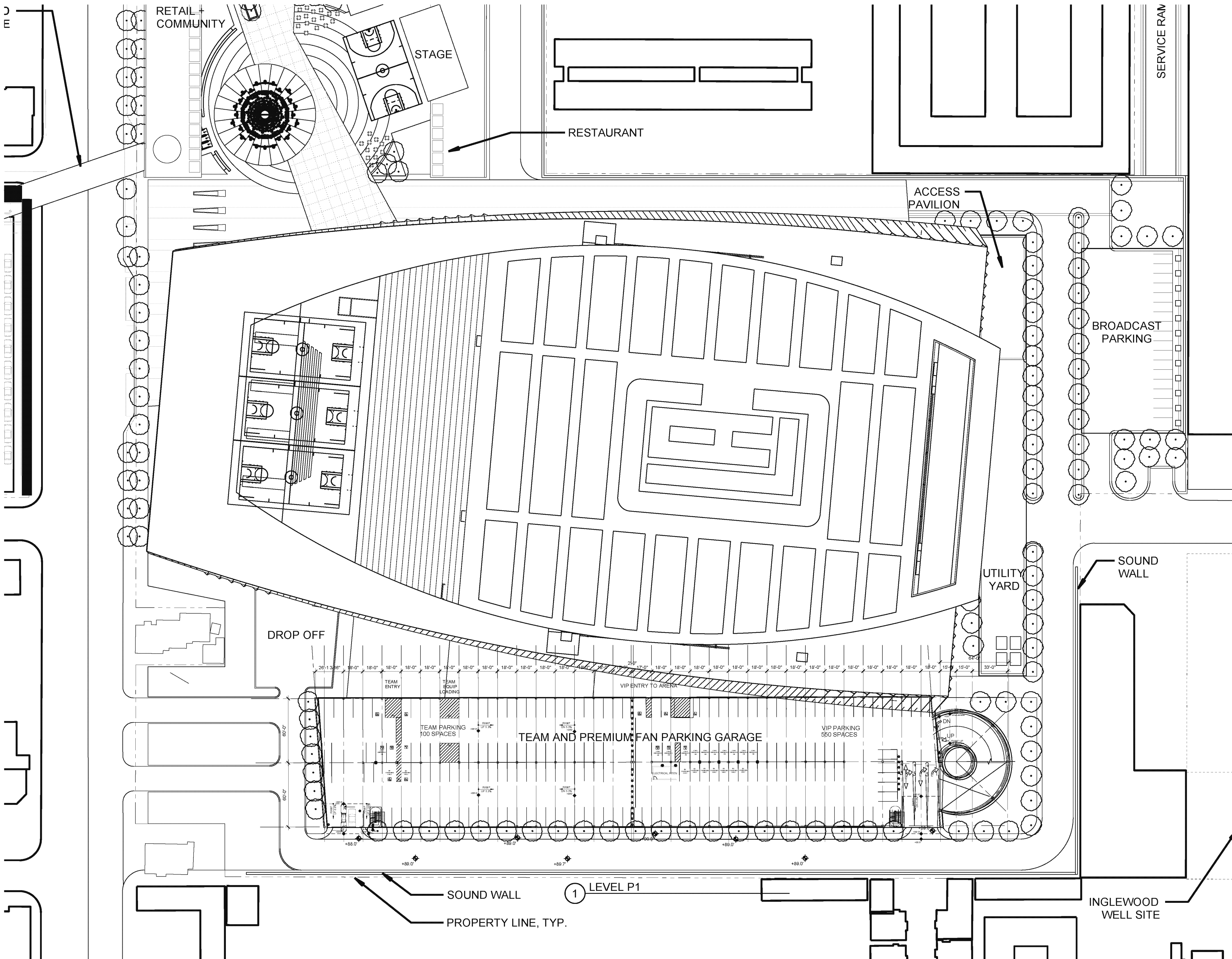

REGISTRATION
 This drawing has been prepared for the use of AECOM's client and may not be used, reproduced or relied upon by third parties, except as agreed by AECOM and its client, as required by law or for use by governmental reviewing agencies. AECOM accepts no responsibility, and denies any liability whatsoever, to any party that modifies this drawing without AECOM's express written consent. Do not scale this document. All measurements must be obtained from the stated dimensions.

NOT FOR CONSTRUCTION
 ISSUE/REVISION

NO.	DATE	DESCRIPTION
1	SEP 12, 2018	CONCEPT DESIGN

KEY PLAN

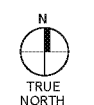

PROJECT NUMBER
60545923

SHEET TITLE
SITE PLAN

SHEET NUMBER
P201A

ARCH: 38' x 48'



PROJECT
PROJECT CONDOR,
INGLEWOOD CALIFORNIA



DEVELOPER

MURPHY'S BOWL
LLC
10400 NE 4TH ST, SUITE 3000
BELLEVUE, WA 98004

DEVELOPER'S MANAGING AGENT

WILSON MEANY
6701 Center Drive, Suite 950
Los Angeles, CA 90045
310.382.8500 tel
http://wilsonmeany.com/

ARCHITECT / PLANNING /
ENGINEERING / TRANSPORTATION

AECOM
AECOM TECHNICAL SERVICES, INC.
2380 McCaw, Suite 200
Kansas City, MO 64108
816.561.4443 tel 816.561.2863 fax
www.aecom.com

CIVIL ENGINEER

D&D
ENGINEERING, INC
8901 S. La Cienega Blvd. Suite 106
Inglewood, CA 90501
494.393.4122 tel

DRY UTILITY SYSTEMS

BJ PALMER &
ASSOCIATES, INC
28245 Crocker Avenue
Valencia, CA 91355
760.842.7510 tel

PARKING

WALKER
CONSULTANTS
606 S. Olive St, Suite 1100
Los Angeles, CA 90014
213.488.4911 tel

SHORING ENGINEER

DRS
ENGINEERING, INC
3564 Sagunto Street, Suite 488
Santa Ynez, CA 93460
818.402.3992 tel

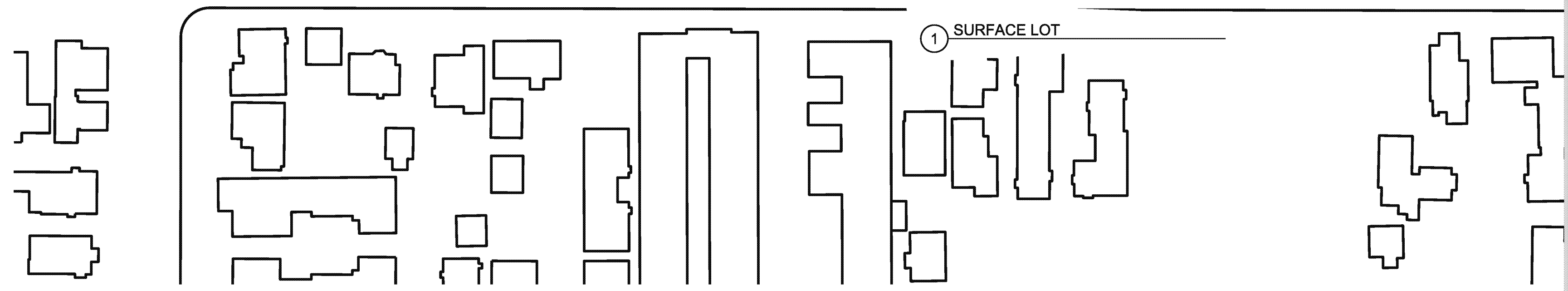
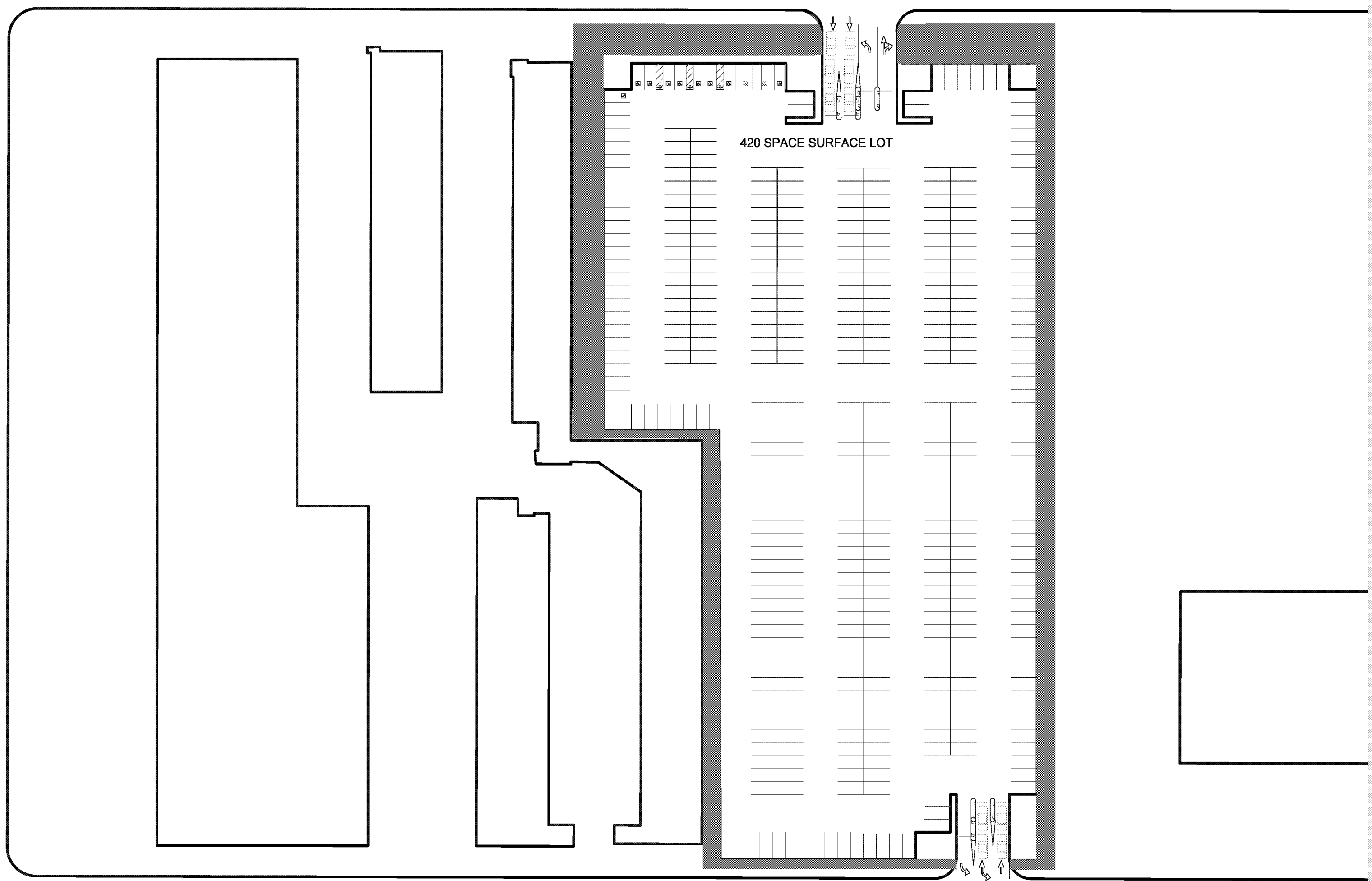

REGISTRATION

This drawing has been prepared for the use of AECOM's client and may not be used, reproduced or relied upon by third parties, except as agreed by AECOM and its client, as required by law or for use by governmental reviewing agencies. AECOM accepts no responsibility, and denies any liability whatsoever, to any party that modifies this drawing without AECOM's express written consent. Do not scale this document. All measurements must be obtained from the stated dimensions.

NOT FOR
CONSTRUCTION

ISSUE/REVISION

NO.	DATE	DESCRIPTION

KEY PLAN

SEP 12, 2016 CONCEPT DESIGN



PROJECT NUMBER

60545923

SHEET TITLE

SITE PLAN

SHEET NUMBER

P301A

© 2015 AECOM TECHNICAL SERVICES, INC.

Project Management Initials: CHK Approved: APR
User: P301A
Last Printed: 09 Jan 2016 9:20:00
Filename: P301A.dwg
Plot: P301A.dwg